

For KCC Use:
Effective Date: 8-2-05
District # 1
SGA? Yes No

KANSAS CORPORATION COMMISSION OIL & GAS CONSERVATION DIVISION NOTICE OF INTENT TO DRILL

Form C-1
December 2002
Form must be Typed
Form must be signed
All blanks must be Filled

Must be approved by KCC five (5) days prior to commencing well

Expected Spud Date 08/01/05
month day year

Spot: East West
C NW - SE - SE Sec. 22 Twp. 23S R. 34

OPERATOR: License # 5447

998 feet from N / S Line of Section

Name: OXY USA Inc.

992 feet from E / W Line of Section

Address: P.O. Box 2528

Is SECTION X Regular _____ Irregular?

City/State/Zip: Liberal, KS 67905

(Note: Locate well on the Section Plat on reverse side)

Contact Person: Vicki Carder

County: Finney

Phone: (620) 629-4242

Lease Name: Sequoyah Morrow Unit Well #: 313W

CONTRACTOR: License # 30606

Field Name: Sequoyah

Name: Murfin Drilling Co., Inc.

Is this a Prorated / Spaced Field? Yes No

Well Drilled For: Well Class: Type Equipment:

Target Formation(s): St. Louis

Oil Enh Rec Infield Mud Rotary

Nearest Lease or unit Boundary: 992 (Waterflood Unit covering 1240 acres)

Gas Storage Pool Ext Air Rotary

Ground Surface Elevation: 2941 feet MSL

OWWO Disposal Wildcat Cable

Water well within one-quarter mile Yes

Seismic: # of Holes Other

Public water supply well within one mile: Yes No

Other Reentry of Dry & Abd Well API 15-055-21489 as a water well

Depth to bottom of fresh water: 360 340

Depth to bottom of usable water: 1100 4020

If OWWO: old well information as follows:

Surface Pipe by Alternate: 1 2

Operator: OXY USA Inc.

Length of Surface Pipe Planned to be set: 1728

Well Name: Garden City S-13

Length of Conductor Pipe Required: NONE

Original Completion Date: ABD 04/18/96 Original Total Depth: 4900

Projected Total Depth: 4900

Formation at Total Depth: St. Louis

Directional, Deviated or Horizontal wellbore? Yes No

Water Source for Drilling Operations: Well Farm Pond Other _____

IF Yes, true vertical depth _____

DWR Permit # _____

Bottom Hole Location _____

(Note: Apply for Permit with DWR)

KCC DKT #: _____

Will Cores be Taken? Yes No

*Prorated & Spaced / SFE ATTACHED
Hugoton & Panoma / PANOMA LETTER

IF Yes, Proposed zone: _____

AFFIDAVIT

The undersigned hereby affirms that the drilling, completion and eventual plugging of this well will comply with K.S.A. 55-101, et. Seq.
It is agreed that the following minimum requirements will be met:

1. Notify the appropriate district office *prior* to spudding of well;
2. A copy of the approved notice of intent to drill *shall be* posted on each drilling rig;
3. The minimum amount of surface pipe as specified below *shall be set* by circulating cement to the top; in all cases surface pipe *shall be set* through all unconsolidated materials plus a minimum of 20 feet into the underlying formation.
4. If the well is dry hole, an agreement between the operator and the district office on plug length and placement is necessary *prior to plugging*;
5. The appropriate district office will be notified before well is either plugged or production casing is cemented in;
6. If an ALTERNATE II COMPLETION, production pipe shall be cemented from below any usable water to surface within **120 days** of spud date. Or pursuant to Appendix "B" - Eastern Kansas surface casing order #133,891-C, which applies to the KCC District 3 area, alternate II cementing must be completed within 30 days of the spud date or the well shall be plugged. *In all cases, NOTIFY district office* prior to any cementing.

I hereby certify that the statements made herein are true and to the best of my knowledge and belief.

Date: 07/25/05 Signature of Operator or Agent: Vicki Carder Title: Capital Project

For KCC Use ONLY

API # 15 - 055-21489-00-01

Conductor pipe required NONE feet

Minimum Surface pipe required 1728 set feet per Alt. ①

Approved by: RJP 7-27-05

This authorization expires: 1-27-06

(This authorization void if drilling not started within 6 months of effective date.)

Spud date: _____ Agent: _____

Remember to:

- File Drill Pit Application (form CDP-1) with Intent to Drill;
- File Completion Form ACO-1 within 120 days of spud date;
- File acreage attribution plat according to field proaction orders;
- Notify appropriate district office 48 hours prior to workover or re-entry;
- Submit plugging report (CP-4) after plugging is completed;
- Obtain written approval before disposing or injecting salt water.
- If this permit has expired (see: authorized expiration date) please check the box below and return to the address below.

Well Not Drilled - Permit Expired

Signature of Operator or Agent: _____

Date: _____

Mail to: KCC - Conservation Division, 130 S. Market - Room 2078, Wichita, Kansas 67202

RECEIVED
JUL 27 2005
KCC WICHITA

IN ALL CASES PLOT THE INTENDED WELL ON THE PLAT BELOW

Plat of acreage attributable to a well in a prorated or spaced field

If the intended well is in a prorated or spaced field, please fully complete this side of the form. If the intended well is in a prorated or spaced field complete the plat below showing that the well will be properly located in relationship to other wells producing from the common source of supply. Please show all the wells and within 1 mile of the boundaries of the proposed acreage attribution unit for gas wells and within 1/2 mile of the boundaries of the proposed acreage attribution unit for oil wells.

API No. 15 - _____
 Operator: _____
 Lease: _____
 Well Number: _____
 Field: _____

Location of Well: County _____
 _____ feet from N / S Line of Section
 _____ feet from E / W Line of Section
 Sec. _____ Twp. _____ R. _____ East West

Number of Acres attributable to well: _____
 QTR / QTR / QTR of acreage: _____ - _____ - _____

Is Section Regular or Irregular

IF Section is Irregular, locate well from nearest corner boundary.

Section corner used: NE NW SE SW

PLAT

(Show location of the well and shade attributable acreage for prorated or spaced wells.)

(Show footage to the nearest lease or unit boundary line.)

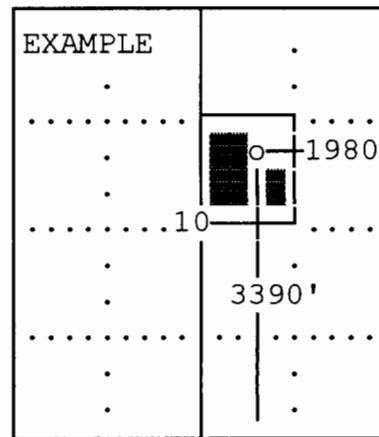
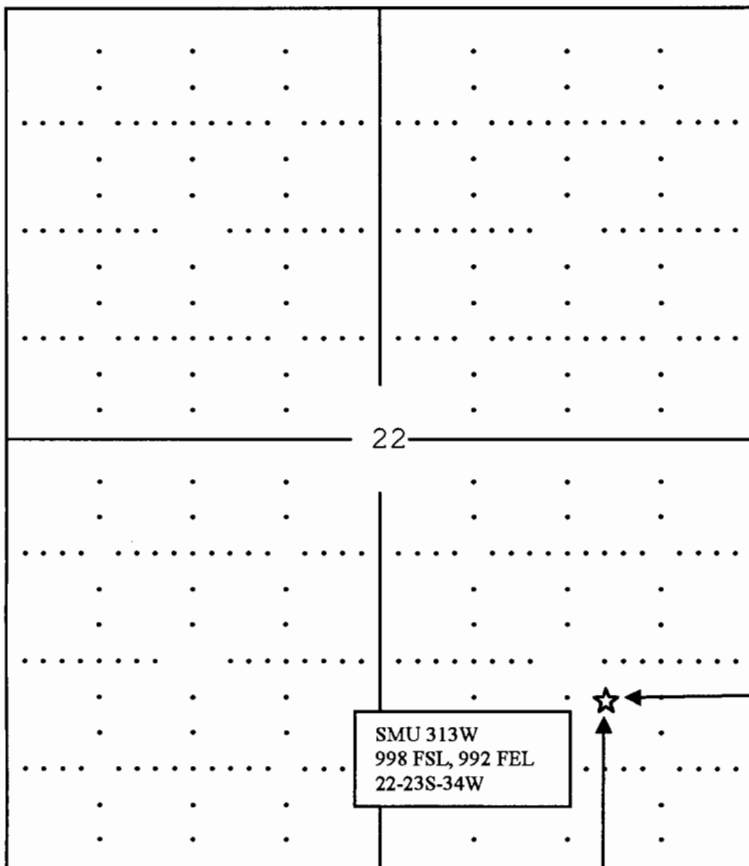

SEWARD CO.

Note: In all cases locate the spot of the proposed drilling location.

Finney County

In plotting the proposed location of the well, you must show:

1. The manner in which you are using the depicted plat by identifying section lines, i.e. 1 section, 1 section with 8 surrounding sections, 4 sections, etc.
2. The distance of the proposed drilling location from the sections south / north and east / west.
3. The distance to the nearest lease or unit boundary line.
4. If proposed location is located within a prorated or spaced field a certificate of acreage attribution plat must be attached: (CO-7 for oil wells; CG-8 for gas wells).



KANSAS

CORPORATION COMMISSION

KATHLEEN SEBELIUS, GOVERNOR

BRIAN J. MOLINE, CHAIR

ROBERT E. KREHBIEL, COMMISSIONER

MICHAEL C. MOFFET, COMMISSIONER

NOTICE TO OPERATORS DRILLING IN THE PANOMA- COUNCIL GROVE GAS POOL SPACED AREA

The enclosed intent is located within the Panoma-Council Grove gas pool space area. In May 1978, Panoma-Council Grove Proration Order (as amended), Docket No. 60,024-C (C-7058) under FINDINGS OF FACT AND LAW on page 31, the following language is stated that:

“The Commission finds that in order to prevent waste and protect correlative rights, the following stated rules pertaining to wells already completed, in the process of being drilled or for future wells to be drilled in the Panoma Council Grove Gas Pool Spaced area, and for wells producing from the Council Grove Formation outside of the Panoma Council Grove Gas Pool Spaced area within the Hugoton Gas Field, should be adopted.”

1. “No dual completions between the Chase (Hugoton) and Council Grove Formations will be permitted for future wells drilled.”
2. “Casing shall not be set above the top of the Council Grove Formation for a Council Grove producing well.”
3. “The production casing of all new Council Grove wells should be cemented with a calculated volume of cement sufficient to encase the casing from the bottom of the casing to a point 500 feet above the Chase Formation.”
4. “The casing shall be encased in cement in the interval between the base of the Council Grove and the top of the Chase Formation on all wells, irrespective of depth, completed below the Council Grove Formation, if they are located within the space area.”
5. “The cement coverage heretofore required shall be confirmed by the running of a recognized survey, such as a temperature survey or cement bond log.”

A copy of this survey and the cement tickets(s) showing that all cement work has been completed, must be filed with the ACO-1 Completion Report within 120 days from the wells “spud date.”

Failure to comply with these provisions may cause the well to be shut-in until compliance has been achieved.

If you have any questions, please feel free to contact the Conservation Division’s Production Department at (316) 337-6200.