

STATE CORPORATION COMMISSION OF KANSAS  
OIL & GAS CONSERVATION DIVISION  
WELL COMPLETION OR RECOMPLETION FORM  
ACO-1 WELL HISTORY  
DESCRIPTION OF WELL AND LEASE

API No. 15-... 065-22-367-00-00  
County... Graham  
SE NE SW Sec. 13 Twp. 7S Rge. 21 East West

Operator: License # 52673  
Name K & E Petroleum, Inc  
Address 100 S. Main, Ste. 300  
City/State/Zip Wichita, KS 67202

1650 Ft North from Southeast Corner of Section  
2970 Ft West from Southeast Corner of Section  
(Note: Locate well in section plat below)

Purchaser N/A

Lease Name Brin Well # 1

Field Name Wildcat

Operator Contact Person Wayne L. Brinegar  
Phone 316-264-4301

Producing Formation N/A

Elevation: Ground 2106' KB 2111'

Contractor: License # 5422  
Name Abercrombie Drilling, Inc

Wellsite Geologist Tim Priest  
Phone 316-264-4301

Designate Type of Completion  
X New Well Re-Entry Workover  
Oil SWD Temp Abd  
Gas Inj Delayed Comp.  
X Dry Other (Core, Water Supply etc.)

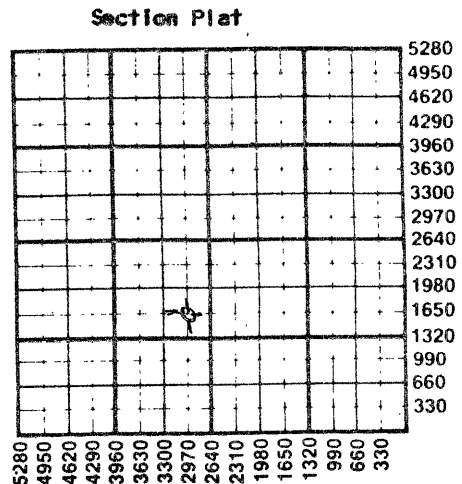

If OWNO: old well info as follows:  
Operator  
Well Name N/A  
Comp. Date Old Total Depth

WATER SUPPLY INFORMATION

Disposition of Produced Water: Disposal  
Docket # Repressuring

WELL HISTORY

Drilling Method:  
Mud Rotary Air Rotary Cable  
4/28/87 5/3/87 5/3/87  
Spud Date Date Reached TD Completion Date  
3630' N/A  
Total Depth PBT

Amount of Surface Pipe Set and Cemented at 243 feet  
Multiple Stage Cementing Collar Used? Yes X No  
If yes, show depth set... feet  
If alternate 2 completion, cement circulated from... feet depth to... w/... SX cmt  
Cement Company Name N/A  
Invoice #

Questions on this portion of the ACO-1 call:  
Water Resources Board (913) 296-3717

Source of Water:  
Division of Water Resources Permit #

Groundwater... Ft North from Southeast Corner (Well) ... Ft West from Southeast Corner of Sec Twp Rge East West

X Surface Water... 330 Ft North from Southeast Corner (Stream, pond etc.) 990 Ft West from Southeast Corner Sec 13 Twp 7S Rge 21 East X West

X Other (explain)... Larry Hanel (purchased from city, R.W.D. #)

INSTRUCTIONS: This form shall be completed in triplicate and filed with the Kansas Corporation Commission, 200 Colorado Derby Building, Wichita, Kansas 67202, within 120 days of the spud date of any well. Rule 82-3-130, 82-3-107 and 82-3-106 apply. Information on side two of this form will be held confidential for a period of 12 months if requested in writing and submitted with the form. See rule 82-3-107 for confidentiality in excess of 12 months. One copy of all wireline logs and drillers time log shall be attached with this form. Submit CP-4 form with all plugged wells. Submit CP-111 form with all temporarily abandoned wells.

All requirements of the statutes, rules and regulations promulgated to regulate the oil and gas industry have been fully complied with and the statements herein are complete and correct to the best of my knowledge.

Signature Wayne L. Brinegar  
Title Vice President Date 5/6/87

Subscribed and sworn to before me this 6th day of May 1987  
Notary Public Bonnie J. Holcomb  
Date Commission Expires 12/23/89

K.C.C. OFFICE USE ONLY  
F Letter of Confidentiality Attached  
C Wireline Log Received  
C Drillers Timelog Received  
Distribution  
KCC SWD/Rep NGPA  
KGS Plug Other (Specify)

BONNIE J. HOLCOMB  
NOTARY PUBLIC  
STATE OF KANSAS  
My Appt. Exp. 12/23/89

5/7/87 MAY 7 1987

SIDE TWO

Operator Name K & E Drilling, Inc. Lease Name Brin Well # 1

Sec. 13 Twp. 7S Rge. 21  East  West County Graham

WELL LOG

INSTRUCTIONS: Show important tops and base of formations penetrated. Detail all cores. Report all drill stem tests giving interval tested, time tool open and closed, flowing and shut-in pressures, whether shut-in pressure reached static level, hydrostatic pressures, bottom hole temperature, fluid recovery, and flow rates if gas to surface during test. Attach extra sheet if more space is needed. Attach copy of log.

Drill Stem Tests Taken  Yes  No  
 Samples Sent to Geological Survey  Yes  No  
 Cores Taken  Yes  No

Formation Description  
 Log  Sample

DST #1 (3303-3338') 30/30/30/30  
 Rec. 10' Mud  
 FPs: 42-42#/42-42#  
 SIPs: 105#/63#  
 HPs: 1626#/1615#  
 BHT: 106°

DST #2 (3366-3392') 30/30/30/30  
 Rec. 3' Mud w/show oil.  
 FPs: 31-31#/31-31#  
 SIPs: 31#/31#  
 HPs: 1678#/1657#  
 BHT: 106°

Name	Top	Bottom
Anhydrite	1708'	+403'
B/Anhydrite	1732'	+379'
Topeka	3095'	-984'
Queen Hill	3252'	-1141'
Oread	3258'	-1147'
Heebner	3306'	-1195'
Toronto	3333'	-1222'
Lansing	3345'	-1234'
Muncie Crk.	3460'	-1249'
BKC	3540'	-1429'
Arbuckle	3578'	-1467'
TD	3632'	-1521'

CASING RECORD <input checked="" type="checkbox"/> New <input type="checkbox"/> Used Report all strings set-conductor, surface, intermediate, production, etc.							
Purpose of String	Size Hole Drilled	Size Casing Set (in O.D.)	Weight Lbs/Ft.	Setting Depth	Type of Cement	#Sacks Used	Type and Percent Additives
Surface	12 1/4	8-5/8"	20#	243'	common	170	2%gel/3%cc.
PERFORATION RECORD				Acid, Fracture, Shot, Cement Squeeze Record			
Shots Per Foot	Specify Footage of Each Interval Perforated			(Amount and Kind of Material Used)		Depth	
N/A				N/A			
TUBING RECORD		Size	Set At	Packer at	Liner Run	<input type="checkbox"/> Yes <input type="checkbox"/> No	
N/A							
Date of First Production	Producing Method						
N/A	<input type="checkbox"/> Flowing <input type="checkbox"/> Pumping <input type="checkbox"/> Gas Lift <input type="checkbox"/> Other (explain).....						
Estimated Production Per 24 Hours	Oil	Gas	Water	Gas-Oil Ratio	Gravity		
	Bbls	MCF	Bbls	CFPB			

METHOD OF COMPLETION

Production Interval

Disposition of gas:  Vented  Open Hole  Perforation  Sold  Other (Specify) .....  Used on Lease  Dually Completed  Commingled

dry hole  
.....  
.....