

STATE CORPORATION COMMISSION OF KANSAS
OIL & GAS CONSERVATION DIVISION
WELL COMPLETION OR RECOMPLETION FORM
ACO-1 WELL HISTORY
DESCRIPTION OF WELL AND LEASE

S

API NO. 15-065-22,328 0000
County Graham
NW SW SE Sec. 13 Twp 7 Rge. 21 East West

Operator: License # 5266
Name K & E Drilling on behalf of K & E
Address Petroleum, Inc.
100 S. Main, Ste. 300
City/State/Zip Wichita, KS 67202

990'
2310' Ft North from Southeast Corner of Section
2310' Ft West from Southeast Corner of Section
(Note: Locate well in section plat below)

Purchaser Koch Oil Company
Wichita, KS

Lease Name Hamel Well # 1

Field Name Wildcat LesAge, West

Operator Contact Person Wayne L. Brinegar
Phone 316-264-4301

Producing Formation Toronto/Lansing "B"

Elevation: Ground 2103 KB 2108

Contractor: License # 5422
Name Abercrombie Drilling, Inc.

Wellsite Geologist Tim Priest
Phone 316-264-4301

Designate Type of Completion
X New Well Re-Entry Workover
X Oil SWD Temp Abd
Gas Inj Delayed Comp.
Dry Other (Core, Water Supply etc.)

If ONWO: old well info as follows:
Operator N/A
Well Name
Comp. Date Old Total Depth

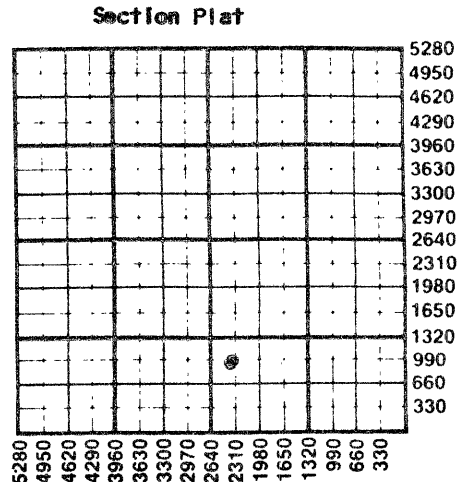

WATER SUPPLY INFORMATION
Disposition of Produced Water: Disposal
Docket # D-24,900 (Pending) Repressuring

WELL HISTORY

Drilling Method: X Mud Rotary Air Rotary Cable
10-9-86 10-17-86 11-17-86
Spud Date Date Reached TD Completion Date
3620' 3395'
Total Depth PBTD

Amount of Surface Pipe Set and Cemented at 256' feet
Multiple Stage Cementing Collar Used? X Yes No
If yes, show depth set 1617 feet
If alternate 2 completion, cement circulated from 1617 feet depth to surface 325' cmt
Cement Company Name Allied Cementing
Invoice # 47587

Questions on this portion of the ACO-1 call:
Water Resources Board (913) 296-3717
Source of Water:
Division of Water Resources Permit #
Groundwater Ft North from Southeast Corner (Well) Ft West from Southeast Corner of Sec Twp Rge East West
X Surface Water 3300 Ft North from Southeast Corner (Stream, pond etc) 3300 Ft West from Southeast Corner Rooks Co. Sec 27 Twp 7S Rge 20 East West
Other (explain) Eugene Hamel (purchased from city, R.W.D. #)

INSTRUCTIONS: This form shall be completed in triplicate and filed with the Kansas Corporation Commission, 200 Colorado Derby Building, Wichita, Kansas 67202, within 120 days of the spud date of any well. Rule 82-3-130, 82-3-107 and 82-3-106 apply. Information on side two of this form will be held confidential for a period of 12 months if requested in writing and submitted with the form. See rule 82-3-107 for confidentiality in excess of 12 months. One copy of all wireline logs and drillers time log shall be attached with this form. Submit CP-4 form with all plugged wells. Submit CP-111 form with all temporarily abandoned wells.

All requirements of the statutes, rules and regulations promulgated to regulate the oil and gas industry have been fully complied with and the statements herein are complete and correct to the best of my knowledge.

Signature Wayne L. Brinegar
Title President, K & E Drilling, Inc. Date 12/1/86

Subscribed and sworn to before me this 1st day of December 1986
Notary Public Bonnie J. Holcomb

Date Commission Expires 12/23/89

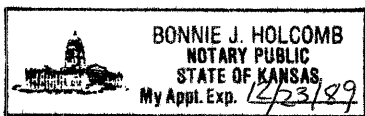

K.C.C. OFFICE USE ONLY
F Letter of Confidentiality Attached
C Wireline Log Received
C Drillers Timelog Received
Distribution
X KCC SWD/Rep NGPA
X KGS Plug Other (Specify)

STATE CORPORATION COMMISSION

DEC 2 1986

Form ACO-1 (5-86)

CONSERVATION DIVISION
Wichita, Kansas

12/2/86

Sec 13, Twp 7, Rge 21

SIDE TWO

Operator Name K & E Drilling on behalf of Lease Name Hamel Well # 1
K & E Petroleum, Inc.

Sec. 13 Twp. 7S Rge. 21 East West County Graham County, Kansas

WELL LOG

INSTRUCTIONS: Show important tops and base of formations penetrated. Detail all cores. Report all drill stem tests giving interval tested, time tool open and closed, flowing and shut-in pressures, whether shut-in pressure reached static level, hydrostatic pressures, bottom hole temperature, fluid recovery, and flow rates if gas to surface during test. Attach extra sheet if more space is needed. Attach copy of log.

Drill Stem Tests Taken Yes No
 Samples Sent to Geological Survey Yes No
 Cores Taken Yes No

Formation Description
 Log Sample

	Name	Top	Bottom
#1 (3233-3255) 45/60/45/60 Rec. 567' Wtr, 31'M, C1 45,580. FPs: 19-169#/169-300# SIPs: 877#/877#. HP 1621#/1621#. BHT 89°	Anhydrite	1697'	+411'
	B/Anhydrite	1730'	+378'
#2 (3285-3322) 45/60/45/60 Rec. 125' 0(36°@66°), 30' OCM (20%O,80%M), FPs: 38-56#/56-75#. SIPs: 1100#/1100#, HP 1658#/1639# BHT 100°	Topeka	3083'	-975'
	Heebner	3291'	-1183'
	Toronto	3313'	-1205'
	Lansing	3328'	-1220'
	Muncie Crk	3445'	-1337'
#3 (3320-3345) 45/60/75/90 Rec. 30' wtry M (50%W) and 120' W (72,000 C1) FPs: 40-50#/71-101#, SIPs: 1164#/1144#, HPs: 1720#/1700#, BHT: 124°	B/KC	3527'	-1419'
	Arbuckle	3569'	-1461'
	Granite Wash	3614'	-1506'
	TD	3620'	-1512'
#4 (3352-3380) 45/60/45/60 180' GIP, 1200' cIn gsy 0(39°@60°), 60' gsy OCM(30%O, 20%G,50%M). FPs: 71-325#/376-497#, SIPs: 1005#/986# HPs: 1720#/1710#, BHT: 121°			

DSTs continued on separate page.

CASING RECORD <input checked="" type="checkbox"/> New <input type="checkbox"/> Used							
Report all strings set-conductor, surface, intermediate, production, etc.							
Purpose of String	Size Hole Drilled	Size Casing Set (in O.D.)	Weight Lbs/Ft.	Setting Depth	Type of Cement	#Sacks Used	Type and Percent Additives
Surface	12 1/2"	8-5/8"	23#	256'	common	165	2%gel/3%cc
Production	7-7/8"	4-1/2"	10.5#	3620'	50/50poz Surefill	50 125	2%gel, 7 1/2#gil 4# gilsonite
PERFORATION RECORD				Acid, Fracture, Shot, Cement Squeeze Record			
Shots Per Foot	Specify Footage of Each Interval Perforated			(Amount and Kind of Material Used)		Depth	
4	3313'-3316'			500 gal 15% MCA		3313-16'	
4	3366'-3371'			750 gal 15% MCA		3366-71'	
TUBING RECORD				Liner Run <input type="checkbox"/> Yes <input checked="" type="checkbox"/> No			
Size 2-3/8"		Set At 3392'		Packer at none			
Date of First Production	Producing Method						
11/17/86	<input type="checkbox"/> Flowing <input checked="" type="checkbox"/> Pumping <input type="checkbox"/> Gas Lift <input type="checkbox"/> Other (explain).....						
Estimated Production Per 24 Hours	Oil	Gas	Water	Gas-Oil Ratio	Gravity		
	95 Bbls	nil MCF	10 Bbls	x	CFPB		

METHOD OF COMPLETION

Production Interval

Disposition of gas: Vented Open Hole Perforation 3313'-3371' O.A.
 Sold Other (Specify)
 Used on Lease Dually Completed
 Commingled

ATTACHMENT TO SIDE TWO
ACO-1 AFFIDAVIT OF WELL COMPLETION

Operator Name K & E Drilling on behalf of Lease Name Hamel Well # 1
K & E Petroleum, Inc.

Sec. 13 Twp 7S Rge 21 West County Graham County, Kansas

Drill Stem Tests Continued

#5 (3378-3415)45/60/45/60

Rec. 1370' fluid: 10' O, 160' OC Wtry Mud (5%O, 40%W, 55%M), 480' OC Wtr (3% Oil),
720' wtr w/scum oil (C1 66,000).

FPs: 132-517#/557-677#

SIPs: 856#/856#

HPs: 1740#/1720#

BHT: 106°

#6 (3439-3529)45/60/75/90

Rec. 40' O (38°@60°F), 30' MCO (50%O, 50%M), 60' OCM (20%O, 80%M), 120' SOC thin mud
(5%O, 2%W, 93%M) (C1 25,000).

FPs: 40-81#/111-142#

SIPs: 1065#/1015#

HPs: 1769#/1750#

BHT: 108°

#7 (3549-3575)30/30/30/30

Rec. 10' oil spkd mud.

FPs: 40-40#/40-40#

SIPs: 50#/40#

HPs: 1821#/1799#

BHT: 109°

#8 (3571-3582)Packer failure

#9 (3549-3582)45/60/30/30

Rec. 15' OCM (5%O, 95%M).

FPs: 50-50#/50-50#

SIPs: 60#/50#

HPs: 1829#/1809#

BHT: 109°