

RECEIVED
 Aug 26, 2003
 AUG 26 2003
 KCC WICHITA

For KCC Use: 9.2-03
 Effective Date: _____
 District #: 4
 SGA? Yes No

KANSAS CORPORATION COMMISSION
 OIL & GAS CONSERVATION DIVISION
NOTICE OF INTENT TO DRILL

Form C-1
 December 2002
 Form must be Typed
 Form must be Signed
 All blanks must be Filled

Must be approved by KCC five (5) days prior to commencing well
 AP TO W OF

Expected Spud Date 8 25 2003
 month day year

Spot _____ East
 _____ West
 Sec. 26 Twp. 7 S. R. 21

OPERATOR: License# 9449
 Name: Great Eastern Energy and Development
 Address: Box 150
 City/State/Zip: Bogue Kansas 67625
 Contact Person: Mike Davignon
 Phone: 785 421 2346

500 feet from N / S Line of Section
 400 feet from E / W Line of Section
 Is SECTION Regular Irregular?

CONTRACTOR: License# 30606
 Name: Murfin Drig. Inc.

(Note: Locate well on the Section Plat on reverse side)
 County: Graham
 Lease Name: Alexander Well #: 4
 Field Name: _____

Well Drilled For:	Well Class:	Type Equipment:
<input checked="" type="checkbox"/> Oil	<input type="checkbox"/> Enh Rec	<input type="checkbox"/> Infield
<input type="checkbox"/> Gas	<input type="checkbox"/> Storage	<input type="checkbox"/> Pool Ext.
<input type="checkbox"/> OWWO	<input type="checkbox"/> Disposal	<input checked="" type="checkbox"/> Wildcat
<input type="checkbox"/> Seismic; # of Holes _____	<input type="checkbox"/> Other	<input type="checkbox"/> Cable
<input type="checkbox"/> Other _____		

Is this a Prorated / Spaced Field? Yes No
 Target Information(s): Granite
 Nearest Lease or unit boundary: 400

* Ground Surface Elevation: 2070 feet MSL
 Water well within one-quarter mile: Yes No
 Public water supply well within one mile: Yes No

Depth to bottom of fresh water: 150
 Depth to bottom of usable water: 1000 1100
 Surface Pipe by Alternate: 1 2

If OWWO: old well information as follows:
 Operator: _____
 Well Name: _____
 Original Completion Date: _____ Original Total Depth: _____

Length of Surface Pipe Planned to be set: 200
 Length of Conductor Pipe required: 0 NONE (See Note)
 Projected Total Depth: 3750
 Formation at Total Depth: Granite

Directional, Deviated or Horizontal wellbore? Yes No
 If Yes, true vertical depth: _____
 Bottom Hole Location: _____
 KCC DKT #: _____

Water Source for Drilling Operations:
 Well Farm Pond Other X
 DWR Permit #: _____
 (Note: Apply for Permit with DWR)

* Conductor Pipe required if Elevation of Location is below 2000' MSL

Will Cores be taken? Yes No
 If Yes, proposed zone: _____

AFFIDAVIT

The undersigned hereby affirms that the drilling, completion and eventual plugging of this well will comply with K.S.A. 55 et. seq.
 It is agreed that the following minimum requirements will be met:

1. Notify the appropriate district office **prior** to spudding of well;
2. A copy of the approved notice of intent to drill **shall be posted** on each drilling rig;
3. The minimum amount of surface pipe as specified below **shall be set** by circulating cement to the top; in all cases surface pipe **shall be set** through all unconsolidated materials plus a minimum of 20 feet into the underlying formation.
4. If the well is dry hole, an agreement between the operator and the district office on plug length and placement is necessary **prior to plugging**;
5. The appropriate district office will be notified before well is either plugged or production casing is cemented in;
6. If an ALTERNATE II COMPLETION, production pipe shall be cemented from below any usable water to surface within **120 days** of spud date. Or pursuant to Appendix "B" - Eastern Kansas surface casing order #133,891-C, which applies to the KCC District 3 area, alternate II cementing must be completed within 30 days of the spud date or the well shall be plugged. **In all cases, NOTIFY district office** prior to any cementing.

I hereby certify that the statements made herein are true and to the best of my knowledge and belief.

Date: 8-25-03 Signature of Operator or Agent: _____ Title: Agent

For KCC Use ONLY

API # 15 - 065-22933.00-00

Conductor pipe required NONE feet

Minimum surface pipe required 200 feet per Alt. * (2)

Approved by: RJP 8-28-03

This authorization expires: 2-28-04
 (This authorization void if drilling not started within 6 months of effective date.)

Spud date: _____ Agent: _____

Remember to:

- File Drill Pit Application (form CDP-1) with Intent to Drill;
- File Completion Form ACO-1 within 120 days of spud date;
- File acreage attribution plat according to field proration orders;
- Notify appropriate district office 48 hours prior to workover or re-entry;
- Submit plugging report (CP-4) after plugging is completed;
- Obtain written approval before disposing or injecting salt water.

- If this permit has expired (See: authorized expiration date) please check the box below and return to the address below.

Well Not Drilled - Permit Expired
 Signature of Operator or Agent: _____
 Date: _____

26
 7
 2/1

IN ALL CASES PLOT THE INTENDED WELL ON THE PLAT BELOW

Plat of acreage attributable to a well in a prorated or spaced field

If the intended well is in a prorated or spaced field, please fully complete this side of the form. If the intended well is in a prorated or spaced field complete the plat below showing that the well will be properly located in relationship to other wells producing from the common source of supply. Please show all the wells and within 1 mile of the boundaries of the proposed acreage attribution unit for gas wells and within 1/2 mile of the boundaries of the proposed acreage attribution unit for oil wells.

API No. 15 - _____
Operator: Great Eastern Energy and Development
Lease: Alexander
Well Number: 4
Field: _____
Number of Acres attributable to well: _____
QTR / QTR / QTR of acreage: _____

Location of Well: County: Graham
500 feet from [X] N / [] S Line of Section
400 feet from [X] E / [] W Line of Section
Sec. 26 Twp. 7 S. R. 21 [] East [X] West

Is Section: [X] Regular or [] Irregular

If Section is Irregular, locate well from nearest corner boundary.

Section corner used: [] NE [] NW [] SE [] SW

PLAT

(Show location of the well and shade attributable acreage for prorated or spaced wells.)
(Show footage to the nearest lease or unit boundary line.)

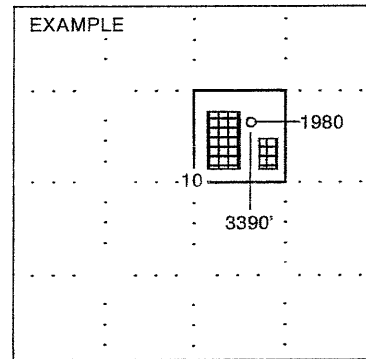
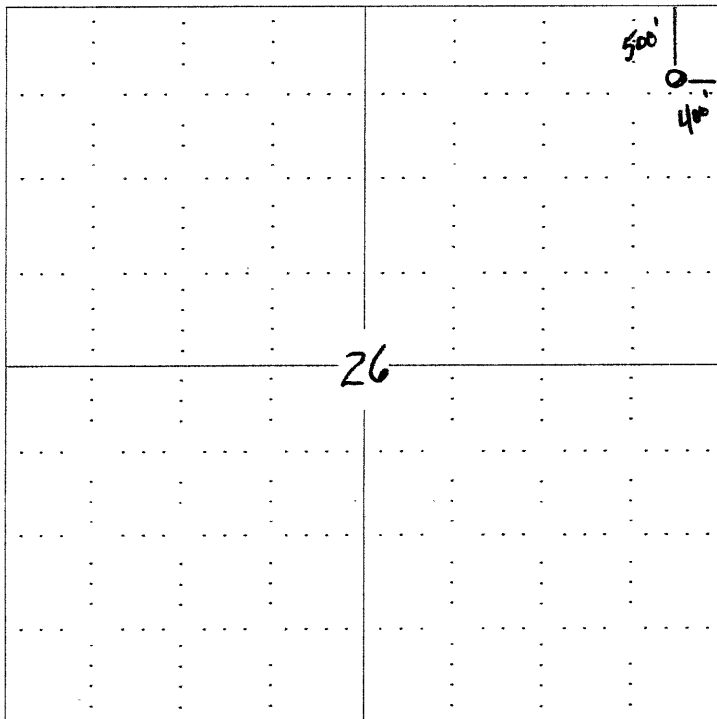

NOTE: In all cases locate the spot of the proposed drilling location.

In plotting the proposed location of the well, you must show:

- 1. The manner in which you are using the depicted plat by identifying section lines, i.e. 1 section, 1 section with 8 surrounding sections, 4 sections, etc.
2. The distance of the proposed drilling location from the section's south / north and east / west.
3. The distance to the nearest lease or unit boundary line.
4. If proposed location is located within a prorated or spaced field a certificate of acreage attribution plat must be attached: (CO-7 for oil wells; CG-8 for gas wells).