

RECEIVED
JAN 13 2003
JAN 13 2003

Form C-1
December 2002
Form must be Typed
Form must be Signed
All blanks must be Filled

For KCC Use:
Effective Date: 1-18-03
District # 4
SGA? Yes No

KANSAS CORPORATION COMMISSION
OIL & GAS CONSERVATION DIVISION
NOTICE OF INTENT TO DRILL

Must be approved by KCC five (5) days prior to commencing well

KCC WICHITA

Ap 160 3 of

Expected Spud Date 1-20-2003
month day year

Spot S12SW-SW-NE
Sec. 25 Twp. 7S S. R. 21
 East West

OPERATOR: License# 9449
Name: GREAT EASTERN ENERGY AND DEVELOPMENT CORP.
Address: BOX 150
City/State/Zip: BOGUE KANSAS 67625
Contact Person: MIKE DAVIGNON
Phone: 785 623-7520

2605 feet from N / S Line of Section
2310 feet from E / W Line of Section
Is SECTION Regular Irregular?

(Note: Locate well on the Section Plat on reverse side)

CONTRACTOR: License# 30606
Name: MURFIN DRILG. Co., Inc

County: GRAHAM
Lease Name: JONES UNIT Well #: 1
Field Name: _____

Well Drilled For: Oil Gas OWD Seismic; # of Holes _____
 Enh Rec Storage Disposal
Well Class: Infield Pool Ext. Wildcat Other _____
Type Equipment: Mud Rotary Air Rotary Cable

Is this a Prorated / Spaced Field? Yes No
Target Information(s): GRANITE
Nearest Lease or unit boundary: 330' +/-
Ground Surface Elevation: 2095EST feet MSL
Water well within one-quarter mile: Yes No
Public water supply well within one mile: Yes No
Depth to bottom of fresh water: 150
Depth to bottom of usable water: 1050

If OWWO: old well information as follows:
Operator: _____
Well Name: _____
Original Completion Date: _____ Original Total Depth: _____

Surface Pipe by Alternate: 1 2
Length of Surface Pipe Planned to be set: 235
Length of Conductor Pipe required: 0 NONE
Projected Total Depth: 3800
Formation at Total Depth: GRANITE

Directional, Deviated or Horizontal wellbore? Yes No
If Yes, true vertical depth: _____
Bottom Hole Location: _____
KCC DKT #: _____

Water Source for Drilling Operations:
 Well Farm Pond Other _____
DWR Permit #: _____

(Note: Apply for Permit with DWR)

Will Cores be taken? Yes No
If Yes, proposed zone: _____

* Pooling Agreement for NE 1/4 of 25

AFFIDAVIT

The undersigned hereby affirms that the drilling, completion and eventual plugging of this well will comply with K.S.A. 55 et. seq.
It is agreed that the following minimum requirements will be met:
1. Notify the appropriate district office **prior** to spudding of well;
2. A copy of the approved notice of intent to drill **shall be** posted on each drilling rig;
3. The minimum amount of surface pipe as specified below **shall be set** by circulating cement to the top; in all cases surface pipe **shall be set** through all unconsolidated materials plus a minimum of 20 feet into the underlying formation.
4. If the well is dry hole, an agreement between the operator and the district office on plug length and placement is necessary **prior to plugging**;
5. The appropriate district office will be notified before well is either plugged or production casing is cemented in;
6. If an ALTERNATE II COMPLETION, production pipe shall be cemented from below any usable water to surface within **120 days** of spud date.
Or pursuant to Appendix "B" - Eastern Kansas surface casing order #133,891-C, which applies to the KCC District 3 area, alternate II cementing must be completed within 30 days of the spud date or the well shall be plugged. **In all cases, NOTIFY district office** prior to any cementing.

* CONDUCTOR PIPE REQUIRED IF ELEVATION IS LESS THAN 2000' MSL

I hereby certify that the statements made herein are true and to the best of my knowledge and belief.

Date: 1-10-03 Signature of Operator or Agent: [Signature] Title: AGENT

For KCC Use ONLY
API # 15 - 065-22872-00-00
Conductor pipe required NONE feet
Minimum surface pipe required 200 feet per Alt. (2)
Approved by: RJP 1-13-03
This authorization expires: 7-13-03
(This authorization void if drilling not started within 6 months of effective date.)
Spud date: _____ Agent: _____

Remember to:
- File Drill Pit Application (form CDP-1) with Intent to Drill;
- File Completion Form ACO-1 within 120 days of spud date;
- File acreage attribution plat according to field proration orders;
- Notify appropriate district office 48 hours prior to workover or re-entry;
- Submit plugging report (CP-4) after plugging is completed;
- Obtain written approval before disposing or injecting salt water.
- If this permit has expired (See: authorized expiration date) please check the box below and return to the address below.
 Well Not Drilled - Permit Expired
Signature of Operator or Agent: _____
Date: _____

25
7
21W

RECEIVED

JAN 13 2003

JAN 13 2003 KCC WICHITA

Side Two

IN ALL CASES PLOT THE INTENDED WELL ON THE PLAT BELOW

Plat of acreage attributable to a well in a prorated or spaced field

If the intended well is in a prorated or spaced field, please fully complete this side of the form. If the intended well is in a prorated or spaced field complete the plat below showing that the well will be properly located in relationship to other wells producing from the common source of supply. Please show all the wells and within 1 mile of the boundaries of the proposed acreage attribution unit for gas wells and within 1/2 mile of the boundaries of the proposed acreage attribution unit for oil wells.

API No. 15 - _____
Operator: GREAT EASTERN ENERGY AND DEVELOPMENT
Lease: JONES UNIT
Well Number: 1
Field: _____
Number of Acres attributable to well: _____
QTR / QTR / QTR of acreage: _____

Location of Well: County: GRAHAM
2605 feet from N / S Line of Section
2310 feet from E / W Line of Section
Sec. 25 Twp. 7S S. R. 21 East West
Is Section: Regular or Irregular

If Section is Irregular, locate well from nearest corner boundary.
Section corner used: NE NW SE SW

PLAT

*(Show location of the well and shade attributable acreage for prorated or spaced wells.)
(Show footage to the nearest lease or unit boundary line.)*

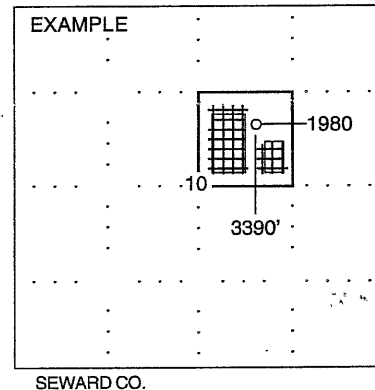
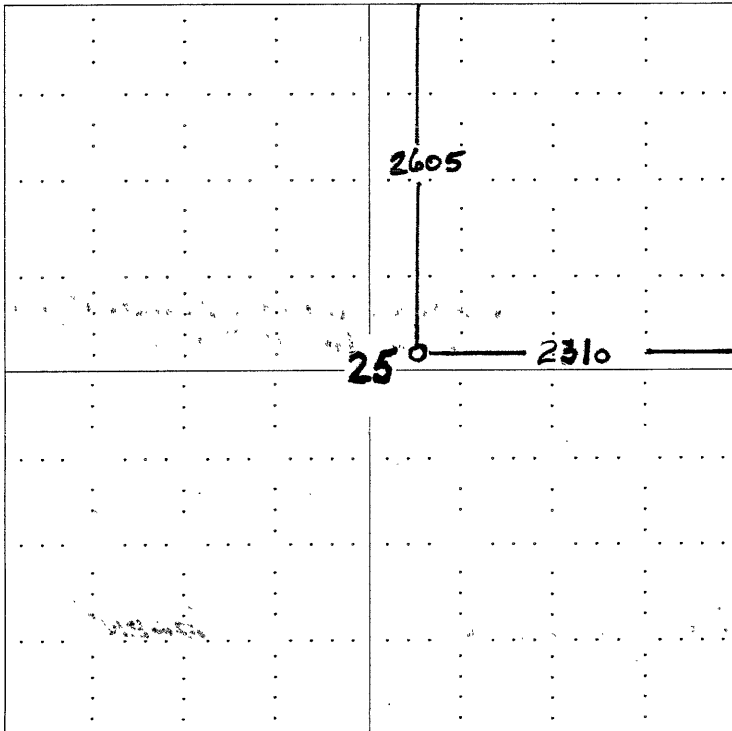

NOTE: In all cases locate the spot of the proposed drilling location.

In plotting the proposed location of the well, you must show:

1. The manner in which you are using the depicted plat by identifying section lines, i.e. 1 section, 1 section with 8 surrounding sections, 4 sections, etc.
2. The distance of the proposed drilling location from the section's south / north and east / west.
3. The distance to the nearest lease or unit boundary line.
4. If proposed location is located within a prorated or spaced field a certificate of acreage attribution plat must be attached: (CG-7 for oil wells; CG-8 for gas wells).