

FOR KCC USE:

EFFECTIVE DATE: 8-13-91

DISTRICT # 4

SGA? Yes X No

State of Kansas

NOTICE OF INTENTION TO DRILL

Must be approved by the K.C.C. five (5) days prior to commencing well

FORM C-1 7/91

FORM MUST BE TYPED

FORM MUST BE SIGNED

ALL BLANKS MUST BE FILLED

P.U.

Expected Spud Date 8 month 17 day 91 year

Spot SE NW Sec 25 Twp 7 S, Rg 21 East West

OPERATOR: License # 30029 Name: Standard Operating Company, Inc. Address: One Main Place, Suite 910 City/State/Zip: Wichita, KS 67202 Contact Person: Dave Pauly Phone: 316-264-0490

3300' FSL feet from South / North line of Section 3300' FEL feet from East / West line of Section

IS SECTION REGULAR IRREGULAR? (NOTE: Locate well on the Section Plat on Reverse Side) County: Graham

CONTRACTOR: License # 30684 Name: Abercrombie RTD, Inc.

Lease Name: Alexander Well #: #1 Field Name: unknown

Well Drilled For: Well Class: Type Equipment: Oil Enh-Rec Infield Mud Rotary Gas Storage Pool Ext Air Rotary DWMO Disposal Wildcat Cable Seismic # of Holes Other

Is this a Prorated/Spaced Field? yes X no Target Formation(s): Arbuckle

If DWMO: old well information as follows: Operator: N/A Well Name: Comp. Date: Old Total Depth

Nearest lease or unit boundary: 660' Ground Surface Elevation: unknown feet MSL Water well within one-quarter mile: yes X no

Directional, Deviated or Horizontal wellbore? yes X no If yes, true vertical depth: N/A Bottom Hole Location

Public water supply well within one mile: yes X no Depth to bottom of fresh water: 120' Depth to bottom of usable water: 1150'

Surface Pipe by Alternate: 1 X 2 Length of Surface Pipe Planned to be set: 225' Length of Conductor pipe required: None

Projected Total Depth: 3650' Formation at Total Depth: Arbuckle

Water Source for Drilling Operations: well X farm pond other DWR Permit #: will file

Will Cores Be Taken?: yes X no If yes, proposed zone: N/A

AFFIDAVIT

The undersigned hereby affirms that the drilling, completion and eventual plugging of this well will comply with K.S.A. 55-101, et. seq. It is agreed that the following minimum requirements will be met:

- 1. Notify the appropriate district office prior to spudding of well; 2. A copy of the approved notice of intent to drill shall be posted on each drilling rig; 3. The minimum amount of surface pipe as specified below shall be set by circulating cement to the top; in all cases surface pipe shall be set through all unconsolidated materials plus a minimum of 20 feet into the underlying formation; 4. If the well is dry hole, an agreement between the operator and the district office on plug length and placement is necessary prior to plugging; 5. The appropriate district office will be notified before well is either plugged or production casing is cemented in; 6. IF AN ALTERNATE II COMPLETION, PRODUCTION PIPE SHALL BE CEMENTED FROM BELOW ANY USABLE WATER TO SURFACE WITHIN 120 DAYS OF SPUD DATE. IN ALL CASES, NOTIFY DISTRICT OFFICE PRIOR TO ANY CEMENTING.

I hereby certify that the statements made herein are true and to the best of my knowledge and belief Date: Signature of Operator or Agent: Title: Exec. Vice Pres.



FOR KCC USE: API # 15-065-22,646-00-00 Conductor pipe required None feet Minimum surface pipe required 300 feet per Alt. (2) Approved by: 8-8-91 This authorization expires: 2-8-92 (This authorization void if drilling not started within 6 months of effective date.) Spud date: Agent:

RECEIVED STATE CORPORATION COMMISSION AUG 8 1991 AUG 8 1991 CONSERVATION DIVISION Wichita, Kansas

REMEMBER TO:

- File Drill Pit Application (form CDP-1) with Intent to Drill; - File Completion Form ACO-1 within 120 days of spud date; - File acreage attribution plat according to field proration orders; - Notify appropriate district office 48 hours prior to workover or re-entry; - Submit plugging report (CP-4) after plugging is completed; - Obtain written approval before disposing or injecting salt water.

Mail to: Conservation Division, 200 Colorado Derby Building, 202 W. First St., Wichita, Kansas 67202-1286.

Handwritten initials and marks on the right margin.

IN ALL CASES PLOT THE INTENDED WELL ON THE PLAT BELOW

PLAT OF ACREAGE ATTRIBUTABLE TO A WELL IN A PRORATED OR SPACED FIELD

If the intended well is in a prorated or spaced field, please fully complete this side of the form. If the intended well is in a prorated or spaced field complete the plat below showing that the well will be properly located in relationship to other wells producing from the common source of supply. Please show all the wells within 1 mile of the boundaries of the proposed acreage attribution unit for gas wells and within 1/2 mile of the boundaries of the proposed acreage attribution unit for oil wells.

API NO. 15- _____
 OPERATOR Standard Operating Company, Inc.
 LEASE Alexander
 WELL NUMBER #1
 FIELD unknown

LOCATION OF WELL: COUNTY Graham
 3300' _____ feet from south/~~north~~ line of section
 3300' _____ feet from east/~~west~~ line of section
 SECTION 25 TWP 7S RG 21W

NUMBER OF ACRES ATTRIBUTABLE TO WELL _____
 QTR/QTR/QTR OF ACREAGE _____

IS SECTION REGULAR or _____ IRREGULAR
 IF SECTION IS IRREGULAR, LOCATE WELL FROM NEAREST
CORNER BOUNDARY.

Section corner used: _____ NE _____ NW _____ SE _____ SW

PLAT

(Show location of the well and shade attributable acreage for prorated or spaced wells.)
 (Show footage to the nearest lease or unit boundary line.)

R 21 W

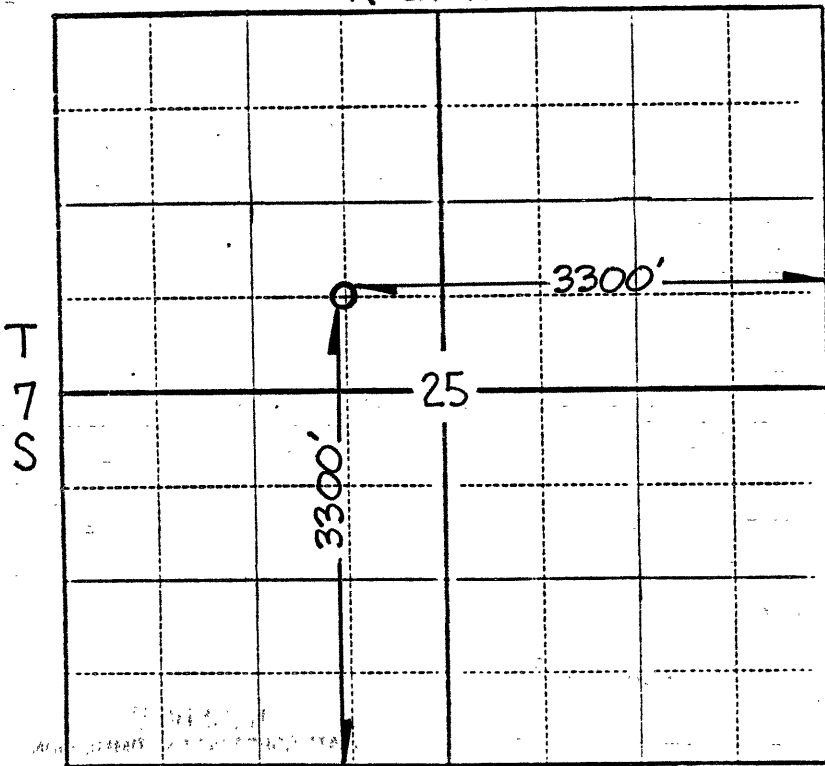

GRAHAM COUNTY

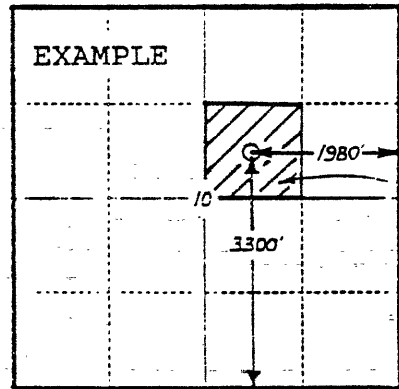

SEWARD CO.



In plotting the proposed location of the well, you must show:

- 1) The manner in which you are using the depicted plat by identifying section lines, i.e. 1 section, 1 section with 8 surrounding sections, 4 sections, etc.;
- 2) the distance of the proposed drilling location from the section's south/north and east/west lines; and
- 3) the distance to the nearest lease or unit boundary line.