

For KCC Use: 12.28.02
Effective Date: _____
District #: 4
SGA? Yes No

KANSAS CORPORATION COMMISSION
OIL & GAS CONSERVATION DIVISION
NOTICE OF INTENT TO DRILL

DEC 18, 2002

Form C-1
December 2002
Form must be Typed
Form must be Signed
All blanks must be Filled

Must be approved by KCC five (5) days prior to commencing well

AP 80'S $\frac{1}{4}$ 160' W

Expected Spud Date 1-27-03
month day year

OPERATOR: License# 9449
Name: Great Eastern Energy and Development Corp.
Address: Box 150
City/State/Zip: Bogue Kansas 67625
Contact Person: Mike Davignon
Phone: 785-623-7520

CONTRACTOR: License# 30606
Name: Murfin Drig. Co. Inc.

Well Drilled For:	Well Class:	Type Equipment:
<input checked="" type="checkbox"/> Oil	<input checked="" type="checkbox"/> Enh Rec	<input checked="" type="checkbox"/> Mud Rotary
<input type="checkbox"/> Gas	<input type="checkbox"/> Storage	<input type="checkbox"/> Air Rotary
<input type="checkbox"/> OWWO	<input type="checkbox"/> Disposal	<input type="checkbox"/> Cable
<input type="checkbox"/> Seismic; # of Holes	<input checked="" type="checkbox"/> Wildcat	
<input type="checkbox"/> Other	<input type="checkbox"/> Other	

Spot E/2 - SE - NE Sec. 23 Twp. 7 S. R. 21
 East
 West
2060 feet from N / S Line of Section
490 feet from E / W Line of Section
Is SECTION Regular Irregular?

(Note: Locate well on the Section Plat on reverse side)

County: GRAHAM
Lease Name: Alexander/Dowdell Well #: 1
Field Name: _____
Is this a Prorated / Spaced Field? Yes No
Target Information(s): GRANITE
Nearest Lease or unit boundary: 330
Ground Surface Elevation: 2100EST feet MSL
Water well within one-quarter mile: Yes No
Public water supply well within one mile: Yes No
Depth to bottom of fresh water: 150
Depth to bottom of usable water: 1000
Surface Pipe by Alternate: 1 2
Length of Surface Pipe Planned to be set: 230
Length of Conductor Pipe required: NONE
Projected Total Depth: 3800
Formation at Total Depth: Granite?
Water Source for Drilling Operations:
 Well Farm Pond Other
DWR Permit #: _____

If OWWO: old well information as follows:
Operator: _____
Well Name: _____
Original Completion Date: _____ Original Total Depth: _____
Directional, Deviated or Horizontal wellbore? Yes No
If Yes, true vertical depth: _____
Bottom Hole Location: _____
KCC DKT #: _____

* Special Surface Casing Requirements in Twp 7s-21w
for wells at > 2000' EL

AFFIDAVIT * Conductor Pipe Required if Elev. less than 2000'

The undersigned hereby affirms that the drilling, completion and eventual plugging of this well will comply with K.S.A. 55 et. seq.
It is agreed that the following minimum requirements will be met:

1. Notify the appropriate district office **prior** to spudding of well;
2. A copy of the approved notice of intent to drill **shall be** posted on each drilling rig;
3. The minimum amount of surface pipe as specified below **shall be set** by circulating cement to the top; in all cases surface pipe **shall be set** through all unconsolidated materials plus a minimum of 20 feet into the underlying formation.
4. If the well is dry hole, an agreement between the operator and the district office on plug length and placement is necessary **prior to plugging**;
5. The appropriate district office will be notified before well is either plugged or production casing is cemented in;
6. If an ALTERNATE II COMPLETION, production pipe shall be cemented from below any usable water to surface within **120 days** of spud date. Or pursuant to Appendix "B" - Eastern Kansas surface casing order #133,891-C, which applies to the KCC District 3 area, alternate II cementing must be completed within 30 days of the spud date or the well shall be plugged. **In all cases, NOTIFY district office** prior to any cementing.

I hereby certify that the statements made herein are true and to the best of my knowledge and belief.

Date: 12-16-02 Signature of Operator or Agent: [Signature] Title: AGENT

For KCC Use ONLY
API # 15 - 0605-22866-0000
Conductor pipe required NONE feet
Minimum surface pipe required 200 feet per Alt. * (2)
Approved by: RSP 12-23-02
This authorization expires: 6-23-03
(This authorization void if drilling not started within 6 months of effective date.)
Spud date: _____ Agent: _____

Remember to:
- File Drill Pit Application (form CDP-1) with Intent to Drill;
- File Completion Form ACO-1 within 120 days of spud date;
- File acreage attribution plat according to field proration orders;
- Notify appropriate district office 48 hours prior to workover or re-entry;
- Submit plugging report (CP-4) after plugging is completed;
- Obtain written approval before disposing or injecting salt water.
- If this permit has expired (See: authorized expiration date) please check the box below and return to the address below.
 Well Not Drilled - Permit Expired
Signature of Operator or Agent: _____
Date: _____

23
7
210

15-065-22866-00-00

15-065-22866-00-00

Side Two

IN ALL CASES PLOT THE INTENDED WELL ON THE PLAT BELOW

Plat of acreage attributable to a well in a prorated or spaced field

If the intended well is in a prorated or spaced field, please fully complete this side of the form. If the intended well is in a prorated or spaced field complete the plat below showing that the well will be properly located in relationship to other wells producing from the common source of supply. Please show all the wells and within 1 mile of the boundaries of the proposed acreage attribution unit for gas wells and within 1/2 mile of the boundaries of the proposed acreage attribution unit for oil wells.

API No. 15 - _____
Operator: GREAT EASTERN ENERGY AND DEVELOPMENT
Lease: Alexander/Dowdell
Well Number: 1
Field: _____
Number of Acres attributable to well: _____
QTR / QTR / QTR of acreage: _____ - _____ - _____

Location of Well: County: GRAHAM
2060 _____ feet from N / S Line of Section
490 _____ feet from E / W Line of Section
Sec. 23 Twp. 7 S. R. 21 East West

Is Section: Regular or Irregular

If Section is Irregular, locate well from nearest corner boundary.
Section corner used: NE NW SE SW

PLAT

*(Show location of the well and shade attributable acreage for prorated or spaced wells.)
(Show footage to the nearest lease or unit boundary line.)*

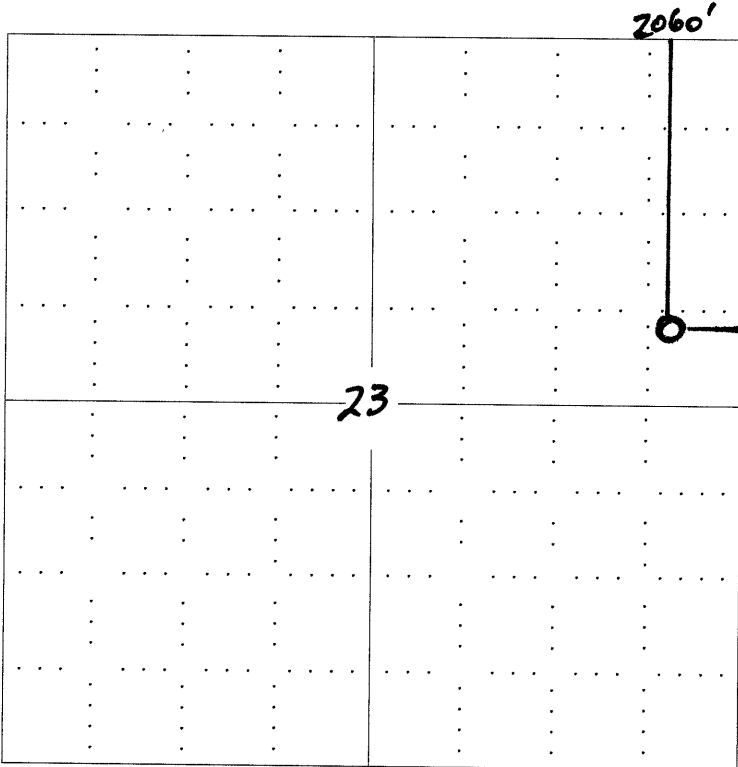

DEC 18, 2002
REGISTRATION
KSO 11/11/02

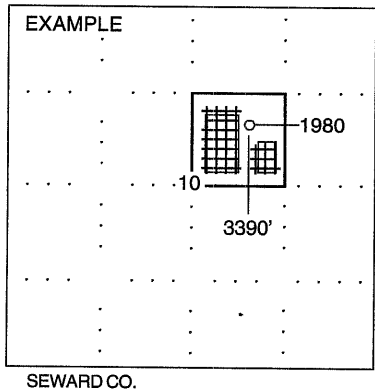

NOTE: In all cases locate the spot of the proposed drilling locaton.

In plotting the proposed location of the well, you must show:

1. The manner in which you are using the depicted plat by identifying section lines, i.e. 1 section, 1 section with 8 surrounding sections, 4 sections, etc.
2. The distance of the proposed drilling location from the section's south / north and east / west.
3. The distance to the nearest lease or unit boundary line.
4. If proposed location is located within a prorated or spaced field a certificate of acreage attribution plat must be attached: (CO-7 for oil wells; CG-8 for gas wells).