

Give All Information Completely  
Make Required Affidavit  
Mail or Deliver Report to:  
Conservation Division  
State Corporation Commission  
800 Bitting Building  
Wichita, Kansas

15-463-00357-00-00

WELL PLUGGING RECORD

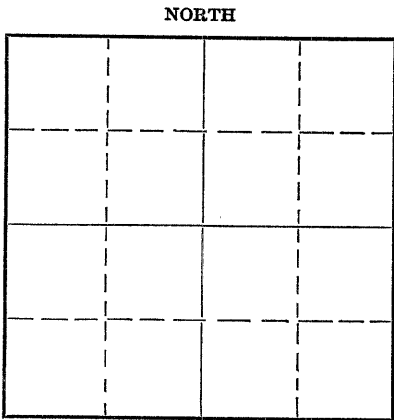

Locate well correctly on above  
Section Plat

Rooks County. Sec. 29 Twp. 7S Rge. (E) 20 (W)  
Location as "NE/CNW $\frac{1}{4}$ SW $\frac{1}{4}$ " or footage from lines NW, NW, SW  
Lease Owner JONES, SHELburnE & FARMER, INC.  
Lease Name Thyfault Well No. 1  
Office Address Russell, Kansas  
Character of Well (completed as Oil, Gas or Dry Hole) Dry  
Date well completed 1-6- 1952  
Application for plugging filed 1-6- 1952  
Application for plugging approved 1-6- 1952  
Plugging commenced 1-7- 1952  
Plugging completed 1-7- 1952  
Reason for abandonment of well or producing formation Dry

If a producing well is abandoned, date of last production Never Produced 19\_\_\_\_  
Was permission obtained from the Conservation Division or its agents before plugging was commenced? Yes

Name of Conservation Agent who supervised plugging of this well Eldon Petty  
Producing formation \_\_\_\_\_ Depth to top \_\_\_\_\_ Bottom \_\_\_\_\_ Total Depth of Well 3683 Feet  
Show depth and thickness of all water, oil and gas formations.

OIL, GAS OR WATER RECORDS

CASING RECORD

Formation	Content	From	To	Size	Put In	Pulled Out
				8 5/8"	165f	None

Describe in detail the manner in which the well was plugged, indicating where the mud fluid was placed and the method or methods used in introducing it into the hole. If cement or other plugs were used, state the character of same and depth placed, from \_\_\_\_\_ feet to \_\_\_\_\_ feet for each plug set.

1. Filled hole with heavy mud.
2. Pushed Halliburton plug to 160.
3. Dumped 1/2 sk hulls on top of plug.
4. Mixed 15 sks of cement and spotted on top of hulls.
5. Pushed 2nd Halliburton plug to 40'.
6. Dumped 1/2 sk hulls on top of hulls.
7. Mixed 10 sks of cement and filled hole with sand.

JAN 14 1952  
DIVISION

1/14/52

(If additional description is necessary, use BACK of this sheet)

Correspondence regarding this well should be addressed to JONES, SHELburnE & FARMER, INC.  
Address Russell, Kansas

STATE OF Kansas, COUNTY OF Russell, ss.  
John O. Farmer, Vice-President (employee of owner) or (owner or operator) of the above-described well,  
being first duly sworn on oath, says: That I have knowledge of the facts, statements, and matters herein contained and the log of the above-described well as filed and that the same are true and correct. So help me God.

(Signature) John O. Farmer

(Address)

SUBSCRIBED AND SWORN to before me this 8th day of January, 1952.

My commission expires October 24, 1955.

Joseph S. Mahalan  
Notary Public.

28-8278-s 4-50-10M

PLUGGING  
FILE SEC 29 T 7 R 20  
BOOK PAGE 136 LINE 36

OPERATOR JONES, SHELburnE & FARMER, INC.ADDRESS Russell, Kansas

## FORMATION RECORD

Give detailed description and thickness of all formations drilled through, contents of sand, whether dry, water, oil or gas.

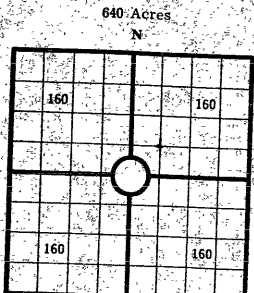

COUNTY Rooks SEC. 29 TWP. 7S RGE. 20W  
 COMPANY OPERATING JONES, SHELburnE & FARMER, INC.  
 OFFICE ADDRESS Russell, Kansas  
 FARM NAME Thyfault WELL NO. 1  
 DRILLING STARTED 19 DRILLING FINISHED 19  
 DATE OF FIRST PRODUCTION 12-21-50 COMPLETED 1-6-52  
 WELL LOCATED NW 1/4, NW 1/4, SW 1/4 North of South  
 Line and ft. East of West Line of Quarter Section  
 Elevation (Relative to sea level) DERRICK FLOOR 2055 GROUND  
 CHARACTER OF WELL (Oil, gas or dryhole) Dry

## OIL OR GAS SANDS OR ZONES

Name	From	To	Name	From	To
1			4		
2			5		
3			6		

## Perforating Record If Any

## Shot Record

Formation	From	To	No. of Shots	Formation	From	To	Size of Shot

## CASING RECORD

Amount Set							Amount Pulled		Packer Record		
Size	Wt.	Thds.	Make	Ft.	In.	Ft.	In.	Size	Length	Depth Set	Make
8 5/8"	24	8	LW	165							

Liner Record: Amount \_\_\_\_\_ Kind \_\_\_\_\_ Top \_\_\_\_\_ Bottom \_\_\_\_\_

## CEMENTING AND MUDDING

Size	Amount Set		Sacks Cement	Chemical		Method of Cementing	Amount	Mudding Method	Results (See Note)
	Ft.	In.		Gal.	Make				
8 5/8"	165'		100						

Note: What method was used to protect sands if outer strings were pulled?

NOTE: Were bottom hole plugs used? \_\_\_\_\_ If so, state kind, depth set and results obtained \_\_\_\_\_

## TOOLS USED

Rotary Tools were used from \_\_\_\_\_ feet to \_\_\_\_\_ Cable tools were used from \_\_\_\_\_ feet to \_\_\_\_\_  
 feet, and from \_\_\_\_\_ feet to \_\_\_\_\_ feet, and from \_\_\_\_\_ feet to \_\_\_\_\_

Type Rig \_\_\_\_\_

## INITIAL PRODUCTION TEST

Describe initial test: whether by flow through tubing or casing or by pumping \_\_\_\_\_

Amount of Oil Production \_\_\_\_\_ bbls. Size of choke, if any \_\_\_\_\_ Length of test \_\_\_\_\_ Water  
 Production \_\_\_\_\_ bbls. Gravity of oil \_\_\_\_\_ Type of Pump - if pump is used, describe \_\_\_\_\_

I, the undersigned, being first duly sworn upon oath, state that this well record is true, correct and complete according to the records of this office and to the best of my knowledge and belief.

Johann Farmer  
 Name and title of representative of company  
 Vice-President

Subscribed and sworn to before me this 8th day of January, 1952

My Commission expires 10-24-55

Notary Public.

PLUGGING  
 JAN 29 17 1952  
 ROKS 165 136 117 36

1/14/52

REGISTRATION DIVISION

WELL NO. 1 COUNTY Rooks  
 SEC. 29 TWP. 7S RGE. 20W  
 FARM NAME Thyfault  
 5-163-08357-00-50