

For KCC Use: 8-6-05
Effective Date: 8-6-05
District # 1
SGA? Yes No

KANSAS CORPORATION COMMISSION
OIL & GAS CONSERVATION DIVISION

RECEIVED
AUG 01 2005

Form C-1
September 1999
Form must be Typed
Form must be Signed
blanks must be Filled

NOTICE OF INTENT TO DRILL

Must be approved by KCC five (5) days prior to commencing well

KCC WICHITA

Expected Spud Date August 14th 2005
month day year

Spot E2 - SE Sec 32 Twp. 30 S. R. 31 East West
1320 feet from (S) N (circle one) Line of Section
660 feet from (E) W (circle one) Line of Section
Is SECTION Regular Irregular?

OPERATOR: License# 5003
Name: McCoy Petroleum corporation
Address: 8080 E. Central, Suite #300
City/State/Zip: Wichita, Kansas 67206
Contact Person: Scott Hampel
Phone: 316-636-2737

(Note: Locate well on the Section Plat on reverse side)
County: Haskell
Lease Name: BALL GAS UNIT "A" Well #: 1-32
Field Name: Lette SE

CONTRACTOR: License# 30606
Name: Murfin Drilling Company

Is this a Prorated / Spaced Field? Yes No

Target Information(s): Morrow

Nearest Lease or unit boundary: 660'

Ground Surface Elevation: 2835' feet MSL

Water well within Dne-quarter mile: Yes No

Public water supply well within one mile: Yes No

Depth to bottom of fresh water: 500'

Depth to bottom of usable water: 560'

Surface Pipe by Alternate: 1 2

Length of Surface Pipe Planned to be set: 1825'+/-

Length of Conductor Pipe required: None

Projected Total Depth: 5500'

Producing Formation Target: Chester

Water Source for Drilling Operations:

Well Farm Pond Other

DWR Permit #: _____

(Note: Apply for Permit with DWR)

Will Cores be taken? Yes No

If Yes, proposed zone: _____

Well Drilled For: Oil Enh Rec Gas Storage OWWO Disposal Seismic; # of Holes Other

Well Class: Infield Pool Ext. Wildcat Other

Type Equipment: Mud Rotary Air Rotary Cable

If OWWO: old well information as follows:
Operator: _____
Well Name: _____
Original Completion Date: _____ Original Total Depth: _____

Directional, Deviated or Horizontal wellbore? Yes No

If Yes, true vertical depth: _____

Bottom Hole Location: _____

KCC DKT #: _____

* Prorated & Spaced Hugobon

AFFIDAVIT

The undersigned hereby affirms that the drilling, completion and eventual plugging of this well will comply with K.S.A. 55-101, et. seq. It is agreed that the following minimum requirements will be met:

1. Notify the appropriate district office **prior** to spudding of well;
2. A copy of the approved notice of intent to drill **shall be** posted on each drilling rig;
3. The minimum amount of surface pipe as specified below **shall be set** by circulating cement to the top; in all cases surface pipe **shall be set** through all unconsolidated materials plus a minimum of 20 feet into the underlying formation.
4. If the well is dry hole, an agreement between the operator and the district office on plug length and placement is necessary **prior to plugging**;
5. The appropriate district office will be notified before well is either plugged or production casing is cemented in;
6. If an ALTERNATE 11 COMPLETION, production pipe shall be cemented from below any usable water to surface within **120 days** of spud date. **In all cases, NOTIFY district office** prior to any cementing.

I hereby certify that the statements made herein are true and to the best of my knowledge and belief.

Date: July 29, 2005 Signature of Operator or Agent: Scott Hampel Title: Engineering/Production Mgr.

For KCC Use ONLY
API # 15 - 081-21608-00-00
Conductor pipe required NONE feet
Minimum surface pipe required 580 feet per Alt 1
Approved by: RJP8-1-05
This authorization expires: 2-1-06
(This authorization void if drilling not started within 6 months of effective date.)
Spud date: _____ Agent: _____

Remember to -

- File Drill Pit Application (form CDP-1) with Intent to Drill;
- File Completion Form ACO-1 within 120 days of spud date;
- File acreage attribution plat according to field proration orders;
- Notify appropriate district office 48 hours prior to workover or re-entry;
- Submit plugging report (CP-4) after plugging is completed;
- Obtain written approval before disposing or injecting salt water.

32
30
31W

RECEIVED

AUG 01 2009

KCC WICHITA

IN ALL CASES PLOT THE INTENDED WELL ON THE PLAT BELOW

Plat of acreage attributable to a well in a prorated or spaced field

If the intended well is in a prorated or spaced field, please fully complete this side of the form. If the intended well is in a prorated or spaced field complete the plat below showing that the well will be properly located in relationship to other wells producing from the common source of supply. Please show all the wells and within 1 mile of the boundaries of the proposed acreage attribution unit for gas wells and within 1/2 mile of the boundaries of the proposed acreage attribution unit for oil wells.

API No. 15 - _____
Operator: McCoy Petroleum Corporation
Lease: BALL GAS UNIT "A"
Well Number: 1-32
Field: Lette SE

Location of Well: County: Haskell
1320 feet from S N (circle one) Line of Section
660 feet from E W (circle one) Line of Section
Sec 32 Twp 30 S. R. 31 W East West

Is Section X Regular or Irregular

If Section is Irregular, locate well from nearest corner boundary.

Section corner used: NE NW -SE SW

Number of Acres attributable to well: _____
QTR / QTR / QTR of acreage: E2 SE

PLAT

(Show location of the well and shade attributable acreage for prorated or spaced wells)
(Show footage to the nearest lease or unit boundary fine.)

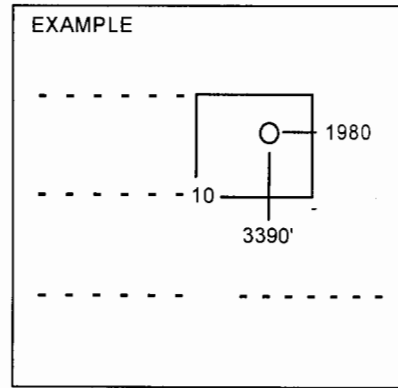
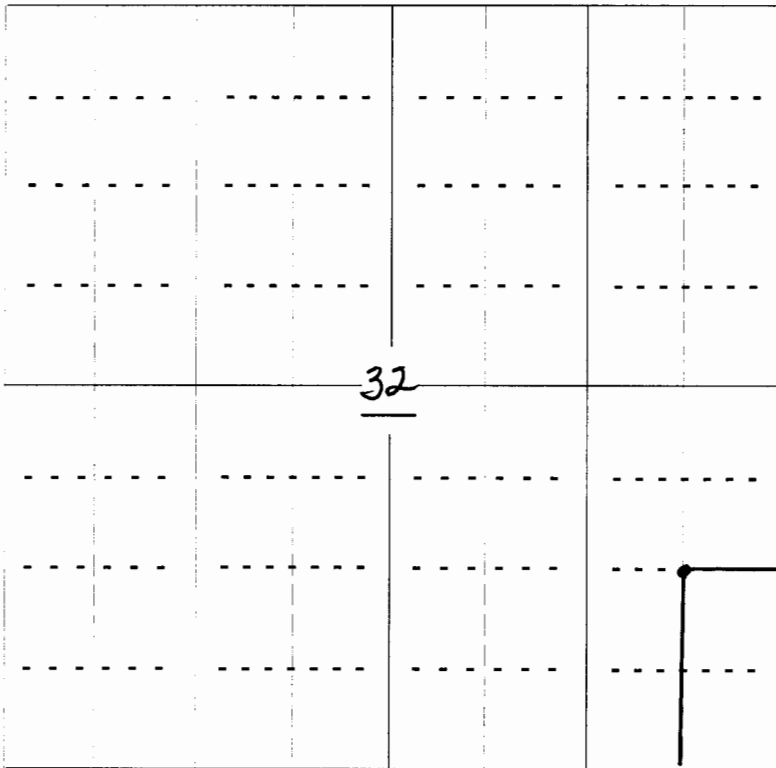

SEWARDCO.

NOTE., In all cases locate the spot of the proposed drilling location.

In plotting the proposed location of the well, you must show.

- 1. The manner in which you are using the depicted plat by identifying section lines, i.e. 1 section, 1 section with 8 surrounding sections, 4 sections, etc.
2. The distance of the proposed drilling location from the section's south / north and east / west.
3. The distance to the nearest lease or unit boundary line.
4. If proposed location is located within a prorated or spaced field a certificate of acreage attribution plat must be attached: (CO-7 for oil wells; CG-8 for gas wells).