

For KCC Use: 8.305
 Effective Date: 3
 District #: _____
 SGA? Yes No

KANSAS CORPORATION COMMISSION
 OIL & GAS CONSERVATION DIVISION
NOTICE OF INTENT TO DRILL

Form C-1
 September 1999
Form must be Typed
Form must be Signed
All blanks must be Filled

Must be approved by KCC five (5) days prior to commencing well

Expected Spud Date August 2 2005
month day year

Spot NW SE NE Sec. 3 Twp. 32 S. R. 14
 East West

OPERATOR: License# 33365
 Name: Layne Energy Operating, LLC
 Address: 1900 Shawnee Mission Parkway
Mission Woods, KS 66205

1700 feet from S / (N) (circle one) Line of Section
800 feet from (E) W (circle one) Line of Section
 Is SECTION Regular Irregular?

Contact Person: Rolland Yoakum
 Phone: 913-748-3987

RECEIVED
KANSAS CORPORATION COMMISSION

(Note: Locate well on the Section Plat on reverse side)
 County: Montgomery
 Lease Name: Bomac Well #: 8-3

CONTRACTOR: License# 33606
 Name: Thorton Air

JUL 29 2005

Field Name: Jefferson-Sycamore
 Is this a Prorated / Spaced Field? Yes No

Well Drilled For: Well Class: Type Equipment:
 Oil Enh Rec Infield Mud Rotary
 Gas Storage Pool Ext. Air Rotary
 QW/O Disposal Wildcat Cable
 Seismic; # of Holes Other
 Other

Target Formation(s): Cherokee Coals
 Nearest Lease or unit boundary: 800
 Ground Surface Elevation: 904 feet MSL

If OWWO: old well information as follows:
 Operator: _____
 Well Name: _____
 Original Completion Date: _____ Original Total Depth: _____

Water well within one-quarter mile: Yes No
 Public water supply well within one mile: Yes No

Directional, Deviated or Horizontal wellbore? Yes No
 If Yes, true vertical depth: _____
 Bottom Hole Location: _____
 KCC DKT #: _____

Depth to bottom of fresh water: 150'
 Depth to bottom of usable water: 200'
 Surface Pipe by Alternate: 1 2
 Length of Surface Pipe Planned to be set: 20'

Length of Conductor Pipe required: None
 Projected Total Depth: 1300 Feet
 Formation at Total Depth: Mississippian

Water Source for Drilling Operations:
 Well _____ Farm Pond _____ Other

DWR Permit #: _____
 (Note: Apply for Permit with DWR)
 Will Cores be taken? Yes No
 If Yes, proposed zone: _____

AFFIDAVIT

The undersigned hereby affirms that the drilling, completion and eventual plugging of this well will comply with K.S.A. 55-101, et. seq.
 It is agreed that the following minimum requirements will be met:

1. Notify the appropriate district office **prior** to spudding of well;
2. A copy of the approved notice of intent to drill **shall be** posted on each drilling rig;
3. The minimum amount of surface pipe as specified below **shall be set** by circulating cement to the top; in all cases surface pipe **shall be set** through all unconsolidated materials plus a minimum of 20 feet into the underlying formation.
4. If the well is dry hole, an agreement between the operator and the district office on plug length and placement is necessary **prior to plugging**;
5. The appropriate district office will be notified before well is either plugged or production casing is cemented in;
6. If an ALTERNATE II COMPLETION, production pipe shall be cemented from below any usable water to surface within **120 days** of spud date. **In all cases, NOTIFY district office** prior to any cementing.

I hereby certify that the statements made herein are true and to the best of my knowledge and belief.

Date: July 28, 2005 Signature of Operator or Agent: Rod Jan Title: Agent

For KCC Use ONLY
 API # 15 - 125-30815-0000
 Conductor pipe required NONE feet
 Minimum surface pipe required 20 feet per Alt. 4 (2)
 Approved by RJP 7.29.05
 This authorization expires: 1-29-06
 (This authorization void if drilling not started within 6 months of effective date.)
 Spud date: _____ Agent: _____

- Remember to:**
- File Drill Pit Application (form CDP-1) with Intent to Drill;
 - File Completion Form ACO-1 within 120 days of spud date;
 - File acreage attribution plat according to field proration orders;
 - Notify appropriate district office 48 hours prior to workover or re-entry;
 - Submit plugging report (CP-4) after plugging is completed;
 - Obtain written approval before disposing or injecting salt water.

3
32
14E

JUL 29 2005

IN ALL CASES PLOT THE INTENDED WELL ON THE PLAT BELOW

Plat of acreage attributable to a well in a prorated or spaced field

CONSERVATION DIVISION
WICHITA, KS

If the intended well is in a prorated or spaced field, please fully complete this side of the form. If the intended well is in a prorated or spaced field complete the plat below showing that the well will be properly located in relationship to other wells producing from the common source of supply. Please show all the wells and within 1 mile of the boundaries of the proposed acreage attribution unit for gas wells and within 1/2 mile of the boundaries of the proposed acreage attribution unit for oil wells.

API No. 15 - _____
 Operator: Layne Energy Operating, LLC
 Lease: Bomac
 Well Number: 8-3
 Field: Jefferson-Sycamore

Location of Well: County: Montgomery
 _____ feet from S (N) (circle one) Line of Section
 _____ feet from (E) / W (circle one) Line of Section
 Sec. 3 Twp. 32 S. R. 14 East West

Number of Acres attributable to well: _____
 QTR / QTR / QTR of acreage: _____ - SE - NE

Is Section Regular or _____ Irregular

If Section is Irregular, locate well from nearest corner boundary.

Section corner used: ___ NE ___ NW ___ SE ___ SW

PLAT

(Show location of the well and shade attributable acreage for prorated or spaced wells.)

(Show footage to the nearest lease or unit boundary line.)

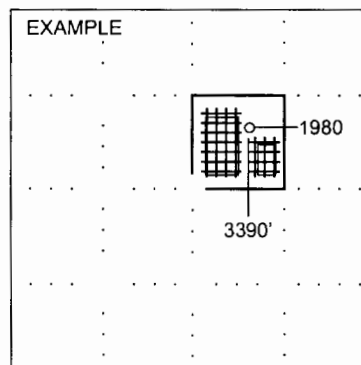
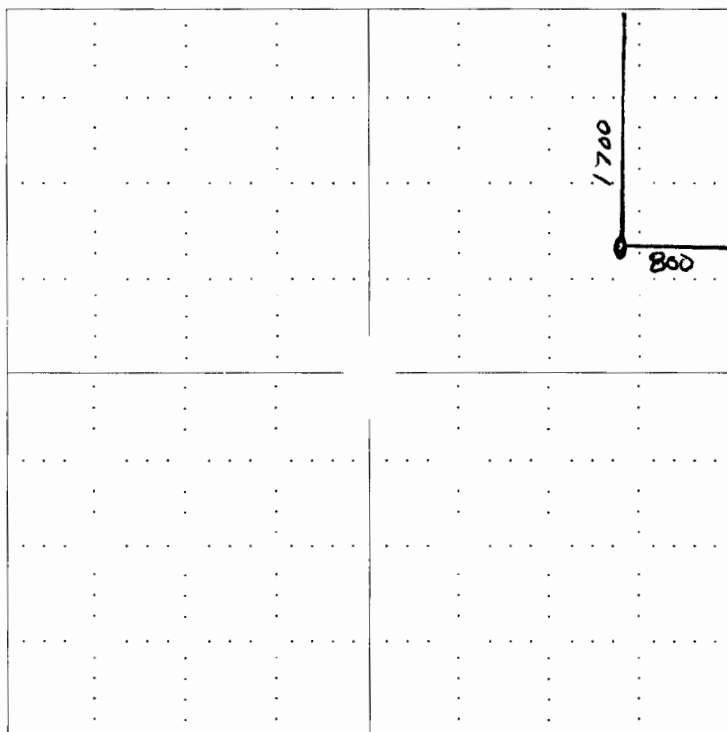

NOTE: In all cases locate the spot of the proposed drilling location.

In plotting the proposed location of the well, you must show:

1. The manner in which you are using the depicted plat by identifying section lines, i.e. 1 section, 1 section with 8 surrounding sections, 4 sections, etc.
2. The distance of the proposed drilling location from the section's south / north and east / west.
3. The distance to the nearest lease or unit boundary line.
4. If proposed location is located within a prorated or spaced field a certificate of acreage attribution plat must be attached: (C0-7 for oil wells; CG-8 for gas wells).