

RECEIVED

KANSAS CORPORATION COMMISSION OIL & GAS CONSERVATION DIVISION

AUG 25 2005

Form C-1

September 1999

Form must be Typed

Form must be Signed

All blanks must be Filled

For KCC Use:

Effective Date:

9.3.05

District #

3

SGA? Yes No

NOTICE OF INTENT TO DRILL KCC WICHITA

Must be approved by KCC five (5) days prior to commencing well

Expected Spud Date 9 month 7 day 2005 year

OPERATOR: License# 6168 Name: Lester Scheuneman Address: 27800 Pleasant Valley Rd. City/State/Zip: Wellsville, Ks. 66092 Contact Person: Lester Scheuneman Phone: 785-883-4621

CONTRACTOR: License# Name: Will notify before drilling

Spot 3545 feet from S / N Line of Section 4290 feet from E / W Line of Section Is SECTION Regular Irregular?

County: Allen Lease Name: Flewhardy Well #: 5 Field Name: Colony

Is this a Prorated / Spaced Field? Target Formation(s): Bartlesville Nearest Lease or unit boundary: 904

Ground Surface Elevation: 1085 feet MSL

Water well within one-quarter mile: Public water supply well within one mile:

Depth to bottom of fresh water: N.A. 100+

Depth to bottom of usable water: N.A. 200+

Surface Pipe by Alternate: 1 2

Length of Surface Pipe Planned to be set: 20

Length of Conductor Pipe required: none

Projected Total Depth: 750

Formation at Total Depth: 750

Water Source for Drilling Operations: Well Farm Pond X Other

DWR Permit #: (Note: Apply for Permit with DWR)

Will Cores be taken? Yes No

If Yes, proposed zone:

Table with columns: Well Drilled For, Well Class, Type Equipment. Includes checkboxes for Oil, Gas, OWWO, Seismic, Enh Rec, Storage, Disposal, Infield, Pool Ext, Wildcat, Other, Mud Rotary, Air Rotary, Cable.

If OWWO: old well information as follows: Operator: Well Name: Original Completion Date: Original Total Depth:

Directional, Deviated or Horizontal wellbore? Yes No

If Yes, true vertical depth:

Bottom Hole Location:

KCC DKT #:

AFFIDAVIT

The undersigned hereby affirms that the drilling, completion and eventual plugging of this well will comply with K.S.A. 55-101, et. seq.

It is agreed that the following minimum requirements will be met:

- 1. Notify the appropriate district office prior to spudding of well;
2. A copy of the approved notice of intent to drill shall be posted on each drilling rig;
3. The minimum amount of surface pipe as specified below shall be set by circulating cement to the top;
4. If the well is dry hole, an agreement between the operator and the district office on plug length and placement is necessary prior to plugging;
5. The appropriate district office will be notified before well is either plugged or production casing is cemented in;
6. If an ALTERNATE II COMPLETION, production pipe shall be cemented from below any usable water to surface within 120 days of spud date.

I hereby certify that the statements made herein are true and to the best of my knowledge and belief.

Date: 8-19-05 Signature of Operator or Agent: Lester Scheuneman Title: owner/operator

For KCC Use ONLY API # 15 - 001-29283-00-00 Conductor pipe required NONE feet Minimum surface pipe required 20 feet per Alt. Approved by: RJP 8-29-05 This authorization expires: 3-3-06

Remember to:

- File Drill Pit Application (form CDP-1) with Intent to Drill;
- File Completion Form ACO-1 within 120 days of spud date;
- File acreage attribution plat according to field proration orders;
- Notify appropriate district office 48 hours prior to workover or re-entry;
- Submit plugging report (CP-4) after plugging is completed;
- Obtain written approval before disposing or injecting salt water.

Mail to: KCC - Conservation Division, 130 S. Market - Room 2078, Wichita, Kansas 67202

29 23 20E

IN ALL CASES PLOT THE INTENDED WELL ON THE PLAT BELOW

Plat of acreage attributable to a well in a prorated or spaced field

If the intended well is in a prorated or spaced field, please fully complete this side of the form. If the intended well is in a prorated or spaced field complete the plat below showing that the well will be properly located in relationship to other wells producing from the common source of supply. Please show all the wells and within 1 mile of the boundaries of the proposed acreage attribution unit for gas wells and within 1/2 mile of the boundaries of the proposed acreage attribution unit for oil wells.

API No. 15 - _____
 Operator: _____
 Lease: _____
 Well Number: _____
 Field: _____
 Number of Acres attributable to well: _____
 QTR / QTR / QTR of acreage: _____

Location of Well: County: _____
 _____ feet from S / N (circle one) Line of Section
 _____ feet from E / W (circle one) Line of Section
 Sec. _____ T. _____ S. R. _____ East West
 Is Section _____ Regular Irregular
If Section is Irregular, locate well from nearest corner boundary.
 Section corner used: ___NE ___NW ___SE ___SW

PLAT

*(Show location of the well and shade attributable acreage for prorated or spaced wells.)
 (Show footage to the nearest lease or unit boundary line.)*

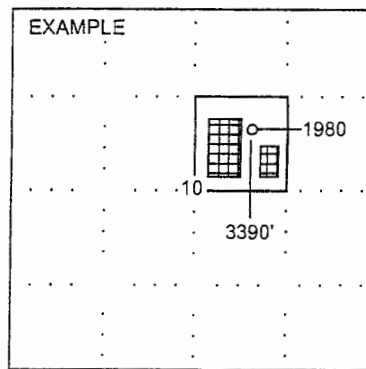
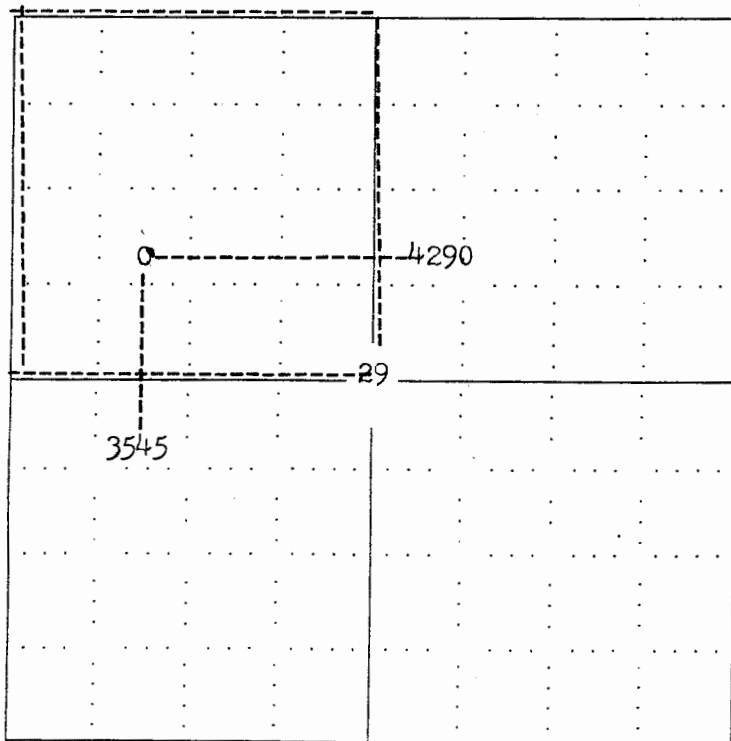

SEWARD CO.

NOTE: In all cases locate the spot of the proposed drilling locaton.
 Allen Co.

In plotting the proposed location of the well, you must show:

1. The manner in which you are using the depicted plat by identifying section lines, i.e. 1 section, 1 section with 8 surrounding sections, 4 sections, etc.
2. The distance of the proposed drilling location from the section's south / north and east / west.
3. The distance to the nearest lease or unit boundary line.
4. If proposed location is located within a prorated or spaced field a certificate of acreage attribution plat must be attached: (CO-7 for oil wells; CG-8 for gas wells).