

O W W O

RECEIVED

AUG 25 2005

Form C-1  
December 2002

Form must be Typed  
Form must be Signed  
blanks must be Filled

For KCC Use: 9.4.05  
Effective Date: \_\_\_\_\_  
District # 1  
SGA?  Yes  No

KANSAS CORPORATION COMMISSION  
OIL & GAS CONSERVATION DIVISION

NOTICE OF INTENT TO DRILL

Must be approved by KCC five (5) days prior to commencing work

KCC WICHITA

Expected Spud Date September 5, 2005  
month / day / year

Spot 75' S of \_\_\_\_\_ East  
SW - NW - NW Sec. 5 Twp. 35 S. R. 13  West  
1065 feet from  N /  S Line of Section  
330 feet from  E /  W Line of Section

OPERATOR: License# 33168  
Name: WOOLSEY OPERATING COMPANY, LLC  
Address: 125 N. Market, Suite 1000  
City/State/Zip: Wichita, Kansas 67202  
Contact Person: Dean Pattisson  
Phone: 316-267-4379 ext 107

Is SECTION  Regular  Irregular?  
(Note: Locate well on the Section Plat on reverse side)

CONTRACTOR: License# 5929  
Name: Duke Drilling Co., Inc.

County: Barber  
Lease Name: OAKES 'A' GU Well #: 6 OWWO  
Field Name: Aetna

Well Drilled For: Well Class: Type Equipment:  
 Oil  Enh Rec  Infield  Mud Rotary  
 Gas  Storage  Pool Ext.  Air Rotary  
 OWWO  Disposal  Wildcat  Cable  
 Seismic; # of Holes  Other  
 Other

Is this a Prorated / Spaced Field?  Yes  No  
Target Information(s): Mississippian  
Nearest Lease or unit boundary: 330

If OWWO: old well information as follows:  
Operator: Continental Oil & City Products  
Well Name: Walsh-Sternberger #1  
Original Completion Date: 05-06-55 Original Total Depth: 5650

Ground Surface Elevation: 1627 feet MSL  
Water well within one-quarter mile:  Yes  No  
Public water supply well within one mile:  Yes  No

Directional, Deviated or Horizontal wellbore?  Yes  No  
If Yes, true vertical depth: \_\_\_\_\_  
Bottom Hole Location: \_\_\_\_\_  
KCC DKT #: \_\_\_\_\_

Depth to bottom of fresh water: 150'  
Depth to bottom of usable water: 180'  
Surface Pipe by Alternate:  1  2

Length of Surface Pipe ~~Planned to be set:~~ has 310' existing  
Length of Conductor Pipe required: None  
Projected Total Depth: 5200

Formation at Total Depth: Mississippian  
Water Source for Drilling Operations:  
 Well  Farm Pond Other To be hauled

DWR Permit #: \_\_\_\_\_  
(Note: Apply for Permit with DWR )  
Will Cores be taken?  Yes  No  
If Yes, proposed zone: \_\_\_\_\_

AFFIDAVIT

The undersigned hereby affirms that the drilling, completion and eventual plugging of this well will comply with K.S.A. 55 et. seq.  
It is agreed that the following minimum requirements will be met:

1. Notify the appropriate district office **prior** to spudding of well;
2. A copy of the approved notice of intent to drill **shall be** posted on each drilling rig;
3. The minimum amount of surface pipe as specified below **shall be set** by circulating cement to the top; in all cases surface pipe **shall be set** through all unconsolidated materials plus a minimum of 20 feet into the underlying formation.
4. If the well is dry hole, an agreement between the operator and the district office on plug length and placement is necessary **prior to plugging**;
5. The appropriate district office will be notified before well is either plugged or production casing is cemented in;
6. If an ALTERNATE II COMPLETION, production pipe shall be cemented from below any usable water to surface within **120 days** of spud date.  
Or pursuant to Appendix "B" - Eastern Kansas surface casing order #133,891-C, which applies to the KCC District 3 area, alternate II cementing must be completed within 30 days of the spud date or the well shall be plugged. **In all cases, NOTIFY district office** prior to any cementing.

I hereby certify that the statements made herein are true and to the best of my knowledge and belief.

Date: 08/24/05 Signature of Operator or Agent: Dean Pattisson Title: Operations Manager

For KCC Use ONLY  
API # 15 - 007. 00187-00-01  
Conductor pipe required NONE feet  
Minimum surface pipe required 310 feet per Alt. 1 & 2  
Approved by: RJP 8.30.05  
This authorization expires: 3.4.06  
(This authorization void if drilling not started within 6 months of effective date.)  
Spud date: \_\_\_\_\_ Agent: \_\_\_\_\_

Remember to:

- File Drill Pit Application (form CDP-1) with Intent to Drill;
- File Completion Form ACO-1 within 120 days of spud date;
- File acreage attribution plat according to field proration orders;
- Notify appropriate district office 48 hours prior to workover or re-entry;
- Submit plugging report (CP-4) after plugging is completed;
- Obtain written approval before disposing or injecting salt water.
- If this permit has expired (See: authorized expiration date) please check the box below and return to the address below.

Well Not Drilled - Permit Expired  
Signature of Operator or Agent: \_\_\_\_\_  
Date: \_\_\_\_\_

Mail to: KCC - Conservation Division, 130 S. Market - Room 2078, Wichita, Kansas 67202

5  
35  
13W

**IN ALL CASES PLOT THE INTENDED WELL ON THE PLAT BELOW**

*Plat of acreage attributable to a well in a prorated or spaced field*

**If the intended well is in a prorated or spaced field, please fully complete this side of the form.** If the intended well is in a prorated or spaced field complete the plat below showing that the well will be properly located in relationship to other wells producing from the common source of supply. Please show all the wells and within 1 mile of the boundaries of the proposed acreage attribution unit for gas wells and within 1/2 mile of the boundaries of the proposed acreage attribution unit for oil wells.

API No. 15 - \_\_\_\_\_  
 Operator: WOOLSEY OPERATING COMPANY, LLC  
 Lease: OAKES 'A' GU  
 Well Number: 6 OWWO  
 Field: Aetna  
 Number of Acres attributable to well: \_\_\_\_\_  
 QTR / QTR / QTR of acreage: SW - NW - NW

Location of Well: County: Barber  
1065 feet from  N /  S Line of Section  
330 feet from  E /  W Line of Section  
 Sec. 5 Twp. 35 S. R. 13  East  West

Is Section:  Regular or  Irregular

**If Section is Irregular, locate well from nearest corner boundary.**

Section corner used:  NE  NW  SE  SW

**PLAT**

*(Show location of the well and shade attributable acreage for prorated or spaced wells.)  
 (Show footage to the nearest lease or unit boundary line.)*

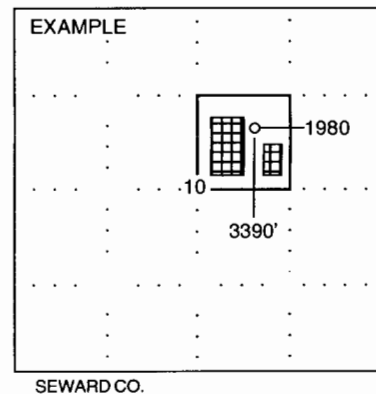
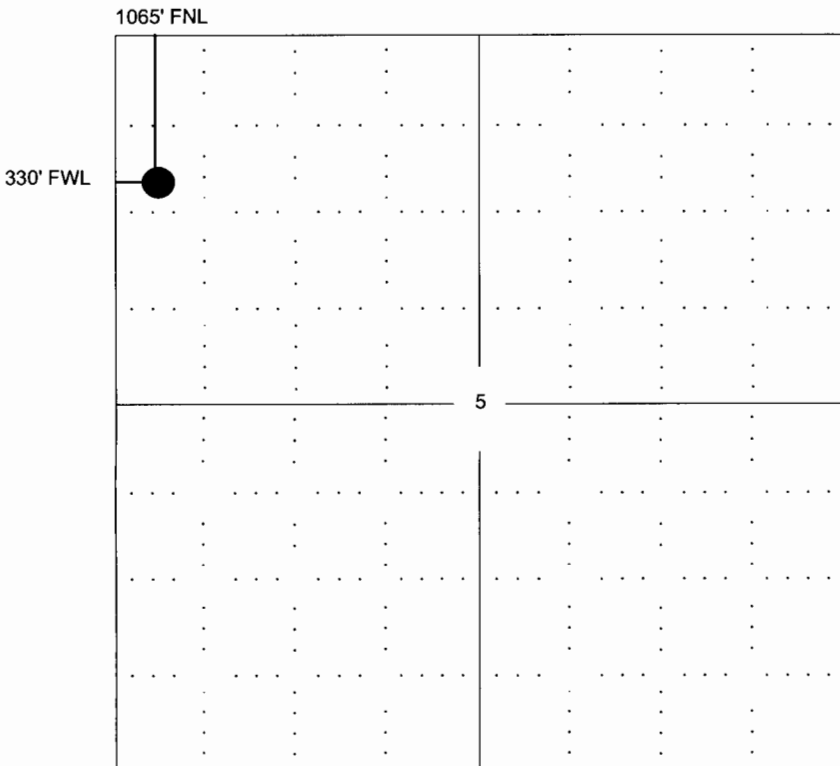

**NOTE: In all cases locate the spot of the proposed drilling location.**

**In plotting the proposed location of the well, you must show:**

1. The manner in which you are using the depicted plat by identifying section lines, i.e. 1 section, 1 section with 8 surrounding sections, 4 sections, etc.
2. The distance of the proposed drilling location from the section's south / north and east / west.
3. The distance to the nearest lease or unit boundary line.
4. If proposed location is located within a prorated or spaced field a certificate of acreage attribution plat must be attached: (CO-7 for oil wells; CG-8 for gas wells).

# KANSAS

CORPORATION COMMISSION

KATHLEEN SEBELIUS, GOVERNOR  
BRIAN J. MOLINE, CHAIR  
ROBERT E. KREHBIEL, COMMISSIONER  
MICHAEL C. MOFFET, COMMISSIONER

August 30, 2005

Mr. Dean Pattisson  
Woolsey Operating Company, LLC  
125 N. Market Ste 1000  
Wichita, KS 67202

RE: Drilling Pit Application  
Oakes A GU Lease Well No. 6 OWWO  
NW/4 Sec. 05-35S-13W  
Barber County, Kansas

Dear Mr. Pattisson:

District staff has inspected the above referenced location and has determined that the reserve pit shall be constructed **without slots**, the bottom shall be flat and reasonably level, and the free fluids must be removed. The fluids are to be removed from the reserve pit as soon as practical after drilling operations have ceased. **The pits should be located outside of the draws.**

**If production casing is set all completion fluids shall be removed on a daily basis.**

The fluids should be taken to an authorized disposal well. Please call the District Office at (620) 225-8888 when the fluids have been removed. Please file form CDP-5, Exploration and Production Waste Transfer, within 30 days of fluid removal. Conservation division forms are available through our office and on the KCC web site: [www.kcc.state.ks.us/conservation/forms](http://www.kcc.state.ks.us/conservation/forms).

**A copy of this letter should be posted in the doghouse along with the approved Intent to Drill.**

If you have any questions or concerns please feel free to contact the undersigned at the above address.

Sincerely,

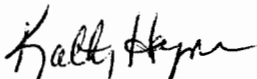

Kathy Haynes  
Environmental Protection and Remediation Department

cc: S Durrant