

RECEIVED

KANSAS CORPORATION COMMISSION  
OIL & GAS CONSERVATION DIVISION

JUL 28 2005

Form C-1  
December 2002

For KCC Use: 8-3-06  
Effective Date: \_\_\_\_\_  
District # 4  
SGA?  Yes  No

NOTICE OF INTENT TO DRILL

KCC WICHITA

Form must be Typed  
Form must be Signed  
All blanks must be Filled

Must be approved by KCC five (5) days prior to commencing well

Expected Spud Date August 5 2005  
month day year

Spot 100' south of  
NE SE NW Sec. 24 Twp. 11 S. R. 18  
1,720 feet from  N /  S Line of Section  
2,970 feet from  E /  W Line of Section  
Is SECTION  Regular  Irregular?

OPERATOR: License# 09346  
Name: Diehl Oil, Inc.  
Address: P. O. Box 234  
City/State/Zip: Hays, KS 67601-0234  
Contact Person: Glenn D. Diehl  
Phone: (785-625-6711)

(Note: Locate well on the Section Plat on reverse side)

County: Ellis  
Lease Name: Peavey "B" Well #: 5  
Field Name: Bemis-Shutts

CONTRACTOR: License# 9292  
Name: Big Three Drilling (Scheck Oil Op)

Is this a Prorated / Spaced Field?  Yes  No  
Target Formation(s): Topeka, LKC & Arbuckle

Nearest Lease or unit boundary: 330'  
Ground Surface Elevation: 1,986 feet MSL

Water well within one-quarter mile:  Yes  No  
Public water supply well within one mile:  Yes  No

Depth to bottom of fresh water: 180'  
Depth to bottom of usable water: 750'

Surface Pipe by Alternate:  1  2  
Length of Surface Pipe Planned to be set: 240

Length of Conductor Pipe required: NONE  
Projected Total Depth: 3,700

Formation at Total Depth: Arbuckle  
Water Source for Drilling Operations:  
 Well  Farm Pond Other

DWR Permit #: \_\_\_\_\_  
(Note: Apply for Permit with DWR )

Will Cores be taken?  Yes  No  
If Yes, proposed zone: \_\_\_\_\_

Well Drilled For:  Oil  Gas  OWWO  Seismic  Other  
 Enh Rec  Storage  Disposal  # of Holes  Other  
Well Class:  Infield  Pool Ext.  Wildcat  Other  
Type Equipment:  Mud Rotary  Air Rotary  Cable

If OWWO: old well information as follows:  
Operator: \_\_\_\_\_  
Well Name: \_\_\_\_\_  
Original Completion Date: \_\_\_\_\_ Original Total Depth: \_\_\_\_\_

Directional, Deviated or Horizontal wellbore?  Yes  No

If Yes, true vertical depth: \_\_\_\_\_

Bottom Hole Location: \_\_\_\_\_

KCC DKT #: \_\_\_\_\_

AFFIDAVIT

The undersigned hereby affirms that the drilling, completion and eventual plugging of this well will comply with K.S.A. 55 et. seq.

It is agreed that the following minimum requirements will be met:

1. Notify the appropriate district office **prior** to spudding of well;
2. A copy of the approved notice of intent to drill **shall be** posted on each drilling rig;
3. The minimum amount of surface pipe as specified below **shall be set** by circulating cement to the top; in all cases surface pipe **shall be set** through all unconsolidated materials plus a minimum of 20 feet into the underlying formation.
4. If the well is dry hole, an agreement between the operator and the district office on plug length and placement is necessary **prior to plugging**;
5. The appropriate district office will be notified before well is either plugged or production casing is cemented in;
6. If an ALTERNATE II COMPLETION, production pipe shall be cemented from below any usable water to surface within **120 days** of spud date.  
Or pursuant to Appendix "B" - Eastern Kansas surface casing order #133,891-C, which applies to the KCC District 3 area, alternate II cementing must be completed within 30 days of the spud date or the well shall be plugged. **In all cases, NOTIFY district office** prior to any cementing.

I hereby certify that the statements made herein are true and to the best of my knowledge and belief.

Date: 7/26/05 Signature of Operator or Agent: [Signature] Title: President

For KCC Use ONLY  
API # 15 - 051-25445-0000  
Conductor pipe required NONE feet  
Minimum surface pipe required 200 feet per Alt. (2)  
Approved by: [Signature] 7-28-05  
This authorization expires: 1-28-06  
(This authorization void if drilling not started within 6 months of effective date.)  
Spud date: \_\_\_\_\_ Agent: \_\_\_\_\_

Remember to:

- File Drill Pit Application (form CDP-1) with Intent to Drill;
- File Completion Form ACO-1 within 120 days of spud date;
- File acreage attribution plat according to field proration orders;
- Notify appropriate district office 48 hours prior to workover or re-entry;
- Submit plugging report (CP-4) after plugging is completed;
- Obtain written approval before disposing or injecting salt water.
- If this permit has expired (See: authorized expiration date) please check the box below and return to the address below.

Well Not Drilled - Permit Expired  
Signature of Operator or Agent: \_\_\_\_\_  
Date: \_\_\_\_\_

Mail to: KCC - Conservation Division, 130 S. Market - Room 2078, Wichita, Kansas 67202

24  
11  
181

**IN ALL CASES PLOT THE INTENDED WELL ON THE PLAT BELOW**

*Plat of acreage attributable to a well in a prorated or spaced field*

**If the intended well is in a prorated or spaced field, please fully complete this side of the form.** If the intended well is in a prorated or spaced field complete the plat below showing that the well will be properly located in relationship to other wells producing from the common source of supply. Please show all the wells and within 1 mile of the boundaries of the proposed acreage attribution unit for gas wells and within 1/2 mile of the boundaries of the proposed acreage attribution unit for oil wells.

API No. 15 - \_\_\_\_\_  
 Operator: Diehl Oil, Inc.  
 Lease: Peavey "B"  
 Well Number: 5  
 Field: Bemis-Shutts  
 Number of Acres attributable to well: 20  
 QTR / QTR / QTR of acreage: NE - SE - NW  
100' south of

Location of Well: County: Ellis  
 \_\_\_\_\_ 1,720 feet from  N /  S Line of Section  
 \_\_\_\_\_ 2,970 feet from  E /  W Line of Section  
 Sec. 24 Twp. 11 S. R. 18  East  West

Is Section:  Regular or  Irregular

**If Section is Irregular, locate well from nearest corner boundary.**

Section corner used:  NE  NW  SE  SW

**PLAT**

*(Show location of the well and shade attributable acreage for prorated or spaced wells.)*

*(Show footage to the nearest lease or unit boundary line.)*

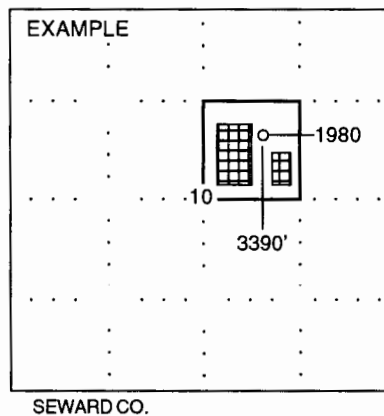
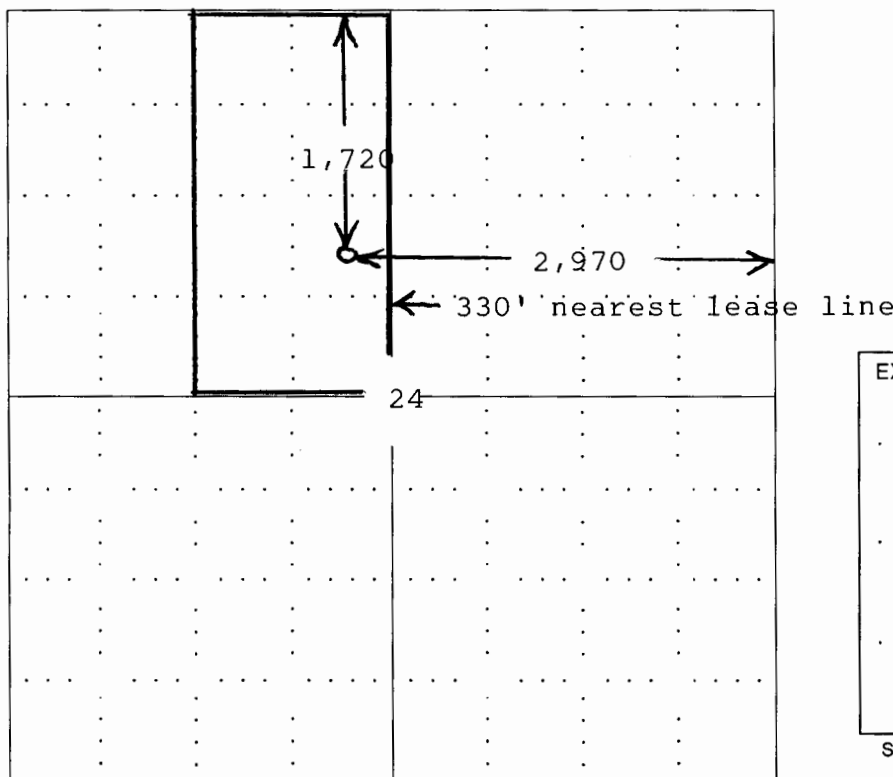

**NOTE: In all cases locate the spot of the proposed drilling locaton.**

**In plotting the proposed location of the well, you must show:**

1. The manner in which you are using the depicted plat by identifying section lines, i.e. 1 section, 1 section with 8 surrounding sections, 4 sections, etc.
2. The distance of the proposed drilling location from the section's south / north and east / west.
3. The distance to the nearest lease or unit boundary line.
4. If proposed location is located within a prorated or spaced field a certificate of acreage attribution plat must be attached: (CO-7 for oil wells; CG-8 for gas wells).