

STATE OF KANSAS  
STATE CORPORATION COMMISSION  
CONSERVATION DIVISION  
500 INSURANCE BUILDING  
212 NORTH MARKET  
WICHITA 2, KANSAS

WELL PLUGGING APPLICATION FORM  
File One Copy

15-193-00043-00-00

Lease Owner JOHN O. FARMER, INC.  
(Applicant)  
Address Russell, Kansas

Lease (Farm Name) BOURQUIN Well No. 1

Well Location NE NE Sec. 7 Twp. 6 S Rge. (E) (W) 32

County Thomas Field Name (if any) \_\_\_\_\_

Total Depth 4670 Oil Well      Gas Well      Input Well      SWD Well      D & A X

Was well log filed with application? yes If not, explain: \_\_\_\_\_

Date and hour plugging is desired to begin 9/20/59 at 4:00 PM

Plugging of the well will be done in accordance with the Rules and Regulations of the State Corporation Commission.

Name of person on the lease in charge of well for owner \_\_\_\_\_

Dale Buchheister Address Plainville, Kansas

Plugging Contractor JOHN O. FARMER, INC. License No. \_\_\_\_\_

Address Russell, Kansas

Invoice covering assessment for plugging this well should be sent to \_\_\_\_\_

JOHN O. FARMER, INC. Address Russell, Kansas

and payment will be guaranteed by applicant.

RECEIVED  
STATE CORPORATION COMMISSION

SEP 29 1959

CONSERVATION DIVISION  
Wichita, Kansas

9-29-59

Signed: John O. Farmer  
Applicant or Acting Agent

Date: September 28, 1959

OPERATOR JOHN O. FARMER, INC.

FORMATION RECORD

ADDRESS Russell, Kansas

Give detailed description and thickness of all formation drilled through, contents of sand, whether dry, water, oil or gas.

WELL NO. 1 COUNTY Thomas TWP 6S RGE. 32W

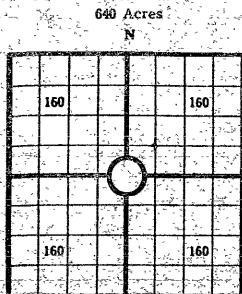

Locate well correctly

COUNTY Thomas, SEC. 7, TWP. 6S, RGE. 32W

COMPANY OPERATING JOHN O. FARMER, INC.

OFFICE ADDRESS Russell, Kansas

DRILLING STARTED 9/6, 1959 DRILLING FINISHED 9/20, 1959

DATE OF FIRST PRODUCTION \_\_\_\_\_ COMPLETED \_\_\_\_\_

WELL LOCATED NE 1/4 NE 1/4 1/4, North of South

Line and \_\_\_\_\_ ft. East of West Line of Quarter Section

Elevation (Relative to sea level) DERRICK FLOOR 3043 GROUND 3040

CHARACTER OF WELL (Oil, gas or dryhole) Dry

OIL OR GAS SANDS OR ZONES

Name	From	To	Name	From	To
1			4		
2			5		
3			6		

Perforating Record If Any

Shot Record

Formation	From	To	No. of Shots	Formation	From	To	Size of Shot

CASING RECORD

Amount Set						Amount Pulled		Packer Record	
Size	Wt.	Thds.	Make	Ft.	In.	Ft.	In.	Depth Set	Make
8-5/8				210					

Liner Record: Amount \_\_\_\_\_ Kind \_\_\_\_\_ Top \_\_\_\_\_ Bottom \_\_\_\_\_

CEMENTING AND MUDDING

Size	Amount Set		Sacks Cement	Chemical		Method of Cementing	Amount	Mudding Method	Results (See Note)
	Ft.	In.		Gal.	Make				
8-5/8	210		125						

Note: What method was used to protect sands if outer strings were pulled?

NOTE: Were bottom hole plugs used? \_\_\_\_\_ If so, state kind, depth set and results obtained \_\_\_\_\_

TOOLS USED

Rotary Tools were used from \_\_\_\_\_ feet to \_\_\_\_\_ Cable tools were used from \_\_\_\_\_ feet to \_\_\_\_\_ feet and from \_\_\_\_\_ feet to \_\_\_\_\_ feet, and from \_\_\_\_\_ feet to \_\_\_\_\_ feet

Type: Rig \_\_\_\_\_

INITIAL PRODUCTION TEST

Describe initial test, whether by flow through tubing or casing or by pumping \_\_\_\_\_

Amount of Oil Production \_\_\_\_\_ bbls. Size of choke, if any \_\_\_\_\_ Length of test \_\_\_\_\_ Water

Production \_\_\_\_\_ bbls. Gravity of oil \_\_\_\_\_ Type of Pump if pump is used, describe \_\_\_\_\_

Formation	Top	Bottom	Formation	Top	Bottom
FARM NAME . . . . .			BOURQUIN #1		
Shale & sand	0	190			
Shale	190	1220			
Shale & sand	1220	2250			
Shale, shells & lime	2250	2450			
Shale & Anhy. Streaks	2450	2655			
Shale & shells	2655	2710	ELEVATION: RB	3045	
Anhydrite	2710	2746			
Shale & shells	2746	3010	FORMATION TOPS:		
Shale & lime	3010	3630	Sample Log		
Lime & shale	3630	4670	Anhydrite	2710	
T.D.		4670	Howard	3691	3690
			Topeka	3735	3722
			Heebner	3956	3954
			Toronto	3987	3987
			Lansing	4002	4002
			B/KC	4268	4267
			Marmaton	4281	4280
			Cherokee sand	4449	4455
			Mississippi	4560	4560
			T.D.	4670	4670
			D & A		

RECEIVED  
 STATE CORPORATION COMMISSION  
 SEP 29 1959  
 CONSERVATION DIVISION  
 Wichita, Kansas

15-193-00043-00-00

I, the undersigned, being first duly sworn upon oath, state that this well record is true, correct and complete according to the records of this office and to the best of my knowledge and belief.

*John O. Farmer*  
 Name and title of representative of company  
 President

Subscribed and sworn to before me this 28th day of September, 19 59

My Commission expires 10/11/62  
*Lucille Kennedy*  
 Notary Public.

State of Kansas



15-193-00043-00-00

GEORGE DOCKING Governor  
HARRY G. WILES Chairman  
MARION BEATTY Commissioner  
RICHARD C. BYRD Commissioner  
RAYMOND B. HARVEY Secretary  
J. ROBERT WILSON Counsel

State Corporation Commission

CONSERVATION DIVISION

(Oil, Gas and Water)

500 Insurance Bldg. 212 N. Market

WICHITA, KANSAS

JEWEL M. OGDEN, Director

WELL PLUGGING AUTHORITY

September 30, 1959

Well No. 1  
Lease Bourquin  
Description NE NE 7-6-32W  
County Thomas  
File No.

John O. Farmer, Inc.  
Russell, Kansas

Gentlemen:

This is your authority to plug the above subject well in accordance with the Rules and Regulations of the State Corporation Commission.

This authority is void after 90 days from the above date.

Very truly yours,

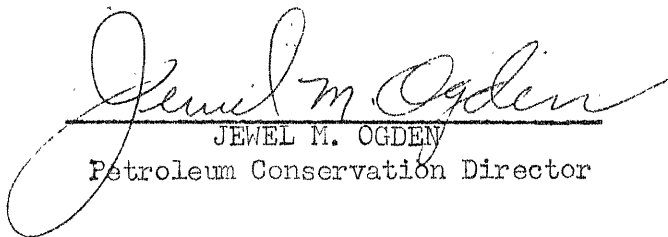
  
JEWEL M. OGDEN  
Petroleum Conservation Director

Mr. Fabricius

is hereby assigned to supervise the plugging of the above named well.

In the event you need any further information regarding this well feel free to write or call me at any time.

J. Lewis Brock  
Western Kansas Field Supervisor  
P. O. Box 569  
Great Bend, Kansas  
Phone: GL-33022