

FOR KCC USE:

FORM C-1 7/91

FORM MUST BE TYPED

EFFECTIVE DATE: 10-5-93

State of Kansas

FORM MUST BE SIGNED

DISTRICT # 4

NOTICE OF INTENTION TO DRILL

ALL BLANKS MUST BE FILLED

SGA? Yes No

Must be approved by the K.C.C. five (5) days prior to commencing well

Expected Spud Date 10-14-93 month day year

Spot NW-SW-NW Sec 1 Twp 7 S Rg 20 West

OPERATOR: License # 8061 Name: Oil Producers, Inc. of Kansas Address: P.O. Box 8647 City/State/Zip: Wichita, Ks. 67208 Contact Person: John S. Weir Phone: 316.681.0231

3630 feet from South / North line of Section 4950 feet from East / West line of Section

IS SECTION X REGULAR IRREGULAR? (NOTE: Locate well on the Section Plat on Reverse Side)

CONTRACTOR: License #: 4958 Name: Mallard IV, Inc.

County: Rooks Lease Name: Gallagher Well #: 2 Field Name:

Well Drilled For: Well Class: Type Equipment:

X Oil Enh Rec X Infield X Mud Rotary Gas Storage Pool Ext. Air Rotary OWWO Disposal Wildcat Cable Seismic; # of Holes Other

Is this a Prorated/Spaced Field? yes X no Target Formation(s): Lansing Arbuckle

If OWWO: old well information as follows: Operator: Well Name: Comp. Date: Old Total Depth

Nearest lease or unit boundary: 330 Ground Surface Elevation: approx feet MSL Water well within one-quarter mile: yes X no

Directional, Deviated or Horizontal wellbore? yes X no

Public water supply well within one mile: yes X no Depth to bottom of fresh water: 650'

If yes, true vertical depth:

Depth to bottom of usable water: 1000' Surface Pipe by Alternate: 1 2

Bottom Hole Location:

Length of Surface Pipe Planned to be set: 370 240 Length of Conductor pipe required: None

AFFIDAVIT

The undersigned hereby affirms that the drilling, completion and eventual plugging of this well will comply with K.S.A. 55-101, et. seq.

It is agreed that the following minimum requirements will be met:

- 1. Notify the appropriate district office prior to spudding of well; 2. A copy of the approved notice of intent to drill shall be posted on each drilling rig; 3. The minimum amount of surface pipe as specified below shall be set by circulating cement to the top; in all cases surface pipe shall be set through all unconsolidated materials plus a minimum of 20 feet into the underlying formation; 4. If the well is dry hole, an agreement between the operator and the district office on plug length and placement is necessary prior to plugging; 5. The appropriate district office will be notified before well is either plugged or production casing is cemented in; 6. IF AN ALTERNATE II COMPLETION, PRODUCTION PIPE SHALL BE CEMENTED FROM BELOW ANY USABLE WATER TO SURFACE WITHIN 120 DAYS OF SPUD DATE. IN ALL CASES, NOTIFY DISTRICT OFFICE PRIOR TO ANY CEMENTING.

I hereby certify that the statements made herein are true and to the best of my knowledge and belief.

Date: 9/30/93 Signature of Operator or Agent: John S. Weir Title: President

FOR KCC USE: API # 15- 163-23237-00-00 Conductor pipe required NONE feet Minimum surface pipe required 240 feet per Alt. X(2) Approved by: CB 10-1-93 This authorization expires: 4-1-94 (This authorization void if drilling not started within 6 months of effective date.) Spud date: Agent:

REMEMBER TO:

- File Drill Pit Application (form CDP-1) with Intent to Drill; - File Completion Form ACO-1 within 120 days of spud date; - File acreage attribution plat according to field proration orders; - Notify appropriate district office 48 hours prior to workover or re-entry; - Submit plugging report (CP-4) after plugging is completed; - Obtain written approval before disposing or injecting salt water.

Mail to: Conservation Division, 200 Colorado Derby Building, 202 W. First St., Wichita, Kansas 67202-1286

RECEIVED STATE CORPORATION COMMISSION OCT 01 1993 OCT 01 1993 CONSERVATION DIVISION Wichita, Kansas

IN ALL CASES PLOT THE INTENDED WELL ON THE PLAT BELOW

PLAT OF ACREAGE ATTRIBUTABLE TO A WELL IN A PRORATED OR SPACED FIELD

If the intended well is in a prorated or spaced field, please fully complete this side of the form. If the intended well is in a prorated or spaced field complete the plat below showing that the well will be properly located in relationship to other wells producing from the common source of supply. Please show all the wells within 1 mile of the boundaries of the proposed acreage attribution unit for gas wells and within 1/2 mile of the boundaries of the proposed acreage attribution unit for oil wells.

API NO. 15- _____
 OPERATOR Oil Producers, Inc. of Kansas
 LEASE Gallagher
 WELL NUMBER #2
 FIELD _____

LOCATION OF WELL: COUNTY Rooks
3630 feet from south/~~north~~ line of section
4950 feet from east/~~west~~ line of section
 SECTION 1 TWP 7 RG 20W

NUMBER OF ACRES ATTRIBUTABLE TO WELL _____
 QTR/QTR/QTR OF ACREAGE _____

IS SECTION X REGULAR or _____ IRREGULAR
IF SECTION IS IRREGULAR, LOCATE WELL FROM NEAREST CORNER BOUNDARY.

Section corner used: _____ NE _____ NW _____ SE _____ SW
PLAT

(Show location of the well and shade attributable acreage for prorated or spaced wells.)
 (Show footage to the nearest lease or unit boundary line.)

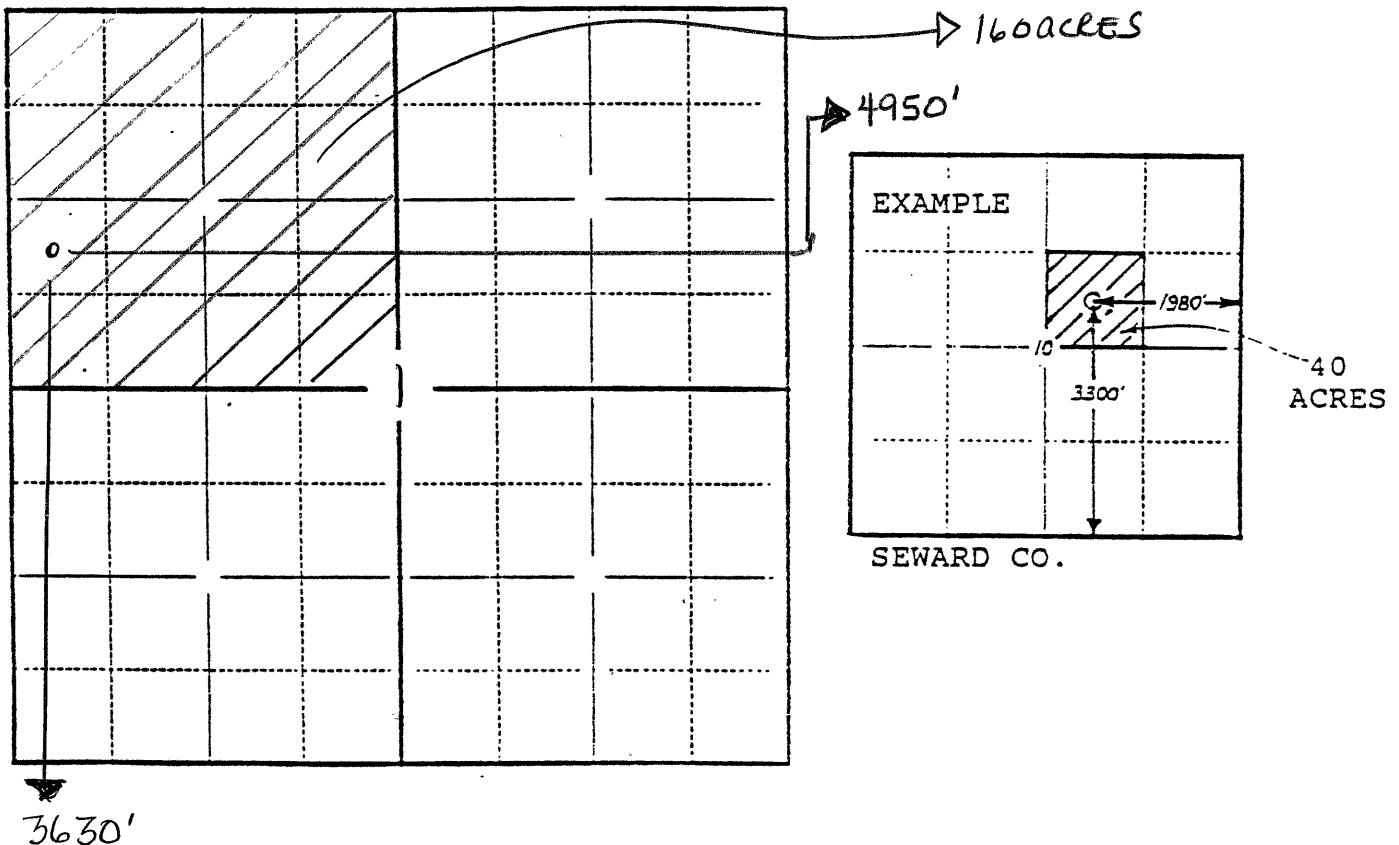

In plotting the proposed location of the well, you must show:

- 1) The manner in which you are using the depicted plat by identifying section lines, i.e. 1 section, 1 section with 8 surrounding sections, 4 sections, etc.;
- 2) the distance of the proposed drilling location from the section's south/north and east/west lines; and
- 3) the distance to the nearest lease or unit boundary line.