

RECEIVED

SEP 07 2005

KCC WICHITA

Form C-1

December 2002

Form must be Typed

Form must be Signed

All blanks must be Filled

For KCC Use: Effective Date: 9-12-05 District #: 2 SGA?  Yes  No

KANSAS CORPORATION COMMISSION OIL & GAS CONSERVATION DIVISION

NOTICE OF INTENT TO DRILL

Must be approved by KCC five (5) days prior to commencing well

Expected Spud Date: October, 5 2005 month day year

OPERATOR: License# 5214 Name: Lario Oil & Gas Co. Address: 301 South Market City/State/Zip: Wichita, KS 67202 Contact Person: Jay G. Schweikert Phone: 316-265-5611

CONTRACTOR: License# 33350 Name: Southwind Drilling, Inc.

Well Drilled For: Oil, Gas, OWWO, Seismic; # of Holes, Other Well Class: Enh Rec, Storage, Disposal, Other Well Class: Infield, Pool Ext, Wildcat, Other Type Equipment: Mud Rotary, Air Rotary, Cable

If OWWO: old well information as follows: Operator: Well Name: Original Completion Date: Original Total Depth:

Directional, Deviated or Horizontal wellbore? If Yes, true vertical depth: Bottom Hole Location: KCC DKT #:

Spot \*\* Approx 110' W of W2 SW Sec. 12 Twp. 28 S. R. 05 1320 feet from N / S Line of Section 550 feet from E / W Line of Section Is SECTION Regular Irregular?

(Note: Locate well on the Section Plat on reverse side) County: Kingman

Lease Name: Jones Well #: 5-12 Field Name: Vinita

Is this a Prorated / Spaced Field? Target Formation(s): Mississippian & Simpson

Nearest Lease or unit boundary: 550 Ground Surface Elevation: 1386 feet MSL

Water well within one-quarter mile: Public water supply well within one mile: Depth to bottom of fresh water: 150 Depth to bottom of usable water: 180

Surface Pipe by Alternate: 1 Length of Surface Pipe Planned to be set: 280

Length of Conductor Pipe required: None Projected Total Depth: 4350 ft.

Formation at Total Depth: Simpson

Water Source for Drilling Operations: Well Farm Pond Other

DWR Permit #: Will Cores be taken? Mississippian

If Yes, proposed zone: (Note: Apply for Permit with DWR)

AFFIDAVIT

The undersigned hereby affirms that the drilling, completion and eventual plugging of this well will comply with K.S.A. 55 et. seq.

It is agreed that the following minimum requirements will be met:

- 1. Notify the appropriate district office prior to spudding of well; 2. A copy of the approved notice of intent to drill shall be posted on each drilling rig; 3. The minimum amount of surface pipe as specified below shall be set by circulating cement to the top; in all cases surface pipe shall be set through all unconsolidated materials plus a minimum of 20 feet into the underlying formation. 4. If the well is dry hole, an agreement between the operator and the district office on plug length and placement is necessary prior to plugging; 5. The appropriate district office will be notified before well is either plugged or production casing is cemented in; 6. If an ALTERNATE II COMPLETION, production pipe shall be cemented from below any usable water to surface within 120 days of spud date. Or pursuant to Appendix "B" - Eastern Kansas surface casing order #133,891-C, which applies to the KCC District 3 area, alternate II cementing must be completed within 30 days of the spud date or the well shall be plugged. In all cases, NOTIFY district office prior to any cementing.

I hereby certify that the statements made herein are true and to the best of my knowledge and belief.

Date: 9/6/05 Signature of Operator or Agent: Jay G. Schweikert Title: Operations Engineer

For KCC Use ONLY API # 15 - 095-21987.0000 Conductor pipe required None feet Minimum surface pipe required 200 feet per Alt. 1 Approved by: RSP 9-7-05 This authorization expires: 3-12-06 (This authorization void if drilling not started within 6 months of effective date.) Spud date: Agent:

Remember to: File Drill Pit Application (form CDP-1) with Intent to Drill; File Completion Form ACO-1 within 120 days of spud date; File acreage attribution plat according to field proration orders; Notify appropriate district office 48 hours prior to workover or re-entry; Submit plugging report (CP-4) after plugging is completed; Obtain written approval before disposing or injecting salt water. If this permit has expired (See: authorized expiration date) please check the box below and return to the address below. Well Not Drilled - Permit Expired Signature of Operator or Agent: Date:

Mail to: KCC - Conservation Division, 130 S. Market - Room 2078, Wichita, Kansas 67202

12 28 SW

**IN ALL CASES PLOT THE INTENDED WELL ON THE PLAT BELOW**

*Plat of acreage attributable to a well in a prorated or spaced field*

If the intended well is in a prorated or spaced field, please fully complete this side of the form. If the intended well is in a prorated or spaced field complete the plat below showing that the well will be properly located in relationship to other wells producing from the common source of supply. Please show all the wells and within 1 mile of the boundaries of the proposed acreage attribution unit for gas wells and within 1/2 mile of the boundaries of the proposed acreage attribution unit for oil wells.

API No. 15 - \_\_\_\_\_  
 Operator: Lario Oil & Gas Co.  
 Lease: Jones  
 Well Number: 5-12  
 Field: Vinita  
 Number of Acres attributable to well: 30  
 QTR / QTR / QTR of acreage: \*\* - W2 - SW

Location of Well: County: Kingman  
1320 feet from  N /  S Line of Section  
550 feet from  E /  W Line of Section  
 Sec. 12 Twp. 28 S. R. 05  East  West

Is Section:  Regular or  Irregular

If Section is Irregular, locate well from nearest corner boundary.

Section corner used:  NE  NW  SE  SW

**PLAT**

(Show location of the well and shade acreage for prorated or spaced wells.)  
 (Show footage to the nearest lease or unit boundary line.)

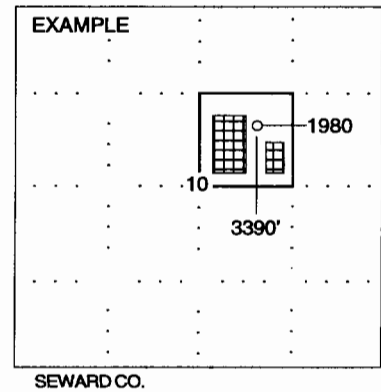
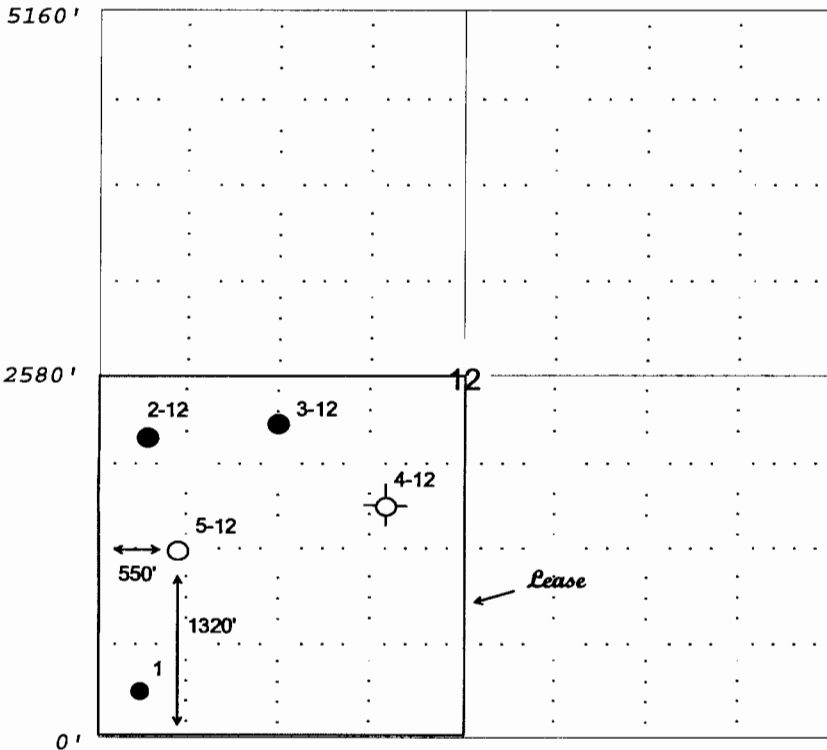

NOTE: In all cases locate the spot of the proposed drilling locaton. 5318' 2655'

**In plotting the proposed location of the well, you must show:**

1. The manner in which you are using the depicted plat by identifying section lines, i.e. 1 section, 1 section with 8 surrounding sections, 4 sections, etc.
2. The distance of the proposed drilling location from the section's south / north and east / west.
3. The distance to the nearest lease or unit boundary line.
4. If proposed location is located within a prorated or spaced field a certificate of acreage attribution plat must be attached: (CO-7 for oil wells; CG-8 for gas wells).