

CORRECTED

FOR KCC USE:

FORM CB-1 12/93

EFFECTIVE DATE: 5-2-05

FORM MUST BE TYPED

DISTRICT # 1

State of Kansas
CATHODIC PROTECTION BOREHOLE INTENT

FORM MUST BE SIGNED

SGA? Yes X No

Must be approved by the K.C.C. sixty (60) days prior to commencing well.

ALL BLANKS MUST BE FILLED IN

Expected Spud (Starting) Date 5-16-05
month day year

Spot (Location) Q/Q/Q East
NW SW NW Sec 4 Twp. 31S Rg. 29W West
1515' feet from North line of Section
75' feet from West line of Section
(Circled directions from nearest outside corner boundaries)

OPERATOR: License # 32119

IS SECTION X REGULAR IRREGULAR?
(Spot well on the Section Plat on Reverse Side)
County: Meade

Name: Northern Natural Gas Co.
Address: 1111 South 103rd St
City/State/Zip: Omaha, NE 68013

Contact Person: Duane Moody

Lease Name: Pennington Well #: 3

Phone: 402-398-7843

Facility Name: Pennington Well #3

CONTRACTOR: License #: 32775

Ground Surface Elevation: 2736 MSL
Cathodic Borehole Total Depth 120' ft.
Depth to Bedrock 48' ft.

Name: McLeans CP Installation, Inc.

WATER INFORMATION:

Type Drilling Equipment: X Mud Rotary Other
Other Air Rotary Other

Aquifer Penetration: X None Single Multiple
Depth to bottom of fresh water: 140 ft.
Depth to bottom of usable water: 480 ft.
Water well within one-quarter mile: yes no
Public water supply well within one mile: yes no
Water Source for Drilling Operations:
well farm pond stream X other

CONSTRUCTION FEATURES

Length of Cathodic Surface (Non-Metallic) Casing
Planned to be set: 20' ft.

Length of Conductor pipe (if any): 10" - 100'

Size of the borehole (I.D.): 10" inches

Cathodic surface casing size: 10" inches

Cathodic surface casing centralizers set at depths of: 20;

..... ; ; ; ; ; ; ; ; ; ;

Cathodic surface casing will terminate at:

... Above surface ... Surface Vault X Below Surface Vault

Pitless casing adaptor will be used: Yes No at Depth ... ft.

Anode installation depths are: 98 ; 88 ; 78 ; 68 ;

..... ; ; ; ; ; ; ; ; ; ;

Water Well Location: ...

DWR Permit #: ...

Standard Dimension Ratio (SDR) is = 26

(cathodic surface OD csg. in inches / MW in inches = SDR)

Annular space between borehole and casing will be grouted

with: ... Concrete ... Bentonite Cement

X Heat cement ... Bentonite clay

Anode vent pipe will be set at: 3 ft. above surface

Anode conductor (backfill) material TYPE: SC2

Depth to BASE of Backfill installation material: 120'

Depth to TOP of Backfill installation material: 25'

Note: Non-Aquifer Completion. Max Total Depth = 120'

Total depth of boring must be a minimum of 20' above the top of groundwater

Boring total depth must be reduced if groundwater is encountered. **AFFIDAVIT**

The undersigned hereby affirms that the drilling, completion and eventual plugging of this well will comply with K.S.A. 55-101, et. seq. It is agreed that the following minimum requirements will be met:

1. Notify the appropriate district office prior to spudding of and again before plugging well;
2. A copy of the approved notice of intent to drill shall be posted on each drilling rig;
3. The minimum amount of cathodic surface casing as specified below shall be set by grouting to the top.
4. An agreement between the operator and the district office on plugs and placement is necessary prior to plugging;
5. The appropriate district office will be notified before well is either plugged or casing is grouted in;
6. IN ALL CASES, NOTIFY DISTRICT OFFICE PRIOR TO ANY CEMENTING.

I hereby certify that the statements made herein are true and to the best of my knowledge and belief.

Date: 4-20-05 Signature of Operator or Agent: [Signature] Title: Owner

X WAS: 400' FNL, 75' FWL
IS: 1515' FNL, 75' FWL

FOR KCC USE:
API # 15- <u>119-21156-000</u> Alt-3
Conductor pipe required <u>NONE</u> feet
Minimum cathodic surface casing required <u>20</u> feet
Approved by: <u>2524-27-05/12509427/05</u>
This authorization expires: <u>10-27-05</u>
(This authorization void if drilling not started within 6 months of effective date.)
Spud date: _____ Agent: _____

REMEMBER TO:

- File Drill Pit Application (form CDP-1) with Intent to Install;
- File Completion Form CB-2 within 30 days of spud date;
- Notify appropriate district office 48 hours prior to workover or re-entry;
- Submit plugging report (CB-4) within 30 days after plugging is completed.

Mail to: KCC - Conservation Division, 130 S. Market - Room 2078, Wichita, Kansas 67202-1286.

RECEIVED
KANSAS CORPORATION COMMISSION

APR 22 2005

CONSERVATION DIVISION
WICHITA, KS

RECEIVED

JUL 01 2005

KCC WICHITA

IN ALL CASES PLOT THE INTENDED WELL ON THE PLAT BELOW

Show the relationship to other wells or facilities proposed to be serviced by the intended cathodic borehole. Please show all the wells, existing cathodic boreholes, pipelines or facilities within 1/2 mile of the proposed borehole.

API NO. 15- _____
OPERATOR Northern Natural Gas. LOCATION OF WELL: COUNTY Meade
LEASE Pennington 1515' feet from ~~south~~ north line of section
WELL NUMBER #3 75' feet from ~~east~~ west line of section
FACILITY NAME Pennington Well #3 SECTION 4 TWP 31S RG 29W

SPOT: QTR/QTR/QTR/QTR OF ACREAGE
- NW - SW - NW

IS SECTION X REGULAR or IRREGULAR
IF SECTION IS IRREGULAR, LOCATE WELL FROM NEAREST
CORNER BOUNDARY.

Section corner used: NE NW SE SW

PLAT

(Show location of intended cathodic borehole.)

(Show footage from nearest lease, unit or outside section boundary line.)

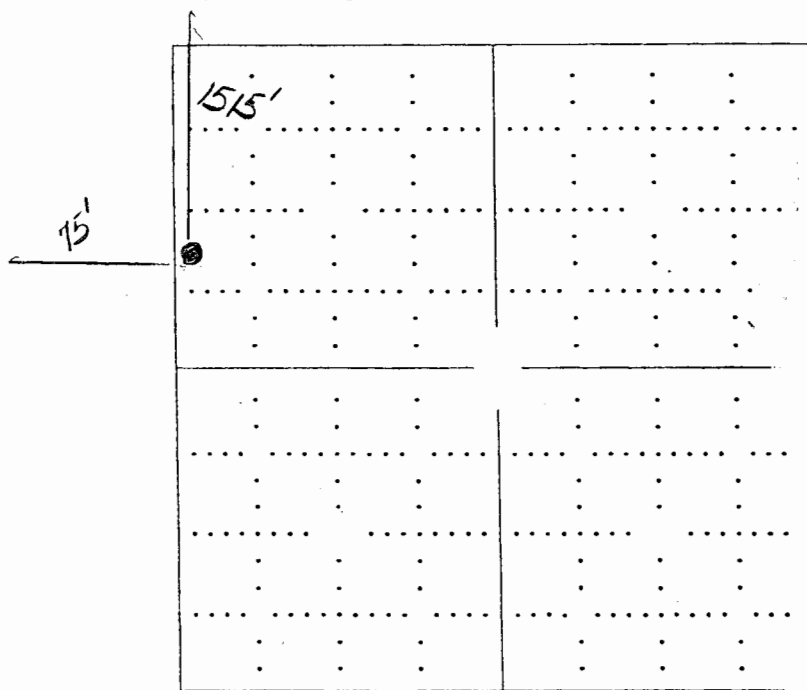

CORRECTED RECEIVED
Section 4 KANSAS CORPORATION COMMISSION

APR 22 2005

CONSERVATION DIVISION
WICHITA KS

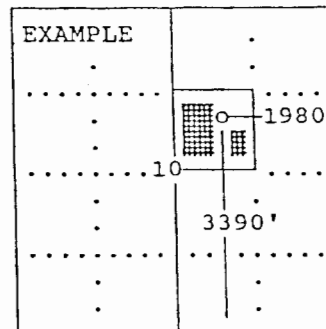

SEWARD CO.

In plotting the proposed location of the well, you must show:

- 1) The manner in which you are using the depicted plat by identifying section lines, i.e. 1 section, 1 section with 8 surrounding sections, 4 sections, etc.;
- 2) the distance of the proposed drilling location from the section's south/north and east/west; and
- 3) the distance to the nearest lease, unit or outside section boundary line.

RECEIVED
JUL 01 2005
KCC WICHITA