

For KCC Use: 10.3.05  
 Effective Date: \_\_\_\_\_  
 District # 4  
 SGA?  Yes  No

KANSAS CORPORATION COMMISSION  
 OIL & GAS CONSERVATION DIVISION  
**NOTICE OF INTENT TO DRILL**

Form C-1  
 September 1999  
 Form must be Typed  
 Form must be Signed  
 All blanks must be Filled

Must be approved by KCC five (5) days prior to commencing well

Expected Spud Date October 1 2005  
month day year

OPERATOR: License# 33019  
 Name: Rosewood Resources, Inc.  
 Address: 2711 N. Haskell Ave. - Suite 2800, LB #22  
 City/State/Zip: Dallas, Texas 75204  
 Contact Person: Jenni Trietsch  
 Phone: 214-756-6607

CONTRACTOR: License# 33532  
 Name: Advanced Drilling Technologies LLC

Well Drilled For:	Well Class:	Type Equipment:
<input type="checkbox"/> Oil	<input type="checkbox"/> Enh Rec	<input checked="" type="checkbox"/> Infield
<input checked="" type="checkbox"/> Gas	<input type="checkbox"/> Storage	<input type="checkbox"/> Pool Ext.
<input type="checkbox"/> QWO	<input type="checkbox"/> Disposal	<input type="checkbox"/> Wildcat
<input type="checkbox"/> Seismic;	<input type="checkbox"/> # of Holes	<input type="checkbox"/> Other
<input type="checkbox"/> Other		

If OWWO: old well information as follows:  
 Operator: \_\_\_\_\_  
 Well Name: \_\_\_\_\_  
 Original Completion Date: \_\_\_\_\_ Original Total Depth: \_\_\_\_\_

Directional, Deviated or Horizontal wellbore?  Yes  No  
 If Yes, true vertical depth: \_\_\_\_\_  
 Bottom Hole Location: \_\_\_\_\_  
 KCC DKT #: \_\_\_\_\_

Spot NW - NE - SE Sec. 8 Twp. 3 S. R. 41W  
 East  
 West  
2190 feet from S (circle one) Line of Section  
1100 feet from E (circle one) Line of Section  
 Is SECTION  Regular  Irregular?

(Note: Locate well on the Section Plat on reverse side)  
 County: Cheyenne  
 Lease Name: Alvin Well #: 33-08  
 Field Name: St Francis  
 Is this a Prorated / Spaced Field?  Yes  No  
 Target Formation(s): Niobrara  
 Nearest Lease or unit boundary: 450'  
 Ground Surface Elevation: 3609 feet MSL  
 Water well within one-quarter mile:  Yes  No  
 Public water supply well within one mile:  Yes  No  
 Depth to bottom of fresh water: ~~200~~ 225  
 Depth to bottom of usable water: ~~200~~ 225  
 Surface Pipe by Alternate: xxx 1 2  
 Length of Surface Pipe Planned to be set: 275' Min.  
 Length of Conductor Pipe required: None  
 Projected Total Depth: 2000  
 Formation at Total Depth: Niobrara  
 Water Source for Drilling Operations:  
 Well \_\_\_\_\_ Farm Pond \_\_\_\_\_ Other XXX  
 DWR Permit #: \_\_\_\_\_  
 (Note: Apply for Permit with DWR )  
 Will Cores be taken?  Yes  No  
 If Yes, proposed zone: \_\_\_\_\_

**AFFIDAVIT**

The undersigned hereby affirms that the drilling, completion and eventual plugging of this well will comply with K.S.A. 55-101, et. seq.  
 It is agreed that the following minimum requirements will be met:

1. Notify the appropriate district office *prior* to spudding of well;
2. A copy of the approved notice of intent to drill *shall be* posted on each drilling rig;
3. The minimum amount of surface pipe as specified below *shall be set* by circulating cement to the top; in all cases surface pipe *shall be set* through all unconsolidated materials plus a minimum of 20 feet into the underlying formation.
4. If the well is dry hole, an agreement between the operator and the district office on plug length and placement is necessary *prior to plugging*;
5. The appropriate district office will be notified before well is either plugged or production casing is cemented in;
6. If an ALTERNATE II COMPLETION, production pipe shall be cemented from below any usable water to surface within **120 days** of spud date. *In all cases, NOTIFY district office* prior to any cementing.

I hereby certify that the statements made herein are true and to the best of my knowledge and belief.

Date: September 27, 2005 Signature of Operator or Agent: Jenni Trietsch Title: Senior Accountant

For KCC Use ONLY  
 API # 15 - 023-20638-0000  
 Conductor pipe required NONE feet  
 Minimum surface pipe required 275 feet per Alt. 1 2  
 Approved by RJP 9-28-05  
 This authorization expires: 3-28-06  
(This authorization void if drilling not started within 6 months of ~~effective~~ date.)  
 Spud date: \_\_\_\_\_ Agent: \_\_\_\_\_

**Remember to:**

- File Drill Pit Application (form CDP-1) with Intent to Drill;
- File Completion Form ACO-1 within 120 days of spud date;
- File acreage attribution plat according to field proration orders;
- Notify appropriate district office 48 hours prior to workover or re-entry;
- Submit plugging report (CP-4) after plugging is completed;
- Obtain written approval before disposing or injecting salt water.

2  
 3  
 4  
 5

**IN ALL CASES PLOT THE INTENDED WELL ON THE PLAT BELOW**

*Plat of acreage attributable to a well in a prorated or spaced field*

*If the intended well is in a prorated or spaced field, please fully complete this side of the form. If the intended well is in a prorated or spaced field complete the plat below showing that the well will be properly located in relationship to other wells producing from the common source of supply. Please show all the wells and within 1 mile of the boundaries of the proposed acreage attribution unit for gas wells and within 1/2 mile of the boundaries of the proposed acreage attribution unit for oil wells.*

API No. 15 - \_\_\_\_\_  
Operator: Rosewood Resources, Inc.  
Lease: Alvin  
Well Number: 33-08  
Field: St Francis

Number of Acres attributable to well: 160  
QTR / QTR / QTR of acreage: NW - NE - SE

Location of Well: County: Cheyenne  
2190 feet from S / N (circle one) Line of Section  
1100 feet from E / W (circle one) Line of Section  
Sec. 8 Twp. 3 S. R. 41W  East  West

Is Section  Regular or  Irregular

If Section is Irregular, locate well from nearest corner boundary.  
Section corner used:  NE  NW  SE  SW

**PLAT**

*(Show location of the well and shade attributable acreage for prorated or spaced wells.)  
(Show footage to the nearest lease or unit boundary line.)*

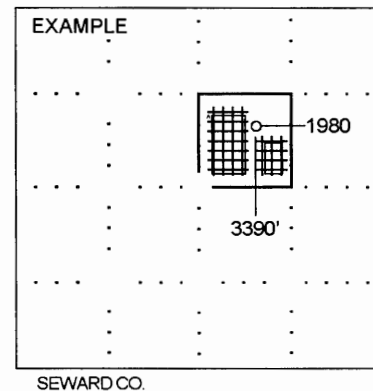
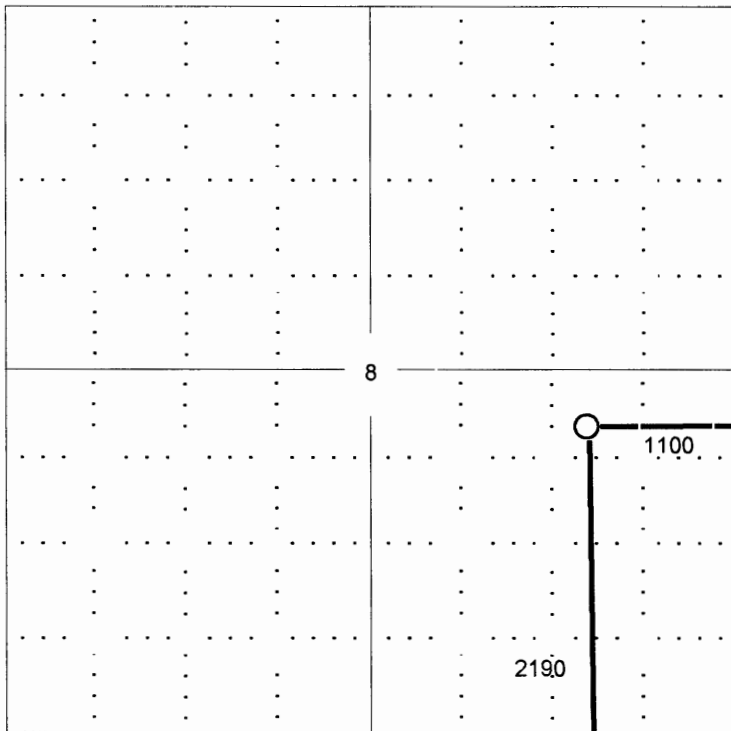

**NOTE:** In all cases locate the spot of the proposed drilling locaton.

**In plotting the proposed location of the well, you must show:**

1. The manner in which you are using the depicted plat by identifying section lines, i.e. 1 section, 1 section with 8 surrounding sections, 4 sections, etc.
2. The distance of the proposed drilling location from the section's south / north and east / west.
3. The distance to the nearest lease or unit boundary line.
4. If proposed location is located within a prorated or spaced field a certificate of acreage attribution plat must be attached: (CO-7 for oil wells; CG-8 for gas wells).