

For KCC Use:

Effective Date:

District #

SGA? ☒ Yes ☐ No

KANSAS CORPORATION COMMISSION
OIL & GAS CONSERVATION DIVISION

NOTICE OF INTENT TO DRILL

Must be approved by KCC five (5) days prior to commencing well

Form C-1
December 2002
Form must be Typed
Form must be Signed
All blanks must be Filled

Expected Spud Date: 9-29-05

OPERATOR: License# 33517

Name: Kansas Production EQR, LLC

Address: 15425 N. Freeway, Suite 230

City/State/Zip: Houston, TX 77090

Contact Person: Jeff Stevenson

Phone: 281/875-6200

CONTRACTOR: License# 33286

Name: Bart Lorenz

Well Drilled For:

☐ Oil

☐ Enh Rec

☒ Infield

Type Equipment:

☐ Mud Rotary

☒ Gas

☐ Storage

☐ Pool Ext.

☒ Air Rotary

☐ OWWO

☐ Disposal

☐ Wildcat

☐ Cable

☐ Seismic; # of Holes

☐ Other

☐ Other

If OWWO: old well information as follows:

Operator:

Well Name:

Original Completion Date: Original Total Depth:

Directional, Deviated or Horizontal wellbore? ☐ Yes ☒ No

If Yes, true vertical depth: KANSAS CORPORATION COMMISSION

Bottom Hole Location:

KCC DKT #: SEP 26 2005

CONSERVATION DIVISION
WICHITA, KS

AFFIDAVIT

The undersigned hereby affirms that the drilling, completion and eventual plugging of this well will comply with K.S.A. 55 et. seq.

It is agreed that the following minimum requirements will be met:

1. Notify the appropriate district office **prior** to spudding of well;
2. A copy of the approved notice of intent to drill **shall be** posted on each drilling rig;
3. The minimum amount of surface pipe as specified below **shall be set** by circulating cement to the top; in all cases surface pipe **shall be set** through all unconsolidated materials plus a minimum of 20 feet into the underlying formation.
4. If the well is dry hole, an agreement between the operator and the district office on plug length and placement is necessary **prior to plugging**;
5. The appropriate district office will be notified before well is either plugged or production casing is cemented in;
6. If an ALTERNATE II COMPLETION, production pipe shall be cemented from below any usable water to surface within **120 days** of spud date.
Or pursuant to Appendix "B" - Eastern Kansas surface casing order #133,891-C, which applies to the KCC District 3 area, alternate II cementing must be completed within 30 days of the spud date or the well shall be plugged. **In all cases, NOTIFY district office** prior to any cementing.

I hereby certify that the statements made herein are true and to the best of my knowledge and belief.

Date: 9-26-05

Signature of Operator or Agent: Jeff Stevenson

Title: Operations Manager

For KCC Use ONLY

API # 15 - 125 - 30 860 - 0000

Conductor pipe required: NONE feet

Minimum surface pipe required: 20 feet per Alt. 2

Approved by: RJP 9-28-05

This authorization expires: 3-28-06

(This authorization void if drilling not started within 6 months of approval date.)

Spud date: Agent:

Remember to:

- File Drill Pit Application (form CDP-1) with Intent to Drill;
- File Completion Form ACO-1 within 120 days of spud date;
- File acreage attribution plat according to field proration orders;
- Notify appropriate district office 48 hours prior to workover or re-entry;
- Submit plugging report (CP-4) after plugging is completed;
- Obtain written approval before disposing or injecting salt water.
- If this permit has expired (See: authorized expiration date) please check the box below and return to the address below.

☐ Well Not Drilled - Permit Expired

Signature of Operator or Agent:

Date:

Mail to: KCC - Conservation Division, 130 S. Market - Room 2078, Wichita, Kansas 67202

27 53 163

IN ALL CASES PLOT THE INTENDED WELL ON THE PLAT BELOW*Plat of acreage attributable to a well in a prorated or spaced field*

If the intended well is in a prorated or spaced field, please fully complete this side of the form. If the intended well is in a prorated or spaced field complete the plat below showing that the well will be properly located in relationship to other wells producing from the common source of supply. Please show all the wells and within 1 mile of the boundaries of the proposed acreage attribution unit for gas wells and within 1/2 mile of the boundaries of the proposed acreage attribution unit for oil wells.

API No. 15 - _____
 Operator: Kansas Production EQR, LLC
 Lease: Obrien Sewell
 Well Number: 5-27
 Field: Jefferson-Sycamore

Number of Acres attributable to well: _____
 QTR / QTR / QTR of acreage: NE - NW - SE

RECEIVED
 KANSAS CORPORATION COMMISSION

SEP 26 2005

Location of Well: County: Montgomery
2180 feet from ☐ N / ☒ S Line of Section
815 feet from ☐ E / ☒ W Line of Section
 Sec. 27 Twp. 33 S. R. 16 ☒ East ☐ West

Is Section: ☒ Regular or ☒ Irregular

If Section is Irregular, locate well from nearest corner boundary.

Section corner used: ☐ NE ☐ NW ☐ SE ☒ SW

CONSERVATION DIVISION
 (Show location of the well and shade attributable acreage for prorated or spaced wells.)
PLAT
 (Show footage to the nearest lease or unit boundary line.)

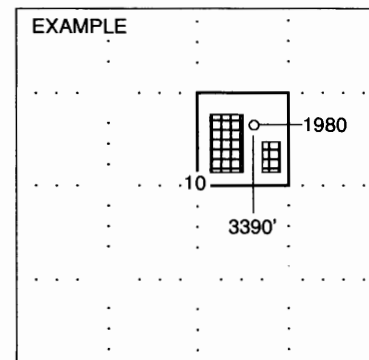
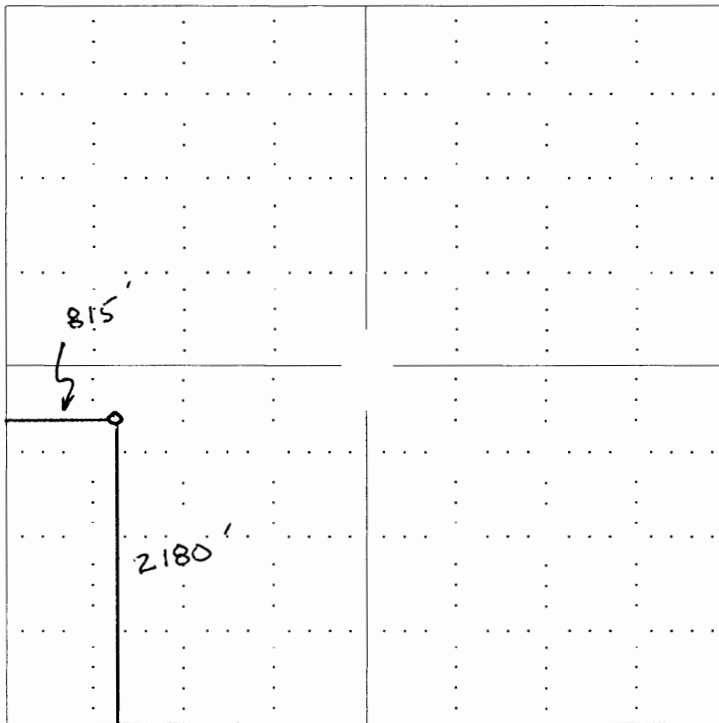

SEWARD CO.

NOTE: In all cases locate the spot of the proposed drilling location.

In plotting the proposed location of the well, you must show:

1. The manner in which you are using the depicted plat by identifying section lines, i.e. 1 section, 1 section with 8 surrounding sections, 4 sections, etc.
2. The distance of the proposed drilling location from the section's south / north and east / west.
3. The distance to the nearest lease or unit boundary line.
4. If proposed location is located within a prorated or spaced field a certificate of acreage attribution plat must be attached: (CO-7 for oil wells; CG-8 for gas wells).