

FOR KCC USE:

FORM CB-1 12/93

FORM MUST BE TYPED

FORM MUST BE SIGNED

ALL BLANKS MUST BE FILLED IN

EFFECTIVE DATE: 10-22-05

State of Kansas

CATHODIC PROTECTION BOREHOLE INTENT

DISTRICT # 1

Must be approved by the K.C.C. sixty (60) days prior to commencing well.

SGA? Yes No

Expected Spud (Starting) Date 10-31-05

Spot (Location) Q/Q/Q NE NE NE Sec 20 Twp 28S Rg 36W East 105 feet from South North line of Section

OPERATOR: License # 32782

59 feet from East West line of Section (Circle directions from nearest outside corner boundaries)

Name: Duke Energy Field Services

IS SECTION X REGULAR IRREGULAR?

Address: Post Office Box 189

(Spot well on the Section Plat on Reverse Side)

City/State/Zip: Forgan, OK 73938

County: Grant

Contact Person: Larry Busby

Lease Name: Cognac NE Well #: #1

Phone: (620) 482-3752

Facility Name: Cognac NE

CONTRACTOR: License #: 32775

Ground Surface Elevation: MSL

Name: McLean's C.P. Installation, Inc.

Cathodic Borehole Total Depth 200 ft

Type Drilling Equipment: X Mud Rotary Cable Air Rotary Other

Depth to Bedrock 2090 EST ft

CONSTRUCTION FEATURES

WATER INFORMATION:

Length of Cathodic Surface (Non-Metallic) Casing Planned to be set: 20 ft. Length of Conductor pipe (if any?): 17 1/2" - 20' 10" - 180' Size of the borehole (I.D.): 1.0 inches Cathodic surface casing size: 1.0 inches Cathodic surface casing centralizers set at depths of: 20;

Aquifer Penetration: X None Single Multiple Depth to bottom of fresh water: 140

Depth to bottom of usable water: 1000 Water well within one-quarter mile: X yes no Public water supply well within one mile: yes X no

Water Source for Drilling Operations: well farm pond stream X other

Water Well Location: DWR Permit #: Standard Dimension Ratio (SDR) is = 26 (cathodic surface OD csg. in inches / MWT in inches = SDR)

Cathodic surface casing will terminate at: X Below Surface Vault

Annular space between borehole and casing will be grouted with: Concrete Bentonite Cement X Neat cement Bentonite clay

Pitless casing adaptor will be used: No at Depth ft.

Anode vent pipe will be set at: .3 ft. above surface

Anode installation depths are: 188', 168', 148', 128', 108'

Anode conductor (backfill) material TYPE: Carbo 60

NON-AQUIFER COMPLETION. BASE OF BORING MUST BE A MINIMUM OF 20 FEET ABOVE TOP OF GROUNDWATER (GW) DO NOT PENETRATE TOP OF GW IF GW IS ENCOUNTERED THE BASE OF THE BORING MUST BE CHANGED (RJP/KCC)

Depth to BASE of Backfill installation material: 200'

Depth to TOP of Backfill installation material: 20'

AFFIDAVIT

MAX TD = 200 (SEE NOTE)

The undersigned hereby affirms that the drilling, completion and eventual plugging of this well will comply with K.S.A. 55-101, et. seq. It is agreed that the following minimum requirements will be met:

- 1. Notify the appropriate district office prior to spudding of and again before plugging well;
2. A copy of the approved notice of intent to drill shall be posted on each drilling rig;
3. The minimum amount of cathodic surface casing as specified below shall be set by grouting to the top.
4. An agreement between the operator and the district office on plugs and placement is necessary prior to plugging;
5. The appropriate district office will be notified before well is either plugged or casing is grouted in;
6. IN ALL CASES, NOTIFY DISTRICT OFFICE PRIOR TO ANY CEMENTING.

I hereby certify that the statements made herein are true and to the best of my knowledge and belief. Date: 10-20-05 Signature of Operator or Agent: Larry Cowth title: Office

FOR KCC USE: API # 15- 065-21617-0000A 1-3 Conductor pipe required NONE feet Minimum cathodic surface casing required 25 feet Approved by: RJP-12-05 This authorization expires: 4.17.06 (This authorization void if drilling not started within 6 months of effective date.) Spud date: Agent:

RECEIVED KANSAS CORPORATION COMMISSION

OCT 11 2005

CONSERVATION DIVISION WICHITA, KS

REMEMBER TO:

- File Drill Pit Application (form CDP-1) with Intent to Install;
- File Completion Form CB-2 within 30 days of spud date;
- Notify appropriate district office 48 hours prior to workover or re-entry;
- Submit plugging report (CB-4) within 30 days after plugging is completed.

Mail to: KCC - Conservation Division, 130 S. Market - Room 2078, Wichita, Kansas 67202-1286.

OCT 11 2005

CONSERVATION DIVISION
WICHITA, KS

IN ALL CASES PLOT THE INTENDED WELL ON THE PLAT BELOW

Show the relationship to other wells or facilities proposed to be serviced by the intended cathodic borehole. Please show all the wells, existing cathodic boreholes, pipelines or facilities within 1/2 mile of the proposed borehole.

API NO. 15- _____
OPERATOR Duke Energy Field Services LOCATION OF WELL: COUNTY Grant
LEASE Cognac NE 105' feet from south/north line of section
WELL NUMBER #1 59' feet from east/west line of section
FACILITY NAME Cognac NE SECTION 20 TWP 28S RG 36W

SPOT: QTR/QTR/QTR/QTR OF ACREAGE
_____ - NE - NE - NE

IS SECTION X REGULAR or _____ IRREGULAR
IF SECTION IS IRREGULAR, LOCATE WELL FROM NEAREST CORNER BOUNDARY.

Section corner used: _____ NE _____ NW _____ SE _____ SW

PLAT

(Show location of intended cathodic borehole.)

(Show footage from nearest lease, unit or outside section boundary line.)

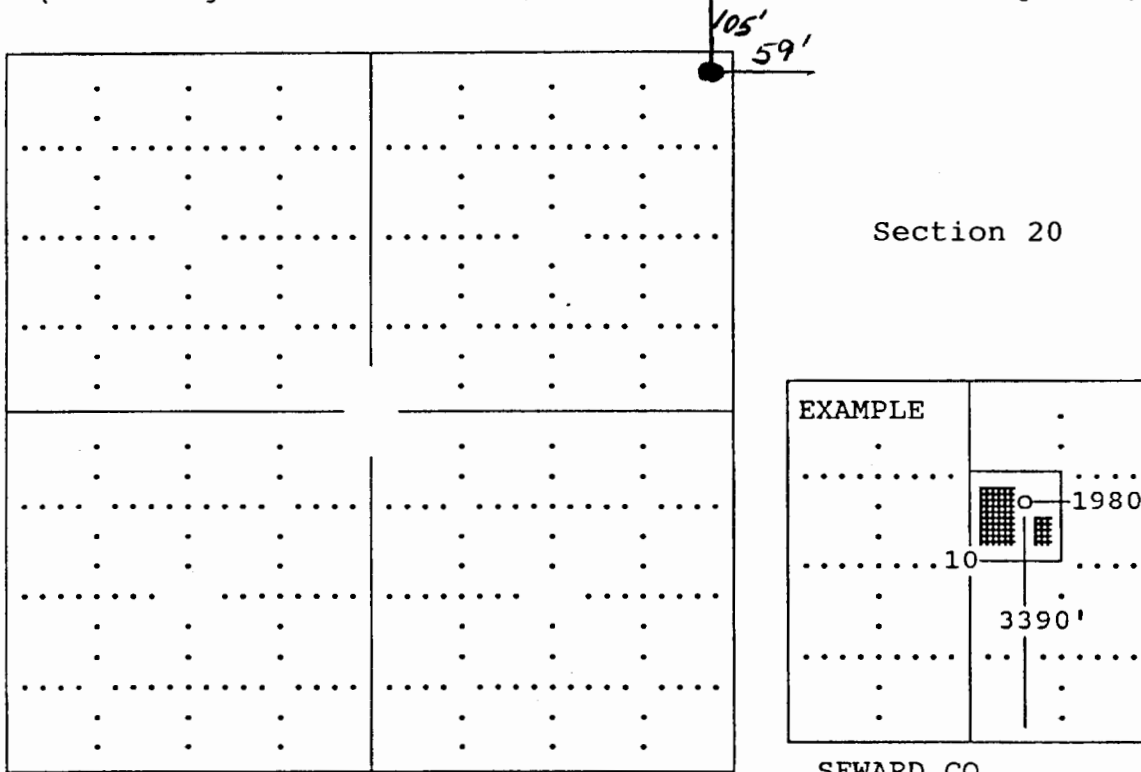

In plotting the proposed location of the well, you must show:

- 1) The manner in which you are using the depicted plat by identifying section lines, i.e. 1 section, 1 section with 8 surrounding sections, 4 sections, etc.;
- 2) the distance of the proposed drilling location from the section's south/north and east/west; and
- 3) the distance to the nearest lease, unit or outside section boundary line.