

RECEIVED

JUL 15 2005

Form C-1
December 2002

File KCC Use: 10-17-05
Effective Date: 10-17-05
District #: 2
SGA? Yes No

KANSAS CORPORATION COMMISSION
OIL & GAS CONSERVATION DIVISION

NOTICE OF INTENT TO DRILL

KCC WICHITA

Form must be Typed
Form must be Signed
All blanks must be Filled

Must be approved by KCC five (5) days prior to commencing well

APPROX 100' W of

Expected Spud Date September 05
month day year

Spot NE SW SW Sec. 16 Twp. 17 S. R. 1
 East
 West
890' feet from N / S Line of Section
890' feet from E / W Line of Section
Is SECTION Regular Irregular?

OPERATOR: License# 6819
Name: Scott's Well Service
Address: P. O. Box 136
City/State/Zip: Roxbury, Kansas 67476
Contact Person: Jay Scott
Phone: 785 254-7828

(Note: Locate well on the Section Plat on reverse side)
County: McPherson
Lease Name: Everhart Well #: 1
Field Name: Henne

CONTRACTOR: License# 32701
Name: C & G Drilling Co.

Is this a Prorated / Spaced Field? Yes No
Target Formation(s): Mississippi

Well Drilled For: Oil Gas QWWD Seismic; # of Holes Other
 Enh Rec Storage Disposal
Well Class: Infield Pool Ext. Wildcat Other
Type Equipment: Mud Rotary Air Rotary Cable

Nearest Lease or unit boundary: 330'
Ground Surface Elevation: 1302 feet MSL

Water well within one-quarter mile: Yes No
Public water supply well within one mile: Yes No

If OWWO: old well information as follows:
Operator: _____
Well Name: _____
Original Completion Date: _____ Original Total Depth: _____

Depth to bottom of fresh water: 40'
Depth to bottom of usable water: 180'

Surface Pipe by Alternate: 1 2
Length of Surface Pipe Planned to be set: 250'

Directional, Deviated or Horizontal wellbore? Yes No
If Yes, true vertical depth: _____
Bottom Hole Location: _____
KCC DKT #: _____

Projected Total Depth: 2700
Formation at Total Depth: 2630

Water Source for Drilling Operations:
 Well Farm Pond Other _____

DWR Permit #: _____
(Note: Apply for Permit with DWR)

Will Cores be taken? Yes No
If Yes, proposed zone: _____

AFFIDAVIT

The undersigned hereby affirms that the drilling, completion and eventual plugging of this well will comply with K.S.A. 55 et. seq.

It is agreed that the following minimum requirements will be met:

- 1. Notify the appropriate district office **prior** to spudding of well;
- 2. A copy of the approved notice of intent to drill **shall be** posted on each drilling rig;
- 3. The minimum amount of surface pipe as specified below **shall be set** by circulating cement to the top; in all cases surface pipe **shall be set** through all unconsolidated materials plus a minimum of 20 feet into the underlying formation.
- 4. If the well is dry hole, an agreement between the operator and the district office on plug length and placement is necessary **prior to plugging**;
- 5. The appropriate district office will be notified before well is either plugged or production casing is cemented in;
- 6. If an ALTERNATE II COMPLETION, production pipe shall be cemented from below any usable water to surface within **120 days** of spud date.
Or pursuant to Appendix "B" - Eastern Kansas surface casing order #133,891-C, which applies to the KCC District 3 area, alternate II cementing must be completed within 30 days of the spud date or the well shall be plugged. **In all cases, NOTIFY district office** prior to any cementing.

I hereby certify that the statements made herein are true and to the best of my knowledge and belief.

Date: 7-13-05 Signature of Operator or Agent: Jay Scott Title: Partner

For KCC Use ONLY
API # 15 - 113-21301-00-00
Conductor pipe required NONE feet
Minimum surface pipe required 200 feet per Alt. 1
Approved by: RJB 10-17-05
This authorization expires: 4-17-06
(This authorization void if drilling not started within 6 months of effective date.)
Spud date: _____ Agent: _____

Remember to:

- File Drill Pit Application (form CDP-1) with Intent to Drill;
- File Completion Form ACO-1 within 120 days of spud date;
- File acreage attribution plat according to field proration orders;
- Notify appropriate district office 48 hours prior to workover or re-entry;
- Submit plugging report (CP-4) after plugging is completed;
- Obtain written approval before disposing or injecting salt water.
- If this permit has expired (See: authorized expiration date) please check the box below and return to the address below.

Well Not Drilled - Permit Expired
Signature of Operator or Agent: _____
Date: _____

16
17
18

RECEIVED

JUL 15 2005

KCC WICHITA

IN ALL CASES PLOT THE INTENDED WELL ON THE PLAT BELOW

Plat of acreage attributable to a well in a prorated or spaced field

If the intended well is in a prorated or spaced field, please fully complete this side of the form. If the intended well is in a prorated or spaced field complete the plat below showing that the well will be properly located in relationship to other wells producing from the common source of supply. Please show all the wells and within 1 mile of the boundaries of the proposed acreage attribution unit for gas wells and within 1/2 mile of the boundaries of the proposed acreage attribution unit for oil wells.

API No. 15 _____
Operator: Scott's Well Service
Lease: Everhart
Well Number: 1
Field: Henne

Location of Well: County: McPherson
990' _____ feet from N / S Line of Section
890' _____ feet from E / W Line of Section
Sec. 16 Twp. 17 S. R. 1 East West

Number of Acres attributable to well: _____
QTR / QTR / QTR of acreage: NE - SW - SW

Is Section: Regular or Irregular

If Section is Irregular, locate well from nearest corner boundary.

Section corner used: NE NW SE SW

PLAT

*(Show location of the well and shade attributable acreage for prorated or spaced wells.)
(Show footage to the nearest lease or unit boundary line.)*

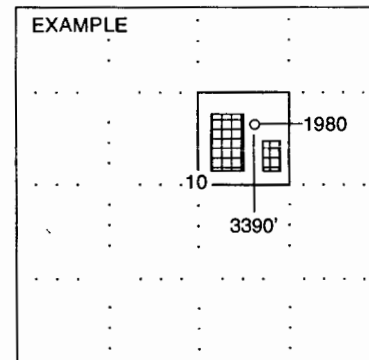
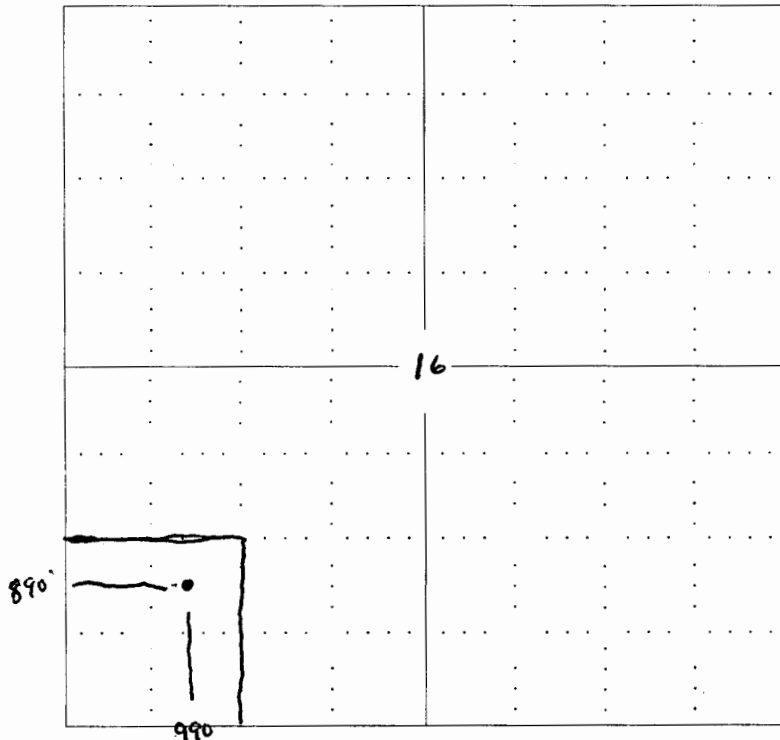

NOTE: In all cases locate the spot of the proposed drilling location.

In plotting the proposed location of the well, you must show:

1. The manner in which you are using the depicted plat by identifying section lines, i.e. 1 section, 1 section with 8 surrounding sections, 4 sections, etc.
2. The distance of the proposed drilling location from the section's south / north and east / west.
3. The distance to the nearest lease or unit boundary line.
4. If proposed location is located within a prorated or spaced field a certificate of acreage attribution plat must be attached: (C0-7 for oil wells; CG-8 for gas wells).

KANSAS

CORPORATION COMMISSION

KATHLEEN SEBELIUS, GOVERNOR

BRIAN J. MOLINE, CHAIR

ROBERT E. KREHBIEL, COMMISSIONER

MICHAEL C. MOFFET, COMMISSIONER

October 17, 2005

Mr. Jay Scott
Scott's Well Service
PO Box 136
Roxbury, KS 67476

Re: Drilling Pit Application
Everhart Lease Well No. 1
SW/4 Sec. 16-17S-01W
McPherson County, Kansas

Dear Mr. Scott:

District staff has inspected the above referenced location and has determined that the reserve pit shall be constructed **without slots**, the bottom shall be flat and reasonably level, and **all pits must be lined with bentonite**. The free fluids must be removed. The fluids are to be removed from the reserve pit as soon as the Hutchinson Salt section has been drilled through and displacement of the fluids into the reserve pit has occurred. The fluids should be removed again within 72 hours after drilling operations have ceased.

If production casing is set all completion fluids shall be removed on a daily basis.

The fluids should be taken to an authorized disposal well. Please call the District Office at (316) 630-4000 when the fluids have been removed. Please file form CDP-5, Exploration and Production Waste Transfer, within 30 days of fluid removal. Conservation division forms are available through our office and on the KCC web site: www.kcc.state.ks.us/conservation/forms.

A copy of this letter should be posted in the doghouse along with the approved Intent to Drill. If you have any questions or concerns please feel free to contact the undersigned at the above address.

Sincerely,



Kathy Haynes
Environmental Protection and Remediation Department

cc: Doug Louis