

# CORRECTED

For KCC Use:  
Effective Date: 6-6-05  
District #: 3  
SGA?  Yes  No

## KANSAS CORPORATION COMMISSION OIL & GAS CONSERVATION DIVISION

Form C-1  
December 2002  
Form must be Typed  
Form must be Signed  
All blanks must be Filled

### NOTICE OF INTENT TO DRILL

Must be approved by KCC five (5) days prior to commencing well

*\*Corrected location*

Expected Spud Date 10 29 2005  
month day year

OPERATOR: License# 5150  
Name: COLT ENERGY, INC.  
Address: P O BOX 388  
City/State/Zip: IOLA, KS 66749  
Contact Person: DENNIS KERSHNER  
Phone: 620-365-3111

CONTRACTOR: License# 5675  
Name: MCPHERSON DRILLING

Well Drilled For:	Well Class:	Type Equipment:
<input type="checkbox"/> Oil	<input type="checkbox"/> Enh Rec	<input type="checkbox"/> Infield
<input checked="" type="checkbox"/> Gas	<input type="checkbox"/> Storage	<input checked="" type="checkbox"/> Pool Ext.
<input type="checkbox"/> OWWO	<input type="checkbox"/> Disposal	<input type="checkbox"/> Wildcat
<input type="checkbox"/> Seismic; # of Holes	<input type="checkbox"/> Other	<input type="checkbox"/> Mud Rotary
<input type="checkbox"/> Other		<input checked="" type="checkbox"/> Air Rotary
		<input type="checkbox"/> Cable

If OWWO: old well information as follows:  
Operator: \_\_\_\_\_  
Well Name: \_\_\_\_\_  
Original Completion Date: \_\_\_\_\_ Original Total Depth: \_\_\_\_\_

Directional, Deviated or Horizontal wellbore?  Yes  No

If Yes, true vertical depth: \_\_\_\_\_

Bottom Hole Location: \_\_\_\_\_

KCC DKT #: \_\_\_\_\_

*WAS: 660' FNL, 1980' FEL NWNE  
IS: 330' FNL, 660' FEL N1/2NE*

#### AFFIDAVIT

The undersigned hereby affirms that the drilling, completion and eventual plugging of this well will comply with K.S.A. 55 et. seq.

It is agreed that the following minimum requirements will be met:

1. Notify the appropriate district office *prior* to spudding of well;
2. A copy of the approved notice of intent to drill *shall be* posted on each drilling rig;
3. The minimum amount of surface pipe as specified below *shall be set* by circulating cement to the top; in all cases surface pipe *shall be set* through all unconsolidated materials plus a minimum of 20 feet into the underlying formation.
4. If the well is dry hole, an agreement between the operator and the district office on plug length and placement is necessary *prior to plugging*;
5. The appropriate district office will be notified before well is either plugged or production casing is cemented in;
6. If an ALTERNATE II COMPLETION, production pipe shall be cemented from below any usable water to surface within **120 days** of spud date. Or pursuant to Appendix "B" - Eastern Kansas surface casing order #133,891-C, which applies to the KCC District 3 area, alternate II cementing must be completed within 30 days of the spud date or the well shall be plugged. *In all cases, NOTIFY district office prior to any cementing.*

I hereby certify that the statements made herein are true and to the best of my knowledge and belief.

Date: 10-5-05 Signature of Operator or Agent: Dennis Kershner Title: OFFICE MANAGER

For KCC Use ONLY	
API # 15 -	<u>125-30778-0000</u>
Conductor pipe required	<u>NONE</u> feet
Minimum surface pipe required	<u>20</u> feet per Alt. <sup>②</sup>
Approved by	<u>RJP 10-1-05 / RJP 10-26-05</u>
This authorization expires:	<u>12-1-05</u>
<small>(This authorization void if drilling not started within 6 months of effective date.)</small>	
Spud date:	Agent:

Spot NE 1/4 NE - NE Sec. 15 Twp. 33 S. R. 17  East  West  
X 330 feet from  N /  S Line of Section  
X 660 feet from  E /  W Line of Section  
Is SECTION Regular  Irregular?

(Note: Locate well on the Section Plat on reverse side)

County: MONTGOMERY

Lease Name: R KING Well #: 2-15

Field Name: COFFEYVILLE- CHERRYVALE

Is this a Prorated / Spaced Field?  Yes  No

Target Formation(s): MISSISSIPPI

Nearest Lease or unit boundary: 660

Ground Surface Elevation: 797 feet MSL

Water well within one-quarter mile:  Yes  No

Public water supply well within one mile:  Yes  No

Depth to bottom of fresh water: 150

Depth to bottom of usable water: 200

Surface Pipe by Alternate:  1  2

Length of Surface Pipe Planned to be set: 20'

Length of Conductor Pipe required: NONE

Projected Total Depth: 1100

Formation at Total Depth: MISSISSIPPI

Water Source for Drilling Operations:

Well  Farm Pond Other  X

DWR Permit #: \_\_\_\_\_

(Note: Apply for Permit with DWR )

Will Cores be taken?  Yes  No

If Yes, proposed zone: \_\_\_\_\_

*\* NEW CD-1 FILED FOR THIS LOCATION (RSP/KCC)*

#### Remember to:

- File Drill Pit Application (form CDP-1) with Intent to Drill;
  - File Completion Form ACO-1 within 120 days of spud date;
  - File acreage attribution plat according to field proration orders;
  - Notify appropriate district office 48 hours prior to workover or re-entry;
  - Submit plugging report (CP-4) after plugging is completed;
  - Obtain written approval before disposing or injecting salt water.
- If this permit has expired (See: authorized expiration date) please check the box below and return to the address below.

Well Not Drilled - Permit Expired

Signature of Operator or Agent: \_\_\_\_\_

Date: \_\_\_\_\_

Mail to: KCC - Conservation Division, 130 S. Market - Room 207B, Wichita, Kansas 67202

15  
33  
17E

**IN ALL CASES PLOT THE INTENDED WELL ON THE PLAT BELOW**

Plat of acreage attributable to a well in a prorated or spaced field

*x Corrected Location*

If the intended well is in a prorated or spaced field, please fully complete this side of the form. If the intended well is in a prorated or spaced field complete the plat below showing that the well will be properly located in relationship to other wells producing from the common source of supply. Please show all the wells and within 1 mile of the boundaries of the proposed acreage attribution unit for gas wells and within 1/2 mile of the boundaries of the proposed acreage attribution unit for oil wells.

API No. 15 - \_\_\_\_\_  
 Operator: COLT ENERGY, INC.  
 Lease: R KING  
 Well Number: 2-15  
 Field: COFFEYVILLE- CHERRYVALE  
 Number of Acres attributable to well: N/A  
 QTR / QTR / QTR of acreage: NE - NE - NE

Location of Well: County: MONTGOMERY  
 x 330 feet from  N /  S Line of Section  
 x 660 feet from  E /  W Line of Section  
 Sec. 15 Twp. 33 S. R. 17  East  West  
 Is Section:  Regular or  Irregular  
 If Section is Irregular, locate well from nearest corner boundary.  
 Section corner used:  NE  NW  SE  SW

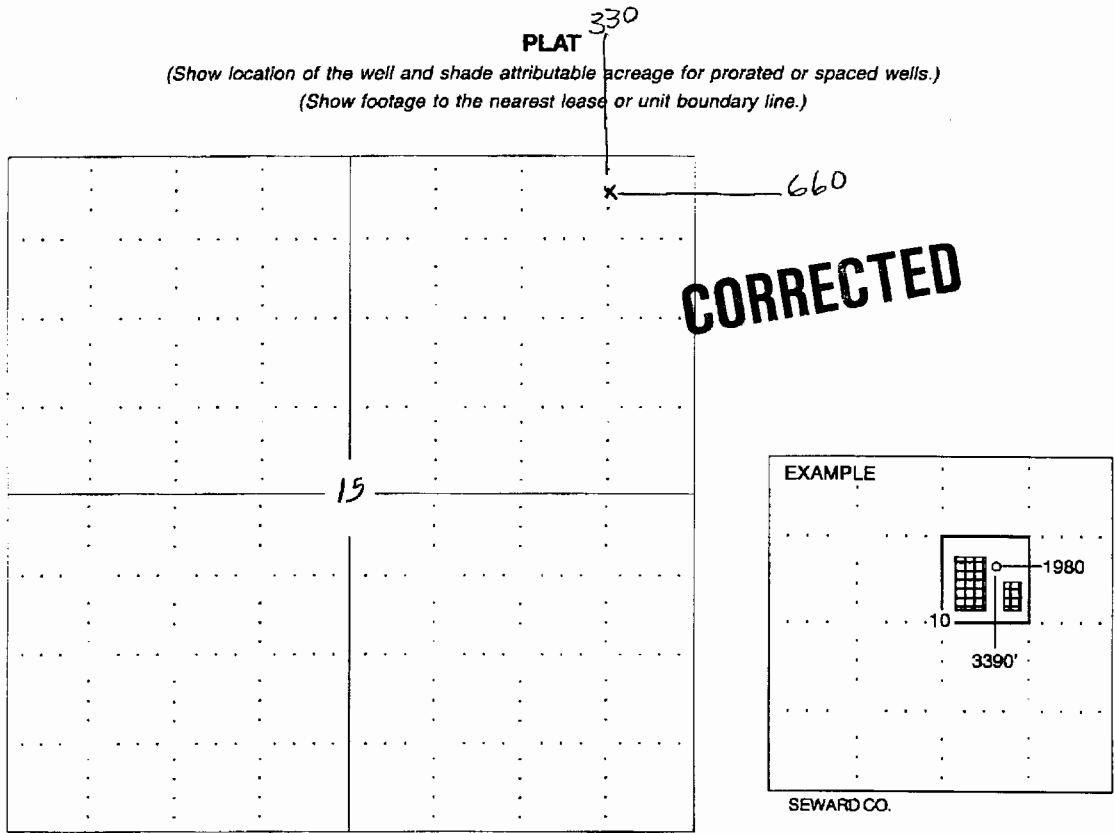

**NOTE: In all cases locate the spot of the proposed drilling locaton.**

**In plotting the proposed location of the well, you must show:**

1. The manner in which you are using the depicted plat by identifying section lines, i.e. 1 section, 1 section with 8 surrounding sections, 4 sections, etc.
2. The distance of the proposed drilling location from the section's south / north and east / west.
3. The distance to the nearest lease or unit boundary line.
4. If proposed location is located within a prorated or spaced field a certificate of acreage attribution plat must be attached: (C0-7 for oil wells; CG-8 for gas wells).