

STATE CORPORATION COMMISSION OF KANSAS  
OIL & GAS CONSERVATION DIVISION

WELL COMPLETION OR RECOMPLETION FORM  
ACO-1 WELL HISTORY

DESCRIPTION OF WELL AND LEASE

Operator: license # 6393  
name Brougher Oil, Inc.  
address P.O. Drawer 1367  
City/State/Zip Great Bend, Kansas 67530

Operator Contact Person Mr. Joe E. Brougher  
Phone 316-793-5610

Contractor: license # 6394  
name Mohawk Drilling, Inc.

Wellsite Geologist Mr. Brent B. Reinhardt  
Phone 316-793-5610

PURCHASER N. C. R. A.

Designate Type of Completion  
 New Well  Re-Entry  Workover

- Oil  SWD  Temp Abd
- Gas  Inj  Delayed Comp.
- Dry  Other (Core, Water Supply etc.)

If OWWO: old well info as follows:  
Operator  
Well Name  
Comp. Date Old Total Depth

WELL HISTORY

Drilling Method:  Mud Rotary  Air Rotary  Cable  
10/30/84 11/8/84 1/11/85  
Spud Date Date Reached TD Completion Date

4862 (LTD) None  
Total Depth PBTD

Amount of Surface Pipe Set and Cemented at 432' feet

Multiple Stage Cementing Collar Used?  Yes  No

If Yes, Show Depth Set feet

If alternate 2 completion, cement circulated from feet depth to w/ SX cmt

API NO. 15-193-20,319-00-00  
County Thomas  
C SE NW Sec 13 Twp 6s Rge 36w XX West  
(location)

3300 Ft North from Southeast Corner of Section  
3300 Ft West from Southeast Corner of Section  
(Note: locate well in section plat below)

Lease Name Miller 'B' Well# 2

Field Name WNW Ext. W W M

Producing Formation Pawnee

Elevation: Ground 3339' KB 3349'

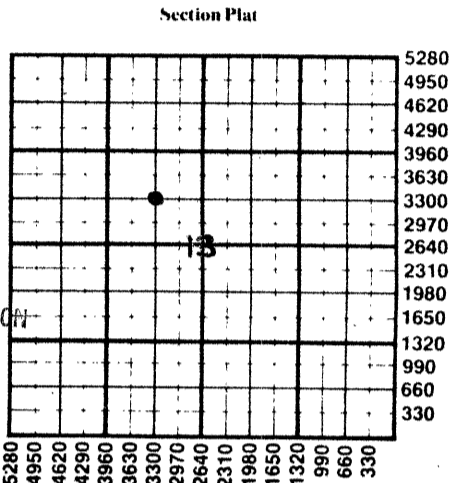

RECEIVED  
STATE CORPORATION COMMISSION  
JAN 24 1985  
CONSERVATION DIVISION  
Wichita, Kansas

WATER SUPPLY INFORMATION

Source of Water:  
Division of Water Resources Permit # T84-712

Groundwater Near 3300 Ft North From Southeast Corner and  
(Well) 3300 Ft. West From Southeast Corner of  
Sec 13 Twp 6s Rge 36w  East  West

Surface Water Ft North From Southeast Corner and  
(Stream, Pond etc.) Ft West From Southeast Corner  
Sec Twp Rge  East  West

Other (explain) (purchased from city, R.W.D.#)

Disposition of Produced Water:  Disposal  Repressuring  
Docket #

**INSTRUCTIONS:** This form shall be completed in duplicate and filed with the Kansas Corporation Commission, 200 Colorado Derby Building, Wichita, Kansas 67202, within 90 days after completion or recompletion of any well. Rules 82-3-130 and 82-3-107 apply.  
Information on side two of this form will be held confidential for a period of 12 months if requested in writing and submitted with the form. See rule 82-3-107 for confidentiality in excess of 12 months.  
One copy of all wireline logs and drillers time log shall be attached with this form. Submit CP-4 form with all plugged wells. Submit CP-111 form with all temporarily abandoned wells.

All requirements of the statutes, rules, and regulations promulgated to regulate the oil and gas industry have been fully complied with and the statements herein are complete and correct to the best of my knowledge.

Signature Brent B. Reinhardt  
Title Company Geologist Date 1/22/85

Subscribed and sworn to before me this 23 day of Jan 19 85

Notary Public Jeri Pebley  
Date Commission Expires 6-9-86

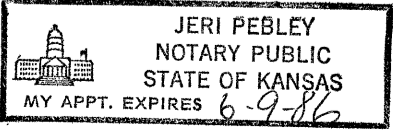

K.C.C. OFFICE USE ONLY  
F  Letter of Confidentiality Attached  
C  Wireline Log Received  
C  Drillers Timelog Received  
Distribution  
 KCC  SWD/Rep  NGPA  
 KGS  Plug  Other (Specify)

Sec. 13 Twp. 6s Rge. 36w

SIDE TWO

Operator Name Brougner Oil, Inc. Lease Name Miller 'B' Well# 2 SEC 13 TWP 6s RGE 36w  East  West

WELL LOG

**INSTRUCTIONS:** Show important tops and base of formations penetrated. Detail all cores. Report all drill stem tests giving interval tested, time tool open and closed, flowing and shut-in pressures, whether shut-in pressure reached static level, hydrostatic pressures, bottom hole temperature, fluid recovery, and flow rates if gas to surface during test. Attach extra sheet if more space is needed. Attach copy of log.

Drill Stem Tests Taken  Yes  No  
 Samples Sent to Geological Survey  Yes  No  
 Cores Taken  Yes  No

Formation Description  
 Log  Sample  
 Name DEPTH DATUM  
~~Top~~ ~~Bottom~~

Drill Stem Test #1 (3843-3890) Tarkio  
 TIMES: 30" : 30" : 30" : 30"  
 REC: 2' Mud  
 SIP: 66#/49# HP: 1904#/1839#  
 FP: 33-33#/33-33# BHT: 110°F

Drill Stem Test #2 (4510-4550) Pawnee "A"  
 TIMES: 45" : 45" : 45" : 45"  
 REC: 93' Gas in Pipe  
 30' Clean Oil  
 62' Heavy Oil Cut Mud  
 62' Slight Oil Cut Mud (2% Oil, 98% Mud)  
 SIP: 556#/540# HP: 2213#/2262#  
 FP: 33-69#/82-90# BHT: 122°F

Drill Stem Test #3 (4555-4595) Pawnee "B"  
 TIMES: 45" : 30" : 30" : 30"  
 REC: 3' Oil Specked Mud  
 SIP: 278#/172# HP: 2360#/2360#  
 FP: 8-33#/25-25# BHT: 121°F

Stone Corral	2974	+ 375
Base/Stone Corral	3008	+ 341
Tarkio	3870	- 521
Burlingame	3940	- 591
Howard	3994	- 645
Topeka	4032	- 683
Queen Hill	4122	- 773
Heebner	4161	- 812
Toronto	4194	- 845
Lansing	4210	- 861
BKC	4462	-1113
Marmaton	4470	-1121
Pawnee	4520	-1171
Ft Scott	4603	-1254
Cherokee	4664	-1315
Conglomerate	4709	-1360
Mississippian	4809	-1460
RTD	4860	-1511
LTD	4862	-1513

Welex, Inc.:  
 Compensated Density, Dual Spaced  
 Neutron, Dual Induction, CAL.

CASING RECORD <input checked="" type="checkbox"/> new <input type="checkbox"/> used							
Report all strings set - conductor, surface, intermediate, production, etc.							
Purpose of string	size hole drilled	size casing set (in O.D.)	weight lbs/ft.	setting depth	type of cement	# sacks used	type and percent additives
Surface (N)	12 1/4"	8 5/8"	24#	432'	60/40 Poz	300	2%Gel, 3%CC...
Production (N)	7 7/8"	5 1/2"	14#	4862'	50/50 Poz	200	2%Gel, 10%Salt, .75%CFR
PERFORATION RECORD				Acid, Fracture, Shot, Cement Squeeze Record			
shots per foot	specify footage of each interval perforated			(amount and kind of material used)			Depth
3	4521-4525			AC: 500 gals (15% Ne) FRAC: 160 sacks 20/40 sand			4525'
TUBING RECORD				Liner Run <input type="checkbox"/> Yes <input type="checkbox"/> No			
size 2 3/8" set at 4857		packer at None					
Date of First Production	Producing method <input type="checkbox"/> flowing <input checked="" type="checkbox"/> pumping <input type="checkbox"/> gas lift <input type="checkbox"/> Other (explain)						
1/11/85							
Estimated Production Per 24 Hours	Oil	Gas	Water	Gas-Oil Ratio	Gravity		
7	Bbls	MCF	100	Bbls	CFPB		

Disposition of gas:  vented  sold  used on lease  
 METHOD OF COMPLETION:  open hole  perforation  other (specify) \_\_\_\_\_  
 PRODUCTION INTERVAL: Pawnee: 4521-4525  
 Dually Completed.  
 Commingled