

15-193-20228-00-00

WELL PLUGGING RECORD

Give All Information Completely
Make Required Affidavit

COUNTY Thomas SEC. 28 TWP. 6S RGE. 36W E/W
Location as in quarters or footage from lines:
C NW NW

Locate Well
correctly on above
Section Platt.

Lease Owner Abercrombi Drilling, Inc.
Lease Name H.L. HAYES Well No. 1
Office Address 801 Union Center, Wichita, KS 67202
Character of Well (Completed as Oil, Gas or Dry Hole): Dry Hole
Date Well Completed September 26, 1981
Application for plugging filed September 26, 1981
Plugging commenced September 26, 1981
Plugging completed September 26, 1981

Reason for abandonment of well or producing formation
No commercial quantity of oil or gas encountered.

Was permission obtained from the Conservation Division or it's
Agent's before plugging was commenced? YES

Name of Conservation Agent who supervised plugging of this well Carl Goodrow

Producing formation _____ Depth to top _____ bottom T.D. 4971'

Show depth and thickness of all water, oil and gas formations.

OIL, GAS OR WATER RECORDS

Casing Record

Formation	Content	From	To	Size	Put in	Pulled Out

Describe in detail the manner in which the well was plugged, indicating where the mud fluid was placed and the method or methods used in introducing it into the hold. If cement or other plugs were used, state the character of same and depth placed, from _____ feet to _____ feet for each plug set.

Set 1st plug @ 1900' with 70 sx.
Set 2nd plug @ 420' with 40 sx.
Set 3rd plug @ 40' with 10 sx.
5 sx in Rathole. 50-50- posmix, 6% gel.

Plug was down @ 2:00 p.m., 9/26/81.

(If additional description is necessary, use BACK of this sheet)
Name of Plugging Contractor Abercrombie Drilling, Inc.

RECEIVED
STATE CORPORATION COMMISSION

STATE OF Kansas COUNTY OF Sedgwick, ss.

Jack L. Partridge, Vice Pres. (employee of owner) or (owner or operator of
above-described well, being first duly sworn on oath, says: That I have knowledge of the
facts, statements, and matters herein contained and the log of the above-described well as
filed and that the same are true and correct. So help me God.

(Signature) Jack L. Partridge
801 Union Center, Wichita, KS 67202
(Address)

SUBSCRIBED AND SWORN TO before me this 29th day of September, 19 81

My Commission expires: 7-13-85

Elizabeth G. Terry
Elizabeth G. Terry

Notary Public

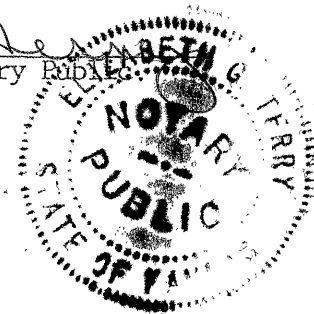

KANSAS

WELL COMPLETION REPORT AND
DRILLER'S LOG

API No. 15 — 193 — 20,228 00-00
County Number

S. 28 T. 6S R. 36W ^E_W
Loc. C NW NW
County Thomas

Operator Abercrombie Drilling, Inc.
Address 801 Union Center, Wichita, KS 67202
Well No. 1 Lease Name H.L. HAYES
Footage Location 660 feet from (N) (S) line 660 feet from (E) (W) line
Principal Contractor Abercrombie Drilling, Inc. Geologist _____
Spud Date 9/20/81 Date Completed 9/26/81 Total Depth 4971' P.B.T.D. _____
Directional Deviation _____ Oil and/or Gas Purchaser _____

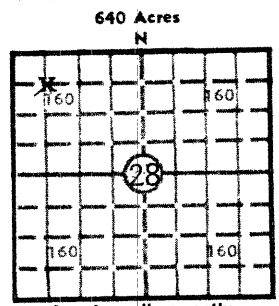

Locate well correctly
Elev.: Gr. 3393'
DF _____ KB 3398'

CASING RECORD

Report of all strings set — surface, intermediate, production, etc.

Purpose of string	Size hole drilled	Size casing set (in O.D.)	Weight lbs/ft.	Setting depth	Type cement	Sacks	Type and percent additives
Surface	12 1/4"	8 5/8"	20#	403'	60-40 posmix	75	2% gel, 3% c.c.

LINER RECORD

PERFORATION RECORD

Top, ft.	Bottom, ft.	Sacks cement	Shots per ft.	Size & type	Depth interval

TUBING RECORD

Size	Setting depth	Packer set at

ACID, FRACTURE, SHOT, CEMENT SQUEEZE RECORD

Amount and kind of material used	Depth interval treated

RECEIVED
STATE CORPORATION COMMISSION

OCT 13 1981

INITIAL PRODUCTION

CONSERVATION DIVISION
Wichita, Kansas

Date of first production _____ Producing method (flowing, pumping, gas lift, etc.) _____
RATE OF PRODUCTION PER 24 HOURS
Oil _____ bbls. Gas _____ MCF Water _____ bbls. Gas-oil ratio _____ CFPB
Disposition of gas (vented, used on lease or sold) _____ Producing interval (s) _____

INSTRUCTIONS: As provided in KCC Rule 82-2-125, within 90 days after completion of a well, one completed copy of this Drillers Log shall be transmitted to the State Geological Survey of Kansas, 4150 Monroe Street, Wichita, Kansas 67209. Copies of this form are available from the Conservation Division, State Corporation Commission, 245 No. Water, Wichita, Kansas 67202. Phone AC 316-522-2206. If confidential custody is desired, please note Rule 82-2-125. Drillers Logs will be on open file in the Oil and Gas Division, State Geological Survey of Kansas, Lawrence, Kansas 66044.

Operator
Abercrombie Drilling, Inc.

DESIGNATE TYPE OF COMP.: OIL, GAS,
DRY HOLE, SWDW, ETC.:
Dry Hole

Well No.

1

Lease Name

H.L. HAYES

S 28 T 6S R 36W E
W

WELL LOG

Show all important zones of porosity and contents thereof; cored intervals, and all drill-stem tests, including depth interval tested, cushion used, time tool open, flowing and shut-in pressures, and recoveries.

SHOW GEOLOGICAL MARKERS, LOGS RUN,
OR OTHER DESCRIPTIVE INFORMATION.

FORMATION DESCRIPTION, CONTENTS, ETC.

TOP

BOTTOM

NAME

DEPTH

Clay, Sand & Shale
Shale
Shale & Sand
Shale
Anhydrite
Shale
Lime & Shale
Shale & Lime
Lime & Shale
Lime
Lime & Shale
Lime
Rotary Total Depth

0
405
1864
2489
3039
3075
3680
4101
4260
4550
4644
4786
4971
4971

SAMPLE TOPS:

Anhydrite 3039' (+ 359)
B/Anhydrite 3075' (+ 323)
Wabaunsee 3845' (- 447)
Tarkio 3932' (- 534)
Topeka 4089' (- 691)
Heebner 4224' (- 826)
Toronto 4256' (- 858)
Lansing 4275' (- 877)
B/KC 4548' (-1150)
Marmaton 4560' (-1162)
Pawnee 4638' (-1240)
Ft. Scott 4668' (-1270)
Cher. Sh. 4696' (-1298)

ELECTRIC LOG TOPS:

Anhydrite 3035' (+ 363)
B/Anhydrite 3070' (+ 328)
Heebner 4226' (- 828)
Toronto 4262' (- 864)
Lansing 4280' (- 882)
Stark Sh. 4479' (-1081)
B/KC 4564' (-1166)
Marmaton 4574' (-1176)
Pawnee 4655' (-1257)
Ft. Scott 4690' (-1292)
Cherokee Sh. 4720' (-1322)
Miss. 4918' (-1520)
LTD 4968'
RTD 4971'

RECEIVED
STATE CORPORATION COMMISSION

OCT 13 1981
CONSERVATION DIVISION
Wichita, Kansas

USE ADDITIONAL SHEETS, IF NECESSARY, TO COMPLETE WELL RECORD.

Date Received

Paul J. Pate
Signature

Vice President

Title

September 30, 1981

Date