

TYPE

AFFIDAVIT OF COMPLETION FORM

ACO-1 WELL HISTORY

Compt. \_\_\_\_\_

SIDE ONE

Two (2) copies of this form shall be filed with the Kansas Corporation Commission, 200 Colorado Derby Building, Wichita, Kansas 67202, within thirty (30) days after the completion of a well, regardless of how the well was completed.

F Attach separate letter of request if the information is to be held confidential. If confidential, only file one copy. Information on Side One will be of public record and Side Two will then be held confidential.

Applications must be made on dual completion, commingling, salt water disposal, injection and temporarily abandoned wells.

C x Attach one copy only wireline logs (i.e. electrical log, sonic log, gamma ray neutron log, etc.). (Rules 82-2-105 & 82-2-125) KCC# (316) 263-3238.

LICENSE # 5562 EXPIRATION DATE 6-30-83

OPERATOR Liberty Enterprises, Inc. API NO. 15-163-21,791 -0000

ADDRESS 308 West Mill COUNTY Rooks

Plainville, Ks 67663 FIELD

\*\* CONTACT PERSON Charles G. Comeau PROD. FORMATION PHONE 913-434-4686

PURCHASER LEASE Kriley

ADDRESS WELL NO. #6

WELL LOCATION SE SE SE

DRILLING Pioneer Drilling Company, Inc. 330 Ft. from South Line and

CONTRACTOR ADDRESS 308 West Mill 330 Ft. from East Line of

Plainville, Ks 67663 the SE/4 (Qtr.) SEC 20 TWP 7s RGE 17W.

PLUGGING Pioneer Drilling Company, Inc. (John Walker) WELL PLAT

CONTRACTOR ADDRESS 308 West Mill

Plainville, Ks 67663

TOTAL DEPTH 3400' PBTD

SPUD DATE 9-11-82 DATE COMPLETED 9-19-82

ELEV: GR DF 1821' KB 1824'

DRILLED WITH (CABLE) (ROTARY) (AIR) TOOLS.

DOCKET NO. OF DISPOSAL OR REPRESSURING WELL BEING USED TO DISPOSE OF WATER FROM THIS LEASE

Amount of surface pipe set and cemented 261' DV Tool Used?

THIS AFFIDAVIT APPLIES TO: (Circle ONE) - Oil, Gas, Shut-in Gas, Dry, Disposal, Injection, Temporarily Abandoned, OWWO. Other

ALL REQUIREMENTS OF THE STATUTES, RULES AND REGULATIONS PROMULGATED TO REGULATE THE OIL AND GAS INDUSTRY HAVE BEEN FULLY COMPLIED WITH.

A F F I D A V I T

David L. Comeau, being of lawful age, hereby certifies that:

I am the Affiant, and I am familiar with the contents of the foregoing Affidavit. The statements and allegations contained therein are true and correct.

Signature of David L. Comeau

(Name)

David L. Comeau

SUBSCRIBED AND SWORN TO BEFORE ME this 23rd day of September

1982

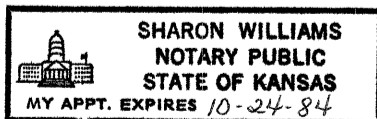

MY COMMISSION EXPIRES:

Notary Seal for Sharon Williams, State of Kansas, Commission Expires 10-24-84, SEP 29 1982, CONSERVATION DIVISION, Wichita, Kansas

\*\* The person who can be reached by phone regarding any questions concerning this information.

9-29-82

SIDE TWO

ACO-1 WELL HISTORY

OPERATOR Liberty Enterprises, Inc, LEASE Kriley #6 SEC. 20 TWP. 7s RGE. 17W

FILL IN WELL INFORMATION AS REQUIRED:

WELL NO. #6

Show all important zones of porosity and contents thereof; cored intervals, and all drill-stem tests, including depth interval tested, cushion used, time tool open, flowing and shut-in pressures, and recoveries.

SHOW GEOLOGICAL MARKERS, LOGS RUN, OR OTHER DESCRIPTIVE INFORMATION.

FORMATION DESCRIPTION, CONTENTS, ETC.	TOP	BOTTOM	NAME	DEPTH
Check if no Drill Stem Tests Run.			Anhydrite	1261 (+563)
			Topeka	2769 (-945)
rock, shale and sand	0'	159'	Heebner	2983 (-1159)
sand and shales	159'	262'	Toronto	3005 (-1181)
sand and shale	262'	700'	Lansing KC	3026 (-1202)
shales and sands	700'	1261'	Base KC	3259 (-1435)
anhydrite	1261'	1292'	Arbuckle	3375 (-1551)
shales	1292'	1308'	RTD	3397 (-1573)
shales	1308'	1660'		
shale and lime	1660'	1772'		
shales and limes	1772'	1957'		
shale and lime	1957'	2129'		
lime and shale	2129'	2332'		
lime and shales	2332'	2460'		
lime and shale	2460'	2596'		
lime and shale	2596'	2731'		
lime and shale	2731'	2846'		
lime and shale	2846'	2956'		
lime and shale	2956'	3034'		
lime and shale	3034'	3105'		
lime and shale	3105'	3171'		
lime and shale	3171'	3242'		
lime and shale	3242'	3290'		
lime and shale	3290'	3345'		
limes and shales	3345'	3400'		
	3400'	R.T.D.		

DST #1  
Interval: 3251 - 3290  
30-30-30-30  
Recovered 20' drilling mud  
Initial BHP 125#  
Final BHP 108#  
Initial FP 41-50#  
Final FP 50-50#

If additional space is needed use Page 2, Side 2

Report of all strings set— surface, intermediate, production, etc. CASING RECORD (New) or ~~USED~~

Purpose of string	Size hole drilled	Size casing set (in O.D.)	Weight lbs/ft.	Setting depth	Type cement	Sacks	Type and percent additives
Surface Casing	12 1/4"	8 5/8"	24#	261'	60-40pos	160	2%gel 3%cc

LINER RECORD			PERFORATION RECORD		
Top, ft.	Bottom, ft.	Sacks cement	Shots per ft.	Size & type	Depth interval

TUBING RECORD		
Size	Setting depth	Packer set at

ACID, FRACTURE, SHOT, CEMENT SQUEEZE RECORD

Amount and kind of material used	Depth interval treated

Date of first production	Producing method (flowing, pumping, gas lift, etc.)	Gravity
--------------------------	---	---------

Estimated Production -I.P.	Oil bbls.	Gas MCF	Water %	Gas-oil ratio bbls.	CFPB
----------------------------	-----------	---------	---------	---------------------	------

Disposition of gas (vented, used on lease or sold)

Perforations

TOM.

Here is a preliminary map to give you an idea what is there.

STOCKTON

Not all on Pump

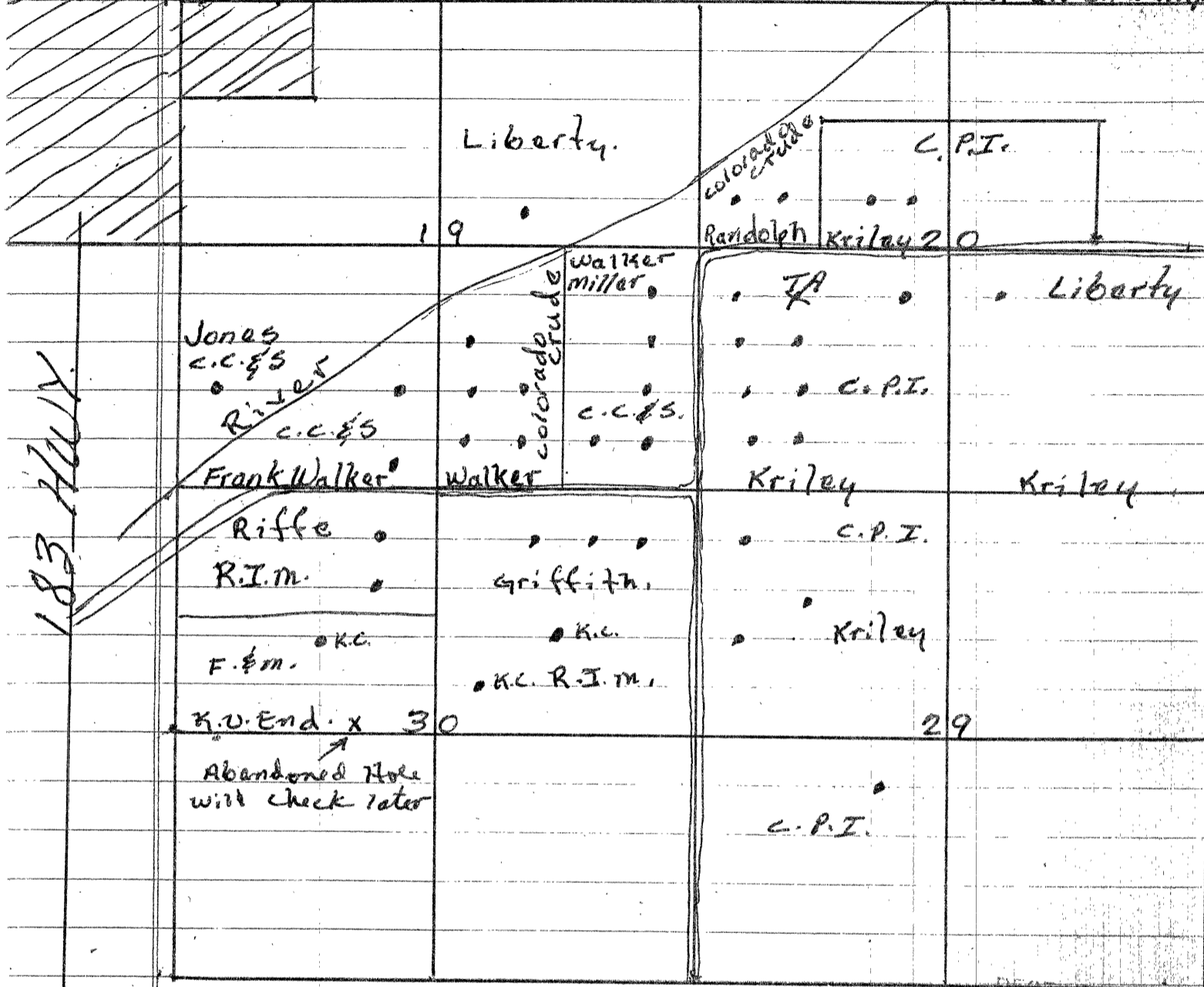

RECEIVED  
STATE CORPORATION COMMISSION

JAN 26 1952

CONSERVATION DIVISION  
Wichita Kansas

c.c.&s. - Chaben, Cory & Scott  
Prod. Kenney Vahige Hays.  
Leroy Berland Plainville.

colorado crude - Operated by c.c.&s  
C.P.I. - Columbia Pet. Inc.

Prod. Carl Barns Hays 913 628 2095  
Prod. Eric Waddell Natoma 913 895 4497  
Liberty R. Comeau Plainville.  
R.I.M. Myrlin Monroe Plainville  
F.&M. Prod. Preston Burkley Russell