

STATE OF KANSAS  
STATE CORPORATION COMMISSION  
CONSERVATION DIVISION  
245 North Water  
WICHITA, KANSAS 67202

Rev. 6-3-74  
FORM CP-1

WELL PLUGGING APPLICATION FORM  
File One Copy

API Number 15 - 163 - 21,248 - 00-00 (of this well)  
Lease Owner Frontier Oil Company  
Address 1720 KSB&T Building, Wichita, Kansas 67202  
Lease (Farm Name) Riffel "D" Well No. 1  
Well Location 150' S of SW/4 SW/4 SE/4 Sec. 12 Twp. 17S<sup>7</sup> Rge. 17W (E) (W) XX  
County Rooks Total Depth 3,370' Field Name \_\_\_\_\_  
Oil Well \_\_\_\_\_ Gas Well \_\_\_\_\_ Input Well \_\_\_\_\_ SWD Well \_\_\_\_\_ Rotary D & A XX  
Well Log attached with this application as required Yes  
Date and hour plugging is desired to begin February 26, 1981 @ 1:30 A.M.

PLUGGING OF THIS WELL WILL BE DONE IN ACCORDANCE WITH K.S.A. 55-128 OF THE RULES AND REGULATIONS OF THE STATE CORPORATION COMMISSION.

Name of company representative authorized to be in charge of plugging operations:

Address \_\_\_\_\_

Plugging Contractor Red Tiger Drilling Company License No. \_\_\_\_\_  
Address 1720 KSB&T Building, Wichita, Kansas 67202

Invoice covering assessment for plugging this well should be sent to:

Name Frontier Oil Company  
Address 1720 KSB&T Building, Wichita, Kansas 67202

and payment will be guaranteed by applicant or acting agent.

FRONTIER OIL COMPANY

Signed: D. Ann Drennan  
Applicant or Acting Agent

Date: 3-6-81

KANSAS

WELL COMPLETION REPORT AND DRILLER'S LOG

API No. 15 — 163 — 21,248-00-00  
 County Number

S. 12 T. 17S R. 17W E  
 W  
 Loc. 150' S of SW/4 SW/4 SE/4  
 County Rooks

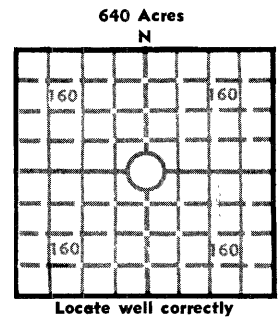

Locate well correctly  
 Elev.: Gr. \_\_\_\_\_  
 DF \_\_\_\_\_ KB 1,856'

Operator  
Frontier Oil Company

Address  
1720 KSB&T Building, Wichita, Kansas 67202

Well No. 1 Lease Name Riffel "D"

Footage Location  
 feet from (N) (S) line \_\_\_\_\_ feet from (E) (W) line \_\_\_\_\_

Principal Contractor Red Tiger Drilling Company Geologist Joel A. Alberts

Spud Date 2/11/81 Date Completed 2/26/81 Total Depth 3,370' P.B.T.D. \_\_\_\_\_

Directional Deviation \_\_\_\_\_ Oil and/or Gas Purchaser \_\_\_\_\_

CASING RECORD

Report of all strings set — surface, intermediate, production, etc.

Purpose of string	Size hole drilled	Size casing set (in O.D.)	Weight lbs/ft.	Setting depth	Type cement	Sacks	Type and percent additives
Surface	12 1/4"	8 5/8"	24#	1,197'	Common	425	2% Gel, 3% C.C.

LINER RECORD

PERFORATION RECORD

Top, ft.	Bottom, ft.	Sacks cement	Shots per ft.	Size & type	Depth interval

TUBING RECORD

Size	Setting depth	Packer set at

ACID, FRACTURE, SHOT, CEMENT SQUEEZE RECORD

Amount and kind of material used	Depth interval treated

INITIAL PRODUCTION

Date of first production \_\_\_\_\_ Producing method (flowing, pumping, gas lift, etc.) \_\_\_\_\_

RATE OF PRODUCTION PER 24 HOURS  
 Oil \_\_\_\_\_ bbls. Gas \_\_\_\_\_ MCF Water \_\_\_\_\_ bbls. Gas-oil ratio \_\_\_\_\_ CFPB

Disposition of gas (vented, used on lease or sold) \_\_\_\_\_ Producing interval (s) \_\_\_\_\_

INSTRUCTIONS: As provided in KCC Rule 82-2-125, within 90 days after completion of a well, one completed copy of this Drillers Log shall be transmitted to the State Geological Survey of Kansas, 4150 Monroe Street, Wichita, Kansas 67209. Copies of this form are available from the Conservation Division, State Corporation Commission, 245 No. Water, Wichita, Kansas 67202. Phone AC 316-522-2206. If confidential custody is desired, please note Rule 82-2-125. Drillers Logs will be on open file in the Oil and Gas Division, State Geological Survey of Kansas, Lawrence, Kansas 66044.

Operator  
Frontier Oil Company

DESIGNATE TYPE OF COMP.: OIL, GAS,  
DRY HOLE, SWDW, ETC.:  
D & A

Well No. 1 Lease Name Riffel 'D'

S 12 T 17 S R 17 W E

**WELL LOG**

Show all important zones of porosity and contents thereof; cored intervals, and all drill-stem tests, including depth interval tested, cushion used, time tool open, flowing and shut-in pressures, and recoveries.

SHOW GEOLOGICAL MARKERS, LOGS RUN, OR OTHER DESCRIPTIVE INFORMATION.

FORMATION DESCRIPTION, CONTENTS, ETC.	TOP	BOTTOM	NAME	DEPTH
Rock & Shale	0	200		
Shale & Sand	200	653		
Shale & Lime Streaks	653	785		
Sand	785	915		
Shale & Lime Streaks	915	1200		
Shale & Sand	1200	1259		
Anhydrite	1259	1261		
Red Bed	1261	1425		
Red Bed & Shale	1425	1576		
Shale	1576	1749		
Shale & Lime Streaks	1749	2110		
Shale & Lime	2110	2283		
Lime	2283	2537		
Shale & Lime	2537	2600		
Lime	2600	3370		
RTD		3370		

USE ADDITIONAL SHEETS, IF NECESSARY, TO COMPLETE WELL RECORD.

Date Received

*J. Ann Brennan*  
Signature

Title

3-6-81  
Date

STATE OF KANSAS

STATE CORPORATION COMMISSION  
CONSERVATION DIVISION  
200 Colorado, Derby Bldg.  
Wichita, Kansas 67202

INVOICE and WELL PLUGGING AUTHORITY

March 13, 1981

INVOICE NUMBER: 4969-W

TO: Frontier Oil Company  
1720 KSB&T Bldg.  
Wichita, KS 67202

15-163-21248-00-00

PLUGGING ASSESSMENT AS FOLLOWS:

Riffel #1-D  
SW SW SE, Sec.12-7S-17W  
Rooks  
Red Tiger Drlg. \$109.53

NOTE: We also need the following before our file is completed:

- \_\_\_\_\_ Well Plugging Record (CP-4)
- \_\_\_\_\_ Well Log
- \_\_\_\_\_ Well Plugging Application (CP-1)

WELL PLUGGING AUTHORITY

Gentlemen:

This is your authority to plug the above subject well in accordance with the rules and regulations of the state corporation commission.

This authority is void after ninety (90) days from the above date.



For Administrator

Mr. Marion Schmidt, 2104 Canterbury Rd., Hays, Ks 67601

is hereby assigned to supervise the plugging of the above mentioned well.

RETURN PINK COPY WITH REMITTANCE