

STATE OF KANSAS
STATE CORPORATION COMMISSION
CONSERVATION DIVISION
P. O. BOX 17027
Wichita, Kansas 67217

Rev. 3-15-72
FORM CP-1
RECEIVED
STATE CORPORATION COMMISSION
JAN 4 1974
01-04-1974
CONSERVATION DIVISION
Wichita, Kansas

WELL PLUGGING APPLICATION FORM
File One Copy

15-163-20499-00-00

Lease Owner T. E. ANDERSON
Address 710 UNION NATIONAL BLDG., WICHITA, KANSAS 67202
Lease (Farm Name) SIMONS Well No. 4
Well Location NW SE SW Sec. 11 Twp. 7S Rge. (E) 17 (W)
County ROOKS Total Depth _____ Field Name _____
Oil Well Gas Well _____ Input Well _____ SWD Well _____ Rotary D & A _____
Well Log filed with application as required YES
Date and hour plugging is desired to begin AUGUST 11, 1973 AT 7:00 P M

PLUGGING OF THIS WELL WILL BE DONE IN ACCORDANCE WITH K.S.A. 55-128 OF THE RULES AND REGULATIONS OF THE STATE CORPORATION COMMISSION.

Name of company representative authorized to be in charge of plugging operations:
LOWELL M. MOORE Address PLAINVILLE, KANSAS 67663

Plugging Contractor C-G DRILLING CO. License No. _____
Address 1107 UNION NATIONAL BLDG., WICHITA, KANSAS 67202

Invoice covering assessment for plugging this well should be sent to:
Name C-G DRILLING CO.
Address 1107 UNION NATIONAL BLDG., WICHITA, KANSAS 67202

and payment will be guaranteed by applicant or acting agent.
C-G DRILLING CO.

Signed: *Phillip L. Anderson*
Applicant or Acting Agent
Date: AUGUST 16, 1973

KANSAS DRILLERS LOG

API No. 15 — ROOKS — 15-163-20499-00-00
County Number

S. 11 T. 7S R. 17W
 Loc. NW SE SW
 County ROOKS

Operator
T E ANDERSON

Address
710 UNION NATIONAL BUILDING, WICHITA, KANSAS

Well No. 4 Lease Name SIMONS

Footage Location
330 feet from ~~XXX~~ ^S line 330 feet from (E) (~~W~~) ^{XX} line

Principal Contractor C-G DRILLING CO. Geologist H. F. FILSON

Spud Date AUGUST 3, 1973 Total Depth 3260' P.B.T.D.

Date Completed AUGUST 11, 1973 Oil Purchaser

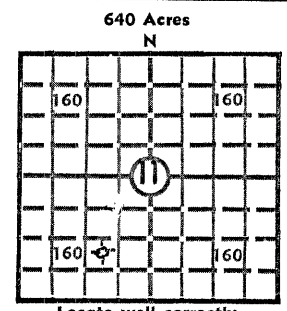

Locate well correctly
 Elev.: Gr. 1886
 DF _____ KB 1891

CASING RECORD

Report of all strings set — surface, intermediate, production, etc.

Purpose of string	Size hole drilled	Size casing set (in O.D.)	Weight lbs/ft.	Setting depth	Type cement	Sacks	Type and percent additives
	<u>12 1/4"</u>	<u>8 5/8"</u>	<u>28#</u>	<u>1239'</u>	<u>60-40 POZMIX</u>	<u>200</u>	<u>3% GEL-3% CA CL</u>
				<u>PLUS</u>	<u>200 COMMON</u>	<u>200</u>	<u>3% GEL</u>

LINER RECORD

PERFORATION RECORD

Top, ft.	Bottom, ft.	Sacks cement	Shots per ft.	Size & type	Depth interval

Size	Setting depth	Packer set at

ACID, FRACTURE, SHOT, CEMENT SQUEEZE RECORD

Amount and kind of material used	Depth interval treated

INITIAL PRODUCTION

Date of first production		Producing method (flowing, pumping, gas lift, etc.)			
RATE OF PRODUCTION PER 24 HOURS	Oil	Gas	Water	Gas-oil ratio	
	bbis.	MCF	bbis.	CFPB	
Disposition of gas (vented, used on lease or sold)			Producing interval (s)		

INSTRUCTIONS: As provided in KCC Rule 82-2-125, within 90 days after completion of a well, one completed copy of this Drillers Log shall be transmitted to the State Geological Survey of Kansas, 4150 Monroe Street, Wichita, Kansas 67209. Copies of this form are available from the Conservation Division, State Corporation Commission, 3830 So. Meridian (P.O. Box 17027), Wichita, Kansas 66217. Phone AC 316-522-2206. If confidential custody is desired, please note Rule 82-2-125. Drillers Logs will be on open file in the Oil and Gas Division, State Geological Survey of Kansas, Lawrence, Kansas 66044.

15-163-20499-00-00

Operator
T E ANDERSON

DRY HOLE, SWDW, ETC.:
DRY HOLE

Well No. 4
Lease Name SIMONS

S 11 T 7 S R 17 W E W

WELL LOG

Show all important zones of porosity and contents thereof; cored intervals, and all drill-stem tests, including depth interval tested, cushion used, time tool open, flowing and shut-in pressures, and recoveries.

SHOW GEOLOGICAL MARKERS, LOGS RUN, OR OTHER DESCRIPTIVE INFORMATION.

FORMATION DESCRIPTION, CONTENTS, ETC.	TOP	BOTTOM	NAME	DEPTH
POST ROCK	0	40		
SAND & SHALE	70	160		
SHALE	160	405		
SAND	405	445		
SAND & SHALE	445	700		
SHALE	700	780		
SAND	780	930		
RED BED & SHALE	930	1235		
ANHYDRITE	1235	1266		
RED BED & SHALE	1266	1715		
LIME & SHALE	1715	2790		
LIME	2790	2893		
LIME & SHALE	2893	2980		
LIME	2980	3260		
<p>DST #1 2872-2893 OPEN 30 SI 45 OPEN 30 SI 45 REC 10' MUD W/SPECKS OIL IBHP 846# FBHP 857# IFP 42# FFP 31# DST #2 2973-3005 OPEN 25 SI 45 OPEN 10 SI 45 REC 2' MUD IBHP 35#, FBHP 23#, IFP 23# FFP 23# DST #3 3002'-3084' OPEN 30 SI 30 OPEN 10 SI 45 REC 25' MUD W/OIL SPECKS IBHP 485#, FBHP 189#, IFP 23#, FFP 35# DST #4 3084'-3260' OPEN 30 SI 45 OPEN 10 SI 45 REC 60' MUD IBHP 754 FBHP 737# IFP 41# FFP 52#</p>				

RECEIVED
STATE CORPORATION COMMISSION
JAN 4 1974
CONSERVATION DIVISION
Wichita, Kansas

USE ADDITIONAL SHEETS, IF NECESSARY, TO COMPLETE WELL RECORD.

Date Received

Signature

Title

Date

State of Kansas



15-163-20499-00-00

State Corporation Commission

CONSERVATION DIVISION

(Oil, Gas and Water)

P. O. Box 17027

3830 S. Meridian

WICHITA, KANSAS 67217

August 14, 1973

WELL PLUGGING AUTHORITY

Well No.	4
Lease	Simons
Description	NW SE SW 11-7-17W
County	Rooks
Total Depth	3260
Plugging Contractor	C-G Drilling

Thornton E. Anderson
710 Union Nat'l Bldg.,
Wichita, Kansas 67202

Gentlemen:

This is your authority to plug the above subject well in accordance with the Rules and Regulations of the State Corporation Commission.

This authority is void after 90 days from the above date.

Yours very truly,

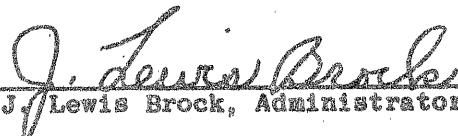
J. Lewis Brock, Administrator

Mr. Leo Massey Box 582 Hays, Kansas

is hereby assigned to supervise the plugging of the above named well.