

SIDE ONE

ORIGINAL

STATE CORPORATION COMMISSION OF KANSAS  
OIL & GAS CONSERVATION DIVISION  
WELL COMPLETION FORM  
ACO-1 WELL HISTORY  
DESCRIPTION OF WELL AND LEASE

API NO. 15- 163-23, 093-00-00  
County Rooks  
NW SE NW Sec. 26 Twp. 7S Rge. 17 X East West

Operator: License # 5140

3630 Ft. North from Southeast Corner of Section

Name: FRONTIER OIL COMPANY

3630 Ft. West from Southeast Corner of Section  
(NOTE: Locate well in section plat below.)

Address 125 N. Market Ste. 1720

Lease Name Reed Well # 1

City/State/Zip Wichita, KS 67202

Field Name Stockton

Purchaser: Koch Oil Company

Producing Formation Topeka

Operator Contact Person: Jean Angle

Elevation: Ground 1761 KB 1766

Phone (316) 263-1201

Total Depth 3100 PBDT 2740

Contractor: Name: RED TIGER DRILLING CO.

License: 5302

Wellsite Geologist: Steve Parker

Designate Type of Completion

- New Well  Re-Entry  Workover
- Oil  SWD  Temp. Abd.
- Gas  Inj  Delayed Comp.
- Dry  Other (Core, Water Supply, etc.)

If OWO: old well info as follows:

Operator: \_\_\_\_\_

Well Name: \_\_\_\_\_

Comp. Date \_\_\_\_\_ Old Total Depth \_\_\_\_\_

Drilling Method:

- Mud Rotary  Air Rotary  Cable

5-21-90 5-30-90 7-6-90

Spud Date Date Reached TD Completion Date

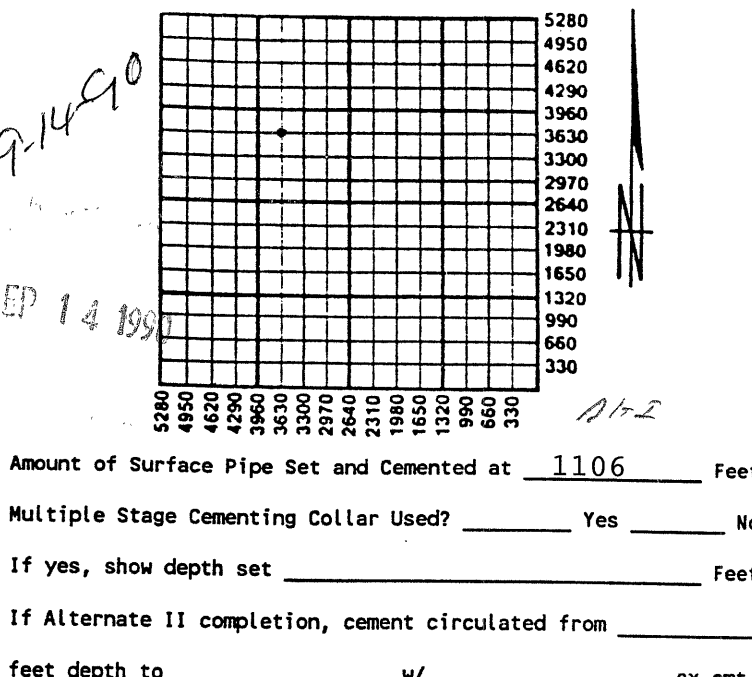

**INSTRUCTIONS:** This form shall be completed in triplicate and filed with the Kansas Corporation Commission, 200 Colorado Derby Building, Wichita, Kansas 67202, within 120 days of the spud date of any well. Rule 82-3-130, 82-3-107 and 82-3-106 apply. Information on side two of this form will be held confidential for a period of 12 months if requested in writing and submitted with the form. See rule 82-3-107 for confidentiality in excess of 12 months. One copy of all wireline logs and drillers time log shall be attached with this form. ALL CEMENTING TICKETS MUST BE ATTACHED. Submit CP-4 form with all plugged wells. Submit CP-111 form with all temporarily abandoned wells. Any recompletion, workover or conversion of a well requires filing of ACO-2 within 120 days from commencement date of such work.

All requirements of the statutes, rules and regulations promulgated to regulate the oil and gas industry have been fully complied with and the statements herein are complete and correct to the best of my knowledge.

Signature Jean Angle  
Title Agent Date 9-13-90

Subscribed and sworn to before me this 13th day of September, 19 90.

Notary Public D'Ann Drennan

Date Commission Expires 10-94



**K.C.C. OFFICE USE ONLY**

F  Letter of Confidentiality Attached  
 C  Wireline Log Received  
 C  Drillers Timelog Received

**Distribution**

KCC  SWD/Rep  NGPA  
 KGS  Plug  Other  
 (Specify)

**SIDE TWO**

Operator Name FRONTIER OIL COMPANY Lease Name Reed Well # 1  
 Sec. 26 Twp. 7S Rge. 17  East  West  
 County Rooks

**INSTRUCTIONS:** Show important tops and base of formations penetrated. Detail all cores. Report all drill stem tests giving interval tested, time tool open and closed, flowing and shut-in pressures, whether shut-in pressure reached static level, hydrostatic pressures, bottom hole temperature, fluid recovery, and flow rates if gas to surface during test. Attach extra sheet if more space is needed. Attach copy of log.

Drill Stem Tests Taken  Yes  No  
 (Attach Additional Sheets.)  
 Samples Sent to Geological Survey  Yes  No  
 Cores Taken  Yes  No  
 Electric Log Run  Yes  No  
 (Submit Copy.)  
 DST #1 (2636-2656) 30-30-30-30. Rec. 10' M, 10' CO. IF & FF 19-19, ISIP 561 FSIP 551  
 DST #2 (2770-2824) 30-30-15-30. Rec. 60' Mud. IF 19-29, FF 39-49, ISIP 907, FSIP 887

Formation Description		
Name	Top	Bottom
ANHYDRITE	1096	+670
B/ANHYDRITE	1126	+640
HOWARD	2545	-779
TOPEKA	2618	-852
HEEBNER	2832	-1066
TORONTO	2857	-1091
LANSING/KS CITY	2878	-1108
BASE KS CITY	3097	-1331
RTD	3100	-1334

cont'd.

CASING RECORD <input checked="" type="checkbox"/> New <input checked="" type="checkbox"/> Used							
Report all strings set-conductor, surface, intermediate, production, etc.							
Purpose of String	Size Hole Drilled	Size Casing Set (In O.D.)	Weight Lbs./Ft.	Setting Depth	Type of Cement	# Sacks Used	Type and Percent Additives
Surface	12 1/2"	8 5/8"	24# (new)	1106'	60-40POZ	400sx	2%gel, 3% cc
Production	7 7/8"	4 1/2"	10 1/2# (used)	3010'	Common	120sx	10% salt
Conductor	17 1/2"	13 3/8"	48# (New)	101'	60-40 POZ	75sx	3%cc, 2% gel
PERFORATION RECORD				Acid, Fracture, Shot, Cement Squeeze Record			
Shots Per Foot	Specify Footage of Each Interval Perforated			(Amount and Kind of Material Used)		Depth	
4	2644-2654			500 gal 15% Mud Acid		2644-2654	
				2000 gal 28% Acid		2644-2654	
TUBING RECORD				Liner Run <input type="checkbox"/> Yes <input type="checkbox"/> No			
Size		Set At	Packer At	No			
2-3/8"		2735	No				
Date of First Production		Producing Method <input type="checkbox"/> Flowing <input checked="" type="checkbox"/> Pumping <input type="checkbox"/> Gas Lift <input type="checkbox"/> Other (Explain)					
7-6-90							
Estimated Production Per 24 Hours		Oil Bbls.	Gas Mcf	Water Bbls.	Gas-Oil Ratio		Gravity
10 BOPD		N/A		20 BWPD	N/A		36

Disposition of Gas: N/A **METHOD OF COMPLETION** Production Interval  
 Vented  Sold  Used on Lease  Open Hole  Perforation  Dually Completed  Commingled  
 (If vented, submit ACO-18.)  Other (Specify) \_\_\_\_\_ 2644-54'

Phone 316-33-2627, Russell, Kansas

Phone 316-793-5861, Great Bend, Kansas

15-163-23093-00-00

ORIGINAL

Phone Plainville 913-434-2812

Phone Ness City 913-798-3843

# ALLIED CEMENTING CO., INC. No. 10018

Home Office P. O. Box 31

Russell, Kansas 67665

*New*

Date	5-21-90	Sec.	26	Twp.	7	Range	17	Called Out		On Location		Job Start		Finish	5:00P.M.
------	---------	------	----	------	---	-------	----	------------	--	-------------	--	-----------	--	--------	----------

Lease	Reed	Well No.	1	Location	Stockton 4E 15 1E	County	Rooks	State	Ks
-------	------	----------	---	----------	-------------------	--------	-------	-------	----

Contractor	Red Tiger #2
Type Job	Conductor Surface
Hole Size	17 1/4
Csg.	13 7/8
Tbg. Size	
Drill Pipe	
Tool	
Cement Left in Csg.	10-15
Press Max.	
Meas Line	

Owner *IS 1/2 W*  
 To Allied Cementing Co., Inc.  
 You are hereby requested to rent cementing equipment and furnish cementer and helper to assist owner or contractor to do work as listed.

Charge To *Frontier Oil Company*  
 Street *125 N Market Ste. 1020*  
 City *Wichita* State *Ks 67202*  
 The above was done to satisfaction and supervision of owner agent or contractor.

Purchase Order No.  
 x. *Pat Woggen*

### CEMENT

Amount Ordered	<i>75 6/8 3% cc 2% gel</i>	
Consisting of		
Common	<i>45 Sk @ 5<sup>00</sup></i>	<i>225<sup>00</sup></i>
Poz. Mix	<i>30 Sk @ 2<sup>25</sup></i>	<i>67<sup>50</sup></i>
Gel.	<i>1 Sk @ N/C</i>	<i>N/C</i>
Chloride	<i>2 Sk @ 20<sup>00</sup></i>	<i>40<sup>00</sup></i>
Quickset		

### EQUIPMENT

Pumptrk	No.	Cementer	<i>Dave</i>
	<i>153</i>	Helper	
Pumptrk	No.	Cementer	<i>Mark</i>
		Helper	
Bulktrk		Driver	
	<i>156</i>	Driver	

Handling	<i>@ 90¢</i>	<i>67<sup>50</sup></i>
Mileage	<i>3¢/sk / Mile</i>	<i>45<sup>00</sup></i>
Sub Total		
Total		<i>445<sup>00</sup></i>

DEPTH of Job		
Reference:	<i>Pump trk chg</i>	<i>360<sup>00</sup></i>
	<i>10¢ per mile</i>	<i>20<sup>00</sup></i>
Sub Total		
Tax		
Total		<i>380<sup>00</sup></i>

Remarks: *Cement in ~~cellar~~ cellar*

SEP 14 1990

Phone 913-483-2627, Russell, Kansas  
 Phone 316-793-5861, Great Bend, Kansas

Phone Plainville 913-434-2812  
 Phone Ness City 913-798-3843

15-163-23093-00-00  
 New

# ALLIED CEMENTING CO., INC. N° 10239

Home Office P. O. Box 31 Russell, Kansas 67665

Date	5-23-90	Sec.	26	Twp.	7 <sup>s</sup>	Range	17 <sup>w</sup>	Called Out	9:15 A.M.	On Location	12:30 P.M.	Job Start	3:00 P.M.	Finish	3:45 P.M.
Lease	Reed	Well No.	1	Location	Stockton 4 1/2 E 1/2 S 1 E 1/4 S 1/2 W				County	Rooks	State	Ks.			
Contractor	Red Tiger Drilling Co. Rig # 2				Owner	Same									
Type Job	Set Surface Pipe														
Hole Size	12 1/4"		T.D.	1106											
Csg.	8 3/8"		Depth	1105'											
Tbg. Size			Depth												
Drill Pipe			Depth												
Tool			Depth												
Cement Left in Csg.	20'		Shoe Joint												
Press Max.	600 #		Minimum												
Meas Line	X		Displace												
Perf.															

To Allied Cementing Co., Inc.  
 You are hereby requested to rent cementing equipment and furnish cementer and helper to assist owner or contractor to do work as listed.

Charge To: Frontier Oil Company  
 Street: 1437 N. Franklin  
 City: Russell, State: Ks. 67665  
 The above was done to satisfaction and supervision of owner agent or contractor.

Purchase Order No. \_\_\_\_\_  
 X Pat Weggoner  
**CEMENT**

### EQUIPMENT

Pumptrk	No. 191	Cementor	Gary H.
		Helper	Wayne Mc.
Pumptrk	No.	Cementor	
		Helper	
Bulktrk	#212	Driver	Glen C.
Bulktrk	#213	Driver	Jim

Amount Ordered	400 sks 6 3/4 @ 22.00 = 2200.00	
Consisting of		
Common	240 sks @ 5.00/sk	1200.00
Poz. Mix	160 sks @ 2.25/sk	360.00
Gel.	7 sks	N/C.
Chloride	10 sks @ 20.00/sk	200.00
Quickset		

DEPTH of Job	# 1	313.95
Reference:	# 1 Pumptruck-surface	360.00
	# 8 1-8 3/8" rubber plug	71.00
	# 14 mileage @ 1.00/mi.	20.00
	<b>Sub Total</b>	<b>451.00</b>
	<b>Tax</b>	
	<b>Total</b>	

Handling	290 @ 1.25/sk. (400 sks)	360.00
Mileage	203 @ 1.20/mi. (20 mi.)	240.00
	<b>Sub Total</b>	<b>2360.00</b>
	<b>Total</b>	

Remarks: Cement Circulated.

Floating Equipment  
 Thanks  
 # 2811.00  
 less disc. 562.20  
 # 2248.80

SEP 14 1990

Phone 913-483-2627, Russell, Kansas  
 Phone 316-793-3361, Great Bend, Kansas

15-163-23093-00-00

Phone Plainville 913-434-2812  
 Phone Ness City 913-798-3843

New ORIGINAL

# ALLIED CEMENTING CO., INC. No 10244

Home Office P. O. Box 31

Russell, Kansas 67665

5-29-90

5-30-90

Date	Sec.	Twp.	Range	Called Out	On Location	Job Start	Finish
5-29-90	26	7 <sup>s</sup>	17 <sup>w</sup>	5:30 P.M.	7:30 P.M.	3:15 A.M.	4:15 A.M.
Lease	Well No.	Location			County	State	
Reed	1	Stockton 4 1/2 E 1/2 S 1 E 1 3/4 S 1/2 W			Rooks	Ks.	

Contractor	Red Tiger Drilling Co. Rig #2		
Type Job	Production String		
Hole Size	7 7/8"	T.D.	3100
Csg.	4 1/2"	Depth	3000
Csg. Size	8 7/8"	Depth	1105'
Drill Pipe		Depth	
Tool		Depth	
Cement Left in Csg.	25'	Shoe Joint	25.30'
Press Max.	1000 #	Minimum	
Meas Line	X	Displace	
Perf.			

Owner	Same
To Allied Cementing Co., Inc. You are hereby requested to rent cementing equipment and furnish cementer and helper to assist owner or contractor to do work as listed.	
Charge To	Frontier Oil Company
Street	1437 N. Franklin
City	Russell State Ks. 67665
The above was done to satisfaction and supervision of owner agent or contractor.	
Purchase Order No.	
X	<i>[Signature]</i>

### EQUIPMENT

No.	Cementer	
Pumptrk 191	Helper	Gary H. Wayne Me.
No.	Cementer	
Pumptrk	Helper	
Bulktrk #212	Driver	Glen C.
Bulktrk	Driver	

CEMENT	
Amount Ordered	125 sks com 10% salt
Consisting of	
Common	125 sks @ \$5.00/sk = 625.00
Poz. Mix	
Gel.	
Chloride	
Quickset	
Salt	13 sks @ 4.75/sk = 61.75
Sales Tax	
Handling	290¢/sk. (125 sks) = 112.50
Mileage	203¢/sk./mi. (20 mi.) = 75.00
Sub Total	# 874.25
Total	

### DEPTH of Job

Reference:	Description	Amount
#1	Cumtruck-long string	\$38.00
#8	1-4 1/2" rubber plug	31.00
#14	mileage @ 1.00/mi.	20.00
	Sub Total	\$89.00
	Tax	
	Total	

Remarks: Float Held.

Plugged rat hole w/15 sks

Floating Equipment

*Thanks*

SEP 14 1990

15-163-23093-00-00

SIDE TWO (Page Two)

ACO-1 WELL HISTORY

OPERATOR FRONTIER OIL COMPANY LEASE NAME Reed # 1 SEC. 26 TWP. 7S RGE. 17W

**FILL IN WELL LOG AS REQUIRED:**

Show all important zones of porosity and contents thereof; cored intervals, and all drill-stem tests, including depth interval tested, cushion used, time tool open, flowing and shut-in pressures, and recoveries.

SHOW GEOLOGICAL MARKERS, LOGS RUN OR OTHER DESCRIPTIVE INFORMATION

FORMATION DESCRIPTION, CONTENTS, ETC.	TOP	BOTTOM	NAME	DEPTH
DST #3 (2968-2983) 60-30-60-30. Rec. 325' SW w/scum of O. IF 44-111 FF 144-177, ISIP 355, FSIP 333.				

RECEIVED  
 STATE CORPORATION COMMISSION  
 SEP 20 1990  
 CONSERVATION DIVISION  
 Wichita, Kansas