

OWWO

For KCC Use: 10-10-05
Effective Date: 10-10-05
District # 1
SGA? Yes No

KANSAS CORPORATION COMMISSION
OIL & GAS CONSERVATION DIVISION
NOTICE OF INTENT TO DRILL

Form C-1
December 2002
Form must be Typed
Form must be Signed
All blanks must be Filled

Must be approved by KCC five (5) days prior to commencing well
APPROX 221'S 159' W OF

Expected Spud Date November 1 2005
month day year

Spot S/2 S/2 NW Sec. 16 Twp. 30 S. R. 14 East West
2332 feet from N / S Line of Section
1479 feet from E / W Line of Section

OPERATOR: License# 30931
Name: Daystar Petroleum, Inc.
Address: 1321 W. 93rd St. North
City/State/Zip: Valley Center, Kansas 67147
Contact Person: Charles Schmidt
Phone: 316-755-3523

Is SECTION Regular Irregular?
(Note: Locate well on the Section Plat on reverse side)

CONTRACTOR: License# 5893
Name: Pratt Well Service

County: Barber
Lease Name: Stannard B Well #: 1-16
Field Name: Wildcat

Well Drilled For: Oil Gas OWWO Seismic; # of Holes Other
 Enh Rec Storage Disposal
Well Class: Infield Pool Ext. Wildcat Other
Type Equipment: Mud Rotary Air Rotary Cable

Is this a Prorated / Spaced Field? Yes No
Target Formation(s): Simpson

Nearest Lease or unit boundary: _____
Ground Surface Elevation: 1651 feet MSL

Water well within one-quarter mile: Yes No
Public water supply well within one mile: Yes No

Depth to bottom of fresh water: 150'
Depth to bottom of usable water: 200'

Surface Pipe by Alternate: 1 2
Length of Surface Pipe Planned to be set: 326' set

If OWWO: old well information as follows:
Operator: Arrowhead Petroleum, Inc.
Well Name: Stannard #1
Original Completion Date: 3/21/86 Original Total Depth: 4740

Length of Conductor Pipe required: NA
Projected Total Depth: 4740'

Formation at Total Depth: Simpson
Water Source for Drilling Operations:
 Well Farm Pond Other X

Directional, Deviated or Horizontal wellbore? Yes No
If Yes, true vertical depth: _____
Bottom Hole Location: _____
KCC DKT #: _____

DWR Permit #: _____
(Note: Apply for Permit with DWR)

Will Cores be taken? Yes No
If Yes, proposed zone: _____

*Unit information attached

AFFIDAVIT

The undersigned hereby affirms that the drilling, completion and eventual plugging of this well will comply with K.S.A. 55 et. seq.
It is agreed that the following minimum requirements will be met:

RECEIVED
SEP 30 2005
KCC WICHITA

1. Notify the appropriate district office **prior** to spudding of well;
2. A copy of the approved notice of intent to drill **shall be** posted on each drilling rig;
3. The minimum amount of surface pipe as specified below **shall be set** by circulating cement to the top; in all cases surface pipe **shall be set** through all unconsolidated materials plus a minimum of 20 feet into the underlying formation.
4. If the well is dry hole, an agreement between the operator and the district office on plug length and placement is necessary **prior to plugging**;
5. The appropriate district office will be notified before well is either plugged or production casing is cemented in;
6. If an ALTERNATE II COMPLETION, production pipe shall be cemented from below any usable water to surface within **120 days** of spud date. Or pursuant to Appendix "B" - Eastern Kansas surface casing order #133,891-C, which applies to the KCC District 3 area, alternate II cementing must be completed within 30 days of the spud date or the well shall be plugged. **In all cases, NOTIFY district office** prior to any cementing.

I hereby certify that the statements made herein are true and to the best of my knowledge and belief.
Date: 9-29-05 Signature of Operator or Agent: Charles Schmidt Title: President

For KCC Use ONLY
API # 15 - 007. 22127.00.01
Conductor pipe required NONE feet
Minimum surface pipe required 326 feet per Alt. 1
Approved by: RJP 10-5-05
This authorization expires: 4-5-06
(This authorization void if drilling not started within 6 months of approval date.)
Spud date: _____ Agent: _____

Remember to:
- File Drill Pit Application (form CDP-1) with Intent to Drill;
- File Completion Form ACO-1 within 120 days of spud date;
- File acreage attribution plat according to field proration orders;
- Notify appropriate district office 48 hours prior to workover or re-entry;
- Submit plugging report (CP-4) after plugging is completed;
- Obtain written approval before disposing or injecting salt water.
- If this permit has expired (See: authorized expiration date) please check the box below and return to the address below.
 Well Not Drilled - Permit Expired
Signature of Operator or Agent: _____
Date: _____

16
30
14w

IN ALL CASES PLOT THE INTENDED WELL ON THE PLAT BELOW

Plat of acreage attributable to a well in a prorated or spaced field

If the intended well is in a prorated or spaced field, please fully complete this side of the form. If the intended well is in a prorated or spaced field complete the plat below showing that the well will be properly located in relationship to other wells producing from the common source of supply. Please show all the wells and within 1 mile of the boundaries of the proposed acreage attribution unit for gas wells and within 1/2 mile of the boundaries of the proposed acreage attribution unit for oil wells.

API No. 15 - _____
 Operator: Daystar Petroleum, Inc.
 Lease: Stannard B
 Well Number: 1-16
 Field: Wildcat

Number of Acres attributable to well: _____
 QTR / QTR / QTR of acreage: S/2 - S/2 - NW

Location of Well: County: Barber
2332 feet from N / S Line of Section
1479 feet from E / W Line of Section
 Sec. 16 Twp. 30 S. R. 14 East West

Is Section: Regular or Irregular

If Section is Irregular, locate well from nearest corner boundary.

Section corner used: NE NW SE SW

PLAT

(Show location of the well and shade attributable acreage for prorated or spaced wells.)

(Show footage to the nearest lease or unit boundary line.)

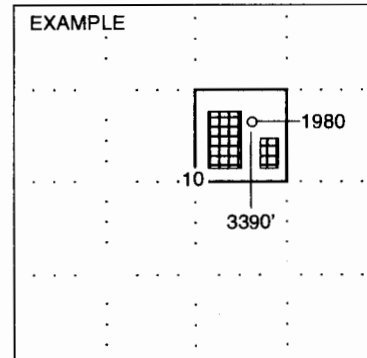
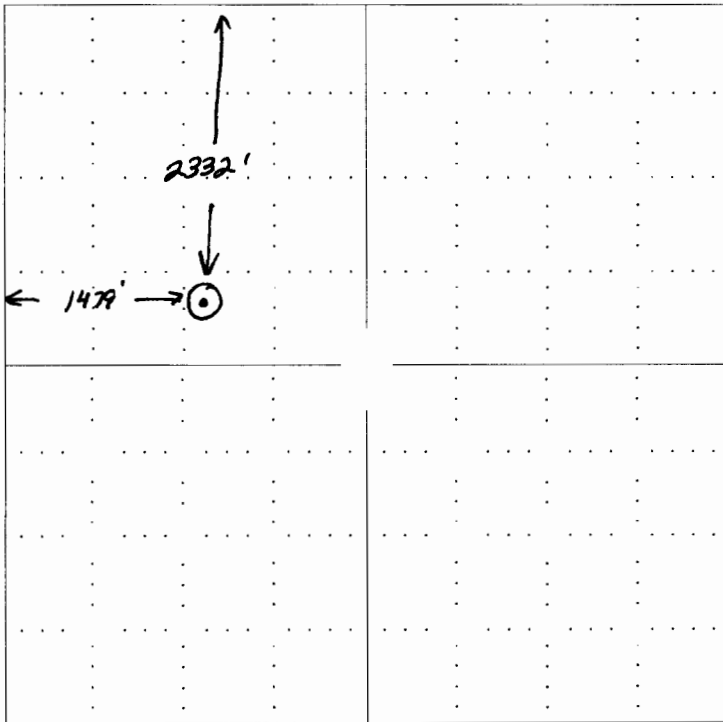

SEWARD CO.

NOTE: In all cases locate the spot of the proposed drilling location.

In plotting the proposed location of the well, you must show:

1. The manner in which you are using the depicted plat by identifying section lines, i.e. 1 section, 1 section with 8 surrounding sections, 4 sections, etc.
2. The distance of the proposed drilling location from the section's south / north and east / west.
3. The distance to the nearest lease or unit boundary line.
4. If proposed location is located within a prorated or spaced field a certificate of acreage attribution plat must be attached: (CO-7 for oil wells; CG-8 for gas wells).

RECEIVED
 SEP 30 2005
 KCC WICHITA

KANSAS

CORPORATION COMMISSION

KATHLEEN SEBELIUS, GOVERNOR

BRIAN J. MOLINE, CHAIR

ROBERT E. KREHBIEL, COMMISSIONER

MICHAEL C. MOFFET, COMMISSIONER

October 4, 2005

Mr. Charles Schmidt
Daystar Petroleum, Inc.
1321 W. 93rd St. North
Valley Center, KS 67147

RE: Drilling Pit Application
Stannard B Lease Well No. 1-16
NW/4 Sec. 16-30S-14W
Barber County, Kansas

Dear Mr. Schmidt:

District staff has inspected the above referenced location and has determined that the reserve pit shall be constructed **without slots**, the bottom shall be flat and reasonably level, and the free fluids must be removed. The fluids are to be removed from the reserve pit as soon as practical after drilling operations have ceased.

If production casing is set all completion fluids shall be removed on a daily basis.

The fluids should be taken to an authorized disposal well. Please call the District Office at (620) 225-8888 when the fluids have been removed. Please file form CDP-5, Exploration and Production Waste Transfer, within 30 days of fluid removal. Conservation division forms are available through our office and on the KCC web site: www.kcc.state.ks.us/conservation/forms.

A copy of this letter should be posted in the doghouse along with the approved Intent to Drill. If you have any questions or concerns please feel free to contact the undersigned at the above address.

Sincerely,

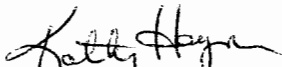

Kathy Haynes

Environmental Protection and Remediation Department

cc: S Durrant