

RECEIVED

NOV 03 2005

Form C-1  
December 2002

For KCC Use:  
Effective Date: 11.12.05  
District # \_\_\_\_\_  
SGA?  Yes  No

KANSAS CORPORATION COMMISSION  
OIL & GAS CONSERVATION DIVISION

NOTICE OF INTENT TO DRILL

KCC WICHITA

Form must be Typed  
Form must be Signed  
All blanks must be Filled

Must be approved by KCC five (5) days prior to commencing well

Expected Spud Date October 30 2005  
month day year

Spot Approx  
150' W SE NE Sec. 31 Twp. 34 S. R. 14  East  West  
1990 feet from  N /  S Line of Section  
810 feet from  E /  W Line of Section  
Is SECTION  Regular  Irregular?

OPERATOR: License# 5363 ✓  
Name: BEREXCO INC  
Address: P O BOX 20380  
City/State/Zip: WICHITA, KS 67208  
Contact Person: GARY MISAK  
Phone: 316-265-3311

CONTRACTOR: License# 5147 ✓  
Name: BEREDCO INC

Well Drilled For:  Oil  Enh Rec  Infield  Mud Rotary  
 Gas  Storage  Pool Ext.  Air Rotary  
 OWO  Disposal  Wildcat  Cable  
Seismic; # of Holes \_\_\_\_\_ Other \_\_\_\_\_  
 Other \_\_\_\_\_

(Note: Locate well on the Section Plat on reverse side)  
County: BARBER  
Lease Name: DAVIS RANCH Well #: 2-31  
Field Name: AETNA  
Is this a Prorated / Spaced Field?  Yes  No  
Target Formation(s): MISSISSIPPI  
Nearest Lease or unit boundary: 650'  
Ground Surface Elevation: 1584 feet MS   
Water well within one-quarter mile:  Yes  No  
Public water supply well within one mile:  Yes  No  
Depth to bottom of fresh water: 180  
Depth to bottom of usable water: 180  
Surface Pipe by Alternate:  1  2  
Length of Surface Pipe Planned to be set: 900  
Length of Conductor Pipe required: NONE  
Projected Total Depth: 5000  
Formation at Total Depth: MISSISSIPPI  
Water Source for Drilling Operations:  
 Well  Farm Pond Other \_\_\_\_\_  
DWR Permit #: \_\_\_\_\_  
(Note: Apply for Permit with DWR )  
Will Cores be taken?  Yes  No  
If Yes, proposed zone: \_\_\_\_\_

If OWWO: old well information as follows:  
Operator: \_\_\_\_\_  
Well Name: \_\_\_\_\_  
Original Completion Date: \_\_\_\_\_ Original Total Depth: \_\_\_\_\_  
Directional, Deviated or Horizontal wellbore?  Yes  No  
If Yes, true vertical depth: \_\_\_\_\_  
Bottom Hole Location: \_\_\_\_\_  
KCC DKT #: \_\_\_\_\_

AFFIDAVIT

The undersigned hereby affirms that the drilling, completion and eventual plugging of this well will comply with K.S.A. 55 et. seq.

It is agreed that the following minimum requirements will be met:

1. Notify the appropriate district office **prior** to spudding of well;
2. A copy of the approved notice of intent to drill **shall be** posted on each drilling rig;
3. The minimum amount of surface pipe as specified below **shall be set** by circulating cement to the top; in all cases surface pipe **shall be set** through all unconsolidated materials plus a minimum of 20 feet into the underlying formation.
4. If the well is dry hole, an agreement between the operator and the district office on plug length and placement is necessary **prior to plugging**;
5. The appropriate district office will be notified before well is either plugged or production casing is cemented in;
6. If an ALTERNATE II COMPLETION, production pipe shall be cemented from below any usable water to surface within **120 days** of spud date. Or pursuant to Appendix "B" - Eastern Kansas surface casing order #133,891-C, which applies to the KCC District 3 area, alternate II cementing must be completed within 30 days of the spud date or the well shall be plugged. **In all cases, NOTIFY district office** prior to any cementing.

I hereby certify that the statements made herein are true and to the best of my knowledge and belief.

Date: 10-13-05 Signature of Operator or Agent: Amy Misak Title: ENGINEER

For KCC Use ONLY  
API # 15 - 007-22946-0000  
Conductor pipe required NONE feet  
Minimum surface pipe required 200 feet per Alt. 1  
Approved by RJP 11.7.05  
This authorization expires: 5.7.06  
(This authorization void if drilling not started within 6 months of approval date.)  
Spud date: \_\_\_\_\_ Agent: \_\_\_\_\_

Remember to:

- File Drill Pit Application (form CDP-1) with Intent to Drill;
- File Completion Form ACO-1 within 120 days of spud date;
- File acreage attribution plat according to field proration orders;
- Notify appropriate district office 48 hours prior to workover or re-entry;
- Submit plugging report (CP-4) after plugging is completed;
- Obtain written approval before disposing or injecting salt water.
- If this permit has expired (See: authorized expiration date) please check the box below and return to the address below.

Well Not Drilled - Permit Expired

Signature of Operator or Agent: \_\_\_\_\_  
Date: \_\_\_\_\_

31  
34  
141

RECEIVED  
NOV 03 2005  
KCC WICHITA

**IN ALL CASES PLOT THE INTENDED WELL ON THE PLAT BELOW**

*Plat of acreage attributable to a well in a prorated or spaced field*

**If the intended well is in a prorated or spaced field, please fully complete this side of the form.** If the intended well is in a prorated or spaced field complete the plat below showing that the well will be properly located in relationship to other wells producing from the common source of supply. Please show all the wells and within 1 mile of the boundaries of the proposed acreage attribution unit for gas wells and within 1/2 mile of the boundaries of the proposed acreage attribution unit for oil wells.

API No. 15 - \_\_\_\_\_  
Operator: BEREXCO INC  
Lease: DAVIS RANCH  
Well Number: 2-31  
Field: AETNA

Location of Well: County: BARBER  
1990 feet from  N /  S Line of Section  
810 feet from  E /  W Line of Section  
Sec. 31 Twp. 34 S. R. 14  East  West

Number of Acres attributable to well: \_\_\_\_\_  
QTR / QTR / QTR of acreage: 150' W - SE - NE

Is Section:  Regular or  Irregular

**If Section is Irregular, locate well from nearest corner boundary.**

Section corner used:  NE  NW  SE  SW

**PLAT**

*(Show location of the well and shade attributable acreage for prorated or spaced wells.)*

*(Show footage to the nearest lease or unit boundary line.)*

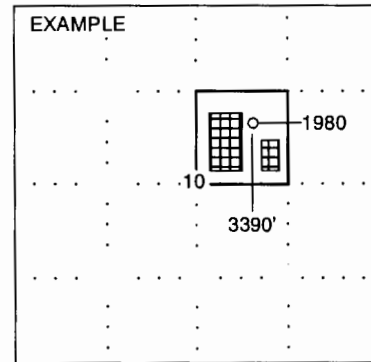
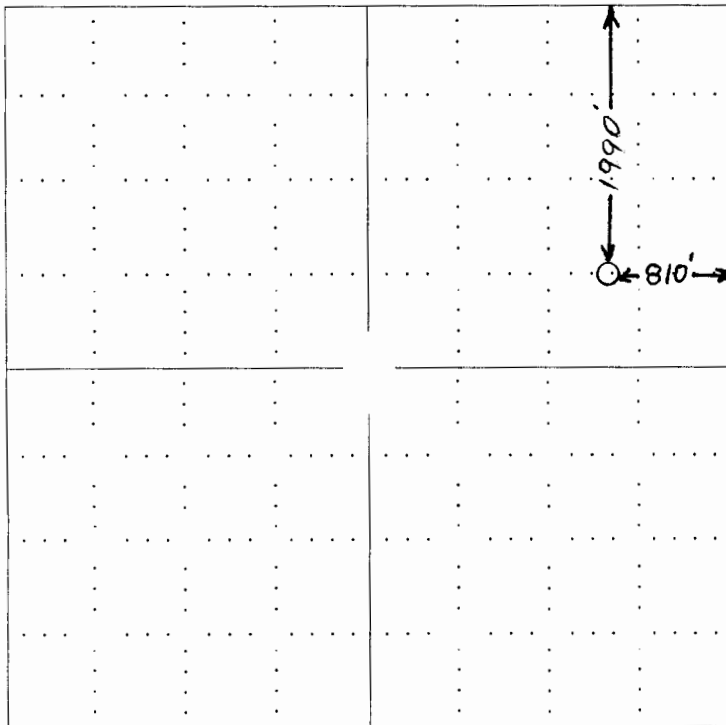

**NOTE: In all cases locate the spot of the proposed drilling location.**

**In plotting the proposed location of the well, you must show:**

1. The manner in which you are using the depicted plat by identifying section lines, i.e. 1 section, 1 section with 8 surrounding sections, 4 sections, etc.
2. The distance of the proposed drilling location from the section's south / north and east / west.
3. The distance to the nearest lease or unit boundary line.
4. If proposed location is located within a prorated or spaced field a certificate of acreage attribution plat must be attached: (CO-7 for oil wells; CG-8 for gas wells).

# KANSAS

CORPORATION COMMISSION

KATHLEEN SEBELIUS, GOVERNOR  
BRIAN J. MOLINE, CHAIR  
ROBERT E. KREHBIEL, COMMISSIONER  
MICHAEL C. MOFFET, COMMISSIONER

November 7, 2005

Mr. Gary Misak  
Berexco, Inc.  
PO Box 20380  
Wichita, KS 67208

RE: Drilling Pit Application  
Davis Ranch Lease Well No. 2-31  
NE/4 Sec. 31-34S-14W  
Barber County, Kansas

Dear Mr. Misak:

District staff has inspected the above referenced location and has determined that the reserve pit shall be constructed **without slots**, the bottom shall be flat and reasonably level, and the free fluids must be removed. The fluids are to be removed from the reserve pit as soon as the Hutchinson Salt section has been drilled through and displacement of the fluids into the reserve pit has occurred. The fluids should be removed again as soon as practical after drilling operations have ceased. **Please keep the pits well away from the slope.**

**If production casing is set all completion fluids shall be removed on a daily basis.**

The fluids should be taken to an authorized disposal well. Please call the District Office at (620) 225-8888 when the fluids have been removed. Please file form CDP-5, Exploration and Production Waste Transfer, within 30 days of fluid removal. Conservation division forms are available through our office and on the KCC web site: [www.kcc.state.ks.us/conservation/forms](http://www.kcc.state.ks.us/conservation/forms).

**A copy of this letter should be posted in the doghouse along with the approved Intent to Drill.** If you have any questions or concerns please feel free to contact the undersigned at the above address.

Sincerely,

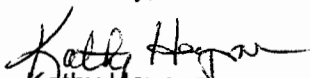

Kathy Haynes

Environmental Protection and Remediation Department

cc: S Durrant