

For KCC Use: 10-1-05
 Effective Date: _____
 District #: _____
 SGA? Yes No

KANSAS CORPORATION COMMISSION
 OIL & GAS CONSERVATION DIVISION

CORRECTED

Form C-1
 December 2002
 Form must be Typed
 Form must be Signed
 All blanks must be Filled

NOTICE OF INTENT TO DRILL

Must be approved by KCC five (5) days prior to commencing well

Ap. 100' N & 50' W of

Expected Spud Date October 15, 2005
 month day year

Spot
 C N2 N2 Sec. 35 Twp. 31S S. R. 31 East West

OPERATOR: License# 30931
 Name: Daystar Petroleum, Inc.
 Address: 1321 W. 93rd St. N.
 City/State/Zip: Valley Center, KS 67147
 Contact Person: Charles Schmidt
 Phone: 316-755-3523

660 560' feet from N / S Line of Section
2640 2690' feet from E / W Line of Section

Is SECTION Regular Irregular? (Per Chuck Schmidt 11/9/05)
 (Note: Locate well on the Section Plat on reverse side)

CONTRACTOR: License# 5142
 Name: Sterling Drilling Company

County: Seward
 Lease Name: Dufield Trust A Well #: 1-35
 Field Name: Thirty One SW

Is this a Prorated / Spaced Field? Yes No
 Target Formation(s): Lansing/Kansas City, Morrow, Mississippi

Well Drilled For:	Well Class:	Type Equipment:
<input checked="" type="checkbox"/> Oil	<input type="checkbox"/> Enh Rec	<input checked="" type="checkbox"/> Mud Rotary
<input checked="" type="checkbox"/> Gas	<input type="checkbox"/> Storage	<input type="checkbox"/> Air Rotary
<input type="checkbox"/> OWWO	<input type="checkbox"/> Disposal	<input type="checkbox"/> Cable
<input type="checkbox"/> Seismic; # of Holes	<input checked="" type="checkbox"/> Wildcat	
<input type="checkbox"/> Other	<input type="checkbox"/> Other	

Nearest Lease or unit boundary: 660'
 Ground Surface Elevation: 2783' feet MSL

Water well within one-quarter mile: Yes No
 Public water supply well within one mile: Yes No

Depth to bottom of fresh water: 620'
 Depth to bottom of usable water: 640'

Surface Pipe by Alternate: 1 2
 Length of Surface Pipe Planned to be set: 1700'

Length of Conductor Pipe required: None
 Projected Total Depth: 5800'

Formation at Total Depth: Mississippi
 Water Source for Drilling Operations:

Well Farm Pond Other _____
 DWR Permit #: _____

(Note: Apply for Permit with DWR)
 Will Cores be taken? Yes No

If Yes, proposed zone: _____

If OWWO: old well information as follows:
 Operator: _____
 Well Name: _____
 Original Completion Date: _____ Original Total Depth: _____

Directional, Deviated or Horizontal wellbore? Yes No

If Yes, true vertical depth: _____

Bottom Hole Location: _____

KCC DKT #: _____

*Prorated & Spaced Hugoton

**Unit information Attached

AFFIDAVIT

The undersigned hereby affirms that the drilling, completion and eventual plugging of this well will comply with K.S.A. 55 et. seq.

It is agreed that the following minimum requirements will be met:

*WAS: 660' FNL, 2640' FEL
 IS: 560' FNL, 2690' FEL

RECEIVED
 SEP 19 2005
 KCC WICHITA

1. Notify the appropriate district office **prior** to spudding of well;
2. A copy of the approved notice of intent to drill **shall be** posted on each drilling rig;
3. The minimum amount of surface pipe as specified below **shall be set** by circulating cement to the top; in all cases surface pipe **shall be set** through all unconsolidated materials plus a minimum of 20 feet into the underlying formation.
4. If the well is dry hole, an agreement between the operator and the district office on plug length and placement is necessary **prior to plugging**;
5. The appropriate district office will be notified before well is either plugged or production casing is cemented in;
6. If an ALTERNATE II COMPLETION, production pipe shall be cemented from below any usable water to surface within **120 days** of spud date.
 Or pursuant to Appendix "B" - Eastern Kansas surface casing order #133,891-C, which applies to the KCC District 3 area, alternate II cementing must be completed within 30 days of the spud date or the well shall be plugged. **In all cases, NOTIFY district office** prior to any cementing.

I hereby certify that the statements made herein are true and to the best of my knowledge and belief.

Date: September 15, 2005 Signature of Operator or Agent: Charles Schmidt Title: President

For KCC Use ONLY
 API # 15 - 175-22005-00-00
 Conductor pipe required NONE feet
 Minimum surface pipe required 660 feet per Alt 1
 Approved by: RJP 9-26-05 RJP 11-9-05
 This authorization expires: 3-26-06
 (This authorization void if drilling not started within 6 months of effective date.)
 Spud date: _____ Agent: _____

Remember to:

- File Drill Pit Application (form CDP-1) with Intent to Drill;
- File Completion Form ACO-1 within 120 days of spud date;
- File acreage attribution plat according to field proration orders;
- Notify appropriate district office 48 hours prior to workover or re-entry;
- Submit plugging report (CP-4) after plugging is completed;
- Obtain written approval before disposing or injecting salt water.

If this permit has expired (See: authorized expiration date) please check the box below and return to the address below.
 Well Not Drilled - Permit Expired
 Signature of Operator or Agent: _____
 Date: _____

35
31
31

IN ALL CASES PLOT THE INTENDED WELL ON THE PLAT BELOW

Plat of acreage attributable to a well in a prorated or spaced field

If the intended well is in a prorated or spaced field, please fully complete this side of the form. If the intended well is in a prorated or spaced field complete the plat below showing that the well will be properly located in relationship to other wells producing from the common source of supply. Please show all the wells and within 1 mile of the boundaries of the proposed acreage attribution unit for gas wells and within 1/2 mile of the boundaries of the proposed acreage attribution unit for oil wells.

API No. 15 - _____
Operator: Daystar Petroleum, Inc.
Lease: Dufield Trust A
Well Number: 1-35
Field: Thirty One SW

Location of Well: County: Seward
~~560~~ 560 feet from N / S Line of Section
~~2640~~ 2690 feet from E / W Line of Section
Sec. 35 Twp. 31S S. R. 31 East West

Number of Acres attributable to well: _____
QTR / QTR / QTR of acreage: C - N2 - N2

Is Section: Regular or Irregular

If Section Is Irregular, locate well from nearest corner boundary.
Section corner used: NE NW SE SW

PLAT

(Show location of the well and shade attributable acreage for prorated or spaced wells.)
(Show footage to the nearest lease or unit boundary line.)

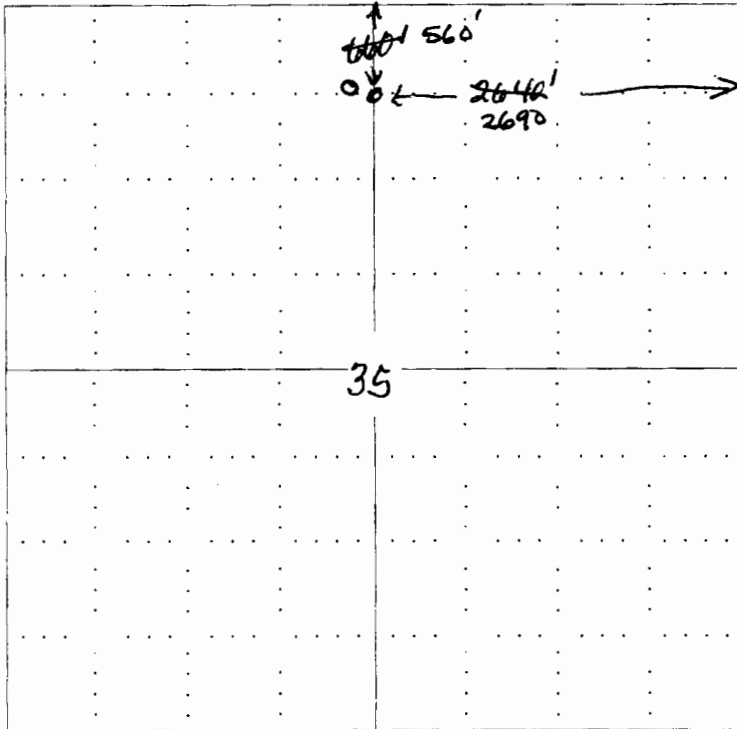

NOTE: In all cases locate the spot of the proposed drilling location.

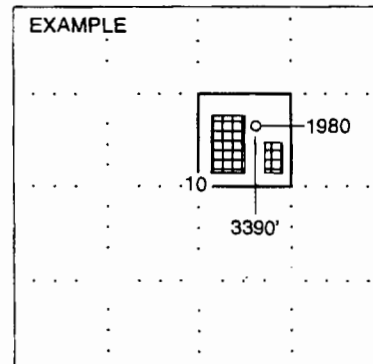

SEWARD CO.

RECEIVED

SEP 19 2005

KCC WICHITA

In plotting the proposed location of the well, you must show:

1. The manner in which you are using the depicted plat by identifying section lines, i.e. 1 section, 1 section with 8 surrounding sections, 4 sections, etc.
2. The distance of the proposed drilling location from the section's south / north and east / west.
3. The distance to the nearest lease or unit boundary line.
4. If proposed location is located within a prorated or spaced field a certificate of acreage attribution plat must be attached: (C0-7 for oil wells; CG-8 for gas wells).