

FOR KCC USE:

Correction

FORM C-1 7/91

EFFECTIVE DATE: 5-18-92

FORM MUST BE TYPED

DISTRICT # 4

State of Kansas
NOTICE OF INTENTION TO DRILL

FORM MUST BE SIGNED

SWAP: Yes, X, No

Must be approved by the K.C.C. five (5) days prior to commencing well

ALL BLANKS MUST BE FILLED

Expected Spud Date 05 18 92
month day year

Spot * N 1/2 SW NW Sec 21 Twp 6 S, Rg 37 East West

OPERATOR: License # 5316
Name: Falcon Exploration, Inc.
Address: 155 N. Market, Suite 1010
City/State/Zip: Wichita, KS 67202
Contact Person: Jim Thatcher
Phone: (316) 265-3351

* 3630 feet from South / North line of Section
4620 feet from East / West line of Section
IS SECTION X REGULAR IRREGULAR?

(NOTE: Locate well on the Section Plat on Reverse Side)
County: Sherman
Lease Name: Query Well #: 1
Field Name: wildcat

CONTRACTOR: License #: 5420
Name: White & Ellis Drilling

Is this a Prorated/Spaced Field? yes X no
Target Formation(s): Lansing, Marm, Cher Sd, Miss
Nearest lease or unit boundary: 660

Well Drilled For: Well Class: Type Equipment:
.X Oil ... Enh Rec ... Infield .X Mud Rotary
... Gas ... Storage ... Pool Ext. ... Air Rotary
... OWD ... Disposal .X Wildcat ... Cable
... Seismic; ... # of Holes ... Other

Ground Surface Elevation: feet MSL
Water well within one-quarter mile: yes X no
Public water supply well within one mile: yes X no
Depth to bottom of fresh water: 200
Depth to bottom of usable water: 275
Surface Pipe by Alternate: X 1 2
Length of Surface Pipe Planned to be set: 360
Length of Conductor pipe required: none

If OWD: old well information as follows:
Operator:
Well Name:
Comp. Date: Old Total Depth

Projected Total Depth: 5050
Formation at Total Depth: Mississippi
Water Source for Drilling Operations:
... well ... farm pond X other

Directional, Deviated or Horizontal wellbore? yes X no
If yes, true vertical depth:
Bottom Hole Location:

DWR Permit #:
Will Cores Be Taken?: yes X no
If yes, proposed zone:

WAS: SW NW 1 3300 FSL

AFFIDAVIT

IS: W/2 SW NW, 3630 FSL

The undersigned hereby affirms that the drilling, completion and eventual plugging of this well will comply with K.S.A. 55-101, et. seq.

It is agreed that the following minimum requirements will be met:

- 1. Notify the appropriate district office prior to spudding of well;
- 2. A copy of the approved notice of intent to drill shall be posted on each drilling rig;
- 3. The minimum amount of surface pipe as specified below shall be set by circulating cement to the top; in all cases surface pipe shall be set through all unconsolidated materials plus a minimum of 20 feet into the underlying formation;
- 4. If the well is dry hole, an agreement between the operator and the district office on plug length and placement is necessary prior to plugging;
- 5. The appropriate district office will be notified before well is either plugged or production casing is cemented in;
- 6. IF AN ALTERNATE II COMPLETION, PRODUCTION PIPE SHALL BE CEMENTED FROM BELOW ANY USABLE WATER TO SURFACE WITHIN 120 DAYS OF SPUD DATE. IN ALL CASES, NOTIFY DISTRICT OFFICE PRIOR TO ANY CEMENTING.

I hereby certify that the statements made herein are true and to the best of my knowledge and belief.

Date: 5/13/92 Signature of Operator or Agent: [Signature] Title: AGENT

FOR KCC USE:
API # 15- 181-202-92-707-00
Conductor pipe required 1102 feet
Minimum surface pipe required 325 feet per Alt. 0 X
Approved by: [Signature] 5-14-92 [Signature] 5-13-92
This authorization expires: 11-13-92
(This authorization void if drilling not started within 6 months of effective date.)
Spud date: Agent:

CONSERVATION DIVISION
WICHITA, KS

MAY 13 1992

RECEIVED
KANSAS CORPORATION COMMISSION

21
6
32

REMEMBER TO:

- File Drill Pit Application (form CDP-1) with Intent to Drill;
- File Completion Form ACD-1 within 120 days of spud date;
- File acreage attribution plat according to field proration orders;
- Notify appropriate district office 48 hours prior to workover or re-entry;
- Submit plugging report (CP-4) after plugging is completed;
- Obtain written approval before disposing or injecting salt water.

Mail to: Conservation Division, 200 Colorado Derby Building, 202 W. First St., Wichita, Kansas 67202-1286.

IN ALL CASES PLOT THE INTENDED WELL ON THE PLAT BELOW

PLAT OF ACREAGE ATTRIBUTABLE TO A WELL IN A PRORATED OR SPACED FIELD

If the intended well is in a prorated or spaced field, please fully complete this side of the form. If the intended well is in a prorated or spaced field complete the plat below showing that the well will be properly located in relationship to other wells producing from the common source of supply. Please show all the wells within 1 mile of the boundaries of the proposed acreage attribution unit for gas wells and within 1/2 mile of the boundaries of the proposed acreage attribution unit for oil wells.

API NO. 15- _____
 OPERATOR Falcon Explorations, Inc.
 LEASE Query
 WELL NUMBER 1
 FIELD wildcat

LOCATION OF WELL: COUNTY Sherman
3630 feet from south/north line of section
4620 feet from east/west line of section
 SECTION 21 TWP 6 RG 37W

NUMBER OF ACRES ATTRIBUTABLE TO WELL na
 QTR/QTR/QTR OF ACREAGE _____

IS SECTION X REGULAR or _____ IRREGULAR
 IF SECTION IS IRREGULAR, LOCATE WELL FROM NEAREST CORNER BOUNDARY.

Section corner used: _____ NE _____ NW _____ SE _____ SW

PLAT

(Show location of the well and shade attributable acreage for prorated or spaced wells.)
 (Show footage to the nearest lease or unit boundary line.)

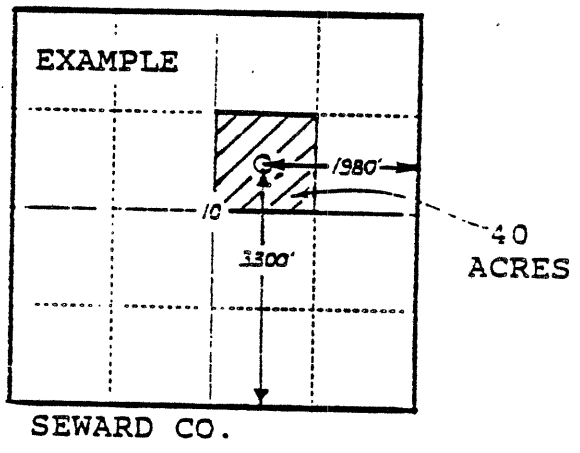
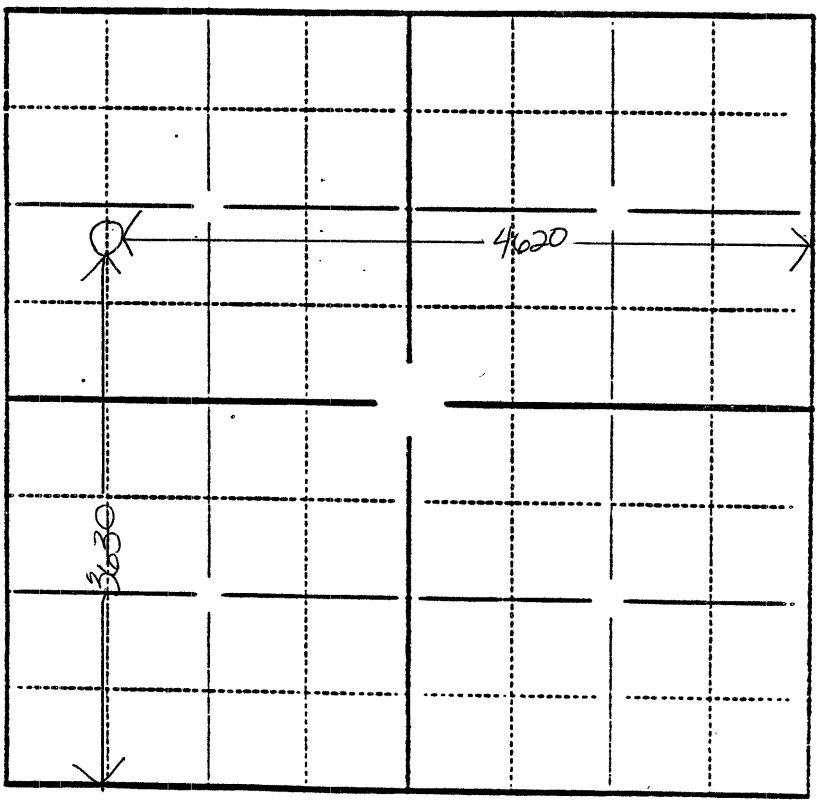

In plotting the proposed location of the well, you must show:

- 1) The manner in which you are using the depicted plat by identifying section lines, i.e. 1 section, 1 section with 8 surrounding sections, 4 sections, etc.;
- 2) the distance of the proposed drilling location from the section's south/north and east/west lines; and
- 3) the distance to the nearest lease or unit boundary line.

FALCON EXPLORATION INC.
OIL & GAS EXPLORATION

~~KSB Bldg. Suite 1075~~ 155 N. Market
~~125 N. Market~~ Suite 1010
Wichita, Kansas 67202
(316) 262-1378

August 24, 1992

Mr. Marion Schmidt
Kansas Corporation Commission
District #4
2301 E. 13th St.
Hays, KS 67601

RE: Query #1
N/2 SW NW Sec. 21-6S-37W
Sherman County, Kansas
API #15-181-20292

Dear Sir:

We do not understand your request of August 15, 1992, regarding Alternate II cementing of the subject well. Attached is a copy of the "Notice of Intention to Drill" showing this as an Alternate I well. This form also shows the bottom of useable water at 275'. This useable water should be protected by the surface pipe which was set at 392' and cemented to surface with 250 sacks 60/40 poz.

Someone with the Commission has either made a serious mistake or there is a lack of communication between offices. I would certainly appreciate knowing what the problem is and what can be done in the future to eliminate this area of confusion.

Sincerely yours,

Jim Thatcher
Jim Thatcher

JT/smw

Enc

cc: KCC - Wichita
David Williams
Jim Robinson
- Hays
Don Butcher

70. When this may concern

8-25-92

after talking w/ don butcher the surface pipe set is enough to satisfy alternate I requirements and district for is mistaken on this, Don Butcher is going to talk to Falcon Exploration and inform them that everything is ok and no additional cementing is necessary.

STATE RECEIVED
CORPORATION COMMISSION
AUG 25 1992
CONSERVATION DIVISION
Wichita, Kansas

Chris Bean, Geologist