

~~15-181~~

15-181-20208-00-00

WELL PLUGGING RECORD

Give All Information Completely  
 Make Required Affidavit

COUNTY Sherman SEC. 8 TWP. 6S RGE. 37W E/W  
 Location as in quarters or footage from lines:  
C NE SE

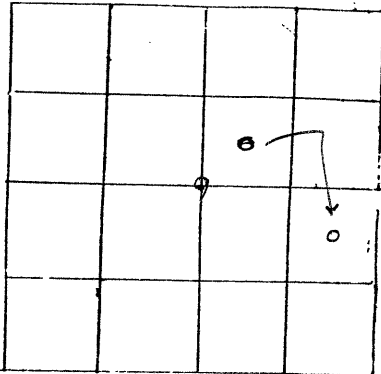

Locate Well  
 correctly on above  
 Section Platt.

Lease Owner Rincon Operating Co.  
 Lease Name Baird Well No. 1  
 Office Address 1580 Lincoln Street #700, Denver, CO 80203  
 Character of Well (Completed as Oil, Gas or Dry Hole): Dry Hole  
 Date Well Completed 6/1/81  
 Application for plugging filed Phone: 6/1/81  
 Plugging commenced 6/1/81  
 Plugging completed 6/1/81  
 Reason for abandonment of well or producing formation Dry Hole

Was permission obtained from the Conservation Division or it's  
 Agent's before plugging was commenced? Yes

Name of Conservation Agent who supervised plugging of this well Gil Baldazor  
 Producing formation None Depth to top          bottom          T.D. 5050

Show depth and thickness of all water, oil and gas formations.

OIL, GAS OR WATER RECORDS

Casing Record

Formation	Content	From	To	Size	Put in	Pulled Out
				8 5/8"	560'	0

Describe in detail the manner in which the well was plugged, indicating where the mud  
 fluid was placed and the method or methods used in introducing it into the hold. If cement  
 or other plugs were used, state the character of same and depth placed, from           
 feet to          feet for each plug set.

Plugs set as follows:

- 2000' with 60 sxs
- 600' with 30 sxs
- 40' with 10 sxs
- 5 sxs in rat hole

RECEIVED  
 STATE CORPORATION COMMISSION

(If additional description is necessary, use BACK of this sheet)  
 Name of Plugging Contractor Stoepelwerth Drilling Co.

OCT 5 1981  
 10-5-81

STATE OF Colorado COUNTY OF Denver, ss.

CONSERVATION DIVISION  
 Wichita, Kansas

C. A. Hansen (employee of owner) or (owner or operator) of the  
 above-described well, being first duly sworn on oath, says: That I have knowledge of the  
 facts, statements, and matters herein contained and the log of the above-described well as  
 filed and that the same are true and correct. So help me God.

(Signature) C. A. Hansen

(Address) 1580 Lincoln Street #700  
Denver, CO 80203

SUBSCRIBED AND SWORN TO before me this 30<sup>th</sup> day of September 19 81

Marian Wilmet  
 Notary Public.

My Commission expires: 2-25-85

1580 Lincoln #700  
Denver, Co 80203

KANSAS

**IMPORTANT**  
Kans. Geo. Survey request  
samples on this well.

**WELL COMPLETION REPORT AND  
DRILLER'S LOG**

S. 8 T. 6 R. 37 *File & Card = C-Ne-Se*  
Loc. NW SW  
County Sherman

API No. 15 — 181 — 20,208 *-0000*  
County Number

Operator  
Rincon Operating Co.

Address  
1580 Lincoln St., Suite 700 Denver, Colo 80203

Well No. #1 Lease Name Faulkner Baird

Footage Location  
feet from (N) (S) line feet from (E) (W) line

Principal Contractor Stooppelwerth Drilling Co. Geologist

Spud Date 5/21/81 Date Completed 6/4/81 Total Depth 5050' P.B.T.D.

Directional Deviation Oil and/or Gas Purchaser

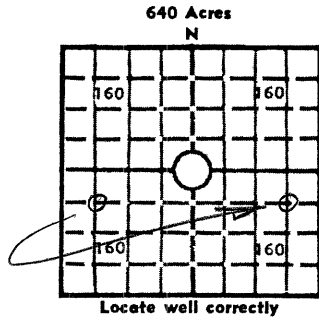

Elev.: Gr. 3434'  
DF 3436' KB 3439'

**CASING RECORD**

Report of all strings set — surface, intermediate, production, etc.

Purpose of string	Size hole drilled	Size casing set (in O.D.)	Weight lbs/ft.	Setting depth	Type cement	Sacks	Type and percent additives
Surface	12 1/4"	8 5/8"	24#	561	Regular	400	3% CaCl

**LINER RECORD**

**PERFORATION RECORD**

Top, ft.	Bottom, ft.	Sacks cement	Shots per ft.	Size & type	Depth interval

**TUBING RECORD**

Size	Setting depth	Packer set at

**ACID, FRACTURE, SHOT, CEMENT SQUEEZE RECORD**

Amount and kind of material used	Depth interval treated
Dry Hole	

*10-5-81*

**INITIAL PRODUCTION**

Date of first production <u>Dry Hole</u>		Producing method (flowing, pumping, gas lift, etc.)			
RATE OF PRODUCTION PER 24 HOURS	Oil bbls.	Gas MCF	Water bbls.	G&O ratio <u>5.10/1</u>	CFPB
Disposition of gas (vented, used on lease or sold)			Producing interval(s)		

RECEIVED  
STATE CORPORATION COMMISSION  
OCT 5 1981  
CONSERVATION DIVISION  
Wichita, Kansas

INSTRUCTIONS: As provided in KCC Rule 82-2-125, within 90 days after completion of a well, one completed copy of this Drillers Log shall be transmitted to the State Geological Survey of Kansas, 4150 Monroe Street, Wichita, Kansas 67209. Copies of this form are available from the Conservation Division, State Corporation Commission, 245 No. Water, Wichita, Kansas 67202. Phone AC 316-522-2206. If confidential custody is desired, please note Rule 82-2-125. Drillers Logs will be on open file in the Oil and Gas Division, State Geological Survey of Kansas, Lawrence, Kansas 66044.

Operator Rincon Operating Co. DESIGNATE TYPE OF COMP.: OIL, GAS, DRY HOLE, SWDW, ETC.:

Well No. 1 Lease Name Baird Dry Hole

S 8 T 6S R 37W E W

**WELL LOG**  
 Show all important zones of porosity and contents thereof; cored intervals, and all drill-stem tests, including depth interval tested, cushion used, time tool open, flowing and shut-in pressures, and recoveries. SHOW GEOLOGICAL MARKERS, LOGS RUN, OR OTHER DESCRIPTIVE INFORMATION.

FORMATION DESCRIPTION, CONTENTS, ETC.	TOP	BOTTOM	NAME	DEPTH
DST #1 4488-4515 Open 30 min, SI 60 min Open 60 min, SI 90 min Rec'd 15' mud IFP 60-40#, FFP 60-60#,			Heebner Toronto Lansing KC Base KC Marmaton	4248' 4285' 4309' 4575' 4583'
DST #2 4572-4625' Open 30 min SI 30 min Rec'd 40' mud IFP 40#, FFP 40#,				
DST #3 4621-4650' Open 30 min, SI 30 min Rec'd 20' mud w/few spks oil IFP 60-50#, ISIP 60#, FFP 396# FSIP 497#				

RECEIVED  
 STATE CORPORATION COMMISSION  
 OCT 5 1981  
 CONSERVATION DIVISION  
 Wichita, Kansas

USE ADDITIONAL SHEETS, IF NECESSARY, TO COMPLETE WELL RECORD.

Date Received

*C. A. Hansen*  
 C. A. Hansen Signature  
 Drlg & Prod Mgr Title  
 9/30/81 Date