

PLAT AND CERTIFICATION OF ACREAGE ATTRIBUTABLE TO AN OIL WELL

State Corporation Commission, Conservation Division
200 Colorado Derby Bldg. Wichita, Kansas 67202

OPERATOR PANCANADIAN PETROLEUM COMPANY

LOCATION OF WELL:

LEASE GARY L. STATES

990 feet from the E line

330 feet from the S line

WELL NUMBER 42-3 #3

Of the NE/4 of Sec 3 T. 7S R. 20W

FIELD Probasco

COUNTY Rooks

*NUMBER OF ACRES
ATTRIBUTABLE TO WELL 20

DESCRIPTION OF ACREAGE:

W/2 SE NE

PLAT

(Show location of Well and outline attributable acreage)
(Show footage to nearest lease or unit boundry line)

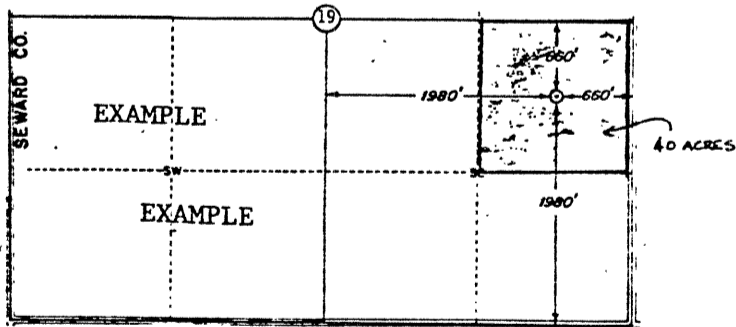
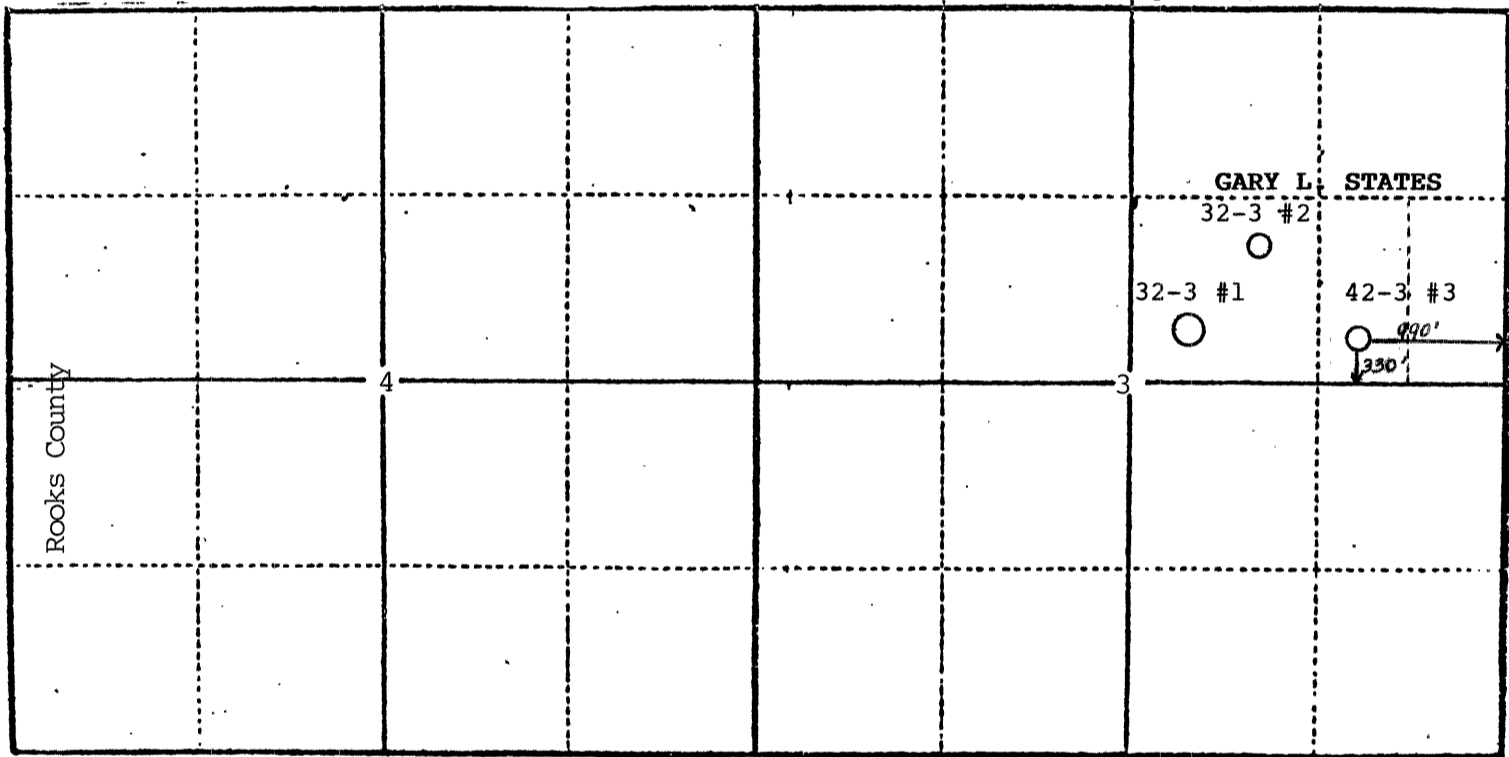

The undersigned hereby certifies that he is Coord., Eng. Operations U.S.
for PANCANADIAN PETROLEUM COMPANY, a duly authorized agent, that all information
shown hereon is true and correct to the best of his knowledge and belief, and that
all acreage claimed as attributable to the well named herein is held by production
from that well.

James D. Keisling
James D. Keisling

Suscribed and sworn to before me on this 24th day of February, 19 86.

Notary Public
Notary Public
STATE CORPORATION COMMISSION

My Commission expires 10/14/88

FEB 20 1986
02-28-86
CONSERVATION DIVISION