

15163-22817-0000

PLAT AND CERTIFICATION OF ACREAGE ATTRIBUTABLE TO AN OIL WELL

State Corporation Commission, Conservation Division  
200 Colorado Derby Bldg. Wichita, Kansas 67202

OPERATOR PANCANADIAN PETROLEUM COMPANY

LOCATION OF WELL:

LEASE GARY L. STATES

990 feet from the W line

990 feet from the S line

WELL NUMBER 32-3 #2

Of the NE/4 of Sec 3 T. 7S R. 20W

FIELD Probasco

COUNTY Rooks

\*NUMBER OF ACRES  
ATTRIBUTABLE TO WELL 20

DESCRIPTION OF ACREAGE:  
E/2 SW NE

PLAT

(Show location of Well and outline attributable acreage)  
(Show footage to nearest lease or unit boundry line)

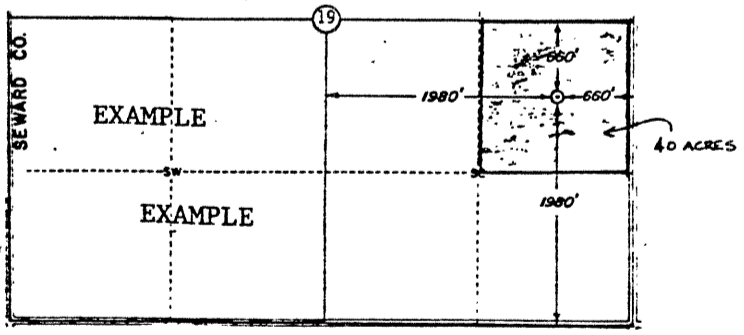
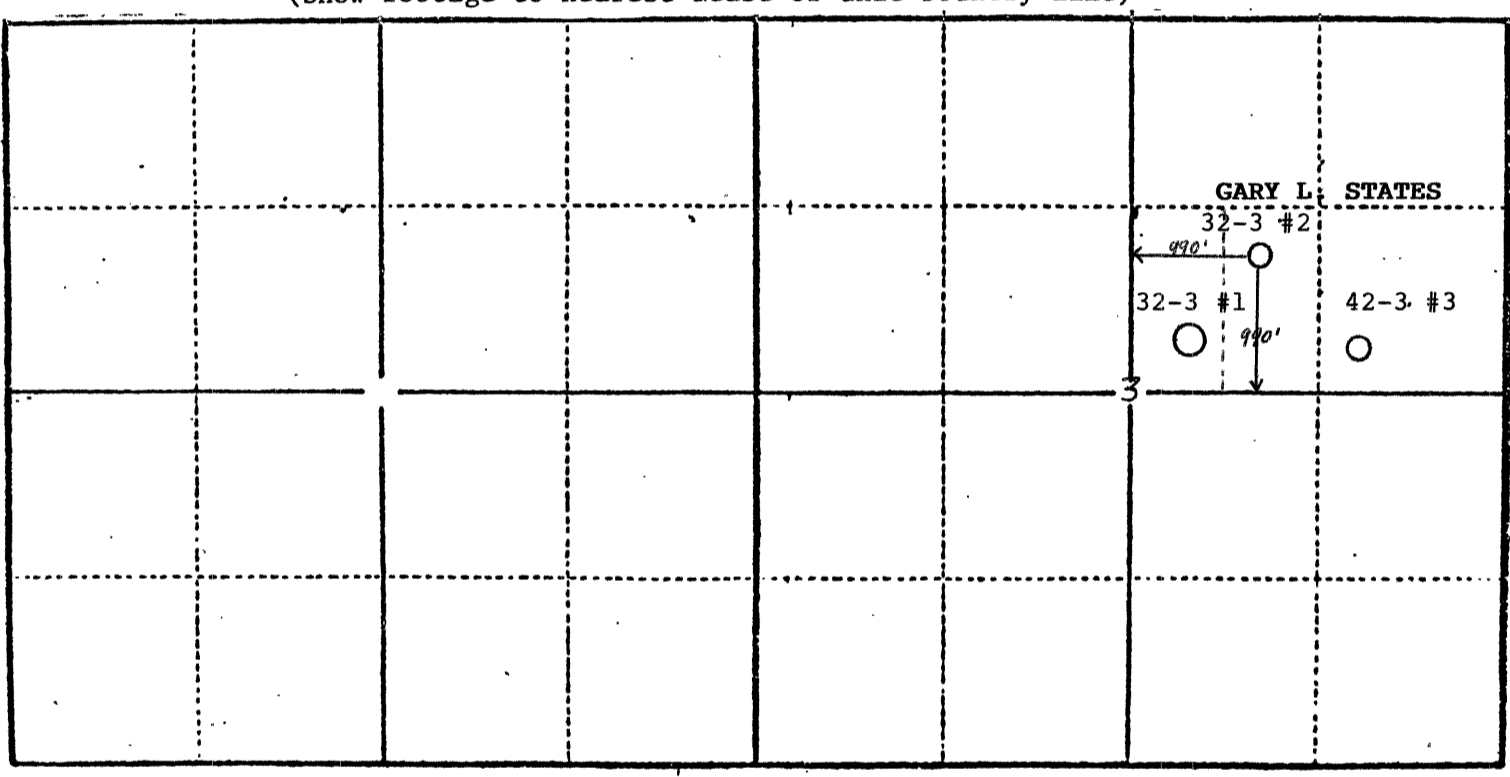

The undersigned hereby certifies that he is Coord., Eng. Operations U.S.  
for PANCANADIAN PETROLEUM COMPANY, a duly authorized agent, that all information  
shown hereon is true and correct to the best of his knowledge and belief, and that  
all acreage claimed as attributable to the well named herein is held by production  
from that well.

James D. Keisling  
James D. Keisling

Suscribed and sworn to before me on this 24th day of February, 19 86.

Janet S. Rittenhouse  
Notary Public

My Commission expires 10/14/88

STATE CORPORATION COMMISSION  
2/28/86  
FEB 28 1986  
CONSERVATION DIVISION