

PLAT AND CERTIFICATION OF ACREAGE ATTRIBUTABLE TO AN OIL WELL

State Corporation Commission, Conservation Division  
 200 Colorado Derby Bldg. Wichita, Kansas 67202

OPERATOR PANCANADIAN PETROLEUM COMPANY

LOCATION OF WELL:

LEASE GARY L. STATES

330 feet from the S line

330 feet from the W line

WELL NUMBER 32-3 #1

Of the NE/4 of Sec 3 T. 7S R. 20W

FIELD Probasco

COUNTY Rooks

\*NUMBER OF ACRES  
 ATTRIBUTABLE TO WELL 20

DESCRIPTION OF ACREAGE:

W/2 SW NE

PLAT

(Show location of Well and outline attributable acreage)  
 (Show footage to nearest lease or unit boundary line)

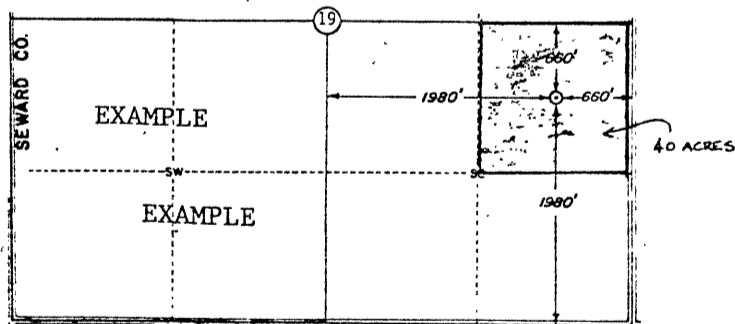
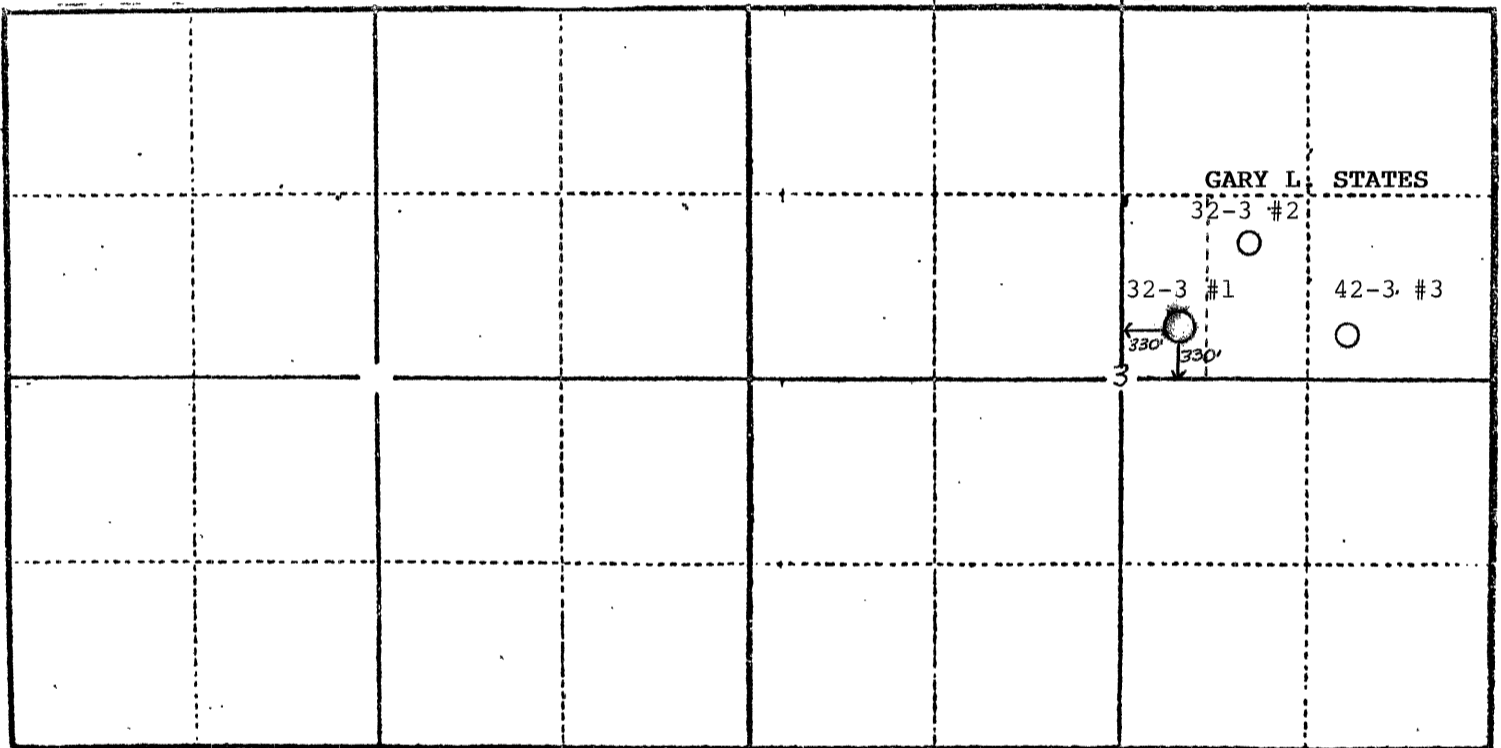

The undersigned hereby certifies that he is Coord., Eng. Operations U.S.  
 for PANCANADIAN PETROLEUM COMPANY, a duly authorized agent, that all information  
 shown hereon is true and correct to the best of his knowledge and belief, and that  
 all acreage claimed as attributable to the well named herein is held by production  
 from that well.

James D. Keisling  
 James D. Keisling

Suscribed and sworn to before me on this 24th day of February, 19 86.

Janet S. Rittenhouse  
 Notary Public

My Commission expires 10/14/88

STATE CORPORATION COMMISSION  
 FEB 20 1986  
 CONSERVATION DIVISION