

EFFECTIVE DATE: 10-16-90  
FORM MUST BE TYPED  
FORM C-1 4/90

CORRECTED INTENT  
State of Kansas

*Correction*  
FORM MUST BE SIGNED  
ALL BLANKS MUST BE FILLED

Must be approved by the K.C.C. five (5) days prior to commencing well

Expected Spud Date 10 17 90  
month day year

SE NE NW Sec 19 Twp 7 S, Rg 17 X East West

OPERATOR: License # 7076  
Name: BLACK DIAMOND OIL, INC.  
Address: 3004 BROADWAY AVE  
City/State/Zip: HAYS, KS 67601  
Contact Person: Kenneth Vehige  
Phone: 913-625-5891

4290 feet from South line of Section  
2970 feet from East line of Section  
(Note: Locate well on Section Plat on Reverse Side)

CONTRACTOR: License #: 8241  
Name: Emphasis Oil Operations

County: Rooks  
Lease Name: Wehrli Well #: 1  
Field Name: Riffe ext  
Is this a Prorated Field? yes X no  
Target Formation(s): Arbuckle  
Nearest lease or unit boundary: 330  
Ground Surface Elevation: 1750 feet MSL  
Domestic well within 330 feet: yes X no  
Municipal well within one mile: yes X no  
Depth to bottom of fresh water: 180!  
Depth to bottom of usable water: 700!  
Surface Pipe by Alternate: X 1 2  
Length of Surface Pipe Planned to be set: 1100!  
Length of Conductor pipe required: 90!  
Projected Total Depth: 3325!  
Formation at Total Depth: Arbuckle  
Water Source for Drilling Operations:  
well X farm pond other  
DWR Permit #: \_\_\_\_\_  
Will Cores Be Taken?: yes X no  
If yes, proposed zone: \_\_\_\_\_

Well Drilled For: Well Class: Type Equipment:  
X Oil ... Inj X Infield X Mud Rotary  
... Gas ... Storage ... Pool Ext. ... Air Rotary  
... OWWO ... Disposal ... Wildcat ... Cable  
... Seismic; ... # of Holes

If OWWO: old well information as follows:  
Operator: \_\_\_\_\_  
Well Name: \_\_\_\_\_  
Comp. Date: \_\_\_\_\_ Old Total Depth \_\_\_\_\_

Directional, Deviated or Horizontal wellbore? yes no  
If yes, total depth location: \_\_\_\_\_

WAS: RANGE = 18W

AFFIDAVIT

IS: RANGE = 17W

The undersigned hereby affirms that the drilling, completion and eventual plugging of this well will comply with K.S.A. 55-101, et. seq.

- It is agreed that the following minimum requirements will be met:
1. The appropriate district office shall be notified before setting surface pipe;
  2. The minimum amount of surface pipe as specified above shall be set by circulating cement to the top; in all cases surface pipe shall be set through all unconsolidated materials plus a minimum of 20 feet into the underlying formation;
  3. If the well is dry, a plugging proposal shall be submitted to the district office. An agreement between the operator and the district office on plug length and placement is necessary prior to plugging;
  4. The appropriate district office will be notified before well is either plugged or production casing is cemented in;
  5. If an Alternate II completion, production pipe shall be cemented from below any usable water to surface within 120 days of spud date. In all cases, notify district office prior to any cementing.

I hereby certify that the statements made herein are true and to the best of my knowledge and belief.  
Date: 10/16/90 Signature of Operator or Agent: Kenneth Vehige Title: Owner/Operator

\* Conductor Required

FOR KCC USE:  
API # 15-163-23,121-00-00  
Conductor pipe required 80 feet  
Minimum surface pipe required 720 feet per Alt. 1  
Approved by: mmw 10-18-90; mg 10-11-90  
EFFECTIVE DATE: 10-16-90  
This authorization expires: 4-11-91  
(This authorization void if drilling not started within 6 months of effective date.)  
Spud date: \_\_\_\_\_ Agent: \_\_\_\_\_

RECEIVED  
STATE OF KANSAS  
10-17-90  
OCT 17 1990  
CONSERVATION DIVISION  
Wichita, Kansas

19  
2  
17W

REMEMBER TO:

- File Drill Pit Application (form CDP-1) with Intent to Drill;
- File Completion Form ACO-1 within 120 days of spud date;
- File acreage attribution plat according to field proration orders;
- Notify appropriate district office 48 hours prior to workover or re-entry;
- Submit plugging report (CP-4) after plugging is completed;
- Obtain written approval before disposing or injecting salt water.

PLAT OF ACREAGE ATTRIBUTABLE TO A WELL

State Corporation Commission, Conservation Division  
 200 Colorado Derby Bldg. Wichita, Kansas 67202

OPERATOR Black Diamond Oil, Inc. LOCATION OF WELL:  
 LEASE Wehrli 4290 feet north of SE corner  
 WELL NUMBER 1 2970 feet west of SE corner  
 FIELD Riffe ext NW Sec. 19 T 7 R 17 X/W  
 COUNTY Rooks  
 NO. OF ACRES ATTRIBUTABLE TO WELL 10 IS SECTION  REGULAR  IRREGULAR?  
 DESCRIPTION OF ACREAGE \_\_\_\_\_ IF IRREGULAR, LOCATE WELL FROM NEAREST  
 CORNER BOUNDARY.

NOTE: If plat depicted is insufficient for your circumstances, you may attach your own scaled or surveyed plat.

PLAT

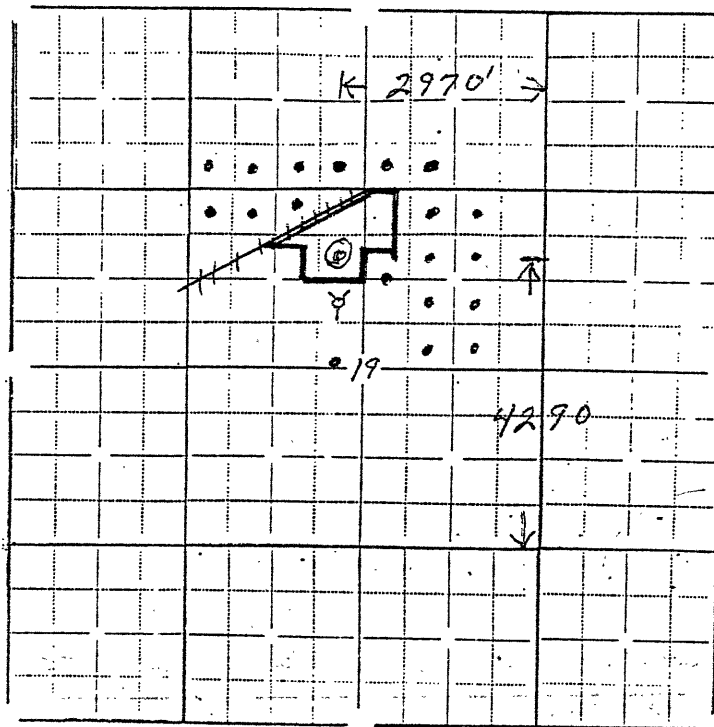

In plotting the proposed location of the well, you must show:

- 1) The manner in which you are using the depicted plat by identifying section lines, i.e. 1 section, 4 sections, 16 sections, etc.;
- 2) the well's location relative to the location of other wells producing from the same common source of supply in adjoining drilling units, pursuant to K.A.R. 82-3-108, 82-3-207, 82-3-312, or special orders of the Commission;
- 3) the distance of the proposed drilling location from the section's east and south lines; and
- 4) the distance to the nearest lease or unit boundary line. 330'

I hereby certify that the statements made herein are true and to the best of my knowledge and belief.

Signature of Operator or Agent

*[Handwritten Signature]* 10/14/90

Date

10-10-90

Title Owner/Operator