

FOR KCC USE:

EFFECTIVE DATE: 1-20-92

DISTRICT # 4

SGA? Yes No

Conductor required 26,275

Correction

FORM C-1 7/91

FORM MUST BE TYPED

FORM MUST BE SIGNED

ALL BLANKS MUST BE FILLED

State of Kansas

NOTICE OF INTENTION TO DRILL

Must be approved by the K.C.C. five (5) days prior to commencing well

Expected Spud Date January 10 1992
month day year

Spot NW SE NE Sec 19 Twp 7 S, Rg 17 East West

OPERATOR: License # 30571
Name: Fremont Energy Corporation
Address: 3030 N.W. Expressway, Suite 1602
City/State/Zip: Oklahoma City, OK 73112
Contact Person: Tom Goldsworthy
Phone: (405) 943-4581

CONTRACTOR: License #: 30684
Name: ABERCROMBIE, RT, D., INC.

Well Drilled For: Well Class: Type Equipment:
 Oil ... Enh Rec ... Infield ... Mud Rotary
 Gas ... Storage ... Pool Ext. Air Rotary
 OWWO ... Disposal ... Wildcat ... Cable
 Seismic; ... # of Holes Other
 Other Replacement
If OWWO: old well information as follows:
Operator: _____
Well Name: _____
Comp. Date: _____ Old Total Depth _____

Directional, Deviated or Horizontal wellbore? yes no
If yes, true vertical depth: _____
Bottom Hole Location: _____

3760 feet from South / North line of Section
830 feet from East / West line of Section
IS SECTION REGULAR IRREGULAR?
(NOTE: Locate well on the Section Plat on Reverse Side)
County: Rooks
Lease Name: F. Walker "B" Well #: 6
Field Name: Riffe
Is this a Prorated/Spaced Field? yes no
Target Formation(s): Arbuckle
Nearest lease or unit boundary: 200'
Ground Surface Elevation: 1,741 feet MSL
Water well within one-quarter mile: yes no
Public water supply well within one mile: yes no
Depth to bottom of fresh water: 100'
Depth to bottom of usable water: 800'
Surface Pipe by Alternate: 1 2
Length of Surface Pipe Planned to be set: 1,800'
Length of Conductor pipe required: 110'
Projected Total Depth: 3,270'
Formation at Total Depth: Arbuckle
Water Source for Drilling Operations:
 well farm pond other
DWR Permit #: Will File
Will Cores Be Taken?: yes no
If yes, proposed zone: _____

WAS: 3830 FSL 15: 3760 FSL AFFIDAVIT

* 110 of conductor pipe required

The undersigned hereby affirms that the drilling, completion and eventual plugging of this well will comply with K.S.A. 55-101, et. seq.
It is agreed that the following minimum requirements will be met:

1. Notify the appropriate district office prior to spudding of well;
2. A copy of the approved notice of intent to drill shall be posted on each drilling rig;
3. The minimum amount of surface pipe as specified below shall be set by circulating cement to the top; in all cases surface pipe shall be set through all unconsolidated materials plus a minimum of 20 feet into the underlying formation;
4. If the well is dry hole, an agreement between the operator and the district office on plug length and placement is necessary prior to plugging;
5. The appropriate district office will be notified before well is either plugged or production casing is cemented in;
6. IF AN ALTERNATE II COMPLETION, PRODUCTION PIPE SHALL BE CEMENTED FROM BELOW ANY USABLE WATER TO SURFACE WITHIN 120 DAYS OF SPUD DATE. IN ALL CASES, NOTIFY DISTRICT OFFICE PRIOR TO ANY CEMENTING.

I hereby certify that the statements made herein are true and to the best of my knowledge and belief.
Date: 12/17/91 Signature of Operator or Agent: Thomas B. Goldsworthy Title: Vice President

Carla Albright
RECEIVED
STATE CORPORATION COMMISSION
DEC 19 1991
CONSERVATION DIVISION
Wichita, Kansas

FOR KCC USE:
API # 15- 163-23192-00-00
Conductor pipe required 110 feet
Minimum surface pipe required 1250 feet per Alt. 10
Approved by: mpw 1-15-92; cam 1-21-92
This authorization expires: 7-15-92
(This authorization void if drilling not started within 6 months of effective date.)
Spud date: _____ Agent: _____

REMEMBER TO:

- File Drill Pit Application (form CDP-1) with Intent to Drill;
- File Completion Form ACO-1 within 120 days of spud date;
- File acreage attribution plat according to field proration orders;
- Notify appropriate district office 48 hours prior to workover or re-entry;
- Submit plugging report (CP-4) after plugging is completed;
- Obtain written approval before disposing or injecting salt water.

Mail to: Conservation Division, 200 Colorado Derby Building, 202 W. First St., Wichita, Kansas 67202-1286.

19
2
15W

IN ALL CASES PLOT THE INTENDED WELL ON THE PLAT BELOW

PLAT OF ACREAGE ATTRIBUTABLE TO A WELL IN A PRORATED OR SPACED FIELD

If the intended well is in a prorated or spaced field, please fully complete this side of the form. If the intended well is in a prorated or spaced field complete the plat below showing that the well will be properly located in relationship to other wells producing from the common source of supply. Please show all the wells within 1 mile of the boundaries of the proposed acreage attribution unit for gas wells and within 1/2 mile of the boundaries of the proposed acreage attribution unit for oil wells.

API NO. 15-

OPERATOR Fremont Energy Corporation
 LEASE F. Walker "B"
 WELL NUMBER #6
 FIELD Riffe

LOCATION OF WELL: COUNTY Rooks
3,830 feet from south/~~north~~ line of section
830 feet from east/~~west~~ line of section
 SECTION 19 TWP 7S RG 17W

NUMBER OF ACRES ATTRIBUTABLE TO WELL 10
 QTR/QTR/QTR OF ACREAGE NW - SE - NE

IS SECTION X REGULAR or IRREGULAR
IF SECTION IS IRREGULAR, LOCATE WELL FROM NEAREST CORNER BOUNDARY.

Section corner used: NE NW SE SW

PLAT

(Show location of the well and shade attributable acreage for prorated or spaced wells.)
 (Show footage to the nearest lease or unit boundary line.)

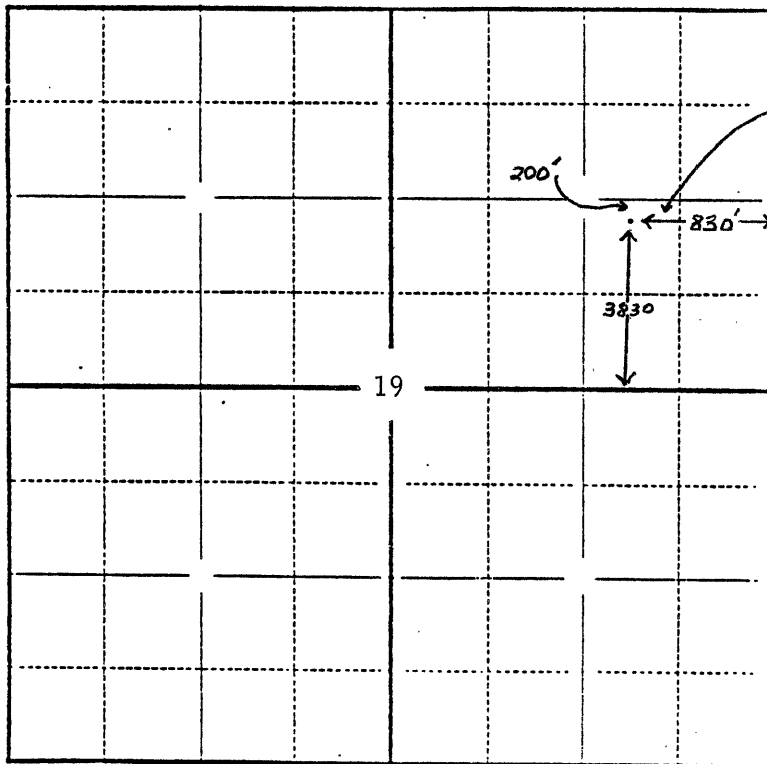

10 ACRES

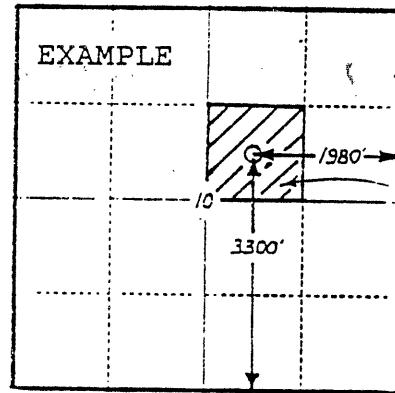

40 ACRES

In plotting the proposed location of the well, you must show:

- 1) The manner in which you are using the depicted plat by identifying section lines, i.e. 1 section, 1 section with 8 surrounding sections, 4 sections, etc.;
- 2) the distance of the proposed drilling location from the section's south/north and east/west lines; and
- 3) the distance to the nearest lease or unit boundary line.