

ORIGINAL

SIDE ONE

STATE CORPORATION COMMISSION OF KANSAS  
OIL & GAS CONSERVATION DIVISION  
WELL COMPLETION FORM  
ACO-1 WELL HISTORY  
DESCRIPTION OF WELL AND LEASE

API NO. 15- 163-23,121 -00-00

County Rooks

SE NE NW Sec. 19 Twp. 7S Rge. 17 East 18 West x

4290 Ft. North from Southeast Corner of Section

2970 Ft. West from Southeast Corner of Section  
(NOTE: Locate well in section plat below.)

Lease Name Wehrli Well # 1

Field Name \_\_\_\_\_

Producing Formation Arbuckle

Elevation: Ground 1757' KB 1762'

Total Depth 3269' PBTD \_\_\_\_\_

Operator: License # 7076

Name: Black Diamond Oil, Inc.

Address 3004 Broadway Avenue

City/State/Zip Hays, KS 67601

Purchaser: Farmland Industries, Inc.

Operator Contact Person: Kenneth Vehige

Phone (913) -625-5891

Contractor: Name: Emphasis Oil Operations

License: 8241

Wellsite Geologist: Kenneth Vehige

Designate Type of Completion  
 New Well  Re-Entry  Workover

Oil  SWD  Temp. Abd.

Gas  Inj  Delayed Comp.

Dry  Other (Core, Water Supply, etc.)

If **OWO**: old well info as follows:

Operator: \_\_\_\_\_

Well Name: \_\_\_\_\_

Comp, Date \_\_\_\_\_ Old Total Depth \_\_\_\_\_

Drilling Method:

Mud Rotary  Air Rotary  Cable

10/20/90 10/26/90 12/10/90  
Spud Date Date Reached TD Completion Date

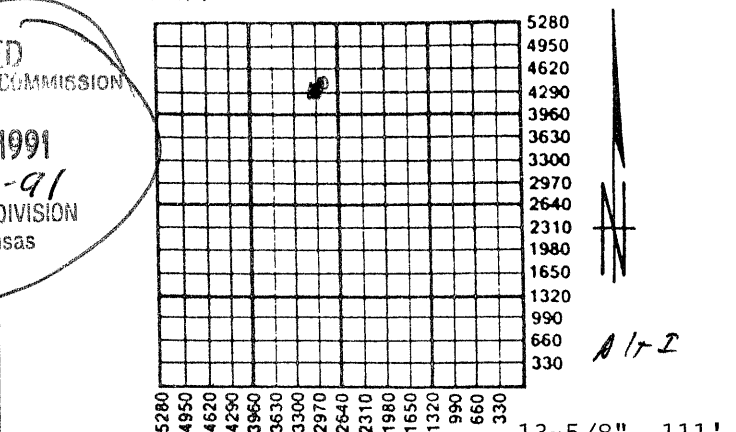

Amount of Surface Pipe Set and Cemented at 8-5/8" 1216 Feet

Multiple Stage Cementing Collar Used?  Yes  No

If yes, show depth set \_\_\_\_\_ Feet

If Alternate II completion, cement circulated from \_\_\_\_\_

feet depth to \_\_\_\_\_ w/ \_\_\_\_\_ sx cmt.

**INSTRUCTIONS:** This form shall be completed in triplicate and filed with the Kansas Corporation Commission, 200 Colorado Derby Building, Wichita, Kansas 67202, within 120 days of the spud date of any well. Rule 82-3-130, 82-3-107 and 82-3-106 apply. Information on side two of this form will be held confidential for a period of 12 months if requested in writing and submitted with the form. See rule 82-3-107 for confidentiality in excess of 12 months. **One copy of all wireline logs and drillers time log shall be attached with this form. ALL CEMENTING TICKETS MUST BE ATTACHED.** Submit CP-4 form with all plugged wells. Submit CP-111 form with all temporarily abandoned wells. Any recompletion, workover or conversion of a well requires filing of ACO-2 within 120 days from commencement date of such work.

All requirements of the statutes, rules and regulations promulgated to regulate the oil and gas industry have been fully complied with and the statements herein are complete and correct to the best of my knowledge.

Signature Kenneth Vehige  
Title Owner/Operator Date 1/15/91

Subscribed and sworn to before me this 15th day of Jan.,  
19 91.

Notary Public Jolene H. Klaus

Date Commission Expires 2/5/94

**K.C.C. OFFICE USE ONLY**  
F  Letter of Confidentiality Attached  
C  Wireline Log Received  
C  Drillers Timelog Received  
**Distribution**  
 KCC  SWD/Rep  NGPA  
 KGS  Plug  Other  
(Specify)

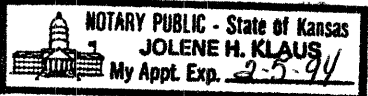

**SIDE TWO**

Operator Name Black Diamond Oil, Inc. Lease Name Wehrli Well # 1  
 Sec. 19 Twp. 7S Rge. 18  East County Rooks  
 West

**INSTRUCTIONS:** Show important tops and base of formations penetrated. Detail all cores. Report all drill stem tests giving interval tested, time tool open and closed, flowing and shut-in pressures, whether shut-in pressure reached static level, hydrostatic pressures, bottom hole temperature, fluid recovery, and flow rates if gas to surface during test. Attach extra sheet if more space is needed. Attach copy of log.

Drill Stem Tests Taken  Yes  No  
 (Attach Additional Sheets.) test tickets attached  
 Samples Sent to Geological Survey  Yes  No  
 Cores Taken  Yes  No  
 Electric Log Run  Yes  No  
 (Submit Copy.)

**Formation Description**

Name	Formation Description	
	Log	Sample
Anhydrite	1211	
Topeka	2701	
Heebner	2911	
Lansing-K.C.	2955	3179
Arbuckle	3250	
R.T.D.	3261	
DDTD	3269	

**CASING RECORD**

New  Used

Report all strings set-conductor, surface, intermediate, production, etc.

Purpose of String	Size Hole Drilled	Size Casing Set (In O.D.)	Weight Lbs./Ft.	Setting Depth	Type of Cement	# Sacks Used	Type and Percent Additives
Conductor	17 1/4"	13 3/8"	N/A	111	60/40Poz	100	2%Gel, 3%CC
Surface	12 1/4"	8 5/8"	N/A	1216	60/40Poz	425	" "
Production	7 7/8"	5 1/2"	14#	3250	Com.	190	10% Salt

**PERFORATION RECORD**

Shots Per Foot Specify Footage of Each Interval Perforated

None

**Acid, Fracture, Shot, Cement Squeeze Record**  
 (Amount and Kind of Material Used) Depth

**TUBING RECORD**

Size 2 7/8" Set At 3265' Packer At None

Liner Run  Yes  No

Date of First Production Est. 1/18/91 Producing Method  Flowing  Pumping  Gas Lift  Other (Explain)

Estimated Production Per 24 Hours  
 Oil 25 Bbls. Gas -0- Mcf Water -0- Bbls. Gas-Oil Ratio Gravity

Disposition of Gas:

Vented  Sold  Used on Lease  
 (If vented, submit ACO-18.)

**METHOD OF COMPLETION**

Open Hole  Perforation  Dually Completed  Commingled  
 Other (Specify) \_\_\_\_\_

Production Interval

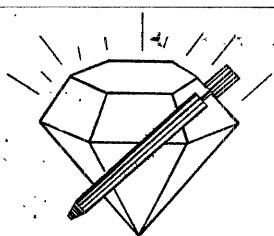

# DIAMOND TESTING

P. O. Box 157  
HOISINGTON, KANSAS 67544  
(316) 653-7550

## DRILL-STEM TEST TICKET

Company BLACK DIAMOND OIL - Lease & Well No. WEHRU #1  
 Contractor EMPHASIS OIL RIG 6 Charge to BLACK DIAMOND OIL  
 Elevation \_\_\_\_\_ Formation LKC Effective Pay \_\_\_\_\_ Ft. Ticket No. J818  
 Date 10/24/96 Sec. 19 Twp. 2 S Range 18 W County ROCKS State KANSAS  
 Test Approved By [Signature] Diamond Representative [Signature]

Formation Test No. 1 Interval Tested from 3019 ft. to 3070 ft. Total Depth 3070 ft.  
 Packer Depth 3014 ft. Size 6 3/4 in. Packer Depth \_\_\_\_\_ ft. Size \_\_\_\_\_ in.  
 Packer Depth 3019 ft. Size 6 3/4 in. Packer Depth \_\_\_\_\_ ft. Size \_\_\_\_\_ in.  
 Depth of Selective Zone Set \_\_\_\_\_

Top Recorder Depth (Inside) 3062 ft. Recorder Number 11017 Cap. 3800 P.S.I.  
 Bottom Recorder Depth (Outside) 3067 ft. Recorder Number 11023 Cap. 4000 P.S.I.  
 Below Straddle Recorder Depth \_\_\_\_\_ ft. Recorder Number \_\_\_\_\_ Cap. \_\_\_\_\_ P.S.I.

Mud Type STAR # Viscosity 40 Drill Collar Length 0 ft. I.D. 2 1/4 in.  
 Weight 9.4 Water Loss 7 cc. Weight Pipe Length 0 ft. I.D. 2 7/8 in.  
 Chlorides 80,000 P.P.M. Drill Pipe Length 2995 ft. I.D. 3 1/2 in.  
 Jars: Make BOWEN Serial Number 10078AN Test Tool Length 24 ft. Tool Size 3 1/2 in.  
 Did Well Flow? NO Reversed Out NO Anchor Length 51 ft. Size 4 1/2 in.  
 Main Hole Size 7 7/8 Tool Joint Size 4 1/2 in. Surface Choke Size 1 in. Bottom Choke Size 5/8 in.

Blow: 1st Flow: GOOD BLOW (BUILT TO 6")  
 2nd Flow: WEAK BLOW (1 1/2")

Recovered 50 ft. of SL OIL CUT MUD  
 Recovered 170 ft. of VERY SLIGHTLY OIL CUT MUD  
 Recovered \_\_\_\_\_ ft. of \_\_\_\_\_

RECEIVED  
STATE CONSERVATION COMMISSION  
JAN 16 1997  
CONSERVATION DIVISION  
Wichita, Kansas

Recovered _____ ft. of _____	Price Job
Recovered _____ ft. of _____	Other Charges
Remarks: <u>TOTAL FLUID REC 170</u>	Insurance
	Total

Time Set Packer(s) 10:32 A.M. Time Started Off Bottom 1:47 A.M. Maximum Temperature 104°  
 Initial Hydrostatic Pressure ..... (A) 1596 P.S.I.  
 Initial Flow Period ..... Minutes 30 (B) 96 P.S.I. to (C) 100 P.S.I.  
 Initial Closed In Period ..... Minutes 45 (D) 522 P.S.I.  
 Final Flow Period ..... Minutes 60 (E) 116 P.S.I. to (F) 118 P.S.I.  
 Final Closed In Period ..... Minutes 60 (G) 410 P.S.I.  
 Final Hydrostatic Pressure ..... (H) 1582 P.S.I.

Diamond Testing shall not be liable for damages of any kind to the property or personnel of the one for whom a test is made or for any loss suffered or sustained, directly or indirectly, through the use of its equipment, or its statement or opinion concerning the result of any test. Tools lost or damaged in the hole shall be paid for at cost by the party for whom the test is made.

Kansas  
Great Bend, Kansas

ORIGINAL  
New

Phone Plainville 913-434-2812

Phone Ness City 913-798-3843

# ALLIED CEMENTING CO., INC. N<sup>o</sup> 9050

Home Office P. O. Box 31

Russell, Kansas 67665

Date	10-21-90	Sec.	19	Twp.	7 <sup>s</sup>	Range	18 <sup>w</sup>	Called Out	9:45 A.M.	On Location	11:45 A.M.	Job Start	4:30 P.M.	Finish	5:15 P.M.	
Lease	Wetuli	Well No.	1	Location				Stockton 7/8 E 1/4 S	County	Rooks	State	Ks.				

Contractor	Emphasis Oil Operations Rig #6		
Type Job	Set Surface Pipe		
Hole Size	12 1/4"	T.D.	1219'
Csg.	8 5/8"	Depth	1216'
Csg. Size	13 7/8"	Depth	111'
Drill Pipe		Depth	
Tool		Depth	
Cement Left in Csg.	20'	Shoe Joint	
Press Max.	600 #	Minimum	
Meas Line	X	Displace	
Perf.			

Owner	Same
To Allied Cementing Co., Inc. You are hereby requested to rent cementing equipment and furnish cementer and helper to assist owner or contractor to do work as listed.	
Charge To	Black Diamond Oil, Inc.
Street	3004 Broadway Ave.
City	Hays, State Ks. 67601
The above was done to satisfaction and supervision of owner agent or contractor.	
Purchase Order No.	
X	MISSION CEMENT
Amount Ordered	425 sks 60/40 per 2 legs, 38 c.c.
Consisting of	

EQUIPMENT

No.	Cementor	
Pumptrk 191	Helper	Gary H. Wayne Mc.
No.	Cementor	
Pumptrk	Helper	
	Driver	Glen C.
Bulktrk #212		
Bulktrk #213	Driver	Paul D.

Amount Ordered	425 sks 60/40 per 2 legs, 38 c.c.
Consisting of	
Common	255 sks @ 5.25/sk. \$1338.75
Poz. Mix	170 sks @ 2.25/sk. 382.50
Gel.	8 sks N/C.
Chloride	13 sks @ 21.00/sk. 273.00
Quickset	
Sales Tax	

DEPTH of Job #1	Pumptruck-surface	\$380.00
Reference #1	916' @ 39¢/ft.	357.24
#13	mileage @ 2.00/mi.	30.00
	1-8 5/8" rubber plug	63.00
	Sub Total	\$830.24
	Tax	
	Total	

Handling	2.00/sk. (425 sks)	425.00
Mileage	2.03¢/sk./mi. (15 mi.)	191.25
Sub Total		\$2610.50
Total		
Floating Equipment	8 7/8"	

Remarks: Cement Circulated.

Thanks

1- centralizer - \$61.00

Phone 316-793-5861, Great Bend, Kansas

ORIGINAL

Phone Plainville 913-434-2812  
Phone Ness City 913-798-3843

New

# ALLIED CEMENTING CO., INC. N<sup>o</sup> 9047

Home Office P. O. Box 31      Russell, Kansas 67665

Date	10-20-90	Sec.	19	Twp.	7 <sup>s</sup>	Range	18 <sup>w</sup>	Called Out	3:30 A.M.	On Location	5:45 A.M.	Job Start	7:25 A.M.	Finish	8:00 A.M.
Lease	Wehrli	Well No.	1	Location				Stockton 7/8 E 1/4 S		County	Rooks	State	Ks.		
Contractor	Emphasis Oil Operations Rig #6								Owner	Same					
Type Job	Set Conductor Pipe								To Allied Cementing Co., Inc. You are hereby requested to rent cementing equipment and furnish cement and helper to assist owner or contractor to do work as listed.						
Hole Size	17 1/4"		T.D.	112'											
Csg.	13 3/8"		Depth	111'											
Tbg. Size			Depth												
Drill Pipe			Depth												
Tool			Depth												
Cement Left in Csg.	7'		Shoe Joint												
Press Max.			Minimum												
Meas Line			Displace	X											
Perf.															

**EQUIPMENT**

Pumptrk	191	Cementor	Gary H. Wayne Mc.
		Helper	
Pumptrk		Cementor	Glen C.
		Helper	
Bulktrk	#212	Driver	
Bulktrk		Driver	

**DEPTH of Job**

Reference #1	Pumptruck-conductor	#380.00
#13	mileage @ 2.00/mi.	30.00
Sub Total		410.00
Tax		
Total		

Remarks: Cement Circulated

Charge To	Black Diamond Oil, Inc.	
Street	3004 Broadway, Ave.	
City	Hays	State Ks. 67601
The above was done to satisfaction and supervision of owner agent or contractor.		
Purchase Order No.	X <i>[Signature]</i>	
Amount Ordered	100 sks 60/40 @ 2.20/sk, 3 b.c.c.	
Consisting of		
Common	60 sks @ 5.25/sk.	\$315.00
Poz. Mix	40 sks @ 2.25/sk.	90.00
Gel.	2 sks	N/C.
Chloride	3 sks @ 21.00/sk.	63.00
Quickset		
Sales Tax		
Handling	2.00/sk. (100 sks)	100.00
Mileage	2.03¢/sk./mi. (15 mi.)	45.00
Sub Total		613.00
Total		
Floating Equipment	Thanks	

3-2627, Russell, Kansas

316-773-5861, Great Bend, Kansas

Phone Plainville 913-434-2812

Phone Ness City 913-798-3843

# ALLIED CEMENTING CO., INC. N<sup>o</sup> 9059

Home Office P. O. Box 31

Russell, Kansas 67665

Date	10-26-90	Sec	19	Twp.	7 <sup>s</sup>	Range	18 <sup>w</sup>	Called Out	6:00 A.M.	On Location	8:00 A.M.	Job Start	9:15 A.M.	Finish	10:00 A.M.	
Lease	Wehrli	Well No.	1	Location				Stockton 7/8 E 1/4 S	County	Rooks	State	Ks.				
Contractor	Emphasis Oil Operations				Rig #		6	Owner	Same							
Type Job	Production String															
Hole Size	7 7/8"	T.D.	3261'													
Csg.	5 1/2"	Depth	3255'													
Csg. Size	8 7/8"	Depth	1216'													
Conductor Drill Pipe	13 3/8"	Depth	111'													
Tool																
Cement Left in Csg.	15'	Shoe Joint	15'													
Press Max.	1100 #	Minimum														
Meas Line	X	Displace														
Perf.																

To Allied Cementing Co., Inc.  
You are hereby requested to rent cementing equipment and furnish cementer and helper to assist owner or contractor to do work as listed.

Charge To Black Diamond Oil, Inc.  
Street 3004 Broadway Ave  
City Hays, State Ks. 67601

The above was done to satisfaction and supervision of owner agent or contractor.

Purchase Order No. [Signature]

## CEMENT

Amount Ordered 190 sks com 10% salt

Consisting of Common 190 sks @ 5.25/sk. #997.50

Poz. Mix Gel. Chloride Quickset

Salt - 19 sks @ 4.75/sk. 90.25

Handling @ 1.00/sk. (190 sks) 190.00

Mileage @ 0.37/sk./mi. (15 mi) 85.50

Sub Total #1363.25

Total

Floating Equipment RECEIVED Thanks  
JAN 16 1991

CONSERVATION DIVISION  
Wichita, Kansas

## EQUIPMENT

No.	Cementer	Gary H. Wayne Mc
Pumptrk 191	Helper	
No.	Cementer	Glen C.
Pumptrk	Helper	
	Driver	
Bulktrk #212	Driver	

## DEPTH of Job

Reference #	Description	Amount
#1	Pump truck - long string	\$880.00
#13	mileage @ 2.00/mi.	30.00
	1-5 1/2" rubber plug	45.00
	Sub/Total	\$955.00
	Tax	
	Total	

Remarks: Float Held.

Plugged rat hole w/15 sks.  
Cemented long string w/175 sks.