

TYPE

AFFIDAVIT OF COMPLETION FORM

ACO-1 WELL HISTORY

Compt. _____

SIDE ONE

(Rules 82-3-130 and 82-3-107)

DOCKET NO. NP _____

This form shall be filed with the Kansas Corporation Commission, 200 Colorado Derby Building, Wichita, Kansas 67202, within ninety (90) days after the completion of a well, regardless of how the well was completed.

FOR INFORMATION REGARDING THE NUMBER OF COPIES TO BE FILED AND APPLICATIONS REQUIRING COPIES OF ACO-1 FORMS SEE PAGE TWO (2), SIDE TWO (2) OF THIS FORM.

F _____ Letter requesting confidentiality attached.

C XXX Attach ONE COPY of EACH wireline log run (i.e. electrical log, sonic log, gamma ray neutron log etc.)***Check here if NO logs were run _____.

PLEASE FILL IN ALL INFORMATION. IF NOT AVAILABLE, INDICATE. IF INFORMATION LATER BECOMES AVAILABLE, SUBMIT BY LETTER.

LICENSE # 8932 EXPIRATION DATE April, 1984
 OPERATOR Apache Corporation API NO. 15-163-22-156-00000
 ADDRESS 1660 Lincoln St. #2300 COUNTY Rooks
Denver, CO 80264 FIELD Riffe
 ** CONTACT PERSON Raymond C. Kersey PROD. FORMATION Arbuckle
 PHONE (303) 861-1751 XX Indicate if new pay.
 PURCHASER Farmland Industires, Inc. LEASE Hutton
 ADDRESS POB 7305 WELL NO. 4
Kansas City, MO 64116 WELL LOCATION 70'N-C-E/2-E/2-W/2
 DRILLING Emphasis Oil Operations 70 Ft. from S Line and
 CONTRACTOR POB 506 330 Ft. from E Line of (X)
 ADDRESS Russell, KS 67665 the NW (Qtr.) SEC 19 TWP 7S RGE 17 (W).

PLUGGING CONTRACTOR ADDRESS _____

WELL PLAT (Office Use Only)

KCC
 KGS
 SWD/REP _____
 PLG. _____
 NGPA _____

TOTAL DEPTH 3340' PBD 3308'
 SPUD DATE 9/13/83 DATE COMPLETED 10/7/83
 ELEV: GR 1741' DF _____ KB 1746'
 DRILLED WITH (CABLE) (ROTARY) (AIR) TOOLS.
 DOCKET NO. OF DISPOSAL OR REPRESSURING WELL BEING USED TO DISPOSE OF WATER FROM THIS LEASE _____

Amount of surface pipe set and cemented 1185' DV Tool Used? NO

TYPE OF COMPLETION THIS AFFIDAVIT APPLIES TO: (Circle ONE) Oil, Shut-in Gas, Gas, Dry, Disposal, Injection, Temporarily Abandoned. If OWWO, indicate type of re-completion _____. Other completion _____. NGPA filing _____.

ALL REQUIREMENTS OF THE STATUTES, RULES AND REGULATIONS PROMULGATED TO REGULATE THE OIL AND GAS INDUSTRY HAVE BEEN FULLY COMPLIED WITH.

A F F I D A V I T

_____, being of lawful age, hereby certifies that:

I am the Affiant, and I am familiar with the contents of the foregoing Affidavit. The statements and allegations contained therein are true and correct.

Raymond C. Kersey
 (Name)
 SUBSCRIBED AND SWORN TO BEFORE ME this 4th day of January, 1984.

MY COMMISSION EXPIRES: 3/27/84

Gerald S. Ringel
 (NOTARY PUBLIC)
 RECEIVED
 STATE CORPORATION COMMISSION

** The person who can be reached by phone regarding any questions concerning this information.

JAN 09 1984
 CONSERVATION DIVISION
 Wichita, Kansas
 1-9-84

Side TWO

OPERATOR Apache Corporation LEASE NAME Hutton SEC 19 TWP 7S RGE 17 (E)
 WELL NO 4 (W)

FILL IN WELL INFORMATION AS REQUIRED;

Show all important zones of porosity and contents thereof; cored intervals, and all drill-stem tests, including depth interval tested, cushion used, time tool open, flowing and shut-in pressures, and recoveries.

Show Geological markers, logs run, or other Descriptive information.

Formation description, contents, etc.	Top	Bottom	Name	Depth
Check if no Drill Stem Tests Run. Check if samples sent Geological Survey.				
DST #1 3265-3234' 15-30-30-60 Arbuckle DP Rec : 720' gas cut oil, 120 gas mud cut oil, 60' clean gassy oil, 60' mud cut oil, 960' total. ISIP 1077#, IOP 206, FOP 275-403, FSIP 1087#.				
Anhydrite		1172		
Topeka		2684		
Toronto		2895		
Lansing/KC		2937		
Arbuckle		3226		
RTD		3340		
If additional space is needed use Page 2				

Report of all strings set — surface, intermediate, production, etc. CASING RECORD (New) or (XXX)

Purpose of string	Size hole drilled	Size casing set (in O.D.)	Weight lbs/ft.	Setting depth	Type cement	Sacks	Type and percent additives
Conductor	17 1/2	13 3/8	48	88	Class B	100	None
Surface	12 1/2	8 5/8	24	1185	common POZ 40/60	250 250	2% gel - 3% CaCl
Production	7 7/8	5 1/2	15.50	3338	Common	150	4% gel - 6% CaCl Seal

LINER RECORD			PERFORATION RECORD		
Top, ft.	Bottom, ft.	Sacks cement	Shots per ft.	Size & type	Depth interval

TUBING RECORD		
Size	Setting depth	Packer set at
2 7/8"	3290'	

ACID, FRACTURE, SHOT, CEMENT SQUEEZE RECORD	
Amount and kind of material used	Depth interval treated
200 gal 15% Hcl	3265-3270'

Date of first production 10/7/83	Producing method (flowing, pumping, gas lift, etc.) Pumping	Gravity 23
Estimated Production-I.P. 42 bbls.	Gas NA MCF	Water 80% 169 bbls.
Disposition of gas (vented, used on lease or sold) Vented		Gas-oil ratio NA CFPB

3265-3270' Arbuckle Perforations

TOM.

Here is a preliminary map to give you an idea what is there.

Not all on Perm

STOCKTON

183 Hwy

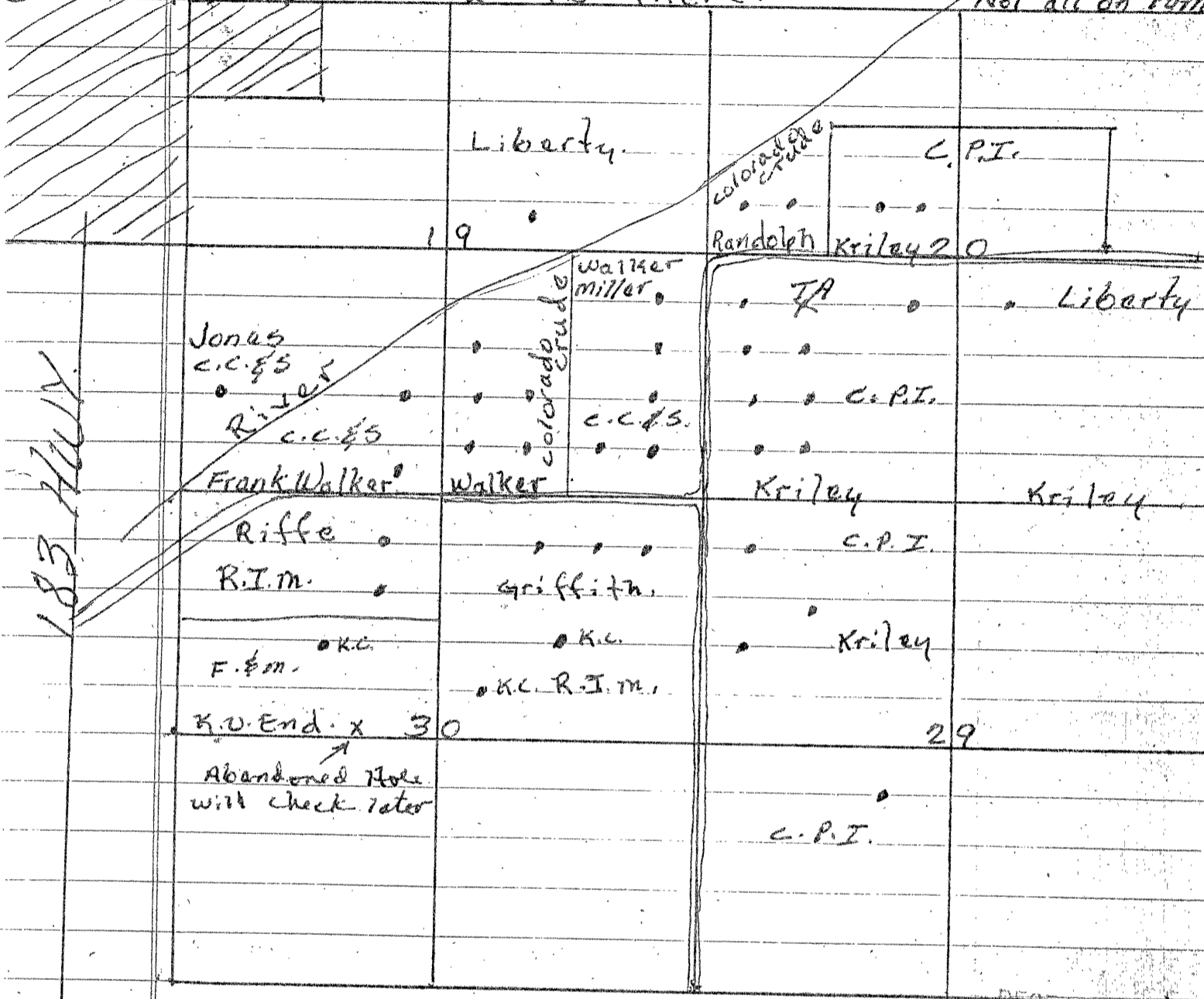

RECEIVED
STATE CORPORATION COMMISSION

JAN 26 1982

CONSERVATION DIVISION
Wichita Kansas

c.c. & s. - Chaban, Cory & Scott

Prod. Kenney Vahige Hays

Leroy Berland Plainville

colorado crude - Operated by c.c. & s.

C.P.I. - Columbia Pet. Inc.

Prod. Carl Barns Hays 913 628 2095

Prod. Eric Waddell Natoma 913 895 4497

Liberty R. Comeau Plainville

R.I.M. Myrlin Monroe Plainville

F. & M. Prod. Preston Burkley Russell