

CARD MUST BE TYPED

State of Kansas

CARD MUST BE SIGNED

NOTICE OF INTENTION TO DRILL

163-22,961

(see rules on reverse side)

✓
10

Expected Spud Date..... 11 15 87
month day year

API Number 15-163-22,961-00-00

OPERATOR: License # 4767

SE NW NW Sec. 6 Twp. 7 S, Rg. 20 East

Name Ritchie Exploration, Inc.

4290 Ft. from South Line of Section

Address 125 N. Market, Suite 1000

4290 Ft. from East Line of Section

City/State/Zip Wichita, KS 67202

(Note: Locate well on Section Plat on reverse side)

Contact Person Jeff Christian

Nearest lease or unit boundary line 330 feet

Phone 316/267-4375

County Rooks

CONTRACTOR: License # 6033

Lease Name Waller Well # 2

Name Murfin Drilling Co.

Ground surface elevation 2220 feet MSL

City/State Wichita, KS

Domestic well within 330 feet: yes no

Well Drilled For: Well Class: Type Equipment:

Municipal well within one mile: yes no

X Oil Storage Infield X Mud Rotary

Depth to bottom of fresh water 100'

Gas Inj X Pool Ext Air Rotary

Depth to bottom of usable water 1200'

OWWO Expl Wildcat Cable

Surface pipe by Alternate: 1 2 X

If OWWO: old well info as follows:

Surface pipe planned to be set 200'

Operator

Conductor pipe required

Well Name

Projected Total Depth 3750' feet

Comp Date Old Total Depth

Formation Arbuckle

I certify that well will comply with K.S.A. 55-101, et seq., plus eventually plugging hole to KCC specifications.

Date 11-10-87 Signature of Operator or Agent Jeff Christian

Title Geologist

For KCC Use:

Conductor Pipe Required feet; Minimum Surface Pipe Required 200 feet per Alt. X 2

This Authorization Expires 5-10-88 Approved By Jeff Christian 11-10-87

EFFECTIVE DATE: 11-15-87

Must be filed with the K.C.C. five (5) days prior to commencing well
 This card void if drilling not started within six (6) months of date received by K.C.C.

Important procedures to follow:

1. Notify District office before setting surface casing.
2. Set surface casing by circulating cement to the top.
3. File completion forms ACO-1 with K.C.C. within 120 days of well spud date, following instructions on ACO-1, side 1, and including copies of wireline logs.
4. Notify District office 48 hours prior to old well workover or re-entry.
5. Prior to filing Intent, prepare a proposed plugging plan in case well is D & A, then obtain approval of plan when calling district office prior to setting surface pipe.
6. Submit plugging report (CP-4) to K.C.C. after plugging is completed.
7. Obtain an approved injection docket number before disposing of salt water.
8. Notify K.C.C. within 10 days when injection commences or terminates.
9. If an alternate 2 completion, cement in the production pipe from below any usable water to surface within 120 days of spud date.

**A Regular Section of Land
 1 Mile = 5,280 Ft.**

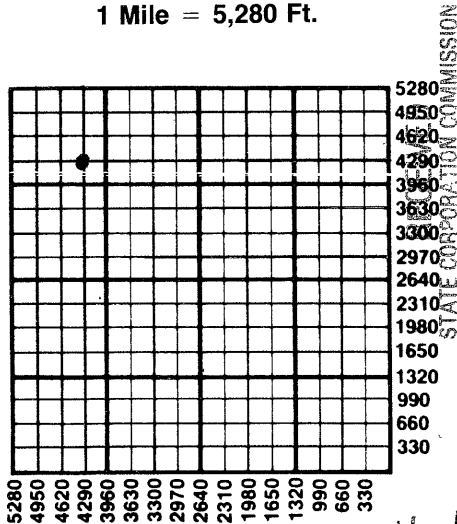

NOV 10 1987

CONSERVATION DIVISION
 Wichita, Kansas

11-10-1987

State Corporation Commission of Kansas
 Conservation Division
 200 Colorado Derby Building
 Wichita, Kansas 67202-1212
 (316) 263-3238