

STATE OF KANSAS
STATE CORPORATION COMMISSION
CONSERVATION DIVISION
P. O. BOX 17027
WICHITA, KANSAS 67217

Rev. 6-3-74
FORM CP-1

WELL PLUGGING APPLICATION FORM
File One Copy

API Number 15 - 163 - 20,945 - 0000 (of this well)
Lease Owner John O. Farmer, Inc.
Address P.O. Box 352, Russell, KS 67665
Lease (Farm Name) Bouchey Well No. #1
Well Location C NW NE Sec. 19 Twp. 7S Rge. 18 (E) (W)
County Rooks Total Depth 3392' Field Name Wildcat
Oil Well Gas Well Input Well SWD Well Rotary D & A
Well Log attached with this application as required Yes
Date and hour plugging is desired to begin 7:30 A.M., 8-10-79

PLUGGING OF THIS WELL WILL BE DONE IN ACCORDANCE WITH K.S.A. 55-128 OF THE RULES AND REGULATIONS OF THE STATE CORPORATION COMMISSION.

Name of company representative authorized to be in charge of plugging operations:

Raymond Kaba Address 807 S. Jefferson, Plainville, KS

Plugging Contractor John O. Farmer, Inc. License No. none

Address P.O. Box 352, Russell, KS 67665

Invoice covering assessment for plugging this well should be sent to: AUG 21 1979

Name John O. Farmer, Inc.

Address P.O. Box 352, Russell, KS 67665

and payment will be guaranteed by applicant or acting agent.

Signed: John O. Farmer
Applicant or Acting Agent

Date: August 20, 1979

RECEIVED
STATE CORPORATION COMMISSION
AUG 21 1979
8-21-79
CONSERVATION DIVISION
Wichita, Kansas

The Kansas Geological Survey needs samples from this well for research. Also, if this well penetrates the PreCambrian, the Survey would like to have all the cuttings that contain crystalline samples.

IMPORTANT
 Kans. Geo. Survey request
 samples on this well.

KANSAS DRILLERS LOG

S. 19 T. 7 R. 18 W
 Loc. C NW NE
 County Rooks

API No. 15 — 163 County — 20,945 Number 00-00

Operator
John O. Farmer, Inc.

Address
P. O. Box 352 Russell, Kansas 67665

Well No. #1 Lease Name Bouchey

Footage Location
660 feet from (N) XSI line 660 feet from (W) XEJ line

Principal Contractor John O. Farmer, Inc. Geologist Lewis Chubb

Spud Date 8-2-79 Total Depth 3392' P.B.T.D.

Date Completed 8-10-79 Oil Purchaser

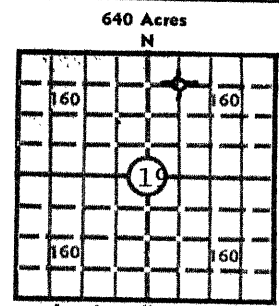

Locate well correctly
 Elev.: Gr. 1903'
 DF 1906' KB 1908'

CASING RECORD

Report of all strings set— surface, intermediate, production, etc.

Purpose of string	Size hole drilled	Size casing set (in O.D.)	Weight lbs/ft.	Setting depth	Type cement	Sacks	Type and percent additives
Surface	12-1/4"	8-5/8"	28	205'	Common	160	

LINER RECORD

PERFORATION RECORD

Top, ft.	Bottom, ft.	Sacks cement	Shots per ft.	Size & type	Depth interval

TUBING RECORD

Size	Setting depth	Packer set at

ACID, FRACTURE, SHOT, CEMENT SQUEEZE RECORD

Amount and kind of material used	Depth interval treated

RECEIVED
 STATE CORPORATION COMMISSION
8-21-79
 AUG 21 1979

INITIAL PRODUCTION

Date of first production _____ Producing method (flowing, pumping, gas lift, etc.) _____

RATE OF PRODUCTION PER 24 HOURS	Oil	Gas	Water	Gas-oil ratio
	bbls.	bbls.	MCF	bbls.

Disposition of gas (vented, used on lease or sold) _____ Producing interval (s) _____

INSTRUCTIONS: As provided in KCC Rule 82-2-125, within 90 days after completion of a well, one completed copy of this Drillers Log shall be transmitted to the State Geological Survey of Kansas, 4150 Monroe Street, Wichita, Kansas 67209. Copies of this form are available from the Conservation Division, State Corporation Commission, 3830 So. Meridian (P.O. Box 17027), Wichita, Kansas 66217. Phone AC 316-522-2206. If confidential custody is desired, please note Rule 82-2-125. Drillers Logs will be on open file in the Oil and Gas Division, State Geological Survey of Kansas, Lawrence, Kansas 66044.

Operator **John O. Farmer, Inc.** DESIGNATE TYPE OF COMP.: OIL, GAS, DRY HOLE, SWDW, ETC.:

Well No. **#1** Lease Name **Bouchev** Dry Hole

S 19 T 7S R 18 W

WELL LOG

Show all important zones of porosity and contents thereof; cored intervals, and all drill-stem tests, including depth interval tested, cushion used, time tool open, flowing and shut-in pressures, and recoveries.

SHOW GEOLOGICAL MARKERS, LOGS RUN, OR OTHER DESCRIPTIVE INFORMATION.

FORMATION DESCRIPTION, CONTENTS, ETC.	TOP	BOTTOM	NAME	DEPTH
Clay Post Rock	-0-	50	Anhydrite	1335 (+573)
Blue Shale	50	207	Base Anhyd.	1369 (+539)
Shale & Sand	207	780	Topeka	2856 (-948)
Shale	780	828	Heebner	3064 (-1156)
Sand	828	1041	Toronto	3086 (-1178)
Red Bed	1041	1334	Lansing KC	3101 (-1193)
Anhydrite	1334	1369	T.D.	3392 (-1484)
Shale & Shells	1369	1463		
Shale & Lime	1463	2840		
Lime & Shale	2840	2965		
Shale & Lime	2965	3060		
Lime & Shale	3060	3135		
Lime	3135	3392		
DST#1 3183-3202 Weak to good blow Rec: 330' saltwater IFP: 1141 FP: 52-94 FFP: 125-187 F clsd-in Prs: 1151 Tool Open 30-30-45-60				

USE ADDITIONAL SHEETS, IF NECESSARY, TO COMPLETE WELL RECORD.

Date Received

John O. Farmer
Signature
President
Title
August 20, 1979
Date



15-163-20945-00-00

State Corporation Commission

CONSERVATION DIVISION

(Oil, Gas and Water)
245 North Water
WICHITA, KANSAS 67202
Telephone (316) 263-3238

August 16, 1979

WELL PLUGGING AUTHORITY

Well No.	1
Lease	Bouchey
Description	C NW NE Sec. 19-7S-18W
County	Rooks
Total Depth	3391'
Plugging Contractor	John O. Farmer, Inc.

John O. Farmer, Inc.
370 West Wichita
Russell, Kansas 67665
Gentlemen:

This is your authority to plug the above subject well in accordance with the Rules and Regulations of the State Corporation Commission.

This authority is void after 90 days from the above date.

Yours very truly,

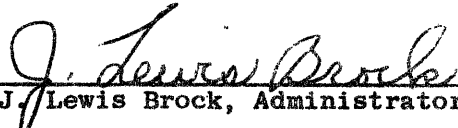
J. Lewis Brock, Administrator

Mr. ~~Marion Schmidt, 2104 Canterbury Rd., Hays, Kansas 67601~~
is hereby assigned to supervise the plugging of the above
named well.