

STATE CORPORATION COMMISSION OF KANSAS  
OIL & GAS CONSERVATION DIVISION  
WELL COMPLETION OR RECOMPLETION FORM  
ACO-1 WELL HISTORY  
DESCRIPTION OF WELL AND LEASE

Operator: License # 8000  
Name PanCanadian Petroleum Company  
Address 600 17th Street Suite 1800  
City/State/Zip Denver, CO 80202

Purchaser Koch Oil Company

Operator Contact Person Jim Keisling/Forrest Moore  
Phone (303) 825-8371

Contractor: License # 5422  
Name Abercrombie Drilling, Inc.

Wellsite Geologist Dan Watterson  
Phone (303) 825-8371

Designate Type of Completion  
 New Well  Re-Entry  Workover  
 Oil  SWD  Temp Abd  
 Gas  Inj  Delayed Comp.  
 Dry  Other (Core, Water Supply etc.)

If ONWO: old well info as follows:  
Operator  
Well Name  
Comp. Date Old Total Depth

WELL HISTORY

Drilling Method:  
 Mud Rotary  Air Rotary  Cable  
11/2/87 11/9/87 11/27/87  
Spud Date Date Reached TD Completion Date  
3750 3690  
Total Depth PBTD

Amount of Surface Pipe Set and Cemented at 311 feet  
Multiple Stage Cementing Collar Used?  Yes  No  
If yes, show depth set 1806 feet  
If alternate 2 completion, cement circulated  
from feet depth to w/SX cmt  
Cement Company Name B.J. Titan  
Invoice # 362722

API NO. 15-163-22595-00-00  
County Rooks 4  
SW NW Sec 6 Twp 7 Rge 20 East  
X West

3630 Ft North from Southeast Corner of Section  
4290 Ft West from Southeast Corner of Section  
(Note: Locate well in section plat below)

Lease Name Waller 12-6 Well # 1

Field Name Wildcat Solokow SE

Producing Formation Lansing/Kansas City

Elevation: Ground 2188 KB 2193

Section Plat

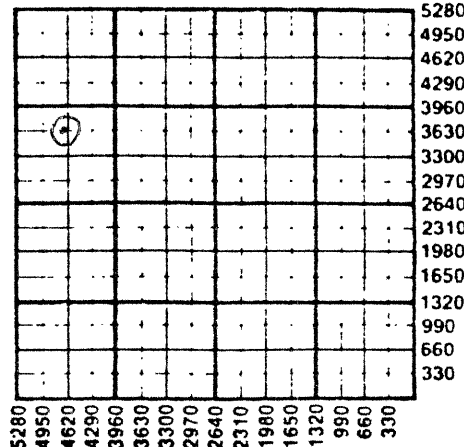

WATER SUPPLY INFORMATION

Disposition of Produced Water:  Disposal  
Docket #  Repressuring

Questions on this portion of the ACO-1 call:  
Water Resources Board (913) 296-3717

Source of Water:  
Division of Water Resources Permit #

Groundwater Ft North from Southeast Corner  
(Well) Ft West from Southeast Corner of  
Sec Twp Rge East West

Surface Water Ft North from Southeast Corner  
(Stream, pond etc) Ft West from Southeast Corner  
NW 1/4 Sec 9 Twp 7S Rge 20 East X West

Other (explain)  
(purchased from city, R.W.D. #)

INSTRUCTIONS: This form shall be completed in triplicate and filed with the Kansas Corporation Commission, 200 Colorado Derby Building, Wichita, Kansas 67202, within 120 days of the spud date of any well. Rule 82-3-130, 82-3-107 and 82-3-106 apply. Information on side two of this form will be held confidential for a period of 12 months if requested in writing and submitted with the form. See rule 82-3-107 for confidentiality in excess of 12 months. One copy of all wireline logs and drillers time log shall be attached with this form. Submit CP-4 form with all plugged wells. Submit CP-111 form with all temporarily abandoned wells.

All requirements of the statutes, rules and regulations promulgated to regulate the oil and gas industry have been fully complied with and the statements herein are complete and correct to the best of my knowledge.

Signature James D. Keisling  
Title Coordinator Engineering Operations Date 12/7/87  
U.S.

Subscribed and sworn to before me this 7 day of December 1987.  
Notary Public Katherine P. Ramsey  
Date Commission Expires 3/18/91

K.C.C. OFFICE USE ONLY  
 Letter of Confidentiality Attached  
 Wireline Log Received  
 Drillers Timelog Received  
Distribution  
 KCC  SWD/Rep  NGPA  
 KGS  Plug  Other  
(Specify)

NOV 14 1988  
01-14-1998

Sec. 6, Twp. 7, Rge. 20W

# JOB LOG

WELL NO. 126 LEASE 1/10/11 TICKET NO. 101010  
 OPERATOR Perm Canadian Petroleum Corp PAGE NO. 1  
 JOB TYPE Cmt Bldg Surf Cong. DATE 11-2-87

FORM 2010 R-2

CHART NO.	TIME	RATE (BPM)	VOLUME (BBL / GAL)	PUMPS		PRESSURE (PSI)		DESCRIPTION OF OPERATION AND MATERIALS
				T	C	TUBING	CASING	
	1500							On loc, Rig Crew Dtg 12 1/4" Hole, Set up Eq.
	1630							Finish Hole 30', Circulate
	1650							Finish Circ - Start out with Drill Pipe
	1705							Drill Pipe in track - Rig up to run 8 1/2"
	1715							Start Cong - Baffle Plug in 1st collar
								Centralizer around Clamp 15' up on 1st Jt, 2nd 14 1/2 collar
								Have weld in 1st 4 collars
	1745							Cong on bottom, Hook up - Plug Container to rig Pump
	1755							Break Circ -
	1805							Fin Circ - Hook to Truck
	1837	4				150		Start 160 Ahead
	1808	"	6 1/2					Start Mixing 205 lbs Std 2% Gel, 3 1/2 CC
	1830		49M Cmt					Fin Mixing - Shut Down
	1857	4						Release Plug - Start Displ.
	1825					300		Plug down - Close Manifold
								"Cmt Circ to collar"
								"
								"
								Job Complete
								Thank You
								Scotti Jack & Co

STATE CORPORATION COMMISSION  
 NOV - 7 1988  
 DEPARTMENT OF REVENUE  
 DIVISION OF OIL AND GAS

CUSTOMER

15-163-22959-00-00  
CUSTOMER COPY

SERVICES/MATERIAL CONTRACT

BJ-TITAN SERVICES COMPANY

DATE OF JOB		
MM	DD	YY

CONTRACT NO. **362722**

DIRECT CORRESPONDENCE TO:	TERMS:	REMIT TO:
PO. BOX 4442 HOUSTON, TX 77210	NET 30 DAYS FROM DATE OF CONTRACT	PO. BOX 200416 HOUSTON, TX 77216

ORDER NO. \_\_\_\_\_

CUSTOMER		
NAME	NO.	
ADDRESS		
CITY	STATE	ZIP CODE
AUTHORIZED BY		

DESCRIPTION OF WELL				
WELL NO.	OIL GAS	NEW OLD	STATE	CODES
LEASE NAME			COUNTY/PARISH	
FIELD NAME			CITY	
OWNER			MTA DISTRICT	
LEASE LINES				
SURVEY LINES				
SURVEY				
DIRECTIONS TO LOCATION				
SECTION, TOWNSHIP, RANGE				
QUADRANT				

JOB INFORMATION		ROUND TRIP MILES			
ARRIVED		RELEASED			
HH	MM	A	MM	DD	YY
12	55	P			
JOB CODE	TYPE OF JOB	API OR IC NO.			
0106	4 1/2" Prod	154352300			
AVG. PSI	BUSINESS CODE	INJ. RATE (BPM)	WORKING WELL DEPTH		
400			7350 FT.		

DIST. NO.	DISTRICT NAME	SLSMAN NO.
3370	Hwy	

CONTRACT CONDITIONS

This contract must be signed before the job is started or merchandise delivered. The undersigned is authorized to execute this contract as an Agent of the Customer. As such, the undersigned acknowledges that this contract for services, materials, products and/or supplies includes all of and only those terms and conditions appearing on the front and back of this document. No additional substitute terms and/or conditions shall become a part of this contract without the written consent of an Officer of BJ-TITAN SERVICES COMPANY.

SIGNED: \_\_\_\_\_ (WELL OWNER: OPERATOR, CONTRACTOR OR AGENT)

PRICE BOOK REF. NO.	SERVICES/MATERIAL	U/M	QUANTITY	PRICE	EXTENSION
01 1012232	Pump Truck Charge	F	7.00	300.00	2100.00
02 1012233	Depth below 200'	Fluo	7.50	4.00	73.50
03 1012234	2nd Stage Pump Truck	F	15.6	695.00	6712.00
04 1012235	Pump Truck Air Log	M	28	1.10	74.80
05 1042236	Common Cords	Q	400	5.30	2120.00
06 1042237	Pump Truck	Q	125	2.61	274.25
07 1042238	Oil	SK	26.10	6.25	176.18
08 1042239	Oil Charge	SK	6.82	25.21	172.93
09 1042240	A-2	lb	522	1.00	522.00
10 1042241	Oil Charge	lb	73	1.27	92.71
11 1042242	Med Sweep	Gal	500	1.45	725.00
12 1062243	Handing & Hoisting	SK	590	1.8	1062.00
13 1092244	Hoisting 2.5 ton	SK	96.9	70	6783.00
14	SUBTOTAL				7496.66
15	TAX				1649.27
16	TOTAL				5847.39

SERVICE REPRESENTATIVE <i>Ben R. DeKam</i>	PR. BOOK 07	The above material and service ordered by the Customer and received by: _____ (WELL OWNER, OPERATOR, CONTRACTOR OR AGENT)
---	----------------	---

## GENERAL TERMS AND CONDITIONS

**DEFINITIONS.** In these terms and conditions, "BJ-T" shall mean BJ-TITAN SERVICES COMPANY and "CUSTOMER" shall refer to the party identified by that term on the front of this contract. As applicable, "job" relates to the services described on the front-side of this contract; "merchandise" refers to the materials described on the front of this contract and to any other materials, products, or supplies used, sold, or furnished under the requirements of this contract.

**TERMS.** Unless satisfactory credit has been established, CUSTOMER must tender full cash payment to BJ-T before the job is undertaken or merchandise is delivered. If satisfactory credit has been established, the terms of payment for the job and/or merchandise, including bulk cement, are net cash, payable in 30 days from the completion of the job and/or delivery of the merchandise. For all past due invoices, CUSTOMER agrees to pay interest on amounts invoiced at a rate of 18% per annum until paid. Notwithstanding the foregoing, in no event shall this Contract provide for interest exceeding the maximum non-usurious rate of interest that CUSTOMER may agree to pay under applicable law. If any such interest should be provided for, it shall be and hereby is deemed to be a mistake, and this Contract shall be automatically reformed to lower the rate of interest to the maximum legal contract rate, any amounts previously paid as excess interest shall be deducted from the amounts owing from the CUSTOMER or, at the option of BJ-T, refunded directly to CUSTOMER. For purposes of this paragraph, BJ-T and CUSTOMER agree that Texas law shall apply. Any discounts granted in association with this contract are null and void if the charges are not paid when due.

**ATTORNEY FEES.** In any legal action or proceeding between the parties to enforce any of the terms of this Service Contract, or in any way pertaining to the terms of this Contract, the prevailing party shall be entitled to recover all expenses, including, but not limited to, a reasonable sum as and for attorney's fees.

**PRICES AND TAXES.** All merchandise listed in BJ-T's current price schedule are F.O.B. BJ-T's local station and are subject to change without notice. All prices are exclusive of any federal, state, local, or special taxes for the sale or use of the merchandise or services listed. The amount of taxes required to be paid by BJ-T shall be added to the quoted prices charged to CUSTOMER.

**TOWING CHARGES.** BJ-T will make a reasonable attempt to get to and from each job site using its own equipment. Should BJ-T be unable to do so because of poor or inadequate road conditions, and should it become necessary to employ a tractor or other pulling equipment to get to or from the job site, the tractor or pulling equipment will be supplied by CUSTOMER or, if furnished by BJ-T, will be charged to and paid for by CUSTOMER.

**PREPARATION CHARGES.** If a job and/or merchandise is ordered and CUSTOMER cancels the order after preparation of a chemical solution or other material, CUSTOMER will pay BJ-T for the expenses incurred by BJ-T as a result of the cancellation.

**DEAD HAUL CHARGES.** Unless otherwise specified on the front of this contract, a deadhaul charge as set forth in BJ-T's current price book will be charged each way for each service unit which is ordered by CUSTOMER but not used.

**SERVICE CONDITIONS AND LIABILITIES.** 1. BJ-T carries public liability and property damage insurance, but since there are so many uncertain and unknown conditions beyond BJ-T's control, BJ-T shall not be liable for injuries to property or persons or for loss or damage arising from the performance of the job or delivery or use of the merchandise. CUSTOMER shall be responsible for and indemnify, defend, and hold harmless BJ-T, its officers, agents, and employees from and against any and all claims or suits for:

- (a) damage to property or for bodily injury, sickness, disease, or death, brought by any person, including CUSTOMER and/or the well owner; and;
- (b) oil spills, pollution, surface or sub-surface damage, injury to the well, reservoir loss, or damage arising from a well blow out arising out of or in connection with BJ-T's performance of the job or furnishing of merchandise in accordance with this contract, unless such loss or damage is caused by the willful misconduct or gross negligence of BJ-T or its employees.

2. With respect to any of BJ-T's tools, equipment, or instruments which are lost in the well or damaged when performing or attempting to perform the job or, in the case of marine operations, are lost or damaged at any time after delivery to the landing for CUSTOMER and before return to BJ-T at the landing, CUSTOMER shall either recover the lost item without cost to BJ-T or reimburse BJ-T the current replacement cost of the item unless the loss or damage results from the sole negligence of BJ-T or its employees.

3. BJ-T does not assume any liability or responsibility for damages or conditions resulting from chemical action in cements caused by contamination of water or other fluids.

**WARRANTIES.** 1. BJ-T warrants all merchandise manufactured or furnished by it to be free from defects in material and workmanship under normal use and service when installed, used, and/or serviced in the manner provided and intended. BJ-T's obligation under this warranty is expressly limited to repair, replacement, or allowance for credit, as its option, for any merchandise which is determined by BJ-T to be defective. THIS IS THE SOLE WARRANTY OF BJ-T AND NO OTHER WARRANTY IS APPLICABLE, EITHER EXPRESS OR IMPLIED, IN FACT OR IN LAW, INCLUDING ANY WARRANTY AS TO MERCHANTABILITY OR FITNESS FOR A PARTICULAR USE OR PURPOSE. CUSTOMER's sole and only remedy with regard to any defective merchandise shall be the repair or replacement thereof or allowance for credit as herein provided, and BJ-T shall not be liable for any consequential, special, incidental, or punitive damages resulting from or caused by defective materials, products or supplies.

2. More specifically;

(a) Nothing in this contract shall be construed as a warranty by BJ-T of the success or the effectiveness of the result of any work done or merchandise used, sold, or furnished under this contract;

(b) Nothing in this contract shall be construed as a warranty of the accuracy or correctness of any facts, information, or data furnished by BJ-T or any interpretation of tests; meter readings, chart information, analysis of research, or recommendations made by BJ-T, unless the inaccuracy or incorrectness is caused by the willful misconduct or gross negligence of BJ-T or its employees in the preparation or furnishing of such facts, information or data;

(c) Work done by BJ-T shall be under the direct supervision and control of the CUSTOMER or his agent and BJ-T will accomplish the job as an independent contractor and not as an employee or agent of the CUSTOMER.



Operator Name PanCanadian Petroleum Company Lease Name Weller Well # 1

Sec. 6 Twp. 7S Rge. 22 East West County. Rocks

WELL LOG

INSTRUCTIONS: Show important tops and base of formations penetrated. Detail all cores. Report all drill stem tests giving interval tested, time tool open and closed, flowing and shut-in pressures, whether shut-in pressure reached static level, hydrostatic pressures, bottom hole temperature, fluid recovery, and flow rates if gas to surface during test. Attach extra sheet if more space is needed. Attach copy of log.

Drill Stem Tests Taken  Yes  No  
 Samples Sent to Geological Survey  Yes  No  
 Cores Taken  Yes  No

DST #1 Oread fm. 3316-3370'. 15-45-60-90 mins.  
 Bomb depth 3312'. IHP 1649.3, IFP 76.7-76.7, ISIP 915.5, FFP 122.4-462.6, FSI 906.2, FHP 1618.2.  
 Sampler - 2000 cc wtr, 72,000 ppm chl.

DST #2 Toronto fm. 3383-3432'. 15-45-60-90 mins.  
 IHP 1693, IFP 224-273, ISIP 968, FFP 302-574, FSIP 944, FHP 1552. Sampler - 20 cc gas, 1980 cc oil, 32°/60.

DST #3 LKC (B&D) 3445-3486'. 15-45-60-90. IHP 1680, IFP 107-93, ISIP 1192, FFP 157-166, FSIP 1113, FHP 1653. Sampler - 25 cc gas, 1075 cc oil, 32°/60.

DST #4 LKC (I&J) 3557-3591'. 15-45-60-90. IHP 1753, IFP 75-192, ISIP 781, FFP 242-463, FSIP 765, FHP 1664. Sampler - 20 cc gas, 1980 cc oil, 36°/60.

Name	Formation Description	
	Top	Bottom
Topeka	3180	3386
Heebner	3386	3409
Toronto	3409	3421
Lansing/Kansas C.	3421	3696
Conglomerate	3696	3663
Arbuckle	3663	TD 3750

CASING RECORD <input checked="" type="checkbox"/> New <input type="checkbox"/> Used							
Report all strings set-conductor, surface, intermediate, production, etc.							
Purpose of String	Size Hole Drilled	Size Casing Set (In O.D.)	Weight Lbs/Ft.	Setting Depth	Type of Cement	#Sacks Used	Type and Percent Additives
Surface	12 1/4	8 5/8"	24	311	A	200	3% CaCl 2% gel
Production	7 7/8	4 1/2"	10.5	3749.50	A	290	2% CaCl 1#/sx floccul
D.V. tool				1806	Thrifty	300	circ to surface

PERFORATION RECORD				Acid, Fracture, Shot, Cement Squeeze Record	
Shots Per Foot	Specify Footage of Each Interval Perforated		(Amount and Kind of Material Used)	Depth	
4	3662-3668		1000 gal 15% MCA, CIBP	3655	
4	3580-3588		1000 gal 15% MCA		
4	3565-3570		1250 gal 15% MCA		
4	3494-3498		1000 gal 15% MCA/100 sx Cl A	2% CaCl	
4	3450-3464		2000 gal 15% MCA		
4	3420-3428		No treatment		

TUBING RECORD			
Size	Set At	Packer at	
2 3/8	3652.98	None	

Date of First Production	Producing Method				
11/28/87	<input type="checkbox"/> Flowing <input checked="" type="checkbox"/> Pumping <input type="checkbox"/> Gas Lift <input type="checkbox"/> Other (explain).....				

Estimated Production Per 24 Hours	Oil		Gas		Water		Gas-Oil Ratio		Gravity
	Bbls		MCF		Bbls		CFPB		
	163		10		24		61		

METHOD OF COMPLETION Production Interval

Disposition of gas:  Vented  Open Hole  Perforation  
 Sold  Other (Specify) .....  
 Used on Lease  Dually Completed .....  
 Commingled .....

PLAT AND CERTIFICATION OF ACREAGE ATTRIBUTABLE TO AN OIL WELL

State Corporation Commission, Conservation Division  
200 Colorado Derby Bldg. Wichita, Kansas 67202

OPERATOR PanCanadian Petroleum Company

LOCATION OF WELL:

LEASE Waller

3630 feet from the south line

4290 feet from the east line

WELL NUMBER 12-6 #1

Of the SW/NW of Sec 6 T. 7S R. 20W

FIELD Wildcat

COUNTY Rooks

\*NUMBER OF ACRES  
ATTRIBUTABLE TO WELL 40

DESCRIPTION OF ACREAGE:

PLAT

(Show location of Well and outline attributable acreage)  
(Show footage to nearest lease or unit boundry line)

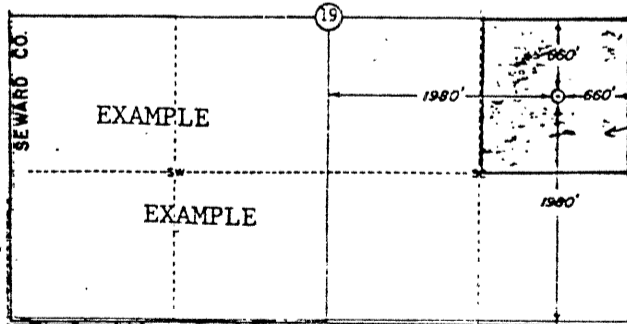
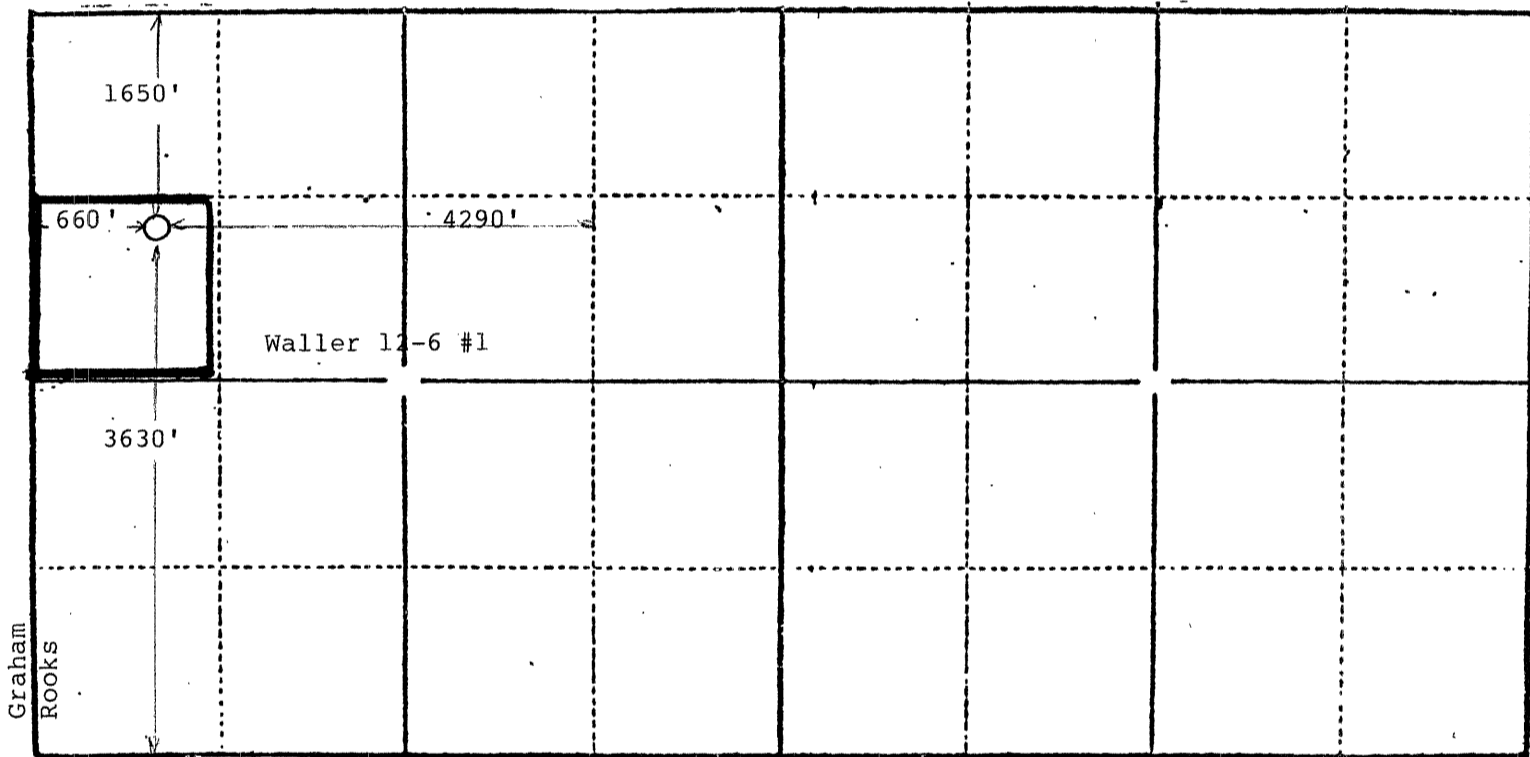

JAN 14 1988  
WICHITA BRANCH

The undersigned hereby certifies that he is Staff Engineer  
for PanCanadian Petroleum Company, a duly authorized agent, that all information  
shown hereon is true and correct to the best of his knowledge and belief, and that  
all acreage claimed as attributable to the well named herein is held by production  
from that well.

Loretta Moore

Suscribed and sworn to before me on this 7th day of December, 1987.

KANSAS GEOLOGICAL SURVEY  
WICHITA BRANCH

Thomas J. Ramsey  
Notary Public

My Commission expires 3/18/91

JAN 19 1988