

STATE CORPORATION COMMISSION OF KANSAS
OIL & GAS CONSERVATION DIVISION
WELL COMPLETION OR RECOMPLETION FORM
ACO-1 WELL HISTORY
DESCRIPTION OF WELL AND LEASE

API NO. 15-163-22970-00-00
County.....Rooks.....
SE NE NW 6 7S 20 East
..... Sec..... Twp..... Rge..... X West

Operator: License # 8000
Name PanCanadian Petroleum Company
Address P.O. Box 929
City/State/Zip Denver, CO 80201

4290 Ft North from Southeast Corner of Section
2970 Ft West from Southeast Corner of Section
(Note: Locate well in section plat below)

Purchaser Koch Oil

Lease Name Waller 21-6 Well # 2
Field Name Wildcat

Operator Contact Person J.D. Keisling
Phone (303) 825-8371

Producing Formation Lansing-Kansas City

Contractor: License # 5422
Name Abercrombie Drilling, Inc

Elevation: Ground 2218 KB 2223

Wellsite Geologist Dan Watterson
Phone (303) 825-8371

Designate Type of Completion
X New Well Re-Entry Workover

X Oil SWD Temp Abd
Gas Inj Delayed Comp.
X Dry Well Other (Core, Water Supply etc.)

If ONWO: old well info as follows:
Operator
Well Name
Comp. Date Old Total Depth

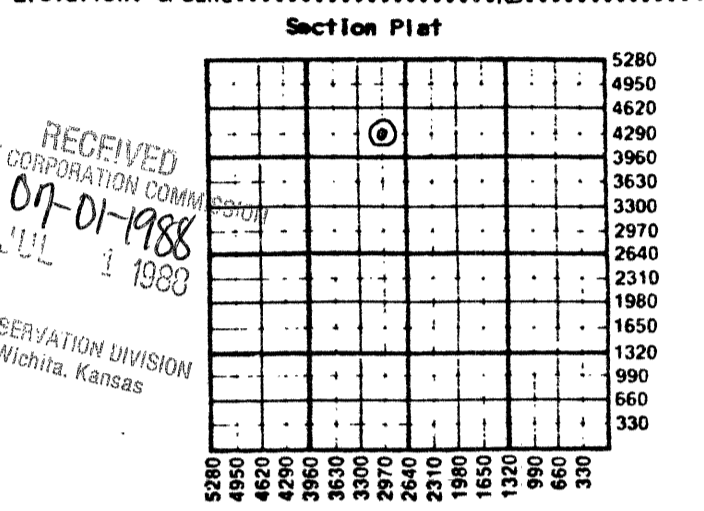

WATER SUPPLY INFORMATION
Disposition of Produced Water: X Disposal
Docket # Repressuring

Questions on this portion of the ACO-1 call:
Water Resources Board (913) 296-3717

Source of Water:
Division of Water Resources Permit #

X Groundwater 2970 Ft North from Southeast Corner
(Well) 3960 Ft West from Southeast Corner of
Sec Twp Rge East West

X Surface Water 2970 Ft North from Southeast Corner
(Stream, pond etc.) 3960 Ft West from Southeast Corner
Sec Twp Rge East West

Other (explain)
(purchased from city, R.W.D. #)

RECEIVED
STATE CORPORATION COMMISSION
07-01-1988
JUL 1 1988
CONSERVATION DIVISION
Wichita, Kansas

WELL HISTORY

Drilling Method:
X Mud Rotary Air Rotary Cable

12/1/87 12/09/87 1/4/88
Spud Date Date Reached TD Completion Date
3780' 3681' plugged 6-3-88
Total Depth PBDT

Amount of Surface Pipe Set and Cemented at 315 feet
Multiple Stage Cementing Collar Used? X Yes No
If yes, show depth set 1848' feet
If alternate 2 completion, cement circulated
from 3780 feet depth to 2902 w/ 195 SX cmt
Cement Company Name R.J. Titan
Invoice # 362745

INSTRUCTIONS: This form shall be completed in triplicate and filed with the Kansas Corporation Commission, 200 Colorado Derby Building, Wichita, Kansas 67202, within 120 days of the spud date of any well. Rule 82-3-130, 82-3-107 and 82-3-106 apply.
Information on side two of this form will be held confidential for a period of 12 months if requested in writing and submitted with the form. See rule 82-3-107 for confidentiality in excess of 12 months.
One copy of all wireline logs and drillers time log shall be attached with this form. Submit OP-4 form with all plugged wells. Submit CP-111 form with all temporarily abandoned wells.

All requirements of the statutes, rules and regulations promulgated to regulate the oil and gas industry have been fully complied with and the statements herein are complete and correct to the best of my knowledge.

Signature James D. Keisling
Coordinator, Eng. Opers. U.S. Date 6/24/88

Subscribed and sworn to before me this 24th day of June 1988
Notary Public Katherine J. Ramsey
Date Commission Expires March 19, 1991

K.C.C. OFFICE USE ONLY
F Letter of Confidentiality Attached
C Wireline Log Received
C Drillers Timelog Received
Distribution
X KCC SWD/Rep NGPA
X KGS Plug Other
(Specify)
7-1-88
Form ACO-1 (5-86)

Sec. 6, Twp. 7, Rge. 20 W

SIDE TWO

Operator Name PanCanadian Petroleum Company Lease Name Waller 21-6 Well # 2

Sec. 6 Twp. 7S Rge. 20 East West County Rooks

WELL LOG

INSTRUCTIONS: Show important tops and base of formations penetrated. Detail all cores. Report all drill stem tests giving interval tested, time tool open and closed, flowing and shut-in pressures, whether shut-in pressure reached static level, hydrostatic pressures, bottom hole temperature, fluid recovery, and flow rates if gas to surface during test. Attach extra sheet if more space is needed. Attach copy of log.

Drill Stem Tests Taken Yes No
 Samples Sent to Geological Survey Yes No
 Cores Taken Yes No

Formation Description
 Log Sample

DST #1 (3416-3463') Toronto - "A" Lansing-Kansas City 15-45-30-60. IHP 1666, IFP 62.2, FFP 62.2, ISIP 680, FSIP 639, FHP 1646. Sampler: 2980 cc mud, Chl 1200.

DST #2 (3475-3515') "B-D" Lansing-Kansas City 15-45-60-90. IHP 1692, IFP 62, ISIP 747, FFP 487, FHP 1609. Sampler: 3000 cc water, Chl 75,000, FSIP 727.

DST #3 (3589-3621') "I-J" Lansing-Kansas City 15-45-60-90. IHP 1786, IFP 20, ISIP 654, FFP 31, FSIP 622, FHP 1774. Sampler: 10 cc gas, 1500 cc oil, 400 cc mud, total 1900 cc.

DST #4 (3621-3649') "K-L" Lansing-Kansas City 15-45-60-90. IHP 1807, IFP 31, ISIP 591, FFP 51, FSIP 259, FHP 1765. Sampler: 2000 cc oil cut mud, 7% oil.

| Name | Top | Bottom |
|---------------------|--------------|--------------|
| Topeka | 3214 (-991) | 3422 (-1199) |
| Heebner | 3422 (-1199) | 3443 (-1220) |
| Toronto | 3443 (-1220) | 3455 (-1232) |
| Lansing-Kansas City | 3455 (-1232) | 3698 (-1475) |
| Stray Dolomite | 3698 (-1475) | 3646 (-1423) |
| Arbuckle | 3646 (-1423) | |

DST #5 (3647-3710') Arbuckle. 15-45-60-90. IHP 1869, IFP 41, ISIP 373, FFP 41, FSIP 186, FHP 1817. Sampler: Oil cut mud, 7% oil, Chl 4100.

| CASING RECORD <input type="checkbox"/> New <input type="checkbox"/> Used | | | | | | | |
|---|---|--|----------------|---|----------------|------------------|------------------------------|
| Report all strings set-conductor, surface, intermediate, production, etc. | | | | | | | |
| Purpose of String | Size Hole Drilled | Size Casing Set (in O.D.) | Weight Lbs/Ft. | Setting Depth | Type of Cement | #Sacks Used | Type and Percent Additives |
| Surface | 12 1/4" | 8 5/8" | 24 | 314.94 | common | 210 | 2% gel, 3% CaCl ₂ |
| Production | 7 7/8" | 4 1/2" | 10.5 | 3779.5 | A | 195 | 2% CaCl ₂ Floccel |
| PERFORATION RECORD | | | | Acid, Fracture, Shot, Cement Squeeze Record | | | |
| Shots Per Foot | Specify Footage of Each Interval Perforated | | | (Amount and Kind of Material Used) | | Depth | |
| 4 | 3634-3639' | | | 1250 gals 15% MCA | | | |
| 4 | 3617-3624' | | | 1500 gals 15% MCA | | | |
| 4 | 3602-3608' | | | 1500 gals 15% MCA | | | |
| 4 | 3582-3588' | | | 1500 gals 15% MCA | | | |
| 4 | 3454-3462' | | | 2000 gals 15% MCA cmt sqz 100 | | sx Cl A | |
| TUBING RECORD | | | | Liner Run <input type="checkbox"/> Yes <input checked="" type="checkbox"/> No | | | |
| Size | | Set At | | Packer at | | | |
| 2 3/8 | | 3672.71 | | | | | |
| Date of First Production | | Producing Method | | | | | |
| | | <input type="checkbox"/> Flowing <input checked="" type="checkbox"/> Pumping <input type="checkbox"/> Gas Lift <input type="checkbox"/> Other (explain)..... | | | | | |
| Estimated Production Per 24 Hours | | Oil | Gas | Water | Gas-Oil Ratio | Gravity | |
| → 15 Bbls | | tstm | MCF | 3 Bbls | CFPB | 36 deg 60 deg | |

METHOD OF COMPLETION

Production Interval

Disposition of gas: Vented Open Hole Perforation
 Sold Other (Specify)
 Used on Lease Dually Completed
 Commingled

BJ-TITAN SERVICES COMPANY

CUSTOMER COPY

DATE OF JOB
 MM DD YY
 06 10 88

CONTRACT NO. **362919**

15-163-22970-00-00

Well #1
 Services
 P.M.

| | | |
|--|---|--|
| DIRECT CORRESPONDENCE TO: P.O. BOX 4442 HOUSTON, TX 77210 | TERMS: NET 30 DAYS FROM DATE OF CONTRACT | REMIT TO: P.O. BOX 200416 HOUSTON, TX 77216 |
|--|---|--|

ORDER NO.

| CUSTOMER | | |
|--|----------------------|--------------------------|
| NAME <i>P. Canadian</i> | NO. | |
| ADDRESS <i>P.O. Box 929</i> | | |
| CITY <i>Dumas</i> | STATE <i>Okla</i> | ZIP CODE <i>80201</i> |
| AUTHORIZED BY <i>Mr. Gene Roberts</i> | | |

| DESCRIPTION OF WELL | | | |
|---|------------|----------------------------|------------------------|
| WELL NO. <i>#2</i> | OIL GAS | NEW OLD | STATE <i>Kansas</i> |
| LEASE NAME <i>Wallace</i> | | COUNTY/PARISH <i>51</i> | |
| FIELD NAME | | CITY | |
| OWNER <i>P. Canadian</i> | | MTA DISTRICT | |
| LEASE LINES | | | |
| SURVEY LINES <i>DRIVERS - Dumas, Okla</i> | | | |
| SURVEY <i>TRUCKS - #32 #B27</i> | | | |
| DIRECTIONS TO LOCATION <i>6N-11W-42S-42W - Dumas, Kansas</i> | | | |
| SECTION, TOWNSHIP, RANGE | | | |
| QUADRANT <i>CONTRACTOR: Also signed.</i> | | | |

| JOB INFORMATION | | ROUND TRIP MILES | |
|-------------------------|---------------------------------------|---------------------------------|---------------------------|
| ARRIVED | | RELEASED | |
| HH MM (A) MM DD YY | HH MM (A) MM DD YY | HH MM (A) MM DD YY | HH MM (A) MM DD YY |
| <i>7:30 P 06 04 88</i> | <i>11:15 P 06 04 88</i> | | |
| JOB CODE <i>0115</i> | TYPE OF JOB <i>Plug To Abandon</i> | API OR IC NO. | |
| AVG. PSI <i>200</i> | BUSINESS CODE | INJ. RATE (BPM) <i>3-150</i> | WORKING WELL DEPTH FT. |

| | | |
|--------------------------|-------------------------------------|----------------------------------|
| DIST. NO. <i>3370</i> | DISTRICT NAME <i>Hays Kansas</i> | SLSMAN NO. <i>515-68-7834</i> |
|--------------------------|-------------------------------------|----------------------------------|

CONTRACT CONDITIONS

This contract must be signed before the job is started or merchandise delivered. The undersigned is authorized to execute this contract as an Agent of the Customer. As such, the undersigned acknowledges that this contract for services, materials, products and/or supplies includes all of and only those terms and conditions appearing on the front and back of this document. No additional substitute terms and/or conditions shall become a part of this contract without the written consent of an Officer of BJ-TITAN SERVICES COMPANY.

SIGNED: *x Gene Roberts*
 (WELL OWNER: OPERATOR, CONTRACTOR OR AGENT)

| PRICE BOOK REF. NO. | SERVICES/MATERIAL | U/M | QUANTITY | PRICE | EXTENSION |
|---------------------|----------------------|-----|----------|----------|-----------|
| 01 1.0.1.9.0.2.0 | Pump. of Job | E | 1 | \$350.00 | \$350.00 |
| 02 1.0.1.0.9.0.0.5 | Pump Truck Mileage | M | 64 (RT) | \$1.10 | \$70.40 |
| 03 1.0.4.1.0.5.0.4 | Cement (Class "A") | SK | 130 | \$5.30 | \$689.00 |
| 04 1.0.4.1.5.0.1.8 | Permit (Type "F") | SK | 70 | \$2.61 | \$182.70 |
| 05 1.0.4.2.0.1.6.5 | Gel | CWT | 1740# | \$6.75 | \$117.45 |
| 06 1.0.4.2.1.0.0.5 | A-2 | Lb. | 348# | \$1.00 | \$348.00 |
| 07 1.0.8.8.0.0.9.5 | Handling and Dumping | SK | 200 | \$0.95 | \$190.00 |
| 08 1.0.9.4.0.1.0.1 | Mileage | Tm | 9.7 Ton | \$0.070 | \$217.20 |
| 09 | SUBTOTAL: | | | | \$2147.73 |
| 10 | DISCOUNT: | | | | \$432.97 |
| 11 | TOTAL: | | | | \$1731.76 |
| 12 | <i>Thank You</i> | | | | |
| 13 | | | | | |
| 14 | | | | | |
| 15 | | | | | |
| 16 | | | | | |

| | | |
|--|------------------------|---|
| SERVICE REPRESENTATIVE <i>Daniel Keener</i> | PR. BOOK <i>#07</i> | The above material and service ordered by the Customer and received by: <i>x Gene Roberts</i> (WELL OWNER, OPERATOR, CONTRACTOR OR AGENT) |
|--|------------------------|---|

BJ-TITAN SERVICES

P.O. BOX 4442 HOUSTON, TX 77210

CEMENTING LOG

STAGE NO.

15-163-22970-00-00

DATE 6-4-88 DISTRICT HAYS TICKET NO. 362914
 COMPANY Pine Commercial RIG ✓
 LEASE W. Huber WELL NO. #2
 COUNTY _____ STATE Kenn. 000
 LOCATION 601-1W 15-11W Demoss FIELD _____

CASING DATA: PTA Squeeze
 Surface Intermediate Production Liner
 Size 8 5/8" Type J55 Weight 24" Collar _____

Casing Depths. Top SURFACE Bottom _____

Drill Pipe. Size ✓ Weight ✓ Collars _____
 Open Hole: Size _____ T.D. _____ ft. P.B to _____ ft

CAPACITY FACTORS

Casing Bbbls/Lin. ft. 0.624 Lin. ft/Bbl. 15.7
 Open Holes Bbbls/Lin. ft. 0.602 Lin. ft/Bbl. 20.27
 Drill Pipe Bbbls/Lin. ft. ✓ Lin. ft/Bbl. ✓
 Annulus Bbbls/Lin. ft. _____ Lin. ft/Bbl. _____
 Bbbls/Lin. ft. _____ Lin. ft/Bbl. _____
 Perforations. From _____ ft. to _____ ft Amt _____

CEMENT DATA:

Spacer Type: _____
 Amt. _____ Sks Yield _____ ft³/sk Density _____ PPG _____
 LEAD: Pump Time _____ hrs. Type _____
 Excess _____
 Amt. _____ Sks Yield _____ ft³/sk Density _____ PPG _____
 TAIL: Pump Time _____ hrs. Type _____
 Excess _____
 Amt. _____ Sks Yield _____ ft³/sk Density _____ PPG _____
 WATER: Lead _____ gals/sk Tail _____ gals/sk Total _____ Bbbls _____
 Pump Trucks Used #32 DEON
 Bulk Equip. #B27 Carl
 Float Equip Manufacturer WALSH USA
 Shoe. Type ✓ Depth _____
 Float Type ✓ Depth _____
 Centralizers Quantity _____ Plugs Top _____ Btm. _____
 Stage Collars _____
 Special Equip. _____
 Disp. Fluid Type _____ Amt _____ Bbbls. Weight _____ PPG _____
 Mud Type _____ Weight _____ PPG _____

COMPANY REPRESENTATIVE Liam Roberts

CEMENTER Dan Korman

| TIME | PRESSURES PSI | | FLUID PUMPED DATA | | | REMARKS |
|------|---------------|-------------------|-------------------|-------------|------------------------|--|
| | AM/PM | DRILL PIPE CASING | ANNULUS | TOTAL FLUID | Pumped Per Time Period | |
| | | | | | | <u>PLUGGING ORDERS</u> |
| | | | | | | <u>Pumped 200 sks thickly thru 8 5/8" casing Max pressure was 250 psi.</u> |
| | | | | | | <u>Shut in at 150 psi</u> |
| | | | | | | <u>Plug down at 11:15 AM</u> |
| | | | | | | <u>Thanks</u> |

FINAL DISP. PRESS: _____ PSI BUMP PLUG TO _____ PSI BLEEDBACK _____ BBLs THANK YOU