

RECEIVED

NOV 23 2005

Form C-1  
December 2002

For KCC Use:  
Effective Date: 12-4-05  
District #: 4  
SGA?  Yes  No

KANSAS CORPORATION COMMISSION  
OIL & GAS CONSERVATION DIVISION

NOTICE OF INTENT TO DRILL KCC WICHITA

Form must be Typed  
Form must be Signed  
All blanks must be Filled

Must be approved by KCC five (5) days prior to commencing well

Expected Spud Date December 1 2005  
month day year

Spot 205'S & 160'W of  
SW SW SE Sec. 11 Twp. 14 S. R. 21W  East  
 West  
125 feet from  N /  S Line of Section  
2470 feet from  E /  W Line of Section

OPERATOR: License# 30717  
Name: DOWNING-NELSON OIL CO., INC.  
Address: P.O. Box 372  
City/State/Zip: Hays, KS 67601  
Contact Person: Ron Nelson  
Phone: (785) 621-2610

Is SECTION  Regular  Irregular?  
(Note: Locate well on the Section Plat on reverse side)  
County: Trego  
Lease Name: Erleka Unit Well #: 1-11  
Field Name: Wildcat

CONTRACTOR: License# 31548  
Name: Discovery Drilling

Is this a Prorated / Spaced Field?  Yes  No  
Target Information(s): LKC & Cherokee  
Nearest Lease or unit boundary: 125'

Well Drilled For: Well Class: Type Equipment:  
 Oil  Enh Rec  Infield  Mud Rotary  
 Gas  Storage  Pool Ext.  Air Rotary  
 OWWO  Disposal  Wildcat  Cable  
 Seismic; # of Holes  Other  
 Other

Ground Surface Elevation: 2231 feet MSL

If OWWO: old well information as follows:  
Operator: \_\_\_\_\_  
Well Name: \_\_\_\_\_  
Original Completion Date: \_\_\_\_\_ Original Total Depth: \_\_\_\_\_

Water well within one-quarter mile:  Yes  No

Directional, Deviated or Horizontal wellbore?  Yes  No

Public water supply well within one mile:  Yes  No

If Yes, true vertical depth: \_\_\_\_\_

Depth to bottom of fresh water: 150'

Bottom Hole Location: \_\_\_\_\_

Depth to bottom of usable water: 900' 850'

KCC DKT #: \_\_\_\_\_

Surface Pipe by Alternate:  1  2

Length of Surface Pipe Planned to be set: 200' +

Length of Conductor Pipe required: None

Projected Total Depth: 4150'

Formation at Total Depth: ar buckle

Water Source for Drilling Operations:  
 Well  Farm Pond  Other \_\_\_\_\_

DWR Permit #: \_\_\_\_\_

(Note: Apply for Permit with DWR )

Will Cores be taken?  Yes  No

If Yes, proposed zone: \_\_\_\_\_

**\*UNIT INFO ATT.**

AFFIDAVIT

The undersigned hereby affirms that the drilling, completion and eventual plugging of this well will comply with K.S.A. 55 et. seq.

It is agreed that the following minimum requirements will be met:

1. Notify the appropriate district office **prior** to spudding of well;
2. A copy of the approved notice of intent to drill **shall be** posted on each drilling rig;
3. The minimum amount of surface pipe as specified below **shall be set** by circulating cement to the top; in all cases surface pipe **shall be set** through all unconsolidated materials plus a minimum of 20 feet into the underlying formation.
4. If the well is dry hole, an agreement between the operator and the district office on plug length and placement is necessary **prior to plugging**;
5. The appropriate district office will be notified before well is either plugged or production casing is cemented in;
6. If an ALTERNATE II COMPLETION, production pipe shall be cemented from below any usable water to surface within **120 days** of spud date.  
Or pursuant to Appendix "B" - Eastern Kansas surface casing order #133,891-C, which applies to the KCC District 3 area, alternate II cementing must be completed within 30 days of the spud date or the well shall be plugged. **In all cases, NOTIFY district office** prior to any cementing.

I hereby certify that the statements made herein are true and to the best of my knowledge and belief.

Date: 18 Nov 2005 Signature of Operator or Agent: [Signature] Title: Agent

For KCC Use ONLY  
API # 15 - 195-22316-0000  
Conductor pipe required NONE feet  
Minimum surface pipe required 200 feet per Alt. → 2  
Approved by: [Signature] 11-29-05  
This authorization expires: 5-29-06  
(This authorization void if drilling not started within 6 months of effective date.)  
Spud date: \_\_\_\_\_ Agent: \_\_\_\_\_

Remember to:  
- File Drill Pit Application (form CDP-1) with Intent to Drill;  
- File Completion Form ACO-1 within 120 days of spud date;  
- File acreage attribution plat according to field proration orders;  
- Notify appropriate district office 48 hours prior to workover or re-entry;  
- Submit plugging report (CP-4) after plugging is completed;  
- Obtain written approval before disposing or injecting salt water.  
- If this permit has expired (See: authorized expiration date) please check the box below and return to the address below.  
 Well Not Drilled - Permit Expired  
Signature of Operator or Agent: \_\_\_\_\_  
Date: \_\_\_\_\_

11  
14  
26W

**IN ALL CASES PLOT THE INTENDED WELL ON THE PLAT BELOW**

*Plat of acreage attributable to a well in a prorated or spaced field*

**If the intended well is in a prorated or spaced field, please fully complete this side of the form.** If the intended well is in a prorated or spaced field complete the plat below showing that the well will be properly located in relationship to other wells producing from the common source of supply. Please show all the wells and within 1 mile of the boundaries of the proposed acreage attribution unit for gas wells and within 1/2 mile of the boundaries of the proposed acreage attribution unit for oil wells.

API No. 15 - \_\_\_\_\_  
 Operator: DOWNING-NELSON OIL CO., INC.  
 Lease: ERLEKA UNIT  
 Well Number: 1-11  
 Field: Wildcat  
 Number of Acres attributable to well: \_\_\_\_\_  
 QTR / QTR / QTR of acreage: \_\_\_\_\_ - \_\_\_\_\_ - \_\_\_\_\_

Location of Well: County: Trego  
 \_\_\_\_\_ feet from  N /  S Line of Section  
125  
 \_\_\_\_\_ feet from  E /  W Line of Section  
2470  
 Sec. 11 Twp. 14S S. R. 21W  East  West

Is Section:  Regular or  Irregular

**If Section is Irregular, locate well from nearest corner boundary.**

Section corner used:  NE  NW  SE  SW

**PLAT**

*(Show location of the well and shade attributable acreage for prorated or spaced wells.)*

*(Show footage to the nearest lease or unit boundary line.)*

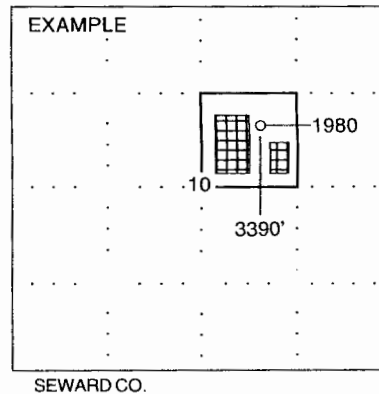
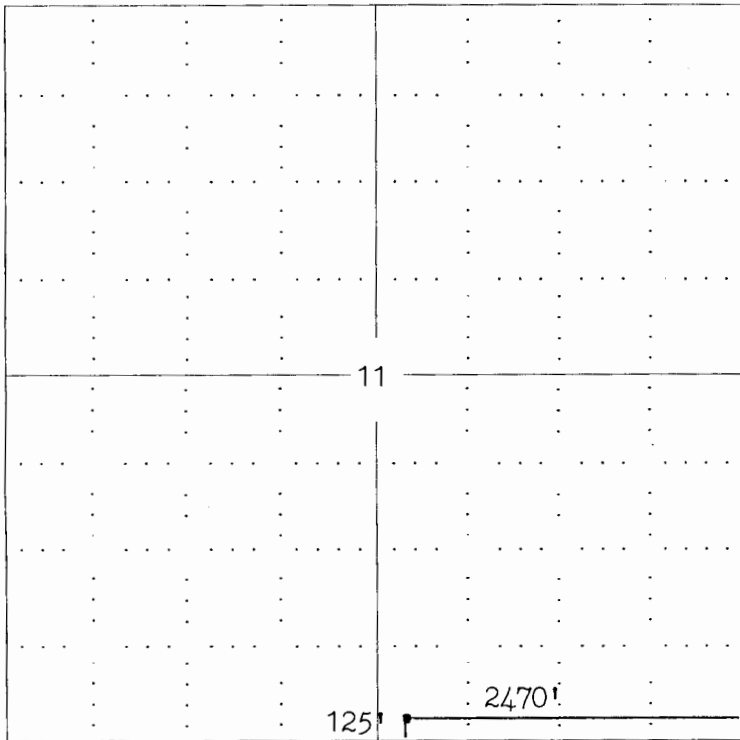

**NOTE: In all cases locate the spot of the proposed drilling location.**

Trego Co., KS

**In plotting the proposed location of the well, you must show:**

1. The manner in which you are using the depicted plat by identifying section lines, i.e. 1 section, 1 section with 8 surrounding sections, 4 sections, etc.
2. The distance of the proposed drilling location from the section's south / north and east / west.
3. The distance to the nearest lease or unit boundary line.
4. If proposed location is located within a prorated or spaced field a certificate of acreage attribution plat must be attached: (CO-7 for oil wells; CG-8 for gas wells).