

STATE CORPORATION COMMISSION OF KANSAS
OIL & GAS CONSERVATION DIVISION
WELL COMPLETION OR RECOMPLETION FORM
ACO-1 WELL HISTORY
DESCRIPTION OF WELL AND LEASE

API NO. 15-163-22,998-00:00
County.....Rooks
40' E of
NW NE NE Sec. 15. Twp. 7S. Rge. 20W. XX East
..... West

Operator: License # 4767
Name Ritchie Exploration, Inc.
Address 125 N. Market, Suite 1000
Wichita, KS 67202
City/State/Zip

..... 4950 Ft North from Southeast Corner of Section
..... 950 Ft West from Southeast Corner of Section
(Note: Locate well in section plat below)

Purchaser.....N/A

Lease Name.....Sammons.....Well #1

Operator Contact Person Jeff Christian
Phone 316/267-4375

Field Name.....

Producing Formation.....N/A

Elevation: Ground.....2063'.....KB.....2068'

Contractor: License # 6033
Name Murfin Drilling Co.
Wellsite Geologist Bob Mathiesen
Phone 316/267-4375

PLEASE KEEP THIS
INFORMATION
CONFIDENTIAL

Designate Type of Completion
 New Well Re-Entry Workover
 Oil SWD Temp Abd
 Gas Inj Delayed Comp
 Dry Other (Core, Water Supply etc.)

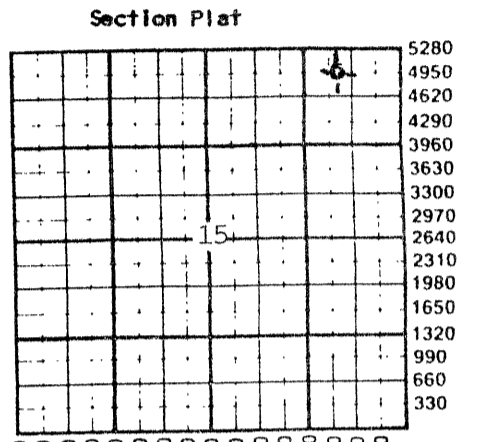

If ONWO: old well info as follows:
Operator
Well Name
Comp. Date Old Total Depth

WATER SUPPLY INFORMATION
Disposition of Produced Water: _____ Disposal
Docket #N/A..... Repressuring

WELL HISTORY

Drilling Method:
 Mud Rotary Air Rotary Cable
5/15/88 5/23/88 5/23/88
Spud Date Date Reached TD Completion Date
3568' n/a
Total Depth PBTD
Amount of Surface Pipe Set and Cemented at.....feet
Multiple Stage Cementing Collar Used? Yes No
If yes, show depth set.....feet
If alternate 2 completion, cement circulated
from.....feet depth to.....w/.....SX cmt
Cement Company Name
Invoice #
at D Ora

Questions on this portion of the ACO-1 call:
Water Resources Board (913) 296-3717
Source of Water: Pumped.
Division of Water Resources Permit #.....
Groundwater.....Ft North from Southeast Corner
(Well)Ft West from Southeast Corner of
Sec Twp Rge East West
Surface Water.....Ft North from Southeast Corner
(Stream, pond etc).....Ft West from Southeast Corner
Sec Twp Rge East West
Other (explain).....
(purchased from city, R.W.D. #)

INSTRUCTIONS: This form shall be completed in triplicate and filed with the Kansas Corporation Commission, 200 Colorado Derby Building, Wichita, Kansas 67202, within 120 days of the spud date of any well. Rule 82-3-130, 82-3-107 and 82-3-106 apply. Information on side two of this form will be held confidential for a period of 12 months if requested in writing and submitted with the form. See rule 82-3-107 for confidentiality in excess of 12 months. One copy of all wireline logs and drillers time log shall be attached with this form. Submit CP-4 form with all plugged wells. Submit CP-111 form with all temporarily abandoned wells.

All requirements of the statutes, rules and regulations promulgated to regulate the oil and gas industry have been fully complied with and the statements herein are complete and correct to the best of my knowledge.

Signature [Signature]
Title Vice President Date 9/14/88

Subscribed and sworn to before me this 14th day of September 1988
Notary Public Linda K. Rice
Date Commission Expires 6-7-92

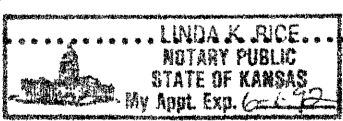

K.C.C. OFFICE USE ONLY
 Letter of Confidentiality Attached
 Wireline Log Received
 Drillers Time Log Received
Distribution
 KCC SWD/Rep NGPA
 KGS Plug Other
(Specify)
9-15-88
Form ACO-1 (5-86)

Sec 15 Twp 7S Rge 20W

Operator Name Ritchie Exploration, Inc. Lease Name Sammons Well # 1

Sec. 15 Twp. 7S Rge. 20W East West County Rooks RELEASED

MAR 06 1990 3-6-90

WELL LOG

INSTRUCTIONS: Show important tops and base of formations penetrated. Detail all cores. Report all stem tests giving interval tested, time tool open and closed, flowing and shut-in pressures, whether shut-in pressure reached static level, hydrostatic pressures, bottom hole temperature, fluid recovery, and flow rates if gas to surface during test. Attach extra sheet if more space is needed. Attach copy of log.

FROM CONFIDENTIAL

Drill Stem Tests Taken [X] Yes [] No
Samples Sent to Geological Survey [X] Yes [] No
Cores Taken [] Yes [X] No

Formation Description [X] Log [] Sample

DST #1 3230'-3295' (Toronto-Top zone). Rec. 92' of slightly oil cut mud and 62' of very slightly oil cut watery mud. IFP:54-87#/45"; ISIP:1039#/60"; FFP:98-120#/45"; FSIP:1017#/60".

Table with 3 columns: Name, Top, Bottom. Rows include Anhydrite, B/Anhydrite, Topeka, Heebner, Toronto, Lansing, B/KC, Arbuckle, LTD.

DST #2 3298'-3343' (35'-50' zones). Rec. 3' oil, 62' slightly oil and water cut mud (3% oil, 3% water, 94% mud). IFP:43-65#/45"; ISIP:996#/60"; FFP:76-87#/45"; FSIP:963#/60".

DST #3 3339'-3364' (70' & 90' zones). Rec. 268' muddy water w/ trace of oil. IFP:43-98#/30"; ISIP:985#/45"; FFP:120-152#/30"; FSIP:974#/45".

DST #5 3519'-3548' (Arbuckle). Rec. 25' of oil cut mud (10% oil, 90% mud). IFP:33-33#/30"; ISIP:608#/30"; FFP:33-33#/30"; FSIP:543#/30".

DST #4 3388'-3454' (140', 160' & 180' zones). Rec. 30' of mud w/oil spots on top. IFP:54-65#/30"; ISIP:1114#/30"; FFP:55-65#/30"; FSIP:996#/30".

PLEASE KEEP THIS INFORMATION CONFIDENTIAL

Form sections: CASING RECORD, PERFORATION RECORD, TUBING RECORD, Date of First Production, Producing Method, Estimated Production Per 24 Hours.

METHOD OF COMPLETION

Production Interval

Disposition of gas: [] Vented [] Open Hole [] Perforation [] Sold [] Other (Specify) [] Used on Lease [] Dually Completed [] Commingled