

-CORRECTED-

CORRECTED RECEIVED

For KCC Use:
Effective Date: 10-30-05
District #: 4
SGA? Yes No

KANSAS CORPORATION COMMISSION
OIL & GAS CONSERVATION DIVISION

OCT 28 2005

Form C-1
September 1999
Form must be Typed
Form must be Signed
Fees must be Filled

NOTICE OF INTENT TO DRILL

Must be approved by KCC five (5) days prior to commencing well

KCC WICHITA

Expected Spud Date November 05, 2005
month day year Approx.

Spot 20' S & 25' W
NE NE SW Sec. 21 Twp. 7- S. R. 35- East West

OPERATOR: License# 33486
Name: Dark Horse Oil Company, LLC.
Address: 34861 Forest Park Drive
City/State/Zip: Elizabeth, CO 80107-7879
Contact Person: Douglas C. Frickey
Phone: 303-646-5156

2290 feet from S / N (circle one) Line of Section
2285 feet from E / W (circle one) Line of Section
Is SECTION Regular Irregular?

CONTRACTOR: License# 30606
Name: Murfin Drilling Company, Inc.

(Note: Locate well on the Section Plat on reverse side)
County: Thomas
Lease Name: Bellamy Well #: 1-21
Field Name: Wildcat

Well Drilled For: Well Class: Type Equipment:
 Oil Enh Rec Infield Mud Rotary
 Gas Storage Pool Ext. Air Rotary
 OWWO Disposal Wildcat Cable
 Seismic; # of Holes Other
 Other

Is this a Prorated / Spaced Field? Yes No
Target Formation(s): Lansing/Kansas City, Johnson Zone & Cherokee
Nearest Lease or unit boundary: 350 feet

Ground Surface Elevation: 3299 feet MSL
Water well within one-quarter mile: Yes No
Public water supply well within one mile: Yes No

Depth to bottom of fresh water: 250 feet 275
Depth to bottom of usable water: 250 feet 275

Surface Pipe by Alternate: X 1 2
Length of Surface Pipe Planned to be set: 300 feet minimum 325' Min.

Length of Conductor Pipe required: _____
Projected Total Depth: 5000 feet
Formation at Total Depth: Mississippian

Water Source for Drilling Operations:
Well _____ Farm Pond _____ Other X
DWR Permit #: _____

(Note: Apply for Permit with DWR)
Will Cores be taken? Yes No
If Yes, proposed zone: _____

If OWWO: old well information as follows:
Operator: _____
Well Name: _____
Original Completion Date: _____ Original Total Depth: _____

Directional, Deviated or Horizontal wellbore? Yes No

If Yes, true vertical depth: _____

Bottom Hole Location: _____

KCC DKT #: _____

X WAS: 2310' ESL, 2310' FWL

IS: 2290' FSL, 2285' FWL

AFFIDAVIT

The undersigned hereby affirms that the drilling, completion and eventual plugging of this well will comply with K.S.A. 55-101, et. seq.

It is agreed that the following minimum requirements will be met:

1. Notify the appropriate district office **prior** to spudding of well;
2. A copy of the approved notice of intent to drill **shall be posted** on each drilling rig;
3. The minimum amount of surface pipe as specified below **shall be set** by circulating cement to the top; in all cases surface pipe **shall be set** through all unconsolidated materials plus a minimum of 20 feet into the underlying formation.
4. If the well is dry hole, an agreement between the operator and the district office on plug length and placement is necessary **prior to plugging**;
5. The appropriate district office will be notified before well is either plugged or production casing is cemented in;
6. If an ALTERNATE II COMPLETION, production pipe shall be cemented from below any usable water to surface within **120 days** of spud date. **In all cases, NOTIFY district office** prior to any cementing.

I hereby certify that the statements made herein are true and to the best of my knowledge and belief.

Date: October 26, 2005 Signature of Operator or Agent: _____ Title: President

For KCC Use ONLY
API # 15 - 193-20707-00-00
Conductor pipe required NONE feet
Minimum surface pipe required 325 feet per Alt. 1
Approved by: RSP 10-25-05 / RSP 12-22-05
This authorization expires: 4-25-06
(This authorization void if drilling not started within 6 months of effective date.)
Spud date: _____ Agent: _____

Remember to:

- File Drill Pit Application (form CDP-1) with Intent to Drill;
- File Completion Form ACO-1 within 120 days of spud date;
- File acreage attribution plat according to field prorations orders;
- Notify appropriate district office 48 hours prior to workover or re-entry;
- Submit plugging report (CP-4) after plugging is completed;
- Obtain written approval before disposing or injecting salt water.

21
7
35W

RECEIVED

OCT 28 2005

KCC WICHITA

IN ALL CASES PLOT THE INTENDED WELL ON THE PLAT BELOW

Plat of acreage attributable to a well in a prorated or spaced field

If the intended well is in a prorated or spaced field, please fully complete this side of the form. If the intended well is in a prorated or spaced field complete the plat below showing that the well will be properly located in relationship to other wells producing from the common source of supply. Please show all the wells and within 1 mile of the boundaries of the proposed acreage attribution unit for gas wells and within 1/2 mile of the boundaries of the proposed acreage attribution unit for oil wells.

API No. 15 - _____
Operator: Dark Horse Oil Company, LLC.
Lease: Bellamy
Well Number: 1-21
Field: Wildcat

Number of Acres attributable to well: _____
QTR / QTR / QTR of acreage: NE - NE - SW

Location of Well: County: Thomas
2290 feet from (S) / N (circle one) Line of Section
2285 feet from E (W) (circle one) Line of Section
Sec. 21 Twp. 7- S. R. 35- East West

Is Section Regular or Irregular

If Section is Irregular, locate well from nearest corner boundary.
Section corner used: NE NW SE SW

PLAT

*(Show location of the well and shade attributable acreage for prorated or spaced wells.)
(Show footage to the nearest lease or unit boundary line.)*

T-7-S

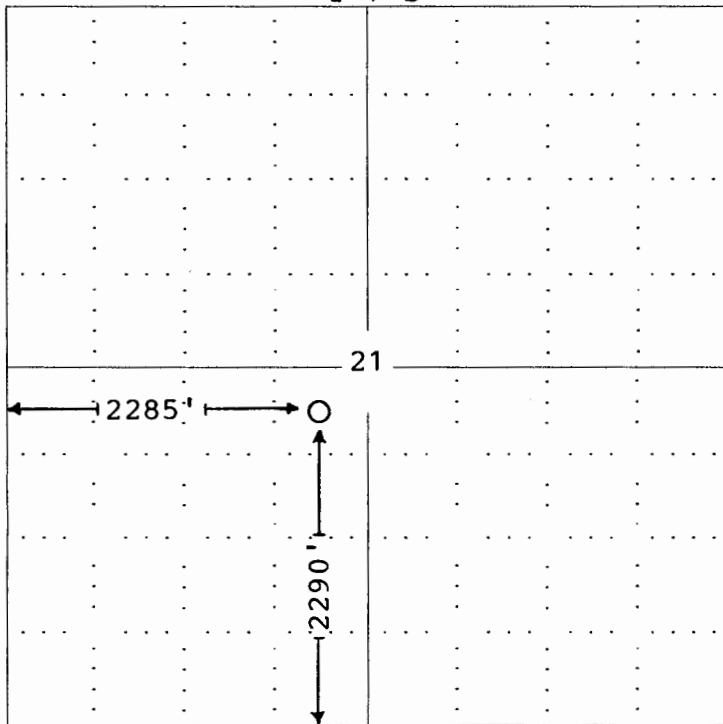

R-35-W

CORRECTED

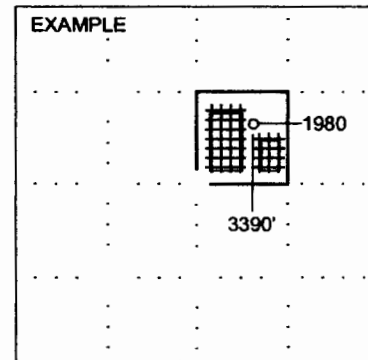

SEWARD CO.

NOTE: In all cases locate the spot of the proposed drilling location.

In plotting the proposed location of the well, you must show:

1. The manner in which you are using the depicted plat by identifying section lines, i.e. 1 section, 1 section with 8 surrounding sections, 4 sections, etc.
2. The distance of the proposed drilling location from the section's south / north and east / west.
3. The distance to the nearest lease or unit boundary line.
4. If proposed location is located within a prorated or spaced field a certificate of acreage attribution plat must be attached: (CO-7 for oil wells; CG-8 for gas wells).