

For KCC Use:
Effective Date: 9-25-05
District #: 3
SGA? Yes No

KANSAS CORPORATION COMMISSION
OIL & GAS CONSERVATION DIVISION

Form C-1
December 2002
Form must be Typed
Form must be Signed
All blanks must be Filled

NOTICE OF INTENT TO DRILL

Must be approved by KCC five (5) days prior to commencing well

Expected Spud Date 9 25 2005
month day year

Spot
Apex E/2. NW NW Sec. 17 Twp. 16 S. R. 25 East West
520 feet from N / S Line of Section
1200 feet from E / W Line of Section
Is SECTION Regular Irregular?

OPERATOR: License# 32294
Name: Osborn Energy, L.L.C.
Address: 24850 Farley
City/State/Zip: Bucyrus, KS 66013
Contact Person: Jeff Taylor
Phone: 913-533-9900

(Note: Locate well on the Section Plat on reverse side)

County: Miami
Lease Name: Mullinix Well #: 3A-17-16-25

CONTRACTOR: License# 5885
Name: Susie Glaze dba Glaze Drilling, Co.

Field Name: Louisburg

Well Drilled For: Well Class: Type Equipment:
 Oil Enh Rec Infield Mud Rotary
 Gas Storage Pool Ext. Air Rotary
 OAWD Disposal Wildcat Cable
 Seismic; # of Holes Other
 Other

Is this a Prorated / Spaced Field? Yes No

Target Formation(s): Marmaton & Cherokee Coals

Nearest Lease or unit boundary: 520'

Ground Surface Elevation: 1066 (Est. from Topo) feet MSL

Water well within one-quarter mile: Yes No

Public water supply well within one mile: Yes No

Depth to bottom of fresh water: 150' +/-

Depth to bottom of usable water: 225' +/-

Surface Pipe by Alternate: 1 2

Length of Surface Pipe Planned to be set: 20'

Length of Conductor Pipe required: None

Projected Total Depth: 700' +/-

Formation at Total Depth: Cherokee

Water Source for Drilling Operations:
 Well Farm Pond Other

DWR Permit #: _____

(Note: Apply for Permit with DWR

Will Cores be taken? Yes No

If Yes, proposed zone: _____

If OWWO: old well information as follows:
Operator: _____
Well Name: _____
Original Completion Date: _____ Original Total Depth: _____
Directional, Deviated or Horizontal wellbore? Yes No
If Yes, true vertical depth: _____
Bottom Hole Location: _____
KCC DKT #: _____

API 15-121-28111-00-00

AFFIDAVIT

The undersigned hereby affirms that the drilling, completion and eventual plugging of this well will comply with K.S.A. 55 et. seq.

It is agreed that the following minimum requirements will be met:

1. Notify the appropriate district office prior to spudding of well;
2. A copy of the approved notice of intent to drill shall be posted on each drilling rig: IS: 520' FNL, 1200' FWL, XWAS: 485' FNL, 1175' FWL
3. The minimum amount of surface pipe as specified below shall be set by circulating cement to the top; in all cases surface pipe shall be set through all unconsolidated materials plus a minimum of 20 feet into the underlying formation.
4. If the well is dry hole, an agreement between the operator and the district office on plug length and placement is necessary prior to plugging;
5. The appropriate district office will be notified before well is either plugged or production casing is cemented in;
6. If an ALTERNATE II COMPLETION, production pipe shall be cemented from below any usable water to surface within 120 days of spud date. Or pursuant to Appendix "B" - Eastern Kansas surface casing order #133,891-C, which applies to the KCC District 3 area, alternate II cementing must be completed within 30 days of the spud date or the well shall be plugged. In all cases, NOTIFY district office prior to any cementing.

I hereby certify that the statements made herein are true and to the best of my knowledge and belief.

Date: 10/05/05 Signature of Operator or Agent: [Signature] Title: _____

For KCC Use ONLY
API # 15 - 121-28111-00-00
Conductor pipe required NONE foot
Minimum surface pipe required 20 feet per Alt. # 2
Approved by: RJP 9-20-05 / RJP 12-22-05
This authorization expires: 3-20-06
(This authorization void if drilling not started within 6 months of approval date.)
Spud date: _____ Agent: _____

Remember to:

- File Drill Pit Application (form GDP-1) with Intent to Drill;
 - File Completion Form ACO-1 within 120 days of spud date;
 - File acreage attribution plat according to field proration orders;
 - Notify appropriate district office 48 hours prior to workover or re-entry;
 - Submit plugging report (CP-4) after plugging is completed;
 - Obtain written approval before disposing or injecting salt water.
- If this permit has expired (See: authorized expiration date) please check the box below and return to the address below.

Well Not Drilled - Permit Expired

Signature of Operator or Agent: _____

Date: _____

Mail to: KCC - Conservation Division, 130 S. Market - Room 2078, Wichita, Kansas 67202

RECEIVED
OCT 11 2005

KCC WICHITA

17 16 25 E

IN ALL CASES PLOT THE INTENDED WELL ON THE PLAT BELOW

Plat of acreage attributable to a well in a prorated or spaced field

If the intended well is in a prorated or spaced field, please fully complete this side of the form. If the intended well is in a prorated or spaced field complete the plat below showing that the well will be properly located in relationship to other wells producing from the common source of supply. Please show all the wells and within 1 mile of the boundaries of the proposed acreage attribution unit for gas wells and within 1/2 mile of the boundaries of the proposed acreage attribution unit for oil wells.

API No. 15 - 121-28111
 Operator: Osborn Energy, L.L.C.
 Lease: Mullinix
 Well Number: 3A-17-16-25
 Field: Louisburg
 Number of Acres attributable to well: _____
 QTR / QTR / QTR of acreage: _____

Location of Well: County: Miami
520 feet from N / S Line of Section
1200 feet from E / W Line of Section
 Sec. 17 Twp. 16 S. R. 25 East West
 Is Section: Regular or Irregular
 If Section is irregular, locate well from nearest corner boundary.
 Section corner used: NE NW SE SW

PLAT

*(Show location of the well and shade attributable acreage for prorated or spaced wells.)
 (Show footage to the nearest lease or unit boundary line.)*

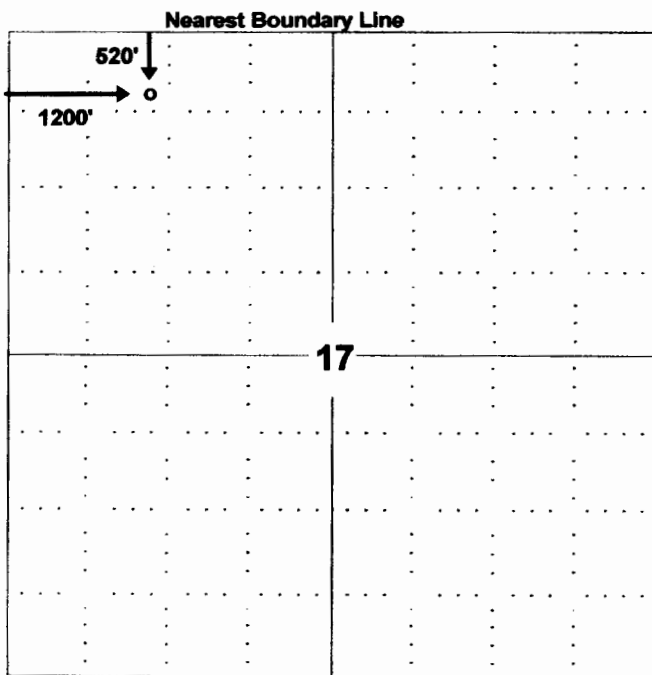

CORRECTED

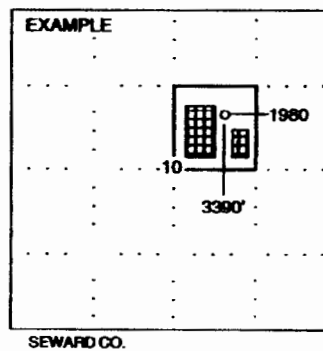

Miami Co.

NOTE: In all cases locate the spot of the proposed drilling location.

In plotting the proposed location of the well, you must show:

1. The manner in which you are using the depicted plat by identifying section lines, i.e. 1 section, 1 section with 8 surrounding sections, 4 sections, etc.
2. The distance of the proposed drilling location from the section's south / north and east / west.
3. The distance to the nearest lease or unit boundary line.
4. If proposed location is located within a prorated or spaced field a certificate of acreage attribution plat must be attached: (CO-7 for oil wells; CG-8 for gas wells).

RECEIVED
 OCT 11 2005
 KCC WICHITA