

FOR KCC USE:

FORM C-1 7/91

FORM MUST BE TYPED

EFFECTIVE DATE: 6-3-96

State of Kansas

FORM MUST BE SIGNED

DISTRICT # 4

NOTICE OF INTENTION TO DRILL

ALL BLANKS MUST BE FILLED

SGA? Yes No

Must be approved by the K.C.C. five (5) days prior to commencing well.

Spot

East

Expected Spud Date 06 06 1996
month day year

Approx SW-NE- NW- Sec 16. Twp 7. S, Rg 20. XX West

1090 feet from South North line of Section
1440 feet from East West line of Section

IS SECTION X REGULAR IRREGULAR?

(NOTE: Locate well on the Section Plat on Reverse Side)

OPERATOR: License # 5352
Name: Baird Oil Company, Inc.
Address: P. O. Bcx 428
City/State/Zip: Logan, Ks. 67646
Contact Person: JIM BAIRD
Phone: 913-689-7456

County: ROOKS

Lease Name: RISELEY 'B' Well #: 4

Field Name: _____

Is this a Prorated/Spaced Field? yes X no

Target Formation(s): LKC

Nearest lease or unit boundary: 1090

CONTRACTOR: License #: 30684
Name: ABERCROMBIE RTD, INC.

* Ground Surface Elevation: 2150 Est. feet MSL

Water well within one-quarter mile: yes X no

Public water supply well within one mile: yes X no

Depth to bottom of fresh water: 100' 180'

Depth to bottom of usable water: 850' 1000'

Surface Pipe by Alternate: 1 X 2

Length of Surface Pipe Planned to be set: 240'

* Length of Conductor pipe required: N/A

Projected Total Depth: 3650'

Formation at Total Depth: ARBUCKLE

Water Source for Drilling Operations:

well farm pond XX other

Well Drilled For: Well Class: Type Equipment:

XX Oil ... Enh Rec ... Infield .XX Mud Rotary
... Gas ... Storage .XX Pool Ext. ... Air Rotary
... OWWO ... Disposal ... Wildcat ... Cable
... Seismic; ... # of Holes ... Other
... Other

If OWWO: old well information as follows:

Operator: _____

Well Name: _____

Comp. Date: _____ Old Total Depth _____

Directional, Deviated or Horizontal wellbore? yes XX no

Will Cores Be Taken?: yes XX no

If yes, true vertical depth: _____

If yes, proposed zone: _____

Bottom Hole Location: _____

* Conductor AREA FOR G.L. < 1960' ELEV. AFFIDAVIT

The undersigned hereby affirms that the drilling, completion and eventual plugging of this well will comply with K.S.A. 55-101, et. seq.

It is agreed that the following minimum requirements will be met:

1. Notify the appropriate district office prior to spudding of well;
2. A copy of the approved notice of intent to drill shall be posted on each drilling rig;
3. The minimum amount of surface pipe as specified below shall be set by circulating cement to the top; in all cases surface pipe shall be set through all unconsolidated materials plus a minimum of 20 feet into the underlying formation;
4. If the well is dry hole, an agreement between the operator and the district office on plug length and placement is necessary prior to plugging;
5. The appropriate district office will be notified before well is either plugged or production casing is cemented in;
6. IF AN ALTERNATE II COMPLETION, PRODUCTION PIPE SHALL BE CEMENTED FROM BELOW ANY USABLE WATER TO SURFACE WITHIN 120 DAYS OF SPUD DATE. IN ALL CASES, NOTIFY DISTRICT OFFICE PRIOR TO ANY CEMENTING.

I hereby certify that the statements made herein are true and to the best of my knowledge and belief.

Date: 05-24-96 Signature of Operator or Agent: _____ Title: Vice-President

FOR KCC USE:
 API # 15- 163-23278000
 Conductor pipe required NONE feet
 Minimum surface pipe required 200 feet per Alt. X(2)
 Approved by: DPW 5-28-96

This authorization expires: 11-28-96
 (This authorization void if drilling not started within 6 months of effective date.)
 Spud date: _____ Agent: _____

REMEMBER TO:

- File Drill Pit Application (form CDP-1) with Intent to Drill;
- File Completion Form ACO-1 within 120 days of spud date;
- File acreage attribution plat according to field proration orders;
- Notify appropriate district office 48 hours prior to workover or re-entry;
- Submit plugging report (CP-4) after plugging is completed;
- Obtain written approval before disposing or injecting salt water.

Mail to: KCC - Conservation Division, 130 S. Market - Room 2078, Wichita, Kansas 67202.

RECEIVED
KANSAS CORP COMM
1996 MAY 28 A 9:53

16 2 20w

IN ALL CASES PLOT THE INTENDED WELL ON THE PLAT BELOW

PLAT OF ACREAGE ATTRIBUTABLE TO A WELL IN A PRORATED OR SPACED FIELD

If the intended well is in a prorated or spaced field, please fully complete this side of the form. If the intended well is in a prorated or spaced field complete the plat below showing that the well will be properly located in relationship to other wells producing from the common source of supply. Please show all the wells within 1 mile of the boundaries of the proposed acreage attribution unit for gas wells and within 1/2 mile of the boundaries of the proposed acreage attribution unit for oil wells.

API NO. 15- _____
 OPERATOR BAIRD OIL COMPANY INC. LOCATION OF WELL: COUNTY _____ ROOKS _____
 LEASE RISELEY 'B' #4 _____ 1090 feet from south/north line of section
 WELL NUMBER 1 _____ 1440 feet from east/west line of section
 FIELD _____ SECTION 16 TWP 7S RG 20W

NUMBER OF ACRES ATTRIBUTABLE TO WELL _____ IS SECTION XX REGULAR or _____ IRREGULAR
 QTR/QTR/QTR OF ACREAGE _____ - _____ - _____ **IF SECTION IS IRREGULAR, LOCATE WELL FROM NEAREST CORNER BOUNDARY.**

Section corner used: _____ NE _____ NW _____ SE _____ SW

PLAT

(Show location of the well and shade attributable acreage for prorated or spaced wells.)
 (Show footage to the nearest lease or unit boundary line.)

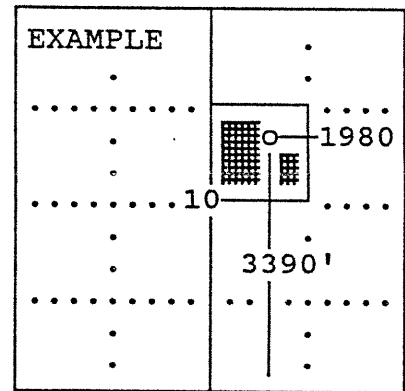
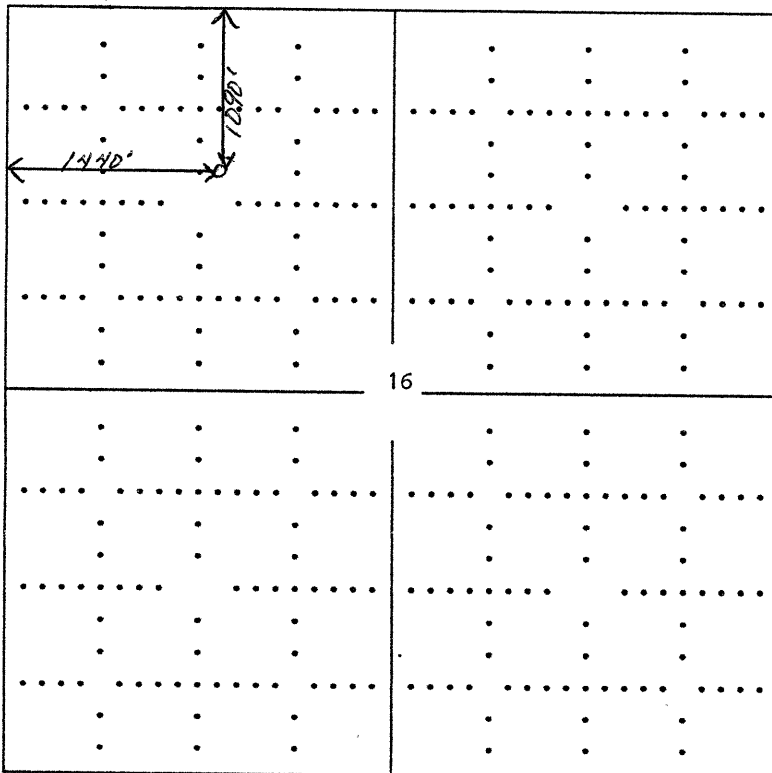

SEWARD CO.

In plotting the proposed location of the well, you must show:

- 1) The manner in which you are using the depicted plat by identifying section lines, i.e. 1 section, 1 section with 8 surrounding sections, 4 sections, etc.;
- 2) the distance of the proposed drilling location from the section's south/north and east/west; and
- 3) the distance to the nearest lease or unit boundary line.