

SIDE ONE

Plugged 9-22-87

STATE CORPORATION COMMISSION OF KANSAS
OIL & GAS CONSERVATION DIVISION
WELL COMPLETION OR RECOMPLETION FORM
ACO-1 WELL HISTORY
DESCRIPTION OF WELL AND LEASE

S

API NO. 15-065-22,407-00-00
County Graham
100' E of Apr.
SE SW NW Sec. 1 Twp. 7S Rge. 21 East West

Operator: License # 4767
Name Ritchie Exploration, Inc.
Address 125 N. Market, Suite 1000
Wichita, KS 67202
City/State/Zip

2970 Ft North from Southeast Corner of Section
4190 Ft West from Southeast Corner of Section
(Note: Locate well in section plat below)

Purchaser N/A

Lease Name Brad Trexler Well # 1

Operator Contact Person Jeff Christian
Phone 316-267-4375

Field Name

Producing Formation N/A

Contractor: License # 6033
Name Murfin Drilling Company

Elevation: Ground 2189' KB 2194'

Wellsite Geologist Bob Mathiesen
Phone 316/267-4375

PLEASE KEEP THIS INFORMATION CONFIDENTIAL

Designate Type of Completion
 New Well Re-Entry Workover

Oil SWD Temp Abd
 Gas Inj Desal
 Dry Other (Core, Water Supply, etc.)

If **OWWO**: old well info as follows:
Operator
Well Name
Comp. Date Old Total Depth

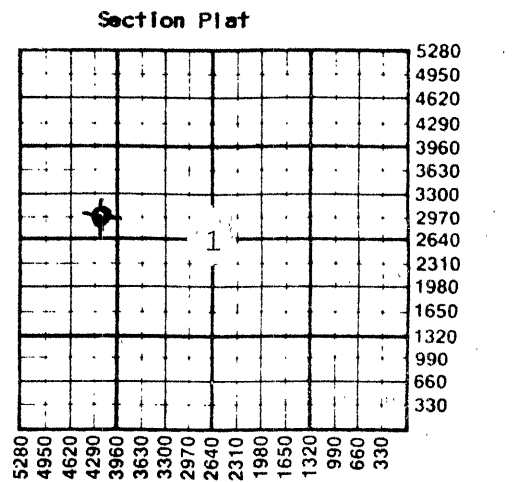

WATER SUPPLY INFORMATION
Disposition of Produced Water: Disposal
Docket # N/A Repressuring

WELL HISTORY
Drilling Method: Mud Rotary Air Rotary Cable
9-15-87 9-21-87 9-22-87
Spud Date Date Reached TD Completion Date
3710' n/a
Total Depth PBT
8-5/8" @ 216'
Amount of Surface Pipe Set and Cemented at...feet
Multiple Stage Cementing Collar Used? Yes No
If yes, show depth set...feet
If alternate 2 completion, cement circulated from...feet depth to...w/...SX cmt
Cement Company Name
Invoice #

Questions on this portion of the ACO-1 call:
Water Resources Board (913) 296-3717
Source of Water: Hauled.
Division of Water Resources Permit #
Groundwater...Ft North from Southeast Corner (Well) ...Ft West from Southeast Corner of Sec Twp Rge East West
Surface Water...Ft North from Southeast Corner (Stream, pond etc)...Ft West from Southeast Corner Sec Twp Rge East West
Other (explain) (purchased from city, R.W.D. #)

INSTRUCTIONS: This form shall be completed in triplicate and filed with the Kansas Corporation Commission, 200 Colorado Derby Building, Wichita, Kansas 67202, within 120 days of the spud date of any well. Rule 82-3-130, 82-3-107 and 82-3-106 apply.
Information on side two of this form will be held confidential for a period of 12 months if requested in writing and submitted with the form. See rule 82-3-107 for confidentiality in excess of 12 months.
One copy of all wireline logs and drillers time log shall be attached with this form. Submit CP-4 form with all plugged wells. Submit CP-111 form with all temporarily abandoned wells.

All requirements of the statutes, rules and regulations promulgated to regulate the oil and gas industry have been fully complied with and the statements herein are complete and correct to the best of my knowledge.

Signature [Signature]
Title Vice President Date 11/20/87

Subscribed and sworn to before me this 20th day of November 1987
Notary Public Linda K. Rice
Date Commission Expires 6/07/88

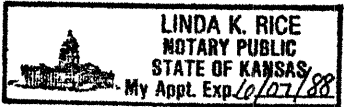

K.C.C. OFFICE USE ONLY
 Letter of Confidentiality Attached
 Wireline Log Received
 Drillers Timelog Received
Distribution
 KCC SWD/Rep NGPA
 RECEIVED Plug Other
STATE CORPORATION COMMISSION (Specify)
DEC 8 1987

Form ACO-1 (5-86)
CONSERVATION DIVISION
Wichita, Kansas
12-8-87

Sec. 1, Twp. 7S, Rge. 21E

SIDE TWO

Operator Name Ritchie Exploration, Inc. Lease Name Brad Trexler Well # 1

Sec. 1 Twp. 7S Rge. 21 East West County Graham

WELL LOG

INSTRUCTIONS: Show important tops and base of formations penetrated. Detail all cores. Report all drill stem tests giving interval tested, time tool open and closed, flowing and shut-in pressures, whether shut-in pressure reached static level, hydrostatic pressures, bottom hole temperature, fluid recovery, and flow rates if gas to surface during test. Attach extra sheet if more space is needed. Attach copy of log.

Drill Stem Tests Taken Yes No
 Samples Sent to Geological Survey Yes No
 Cores Taken Yes No

Formation Description
 Log Sample

DST #1 3358'-3403' (Lower Topeka). Recovered 1360' of salt water, no show of oil.
 IFP:116-443#/30"; ISIP:1009#/30";
 FFP:490-640#/30"; FSIP:997#/30".

Name	Top	Bottom
Anhydrite	1789' (+ 405)	
B/Anhydrite	1822' (+ 372)	
Topeka	3189' (- 995)	
Heebner	3396' (-1202)	
Toronto	3417' (-1223)	
Lansing	3430' (-1236)	
B/KC	3626' (-1432)	
LTD	3710' (-1516)	

DST #2 3390'-3423' (Toronto). Recovered 150' of muddy water.
 IFP:46-70#/30"; ISIP:1237#/45";
 FFP:81-93#/30"; FSIP:1226#/45".

DST #3 3425'-3450' (Top zone). Recovered 140' muddy water.
 IFP:35-58#/30"; ISIP:1237#/45";
 FFP:70-81#/30"; FSIP:1226#/45".

DST #4 3475'-3493' (50' zone). Recovered 45' of watery mud.
 IFP:23-35#/30"; ISIP:1237#/45";
 FFP:35-46#/30"; FSIP:1214#/45".

DST #5 3536'-3600' (140', 160' & 180' zones). Recovered 30' of slightly oil cut mud, show of oil in tool.

IFP:46-58#/30"; ISIP:928#/45";
 FFP:58-58#/30"; FSIP:778#/45".

PLEASE KEEP THIS INFORMATION CONFIDENTIAL

RELEASED 1-11-89 JAN 11 1989

FROM CONFIDENTIAL

CASING RECORD <input checked="" type="checkbox"/> New <input type="checkbox"/> Used Report all strings set-conductor, surface, intermediate, production, etc.							
Purpose of String	Size Hole Drilled	Size Casing Set (in O.D.)	Weight Lbs/Ft.	Setting Depth	Type of Cement	#Sacks Used	Type and Percent Additives
Surface	12 1/4"	8-5/8"	23#	216'	QuickSet	160	
PERFORATION RECORD				Acid, Fracture, Shot, Cement Squeeze Record			
Shots Per Foot	Specify Footage of Each Interval Perforated			(Amount and Kind of Material Used)		Depth	
TUBING RECORD				Liner Run <input type="checkbox"/> Yes <input type="checkbox"/> No			
Date of First Production		Producing Method <input type="checkbox"/> Flowing <input type="checkbox"/> Pumping <input type="checkbox"/> Gas Lift <input type="checkbox"/> Other (explain).....					
Estimated Production Per 24 Hours	Oil	Gas	Water	Gas-Oil Ratio	Gravity		
	Bbls	MCF	Bbls	CFPB			

METHOD OF COMPLETION

Production Interval

Disposition of gas: Vented Open Hole Perforation
 Sold Other (Specify)
 Used on Lease Dually Completed
 Commingled